

INDEX OF SHEETS

08-02-2024 LETTING ITEM 020

- 1 COVER SHEET
- 2 GENERAL NOTES
- 3-5 SUMMARY OF QUANTITIES
- 6-7 TYPICAL SECTIONS
- 8-10 SCHEDULES
- 11 PROJECT LAYOUT
- 12-14 DETAILS

LIST OF ILLINOIS DOT HIGHWAY STANDARDS

- 000001-08 STANDARD SYMBOLS, ABBREVIATIONS AND PATTERNS
- 001006 DECIMAL OF AN INCH AND OF A FOOT
- 406201-01 MAILBOX TURNOUT
- 420406 PAVEMENT CONNECTOR (HMA) FOR BRIDGE APPROACH SLAB
- 635001-02 DELINEATORS
- 667101-02 PERMANENT SURVEY MARKERS
- 701001-02 OFF-ROAD OPERATIONS 2L, 2W, MORE THAN 15' AWAY
- 701006-05 OFF-ROAD OPERATIONS 2L, 2W, 15' TO 24" FROM PAVEMENT EDGE
- 701011-04 OFF-ROAD MOVING OPERATIONS 2L, 2W, DAY ONLY
- 701306-04 LANE CLOSURE, 2L, 2W, SLOW MOVING OPERATIONS DAY ONLY, FOR SPEEDS ≥ 45 MPH
- 701311-03 LANE CLOSURE, 2L, 2W, MOVING OPERATIONS - DAY ONLY
- 701901-09 TRAFFIC CONTROL DEVICES
- 780001-05 TYPICAL PAVEMENT MARKINGS
- 781001-04 TYPICAL APPLICATIONS RAISED REFLECTIVE PAVEMENT MARKERS
- 782006-01 GUARDRAIL AND BARRIER WALL REFLECTOR MOUNTING DETAILS

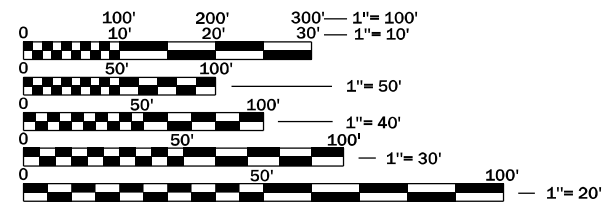

FULL SIZE PLANS HAVE BEEN PREPARED USING STANDARD ENGINEERING SCALES. REDUCED SIZED PLANS WILL NOT CONFORM TO STANDARD SCALES. IN MAKING MEASUREMENTS ON REDUCED PLANS, THE ABOVE SCALES MAY BE USED.

J.U.L.I.E.
JOINT UTILITY LOCATION INFORMATION FOR EXCAVATION
1-800-892-0123
OR 811

PROJECT ENGINEER: JOE KANNEL, P.E.
UNIT CHIEF: DARCY MITCHELL
DISTRICT 3 NO. (815) 434-6131
CONTRACT NO. 66P43

STATE OF ILLINOIS
DEPARTMENT OF TRANSPORTATION

PROPOSED
HIGHWAY PLANS

FAP ROUTE 786 (IL 170)
SECTION (99)RS-3
PROJECT STP-1LWT(206)
MILLING AND RESURFACING
(DESIGN OVERLAY)
LIVINGSTON COUNTY

C-93-096-24

BRIDGE OMISSION
S.N. 053-0162
STA. 285 + 08 TO
STA. 286 + 22

BRIDGE OMISSION
S.N. 053-0164
STA. 413 + 00 TO
STA. 413 + 83

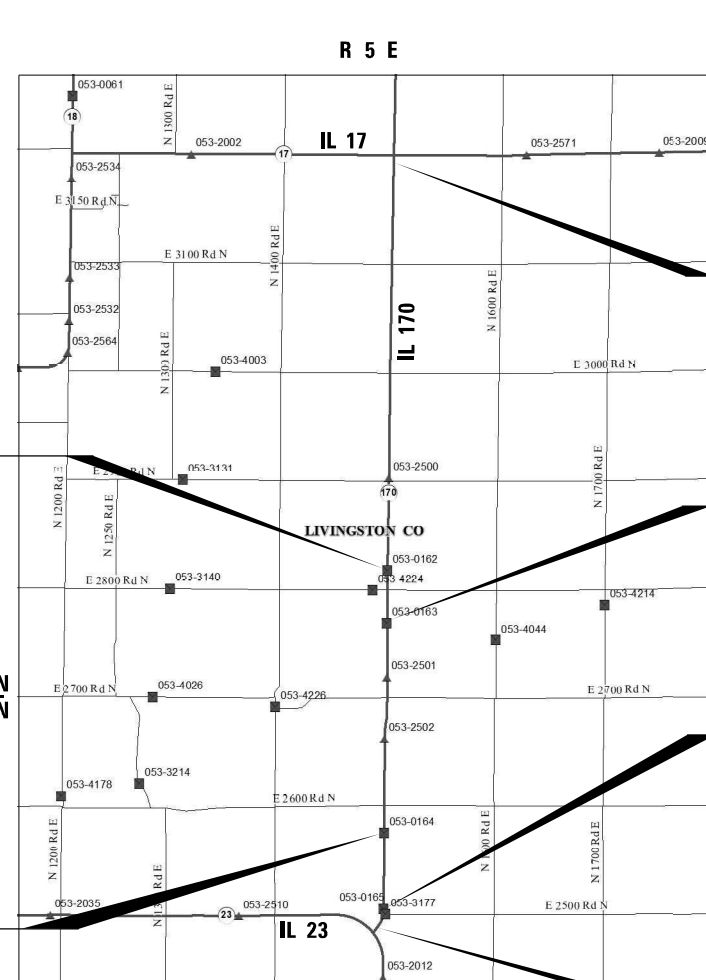

BEGIN
IMPROVEMENT
STA. 84 + 35

BRIDGE OMISSION
S.N. 053-0163
STA. 310 + 55 TO
STA. 311 + 78

BRIDGE OMISSION
S.N. 053-0164
STA. 449 + 87 TO
STA. 450 + 97

END
IMPROVEMENT
STA. 462 + 00

GROSS LENGTH OF PROJECT = 37,765 FT = 7.152 MILES
NET LENGTH OF PROJECT = 37,275 FT = 7.060 MILES

F.A.P. RTE.	SECTION	COUNTY	TOTAL SHEETS	SHEET NO.
786	(99)RS-3	LIVINGSTON	14	1
		ILLINOIS	CONTRACT NO. 66P43	

D-93-058-24

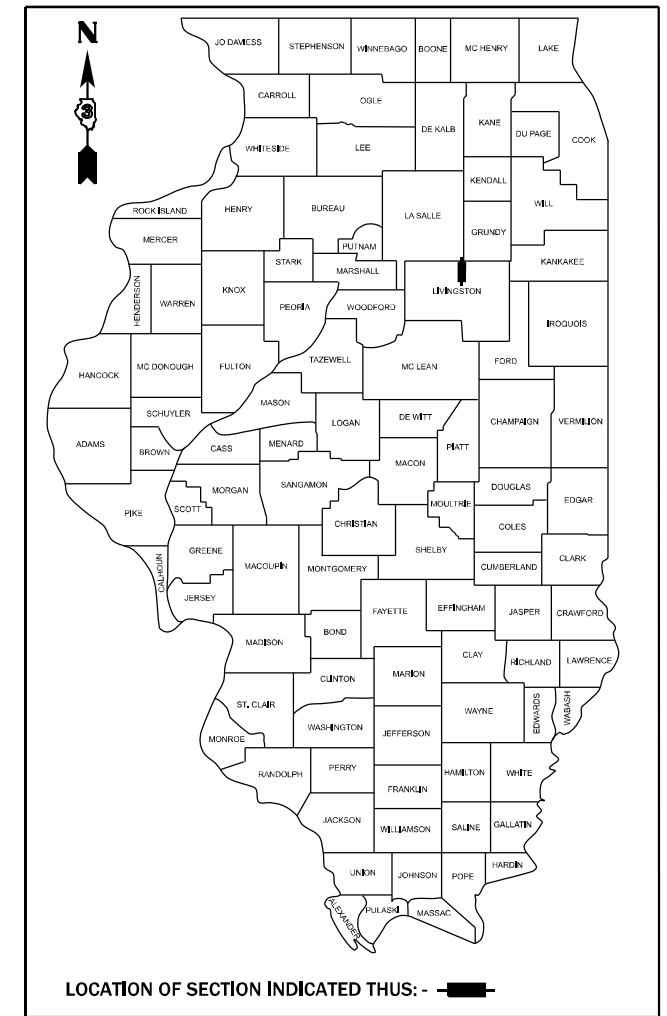

LOCATION OF SECTION INDICATED THIS: - [Symbol] -

FUNCTIONAL CLASSIFICATION =
MINOR ARTERIAL (RURAL)

ADT (2023) = 1300
P.V. = 87.0% M.U. = 9.2% S.U. = 3.8%

STATE OF ILLINOIS
DEPARTMENT OF TRANSPORTATION

SUBMITTED May 13, 2024

Tasha Thompson
REGIONAL ENGINEER

June 28, 2024
[Signature]
ENGINEER OF DESIGN AND ENVIRONMENT

June 28, 2024
[Signature]
DIRECTOR OF HIGHWAYS PROJECT IMPLEMENTATION

PRINTED BY THE AUTHORITY
OF THE STATE OF ILLINOIS

GENERAL NOTES

THE HMA SURFACE OF ALL MAILBOX TURNOUTS, PRIVATE ENTRANCES, COMMERCIAL ENTRANCES, AND SIDE ROADS SHALL BE MADE NEATLY, IN A WORKMANLIKE MANNER, AND SHALL ACCURATELY CONFORM TO THE SHAPES AND DIMENSIONS SHOWN ON THE PLAN DETAILS. IF REQUIRED BY THE ENGINEER, THE CONTRACTOR SHALL SAW CUT THE HMA SURFACE TO CONFORM TO THE SHAPES AND DIMENSIONS SHOWN ON THE PLAN DETAILS. THIS WORK WILL BE INCLUDED IN THE COST OF THE HMA SURFACE.

EXCEPT AS NOTED ON THE PLANS, PAVEMENT GRADES SHOWN ARE AT THE TOP OF PAVEMENT SURFACES.

THE ENGINEER WILL BE THE SOLE JUDGE CONCERNING CURING TIME FOR THE VARIOUS HMA LIFTS.

THE FINISHED EARTHWORK SHALL HAVE A VEGETATION SUSTAINING SOIL COVERING THE TOP FOUR INCHES (100 MILLIMETERS) IN AREAS TO BE SEEDED OR SODDED. THE VEGETATION SUSTAINING SOIL REQUIRED WILL NOT BE PAID FOR SEPARATELY BUT WILL BE INCLUDED IN THE COST OF FURNISHED EXCAVATION.

ALL EXCAVATED MATERIAL, WHICH INCLUDES DIGGING OR GRADING OF ANY SOIL OR FILL MATERIAL, WITH THE EXCEPTION OF AGGREGATE FILLS, MUST BE INCORPORATED WITHIN THE IDOT RIGHT OF WAY.

ON EXISTING PAVEMENT WHICH MAY BE SUPERELEVATED, THE NEW HMA PAVEMENT SHALL BE BUILT WITH THE SAME SUPERELEVATION UNLESS NEW SUPERELEVATION RATES ARE GIVEN ON THE PLANS.

ALL ELEVATIONS REFERRING TO U.S.G.S. MEAN SEA LEVEL DATUM.

THE FOLLOWING RATES OF APPLICATION HAVE BEEN USED IN CALCULATING PLAN QUANTITIES:

GRANULAR MATERIALS	2.05	TONS / CU YD
HMA RESURFACING	112	LBS / SQ YD / IN
SHORT TERM PAVEMENT MARKING	10	FT /100 FT OF APPLICATION
MIX FOR CRACKS, JTS & FLGWYS	0.0003	TONS / SQ YD

MEMBERS OF JULIE KNOWN TO BE WITHIN THE LIMITS OF THE IMPROVEMENT ARE: COMED, FAIRPOINT COMMUNICATIONS, FRONTIER COMMUNICATIONS, AND METRO COMMUNICATIONS.

NON-MEMBERS OF JULIE KNOWN TO BE WITHIN THE LIMITS OF THE IMPROVEMENT ARE: ILLINOIS DEPT. OF TRANSPORTATION DISTRICT #3

THE CONTRACTOR SHALL CONTACT JULIE AT LEAST 48 HOURS PRIOR TO EXCAVATION TO DETERMINE WHICH UTILITIES ARE IN THE AREA.

COMMITMENTS:

NONE

HMA MIXTURE REQUIREMENT TABLE			
LOCATIONS:	ENTIRE PROJECT	ENTIRE PROJECT	ENTIRE PROJECT
MIXTURE USE(S):	HMA SURFACE	HMA BINDER	HMA INCIDENTAL
BINDER GRADE (PG):	PG 64-22	PG 64-22	PG 64-22
DESIGN AIR VOIDS:	4.0% @ N50	4.0% @ N50	4.0% @ N50
MIXTURE COMPOSITION: (MIXTURE GRADATION)	IL 9.5	IL 19.0	IL 9.5
FRICITION AGGREGATE:	MIXTURE C		
MIXTURE WEIGHT:	112.0 LB/SY/IN	112.0 LB/SY/IN	112.0 LB/SY/IN
QUALITY MANAGEMENT PROGRAM:	QCP	QCP	QCQA
SUBLOT SIZE:	1000 TONS	1000 TONS	NA
DENSITY TEST METHOD:	CORES	CORES	SATISFACTION OF ENGINEER
MATERIAL TRANSFER DEVICE (REQUIRED)	YES	YES	NO

STATE OF ILLINOIS
DEPARTMENT OF TRANSPORTATION
DISTRICT THREE
AS BUILT INFORMATION

SUPERVISING CONSTRUCTION FIELD ENGINEER

RESIDENT ENGINEER / TECHNICIAN

START & END DATES
OF CONSTRUCTION: _____

INSPECTORS: _____

MODEL: Default FILE: \\dot-pw-beachy.com\P\INDOT\Documents\DOT 0 ces\District 3\ORR Projects\366R3\CADD\366R3\CAD\Sheet\366R3_Cover_Sheet.dgn

USER NAME = tmothy.pletsch	DESIGNED -	REVISED -
	DRAWN -	REVISED -
PLOT SCALE = \$SCALE\$	CHECKED -	REVISED -
PLOT DATE = 5/13/2024	DATE -	REVISED -

**STATE OF ILLINOIS
DEPARTMENT OF TRANSPORTATION**

GENERAL NOTES

SCALE: SHEET OF SHEETS STA. TO STA.

F.A.P. RTE.	SECTION	COUNTY	TOTAL SHEETS	SHEET NO.
786	(99)RS-3	LIVINGSTON	14	2
CONTRACT NO. 66P43				
ILLINOIS FED. AID PROJECT				

MODEL: Default
 FILE NAME: p:\ilict-pw-bentley.com\p\INDOT\Documents\DOT 0 ces\District_3\ORRD Project\366R43\CADD\366R43\CAD\Sheet\366R43 Cover Sheet.dgn

CODE NO.	ITEM	UNIT	TOTAL QUANTITY	CONSTR. CODE	
				80% FED 20% STATE	
				ROADWAY	
				0005	
				RURAL	
20400800	FURNISHED EXCAVATION	CU YD	6		6
40200900	AGGREGATE SURFACE COURSE, TYPE B	CU YD	160		160
40600290	BITUMINOUS MATERIALS (TACK COAT)	POUND	74113		74113
40600370	LONGITUDINAL JOINT SEALANT	FOOT	37228		37228
40600400	MIXTURE FOR CRACKS, JOINTS, AND FLANGEWAYS	TON	32		32
40600990	TEMPORARY RAMP	SQ YD	362		362
40603080	HOT-MIX ASPHALT BINDER COURSE, IL-19.0, N50	TON	13150		13150
40604050	HOT-MIX ASPHALT SURFACE COURSE, IL-9.5, MIX "C", N50	TON	9187		9187
40800050	INCIDENTAL HOT-MIX ASPHALT SURFACING	TON	652		652
44000157	HOT-MIX ASPHALT SURFACE REMOVAL, 2"	SQ YD	3761		3761
44000164	HOT-MIX ASPHALT SURFACE REMOVAL, 3 3/4"	SQ YD	104361		104361
48102100	AGGREGATE WEDGE SHOULDER, TYPE B	TON	2803		2803
63500105	DELINEATORS	EACH	46		46
* 66700205	PERMANENT SURVEY MARKERS, TYPE I	EACH	14		14

* SPECIALTY ITEM

USER NAME = tlmthy,pletsch	DESIGNED -	REVISED -
	DRAWN -	REVISED -
PLOT SCALE = \$SCALE\$	CHECKED -	REVISED -
PLOT DATE = 5/13/2024	DATE -	REVISED -

**STATE OF ILLINOIS
DEPARTMENT OF TRANSPORTATION**

SUMMARY OF QUANTITIES

SCALE: SHEET OF SHEETS STA. TO STA.

F.A.P. RTE.	SECTION	COUNTY	TOTAL SHEETS	SHEET NO.
786	(99)RS-3	LIVINGSTON	14	3
CONTRACT NO. 66P43			ILLINOIS FED. AID PROJECT	

MODEL: Default
 FILE NAME: p:\illicit-plw-beadley.com\PIV\DOT\Documents\DOT 0 ces\District_3\ORD Project\366R43\CADD\366R43\CAD\Sheet\366R43 Cover Sheet.dgn

CODE NO.	ITEM	UNIT	TOTAL QUANTITY	CONSTR. CODE	
				80% FED 20% STATE	
				ROADWAY	
				0005	
				RURAL	
67000400	ENGINEER'S FIELD OFFICE, TYPE A	CAL MO	4		4
67100100	MOBILIZATION	L SUM	1		1
70100460	TRAFFIC CONTROL AND PROTECTION, STANDARD 701306	L SUM	1		1
70300100	SHORT TERM PAVEMENT MARKING	FOOT	11315		11315
70300150	SHORT TERM PAVEMENT MARKING REMOVAL	SQ FT	1257		1257
* 78009000	MODIFIED URETHANE PAVEMENT MARKING - LETTERS AND SYMBOLS	SQ FT	31.2		31.2
* 78009004	MODIFIED URETHANE PAVEMENT MARKING - LINE 4"	FOOT	173282		173282
* 78009006	MODIFIED URETHANE PAVEMENT MARKING - LINE 6"	FOOT	18859		18859
* 78009008	MODIFIED URETHANE PAVEMENT MARKING - LINE 8"	FOOT	586		586
* 78100100	RAISED REFLECTIVE PAVEMENT MARKER	EACH	477		477
78300200	RAISED REFLECTIVE PAVEMENT MARKER REMOVAL	EACH	477		477
X4401198	HOT-MIX ASPHALT SURFACE REMOVAL, VARIABLE DEPTH	SQ YD	4427		4427
X6350204	LINEAR DELINEATOR PANELS, 4 INCH	EACH	62		62
X6350206	LINEAR DELINEATOR PANELS, 6 INCH	EACH	24		24

* SPECIALTY ITEM

USER NAME = tlmthy,pletsch	DESIGNED -	REVISED -	STATE OF ILLINOIS DEPARTMENT OF TRANSPORTATION	SUMMARY OF QUANTITIES				F.A.P. RTE.	SECTION	COUNTY	TOTAL SHEETS	SHEET NO.
PLOT SCALE = \$SCALE\$	DRAWN -	REVISED -						786	(99)RS-3	LIVINGSTON	14	4
PLOT DATE = 5/13/2024	CHECKED -	REVISED -		SCALE: SHEET OF SHEETS STA. TO STA.				CONTRACT NO. 66P43				
	DATE -	REVISED -						ILLINOIS FED. AID PROJECT				

MODEL: Default
 FILE NAME: p:\illicit-aw-beadley.com\P\INDOT\Documents\DOT 0 ces\District_3\ORD Project\366R43\CADD\366R43\Cover Sheet.dgn

CODE NO.	ITEM	UNIT	TOTAL QUANTITY	CONSTR. CODE	
				ROADWAY	RURAL
				80% FED	20% STATE
				0005	
Z0030850	TEMPORARY INFORMATION SIGNING	SQ FT	42	42	
Z0034105	MATERIAL TRANSFER DEVICE	TON	22337	22337	

* SPECIALTY ITEM

USER NAME = tlmthy,pletsch	DESIGNED -	REVISED -
	DRAWN -	REVISED -
PLOT SCALE = \$SCALE\$	CHECKED -	REVISED -
PLOT DATE = 5/13/2024	DATE -	REVISED -

**STATE OF ILLINOIS
 DEPARTMENT OF TRANSPORTATION**

SUMMARY OF QUANTITIES

SCALE: SHEET OF SHEETS STA. TO STA.

F.A.P. RTE.	SECTION	COUNTY	TOTAL SHEETS	SHEET NO.
786	(99)RS-3	LIVINGSTON	14	5
CONTRACT NO. 66P43				
ILLINOIS FED. AID PROJECT				

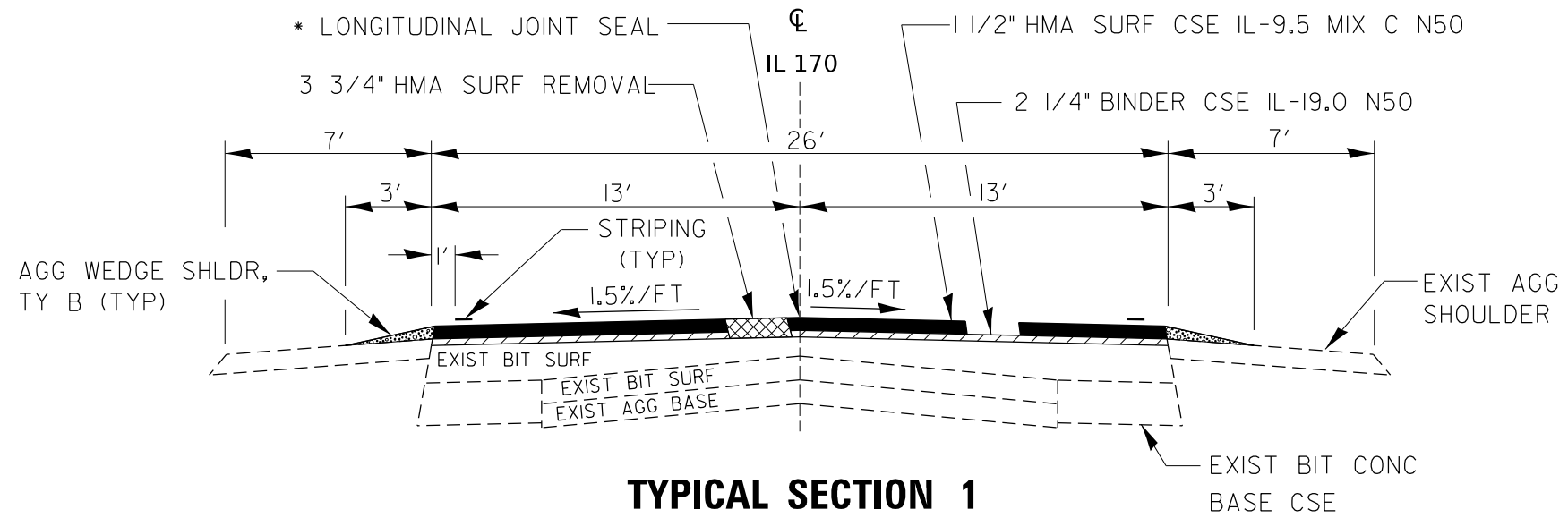

TYPICAL SECTION 1

STA. 84+35 TO STA. 353+05
 STA. 368+79 TO STA. 449+87

STRUCTURE OMISSIONS

- STA. 285+13 TO STA. 286+26 (SN 053-0162)
- STA. 305+56 TO STA. 306+75 (SN 053-0163)
- STA. 312+30 TO STA. 313+78 (SN 053-0164)
- STA. 449+87 TO STA. 450+97 (SN 053-0165)

* LONGITUDINAL JOINT SEAL BETWEEN BINDER AND SURFACE

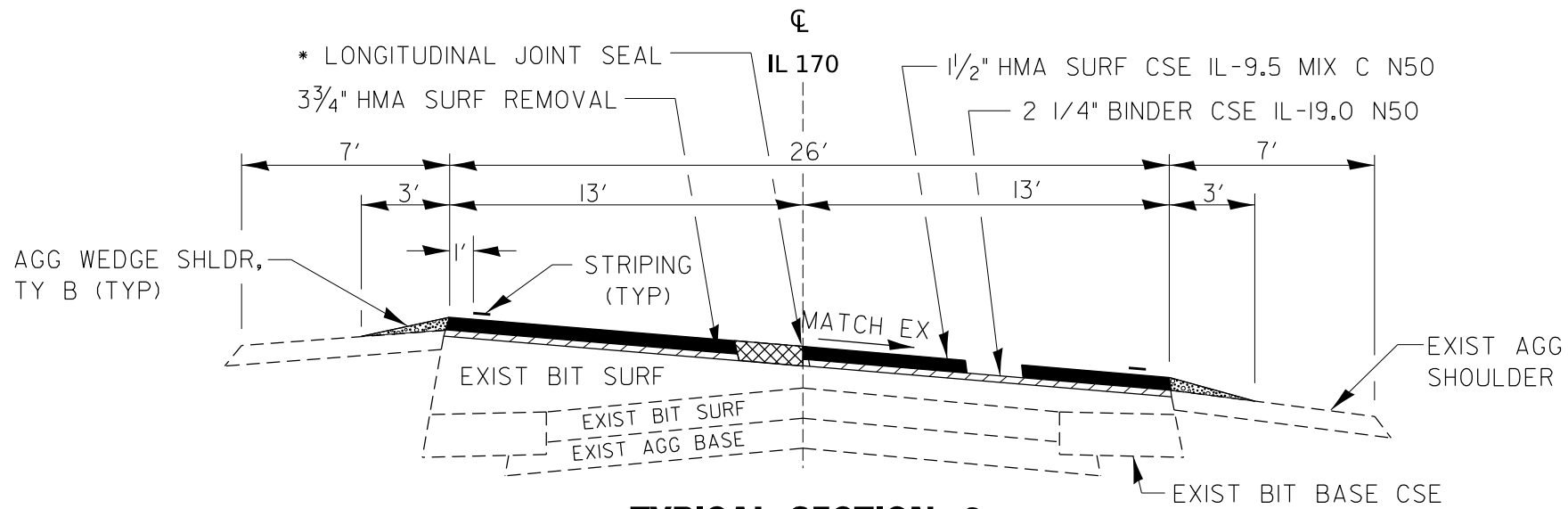

TYPICAL SECTION 2

STA. 353+05 TO STA. 368+79

MODEL: D:\info\...
 FILE NAME: ...

USER NAME = tlmthy.zletsch	DESIGNED -	REVISED -
	DRAWN -	REVISED -
PLOT SCALE = \$SCALE\$	CHECKED -	REVISED -
PLOT DATE = 5/13/2024	DATE -	REVISED -

**STATE OF ILLINOIS
 DEPARTMENT OF TRANSPORTATION**

TYPICAL SECTIONS	
SCALE:	SHEET OF SHEETS STA. TO STA.

F.A.P. RTE.	SECTION	COUNTY	TOTAL SHEETS	SHEET NO.
786	(99)RS-3	LIVINGSTON	14	6
CONTRACT NO. 66P43				
ILLINOIS FED. AID PROJECT				

Long Section Number

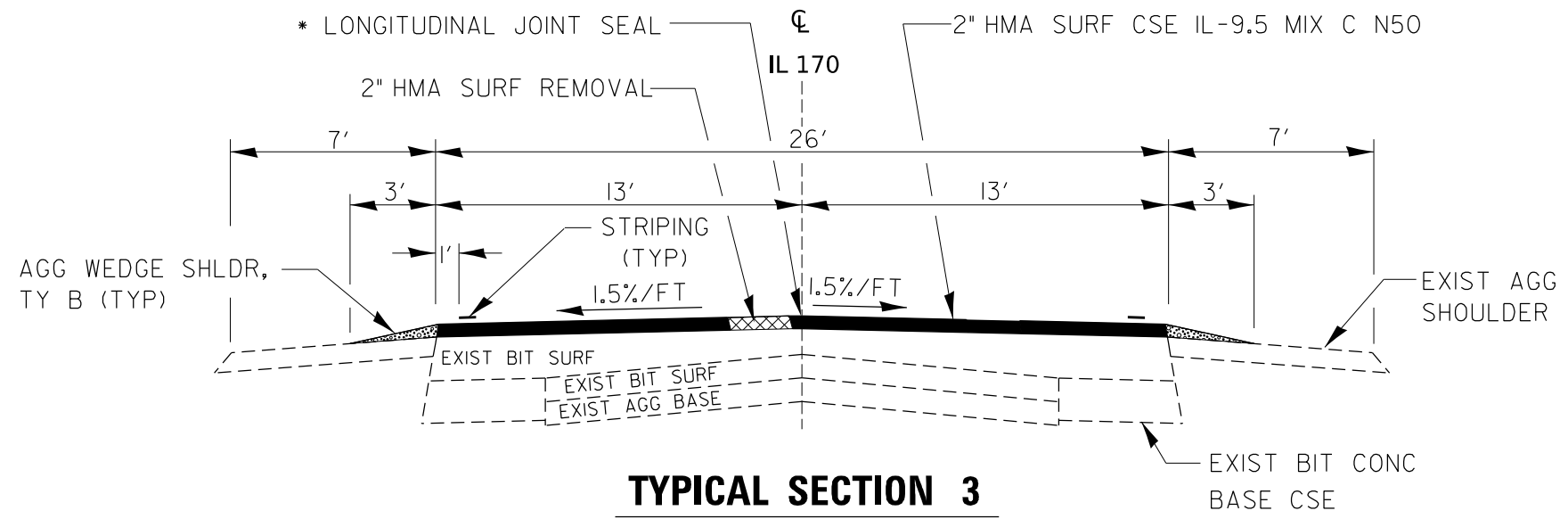

TYPICAL SECTION 3
 STA. 450+97 TO STA. 462+00

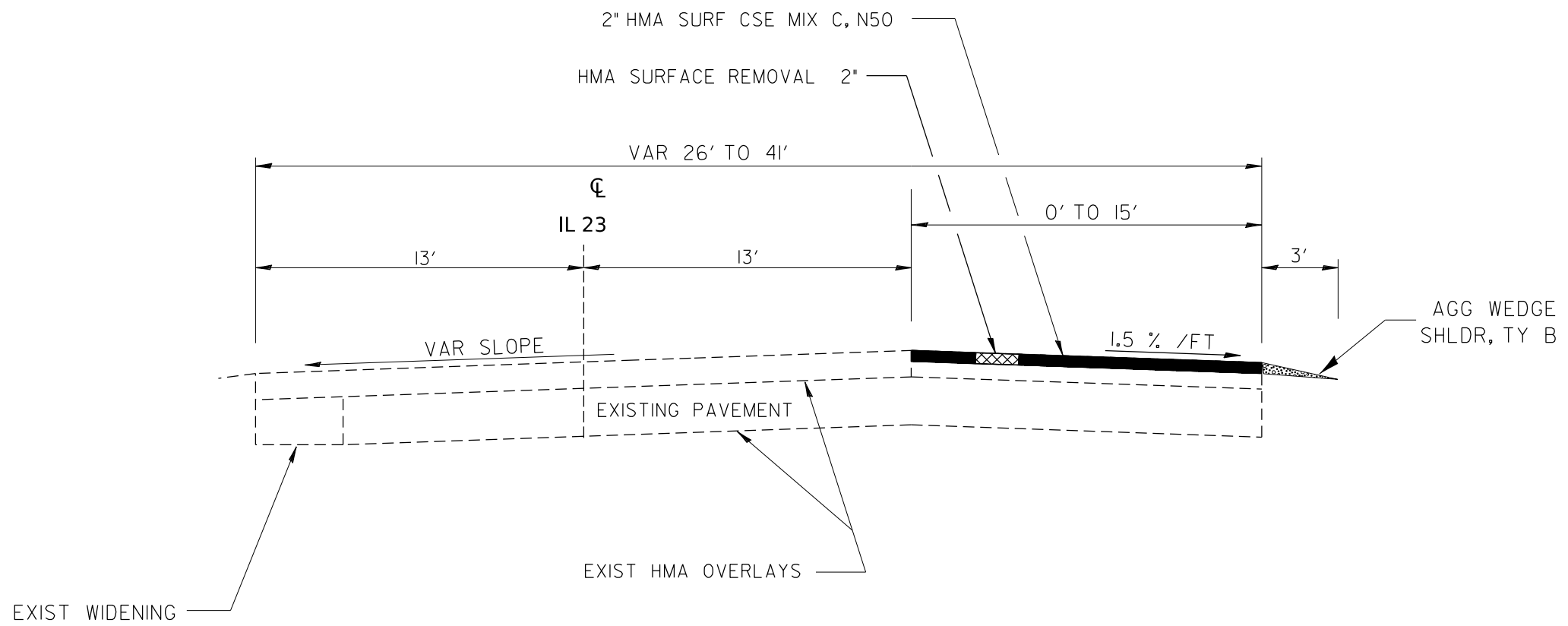

TYPICAL SECTION 4
 IL 23 RIGHT TURN LANE TO IL 170

MODEL: D:\h111...
 FILE NAME: ...
 PROJECT: ...
 DATE: ...

USER NAME = tlmthy.zletsch	DESIGNED -	REVISED -
DRAWN -	REVISOR -	
PLOT SCALE = \$SCALE\$	CHECKED -	REVISED -
PLOT DATE = 5/13/2024	DATE -	REVISED -

STATE OF ILLINOIS
DEPARTMENT OF TRANSPORTATION

TYPICAL SECTIONS	
SCALE:	SHEET OF SHEETS STA. TO STA.

F.A.P. RTE.	SECTION	COUNTY	TOTAL SHEETS	SHEET NO.
786	(99)RS-3	LIVINGSTON	14	7
CONTRACT NO. 66P43				
ILLINOIS FED. AID PROJECT				

Long Section Number

MAINLINE SCHEDULE																
STA. TO STA.	LENGTH	MAINLINE WIDTH	HMA SURFACE REMOVAL	HMA SURFACE REMOVAL	HMA SURF.CSE MIX C	BINDER COURSE	HMA SURF.CSE MIX C	MATERIAL TRANSFER DEVICE	MIX FOR JTS, CRACKS & FLGWYS	BIT. MAT'L (TACK COAT)	LONG JOINT SEAL	AGG WEDGE SHLD TY B	TEMP RAMP			
	FT	FT	3 3/4" SQ YD	2" SQ YD	IL-9.5,N50 1 1/2" TONS	IL-19.0 N50 2 1/4" TONS	IL-9.5,N50 2" TONS	TON	TONS	POUND	FOOT	TONS	SQ YD			
84+82	285+13	20031	26	57867	4860.9	7291		12152.1	17.4	39060	20031	1520.9	36.1			
285+13	286+26	STRUCTURE OMISSION S.N. 053-0162														
286+26	305+56	1930	26	5576	468.3	703		1170.9	1.7	3764	1930	146.5	36.1			
305+56	306+75	STRUCTURE OMISSION S.N. 053-0163														
306+75	312+30	555	26	1603.3	134.7	202		336.7	0.5	1082	555	42.1	36.1			
312+30	313+78	STRUCTURE OMISSION S.N. 053-0164														
313+78	449+87	13609	26	39314.9	3302.5	4954		8256.1	11.8	26538	13609	1033.3	36.1			
449+87	450+97	STRUCTURE OMISSION S.N. 053-0165														
450+97	462+00	1103	26		3186.4			356.9	356.9	1.0	1434	1103	41.9	36.1		
IL 23 TURN LANE		205	15		341.7			38.3	38.3	0.1	154		7.8			
IL 23 TURN LANE TAPER		280	15-0		233.3			26.1	26.1	0.1	105		10.6			
TOTALS		37713			104361	3761		8766	13150	421	22337	32	72136	37228	2803	181

SIDEROADS SCHEDULE															
STATION	NAME	SIDE	MATERIAL	WIDTH FRONT	WIDTH BACK	VARIABLE DEPTH SURF REM	INCIDENTAL HMA SURF	BIT MATL (TACK COAT)	TEMP RAMP	FURNISH EX	SEEDING, CL 2A *	NITROGEN FERTILIZER NUTRIENT *	PHOSPHORUS FERTILIZER NUTRIENT *	POTASSIUM FERTILIZER NUTRIENT *	EROSION CONTROL BLANKET *
						SQ YD	TON	POUND	SQ YD	CU YD	ACRE	POUND	POUND	POUND	SQ YD
136+69	3100 N Road	RT	HMA	140	25	275.0	40.8	123.8	13.9	0.4	0.002	0.2	0.2	0.2	10.0
136+69	3100 N Road	LT	HMA	110	25	225.0	33.4	101.3	13.9	0.4	0.002	0.2	0.2	0.2	10.0
189+60	3000 N Road	RT	HMA	115	25	233.3	34.6	105.0	13.9	0.4	0.002	0.2	0.2	0.2	10.0
189+60	3000 N Road	LT	HMA	115	25	233.3	34.6	105.0	13.9	0.4	0.002	0.2	0.2	0.2	10.0
242+27	2900 N Road	RT	HMA	130	25	258.3	38.3	116.3	13.9	0.4	0.002	0.2	0.2	0.2	10.0
242+27	2900 N Road	LT	HMA	130	25	258.3	38.3	116.3	13.9	0.4	0.002	0.2	0.2	0.2	10.0
295+07	2800 N Road	RT	HMA	105	25	216.7	32.2	97.5	13.9	0.4	0.002	0.2	0.2	0.2	10.0
295+07	2800 N Road	LT	HMA	105	25	216.7	32.2	97.5	13.9	0.4	0.002	0.2	0.2	0.2	10.0
347+76	2700 N Road	RT	HMA	160	25	308.3	45.8	138.8	13.9	0.4	0.002	0.2	0.2	0.2	10.0
347+76	2700 N Road	LT	HMA	160	25	308.3	45.8	138.8	13.9	0.4	0.002	0.2	0.2	0.2	10.0
399+98	2600 N Road	RT	HMA	145	25	283.3	42.0	127.5	13.9	0.4	0.002	0.2	0.2	0.2	10.0
399+98	2600 N Road	LT	HMA	165	25	316.7	47.0	142.5	13.9	0.4	0.002	0.2	0.2	0.2	10.0
453+29	2500 N Road	LT	HMA	90	25	191.7	28.4	86.3	13.9	0.4	0.002	0.2	0.2	0.2	10.0
TOTALS						3325	493	1496	181	6	0.03	3	3	3	130

* SEEDING PAY ITEMS WILL NOT BE PAID FOR SEPARATELY, BUT WILL BE INCLUDED IN THE COST OF FURNISHED EXCAVATION.

PAVEMENT MARKING SCHEDULE									
LOCATION	COMMENT	LENGTH	MODIFIED URETHANE (2 APPLICATIONS)				RAISED REFLECT PVMT MARK 2 WAY YEL EACH	RAISED REFLECT PVMT MARK REMOVAL EACH	
			LINE 4" WHITE	LINE 6" YELLOW	LINE 8" WHITE	LTR & SYM WHITE			
STATION		FOOT	FOOT	FOOT	FOOT	SQ FT			
84+82 TO 462+00	Passing Zone	37718	150872	18859			471	471	
IL 23 TURN LANE		485	970	586		31.2	6	6	
TOTAL		38203	151842	18859	586	31.2	477	477	

PAVEMENT MARKING INCLUDES BRIDGE OMISSIONS

MODEL: Default
FILE NAME: c:\pwworking\plm\sch\rd0074386\Schedules.dgn

USER NAME = timothy.pletsch	DESIGNED -	REVISED -	STATE OF ILLINOIS DEPARTMENT OF TRANSPORTATION	SCHEDULES				F.A.P. RTE. 786	SECTION (99)RS-3	COUNTY LIVINGSTON	TOTAL SHEETS 14	SHEET NO. 8
	DRAWN -	REVISED -		SCALE:	SHEET	OF	SHEETS	STA.	TO STA.	CONTRACT NO. 66P43		
	CHECKED -	REVISED -		ILLINOIS FED. AID PROJECT								
PLOT DATE = 5/13/2024	DATE -	REVISED -										

ENTRANCES SCHEDULE									
STATION	TYPE	SIDE	MATERIAL	WIDTH FRONT	WIDTH BACK	VARIABLE DEPTH SURF REM	INCIDENTAL HMA SURF	BIT MATL (TACK COAT)	AGG SURF CSE TY B
						SQ YD	TON	POUND	TON
88+05	CE	LT	PCC						
97+11	FE	LT	AGG	25	25				4.7
103+97	PE	RT	HMA/AGG	55	20	41.7	6.2	18.8	
114+26	PE/MBTO	RT	HMA/AGG	65	25	50.0	7.4	22.5	
122+65	FE	RT	AGG	25	25				4.7
123+20	FE	LT	AGG	25	25				4.7
135+87	CE	RT	HMA/AGG	45	20	36.1	5.4	16.3	
141+09	PE	RT	HMA/AGG	50	25	41.7	6.2	18.8	
141+20	MBTO/FE	LT	HMA/AGG	75	25	27.8	4.1	12.5	
150+00	FE	RT	AGG	25	25				4.7
150+05	FE	LT	AGG	25	25				4.7
163+32	FE	RT	AGG	25	25				4.7
163+32	FE	LT	AGG	25	25				4.7
176+37	FE	RT	AGG	25	25				4.7
202+84	FE	RT	AGG	25	25				4.7
216+12	FE	LT	AGG	25	25				4.7
216+24	FE	RT	AGG	25	25				4.7
219+91	CE	LT	HMA/AGG	70	40	275.0	40.8	123.8	
220+37	FE	RT	AGG	25	25				4.7
229+00	FE	RT	AGG	25	25				4.7
237+82	FE	LT	AGG	25	25				4.7
238+28	FE	RT	AGG	25	25				4.7
252+88	PE	RT	HMA/AGG	35	20	30.6	4.5	13.8	
253+25	MBTO	LT	HMA	75	25	33.3	4.9	15.0	
254+60	FE	RT	AGG	25	25				4.7
254+92	PE	LT	AGG	50	35				8.1
257+12	PE	LT	HMA	50	25	41.7	6.2	18.8	
273+46	FE	RT	AGG	25	25				4.7
276+05	FE	LT	AGG	25	25				4.7
293+92	FE	LT	AGG	25	25				4.7
304+58	FE	LT	AGG	25	25				4.7
306+30	FE	LT	AGG	25	25				4.7
306+90	PE	RT	HMA/AGG	80	30	36.7	5.4	16.5	
307+18	MBTO	LT	HMA	70	25	31.7	4.7	14.3	
313+58	FE	LT	AGG	25	25				4.7
313+58	FE	RT	AGG	25	25				4.7
321+23	FE	LT	AGG	25	25				4.7
327+90	PE	RT	HMA/AGG	50	25	41.7	6.2	18.8	
328+00	MTBO	LT	HMA	70	25	52.8	7.8	23.8	
354+77	PE/MBTO	RT	HMA/AGG	75	15	30.0	4.5	13.5	
360+06	PE/MBTO	RT	HMA/AGG	75	20	31.7	4.7	14.3	
369+00	FE	RT	AGG	25	25				4.7
378+03	FE	RT	AGG	25	25				4.7
384+39	FE	LT	AGG	25	25				4.7
408+61	PE	LT	HMA/AGG	40	20				
408+61	MBTO	RT	HMA	75	25	33.3	4.9	15.0	
415+75	PE	LT	HMA/AGG	45	20	36.1	5.4	16.3	
415+75	MBTO	RT	HMA	75	25	33.3			
416+89	FE	LT	AGG	25	25				4.7
426+72	FE	LT	AGG	25	25				4.7
438+69	FE	RT	DIRT	25	25				
440+52	PE/MBTO	RT	HMA/AGG	75	20	52.8	7.8	23.8	
441+52	PE	RT	HMA/AGG	50	20	38.9	5.8	17.5	
444+23	PE	LT	HMA/AGG	45	20	36.1	5.4	16.3	
445+63	PE	LT	HMA/AGG	45	20	36.1	5.4	16.3	
445+63	MBTO	RT	HMA	75	25	33.3	4.9	15.0	
453+33	FE	RT	AGG	25	25	16.7	2.5	7.5	4.7
460+00	FE	LT	AGG	25	25				4.7
460+00	FE	RT	AGG	25	25				4.7
TOTALS						1119	161	489	160

SHORT TERM PAVEMENT MARKINGS					
LOCATION			LENGTH	SHORT TERM PVMT	SHORT TERM PVMT REM
STATION			FOOT	FOOT	SQ FT
84+82	TO	462+00	37718.0	11315.4	1257
TOTAL			37718	11315	1257

*THIS QUANTITY IS FOR 3 APPLICATIONS IF NEEDED.

PAVEMENT MARKING SCHEDULE (NO PASSING ZONES)				
LOCATION			LOCATION	MODIFIED URETHANE (2 APPLICATIONS) LINE 4" YELLOW
STATION			NB / SB	FOOT
84+82	TO	462+00	SB	11190
84+82	TO	462+00	NB	10250
TOTAL				21440

THE RESIDENT ENGINEER SHALL VERIFY THE LOCATIONS OF THE NO PASSING ZONES.

LINEAR DELINEATOR PANEL SCHEDULE						
STRUCTURE NUMBER	SIDE	STRUCTURE CENTERLINE	GUARDRAIL LENGTH	PARAPET LENGTH	LINEAR DELINEATOR PANELS, 4"	LINEAR DELINEATOR PANELS, 6"
		STATION	FT	FT	EACH	EACH
053-2500	LEFT	240+37.00	275.0		5	
053-2500	RIGHT	240+37.00	325.0		6	
053-0162	LEFT	285+65.00	662.5	58.3	10	3
053-0162	RIGHT	285+65.00	325.0	58.3	6	3
053-0163	LEFT	311+16.00	250.0	66.9	5	3
053-0163	RIGHT	311+16.00	325.0	66.9	6	3
053-0164	LEFT	413+41.00	300.0	41.3	6	3
053-0164	RIGHT	413+41.00	325.0	41.3	6	3
053-0165	LEFT	450+45.00	325.0	53.9	6	3
053-0165	RIGHT	450+45.00	325.0	53.9	6	3
TOTAL			3438	440.8	62	24

MODEL: Default
FILE NAME: c:\pwworkspace\plm\sch\1\00743865\Schedules.dgn

USER NAME = timothy.pletsch	DESIGNED -	REVISED -
	DRAWN -	REVISED -
	CHECKED -	REVISED -
PLOT DATE = 5/13/2024	DATE -	REVISED -

STATE OF ILLINOIS
DEPARTMENT OF TRANSPORTATION

SCHEDULES

SCALE: SHEET OF SHEETS STA. TO STA.

F.A.P. RTE. 786	SECTION (99)RS-3	COUNTY LIVINGSTON	TOTAL SHEETS 14	SHEET NO. 9
CONTRACT NO. 66P43				
ILLINOIS FED. AID PROJECT				

ILL RTE 170		IL 23 TO IL 17 MILLING & RESURFACING				LIVINGSTON COUNTY	
GPS NUMBER	DESCRIPTION	APPROXIMATE LOCATION	EXISTING MONUMENT TYPE	PROPOSED MONUMENT TYPE	MONUMENT RECORD TO BE RECORDED	RESPONSIBILITY	
170001	NW CORNER SECTION 10, T30N, R5E, 3RD PM	ILL RTE 17 INTERSECTION	BRASS PLAQUE	NO CHANGE	YES	2	
PI1089688	PI STA 108+96.88	2538' S OF ILL RTE 17	MISSING	MAG SPIKE	NO	2	
170002	W QTR CORNER SECTION 10, T30N, R53, 3RD PM	1/2 MI S OF ILL RTE 17	BRASS PLAQUE	TYPE 1	YES	1	
170003	SW CORNER SECTION 10, T 30N, R5E, 3RD PM	3100 N RD INTERSECTION	BRASS PLAQUE / BURIED RRS	TYPE 1	YES	1	
170004	NE CORNER OF SE QTR OF NE QTR SECTION 16, T30N, R5E, 3RD PM	1/4 MI S OF 3100 N RD	BRASS PLAQUE	TYPE 1	NO	1	
170005	W QTR CORNER SECTION 15, T30N, R5E, 3RD PM	1/2 MI S OF 3100 N RD	MAG NAIL	TYPE 1	YES	1	
170006	NW CORNER SECTION 22, T30N, R5E, 3RD PM	3000 N RD INTERSECTION	MISSING / BURIED RRS	TYPE 1	YES	1	
170007	W QTR CORNER SECTION 22, T30N, R5E, 3RD PM (NEED TO VERIFY)	1/2 MI S OF 3000 N RD	BRASS DISK	TYPE 1	YES	1	
170008	SW CORNER SECTION 22, T 30N, R5E, 3RD PM	2900 N RD INTERSECTION	MISSING	TYPE 1	YES	1	
170009	SW CORNER SECTION 27, T 30N, R5E, 3RD PM	2800 N RD INTERSECTION	BRASS PLAQUE	TYPE 1	YES	1	
170010	W QTR CORNER SECTION 34, T30N, R5E, 3RD PM	1/2 MI S OF 2900 N RD INTERSECTION	MISSING	TYPE 1	YES	1	
170011	SW CORNER SECTION 34, T 30N, R5E, 3RD PM	2700 N RD INTERSECTION	MISSING	TYPE 1	YES	1	
PI3563452	PI STA 356+34.52	856'+/- S OF 2700 N RD INTERSECTION	MISSING	MAG SPIKE	NO	2	
PI3640763	PI STA 364+07.63	1625'+/- S OF 2700 N RD INTERSECTION	MISSING	MAG SPIKE	NO	2	
117013	W QTR CORNER SECTION 3, T29N, R5E, 3RD PM	1/2 MI S OF 2700 N RD INTERSECTION	MISSING	TYPE 1	YES	1	
117014	SW CORNER SECTION 3, T 29N, R5E, 3RD PM	2600 N RD INTERSECTION	BRASS PLAQUE	TYPE 1	YES	1	
117015	W QTR CORNER SECTION 10, T29N, R5E, 3RD PM	1/2 MI S OF 2600 N RD INTERSECTION	MAG NAIL	TYPE 1	YES	1	
PI45200	ORIGINAL PI STA 452+00	125'+/- N OF 2500 N RD INTERSECTION	MISSING	MAG SPIKE	NO	2	
117016	SW CORNER SECTION 10, T 29N, R5E, 3RD PM	2500 N RD INTERSECTION	BRASS PLAQUE	TYPE 1	YES	1	

ONLY THE ORIGINAL SCOPE OF THIS JOB HAS BEEN SEARCHED FOR MONUMENTS. R.E. MUST INFORM PLATS AND PLANS TO SEARCH FOR ADDITIONAL MONUMENTS PRIOR TO MILLING IF ADDENDUMS HAVE BEEN ADDED TO THIS JOB.

R.E. WILL INFORM PLATS AND PLANS WHEN SURFACE IS TO BE MILLED FOR THE PURPOSE OF LOCATING MONUMENTS NOTED AS BURIED.

UNKNOWN MONUMENTS MAY EXIST. IF AN UNLISTED MONUMENT IS FOUND, R.E. IS REQUIRED TO PROTECT THE MONUMENT FROM DAMAGE UNTIL A PLATS AND PLANS LAND SURVEYOR CAN DOCUMENT THE MONUMENT. PLATS AND PLANS WILL RESET SUCH MONUMENTS IN KIND FOLLOWING CONSTRUCTION.

UPON PAVING COMPLETION, R.E. WILL DIRECT PLATS AND PLANS TO STAKE THE TYPE 1 PSM CORING LOCATIONS.

TYPE 1 TOTALS ARE SUBJECT TO CHANGE BASED ON THE RESULTS OF THE MILLED ROAD MONUMENTS SEARCH.

NOTE: FOR BIDDING PURPOSES, NO CONTRACTED LAND SURVEYING SERVICES WILL BE REQUIRED FOR SETTING THE LISTED PERMANENT SURVEY MARKERS. PLATS AND PLANS WILL PREPARE THE REQUIRED MONUMENT RECORDS.

RESPONSIBILITY:

- 1) RESIDENT TO RE-ESTABLISH MONUMENT (PAY ITEM REQUIRED. PERMANENT SURVEY MARKER, TYPE 1)
- 2) PLATS AND PLANS TO RE-ESTABLISH MONUMENT

MODEL: Default
FILE NAME: c:\pwworking\platsch\rd0074386\Schedules.dgn

USER NAME = timothy.platsch	DESIGNED -	REVISED -	STATE OF ILLINOIS DEPARTMENT OF TRANSPORTATION	SCHEDULES			F.A.P. RTE.	SECTION	COUNTY	TOTAL SHEETS	SHEET NO.
	DRAWN -	REVISED -					786	(99)RS-3	LIVINGSTON	14	10
	CHECKED -	REVISED -		CONTRACT NO. 66P43							
PLOT DATE = 5/13/2024	DATE -	REVISED -		SCALE:	SHEET OF SHEETS	STA. TO STA.	ILLINOIS FED. AID PROJECT				

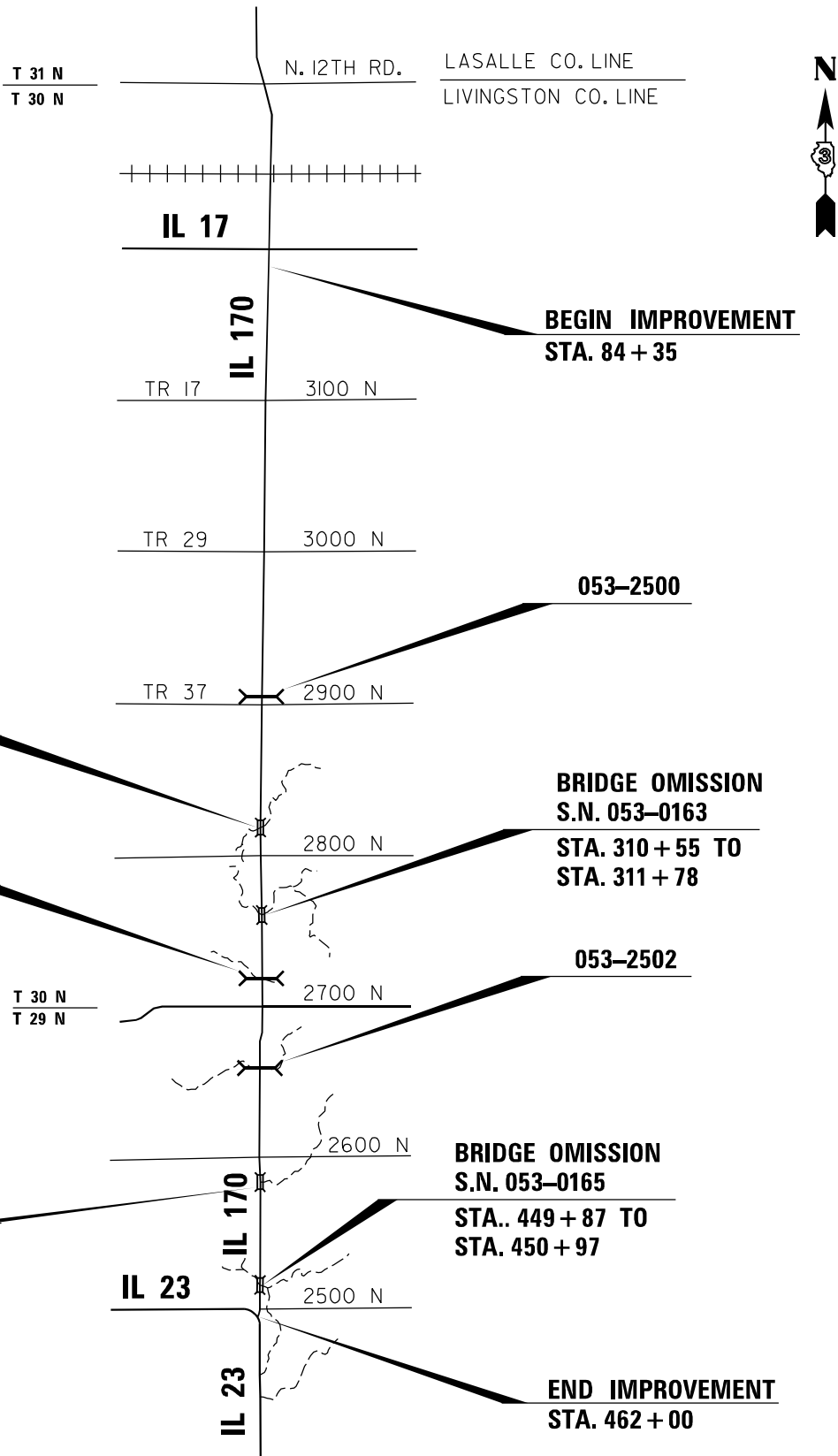

EX CURVE
 PI STA = 364+07.36
 $\Delta = 08^{\circ}09'28''$ (LT)
 $D = 01^{\circ}18'19''$
 $R = 4,389.57'$
 $T = 313.02'$
 $L = 624.99'$
 $E = 11.15'$
 $e =$
 PC STA = 360+94.34
 PT STA = 367+19.32

EX CURVE
 PI STA = 356+34.30
 $\Delta = 07^{\circ}55'08''$ (RT)
 $D = 02^{\circ}20'38''$
 $R = 2,444.55'$
 $T = 169.20'$
 $L = 337.86'$
 $E = 5.85'$
 $e =$
 PC STA = 354+65.10
 PT STA = 358+02.96

EX CURVE
 PI STA = 455+27.28
 $\Delta = 36^{\circ}17'13''$ (RT)
 $D = 05^{\circ}00'10''$
 $R = 1,145.29'$
 $T = 375.30'$
 $L = 725.34'$
 $E = 59.92'$
 $e =$
 PC STA = 451+51.98
 PT STA = 458+77.32

MODEL: Default
 FILE NAME: c:\pwworkspace\platachir\0074385D366P43 Line Diagram.dgn

USER NAME = Anthony.Grunstad	DESIGNED -	REVISED -
	DRAWN -	REVISED -
PLOT SCALE = \$SCALE\$	CHECKED -	REVISED -
PLOT DATE = 5/8/2024	DATE -	REVISED -

**STATE OF ILLINOIS
 DEPARTMENT OF TRANSPORTATION**

PROJECT LAYOUT			
SCALE:	SHEET	OF SHEETS	STA. TO STA.

F.A.P. RTE.	SECTION	COUNTY	TOTAL SHEETS	SHEET NO.
786	(99)RS-3	LIVINGSTON	14	11
CONTRACT NO. 66P43				
		ILLINOIS	FED. AID PROJECT	

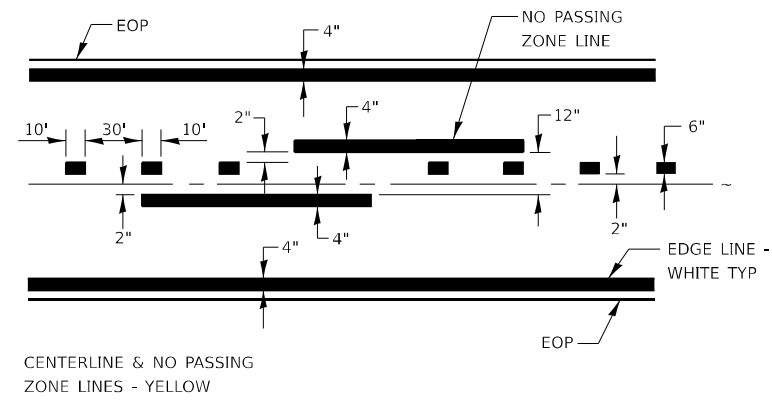

PAVEMENT MARKING

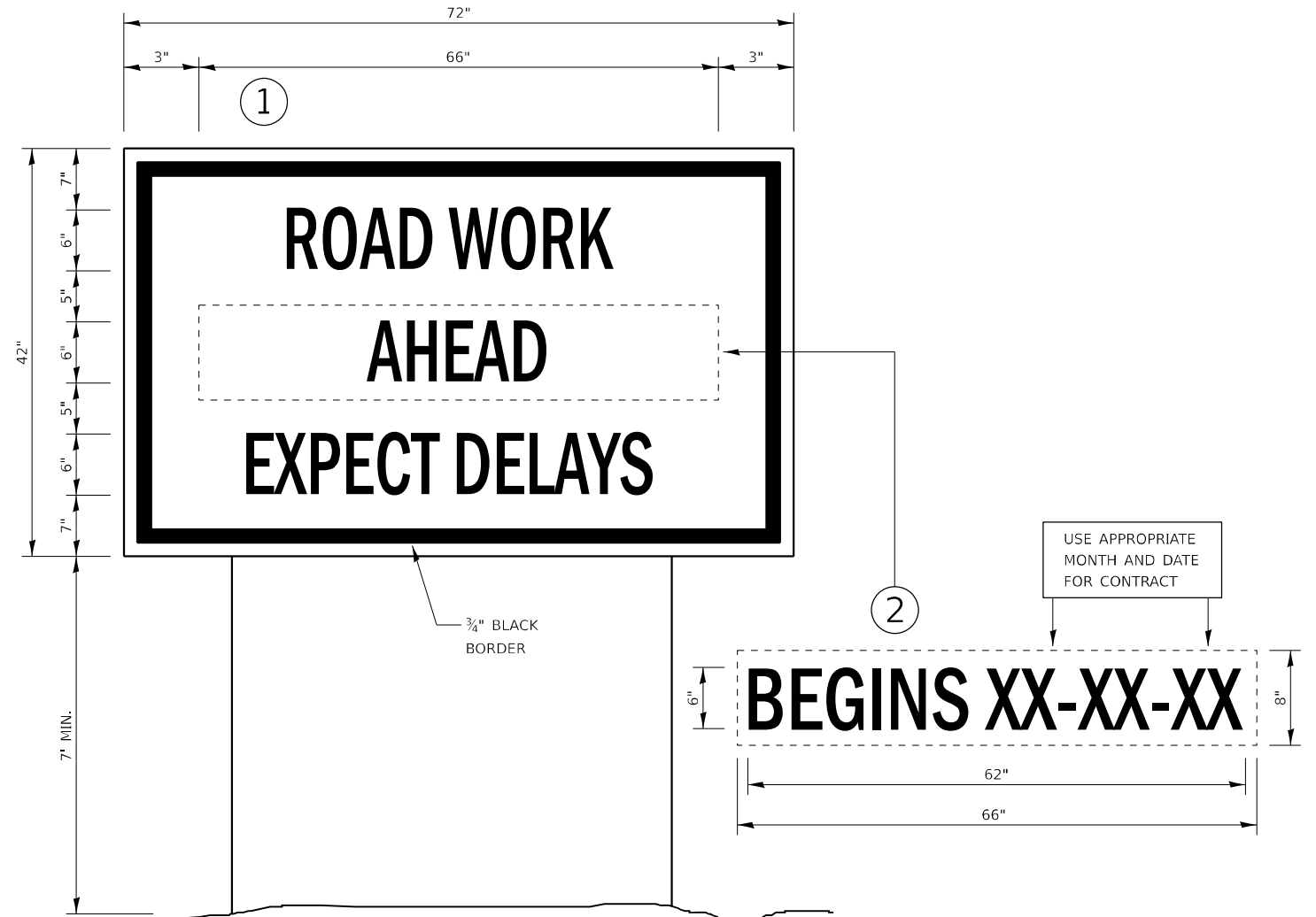

TEMPORARY INFORMATION SIGNING

NOTES:

- USE 6" D BLACK LETTERING ON FLUORESCENT ORANGE BACKGROUND.
- ERECT SIGNS AT LOCATIONS IN ADVANCE OF THE "ROAD CONSTRUCTION AHEAD" SIGNS AS DIRECTED BY THE ENGINEER.
- ERECT SIGN ① WITH INSTALLED PANEL ② A MINIMUM OF ONE WEEK PRIOR TO THE START OF THE LANE CLOSURE.
- REMOVE PANEL ② ON THAT DATE.
- SEE SPECIAL PROVISION "TEMPORARY INFORMATION SIGNING" FOR ADDITIONAL INFORMATION.
- WILL BE PAID FOR PER SQ FT AS "TEMPORARY INFORMATION SIGNING". EACH SIGN = 21 SQ FT AND THE DATE PANEL ② WILL NOT BE MEASURED SEPARATELY FOR PAYMENT.

MODEL: D:\info...
 FILE NAME: ...

USER NAME = tlmthy.zletsch	DESIGNED -	REVISED -
	DRAWN -	REVISED -
PLOT SCALE = \$\$SCALE\$	CHECKED -	REVISED -
PLOT DATE = 5/13/2024	DATE -	REVISED -

**STATE OF ILLINOIS
DEPARTMENT OF TRANSPORTATION**

DETAILS			
SCALE:	SHEET	OF	SHEETS
	STA.		TO STA.

F.A.P. RTE.	SECTION	COUNTY	TOTAL SHEETS	SHEET NO.
786	(99)RS-3	LIVINGSTON	14	13
			CONTRACT NO. 66P43	
		ILLINOIS	FED. AID PROJECT	

Long Section Number

