

F.A.I. RTE.	SECTION	COUNTY	TOTAL SHEETS	SHEET NO.
55	99(1&2)RS-10	WILL	18	7
STA.		TO STA.		
FED. ROAD DIST. NO.	ILLINOIS	FED. AID PROJECT		

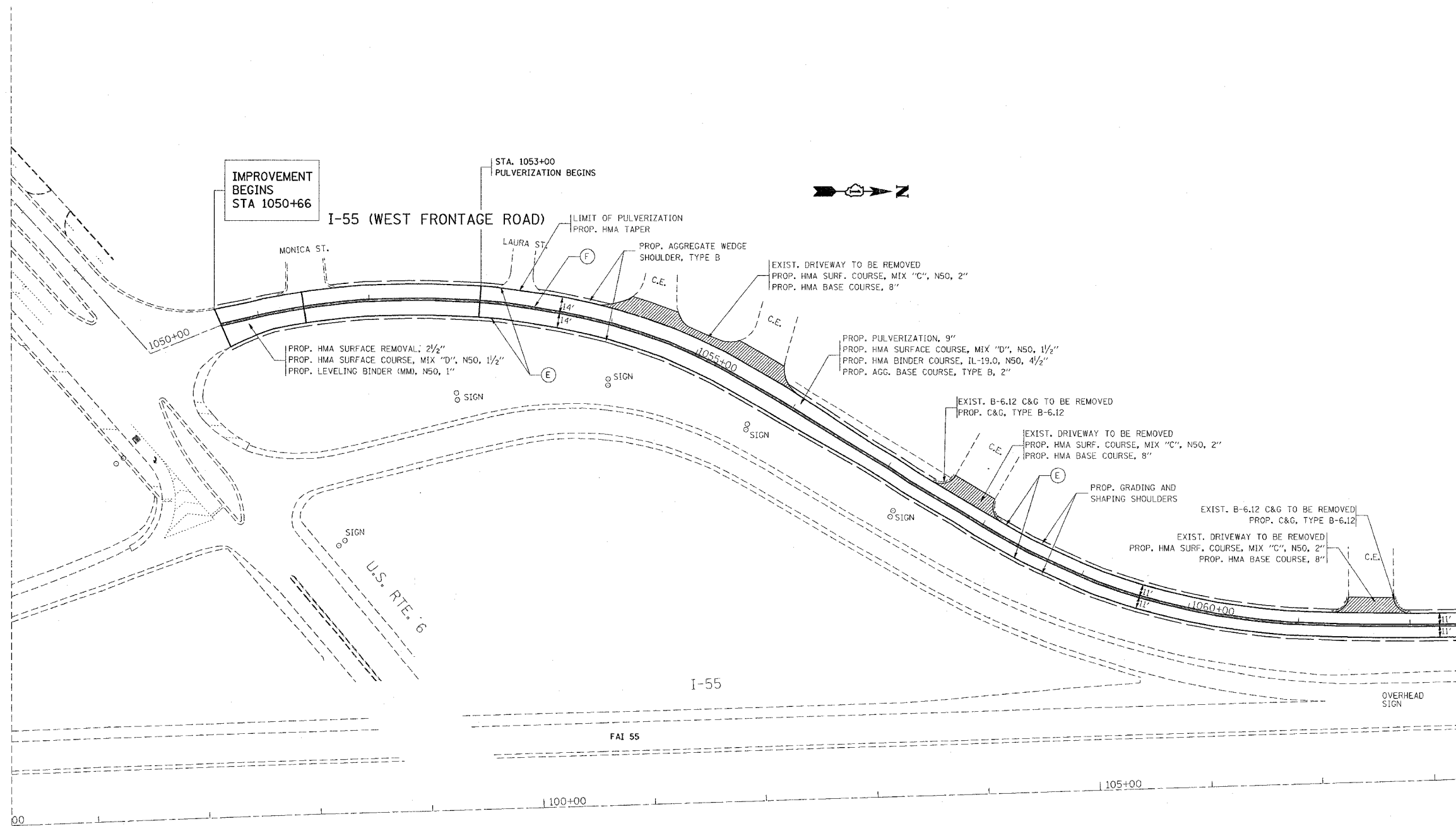

- (A) SKIP-DASH CENTERLINE - 4" YELLOW (TYP.)
(10' DASH & 30' SKIP)
- (B) SKIP-DASH CENTERLINE - 4" YELLOW (TYP.)
(10' DASH & 30' SKIP)
(@ 5 1/2" C-C FROM NO PASSING ZONE LINE)
- (C) NO PASSING ZONE LINE - 4" YELLOW (TYP.)
(@ 5 1/2" C-C FROM SKIP-DASH)
- (D) STOP LINE - 24" SOLID WHITE (TYP.)
- (E) EDGE LINE - 4" SOLID WHITE (TYP.)
- (F) DOUBLE YELLOW CENTERLINE - 4" SOLID YELLOW (TYP.)
(2 @ 11" C-C)

REVISIONS	
NAME	DATE

ILLINOIS DEPARTMENT OF TRANSPORTATION
**I-55 WEST FRONTAGE ROAD
 ROADWAY AND PAVEMENT
 MARKING PLAN**

SCALE: VERT.
 HORIZ.
 DATE

DRAWN BY
 CHECKED BY

PLOT DATE = 6/15/2007
 FILE NAME = I:\1050\1050\1050\1050.dwg
 PLOT SCALE = 5/8" = 1' IN.
 USER NAME = smtsh1