

F.A.P. RTE.	SECTION	COUNTY	TOTAL SHEETS	SHEET NO.
335	119R-2	LAKE	439	50
STA. 432+83.12		TO STA. 470+56.84		
FED. ROAD DIST. NO.		ILLINOIS FED. AID PROJECT		

60B01

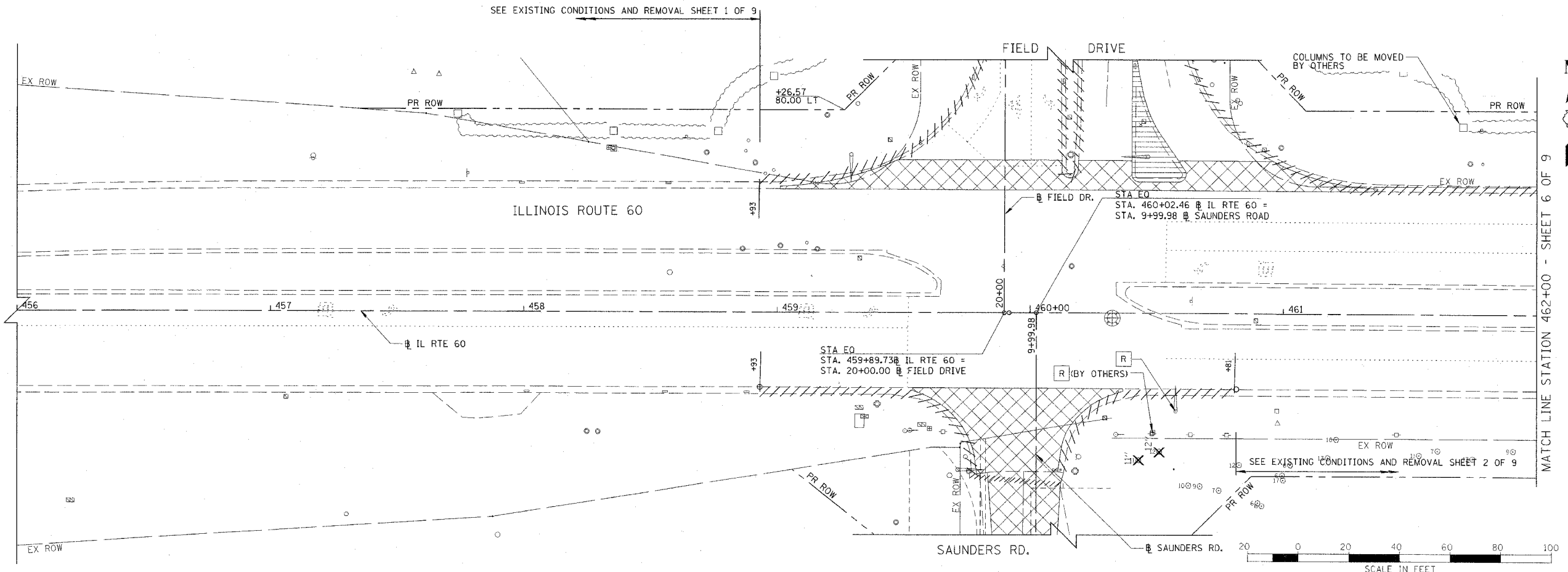

- LEGEND:
- CONC CURB & GUTTER REMOVAL
 - PAVEMENT REMOVAL
 - ISLAND REMOVAL
 - RELOCATE EXISTING ROADSIDE FEATURE
 - TREE REMOVAL
 - REMOVAL

REVISIONS	
NAME	DATE

ILLINOIS DEPARTMENT OF TRANSPORTATION
 ILLINOIS RTE 60 OVER I-94
 IL RTE 60
 EXISTING CONDITIONS AND REMOVAL
 STA. 458+93.00 TO STA. 462+00.00
 SHEET 5 OF 9

SCALE: 1"=20'
 DATE: MAY 8, 2007
 DRAWN BY: GT
 CHECKED BY: MCW

CB CHRISTOPHER B. BURKE ENGINEERING LTD.
 9275 West Higgins Road, Suite 600
 Rosemont, Illinois 60018
 (847) 823-0500

A:\Users\Fred\03192\CH\1103992_RT\60R2P1EM 5/2/2007 9:25:32 AM