

F.A.P. RTE.	SECTION	COUNTY	TOTAL SHEETS	SHEET NO.
335	119R-2	LAKE	439	94
STA. 432+83.12		TO STA. 470+56.84		
FED. ROAD DIST. NO.	ILLINOIS FED. AID PROJECT		60B01	

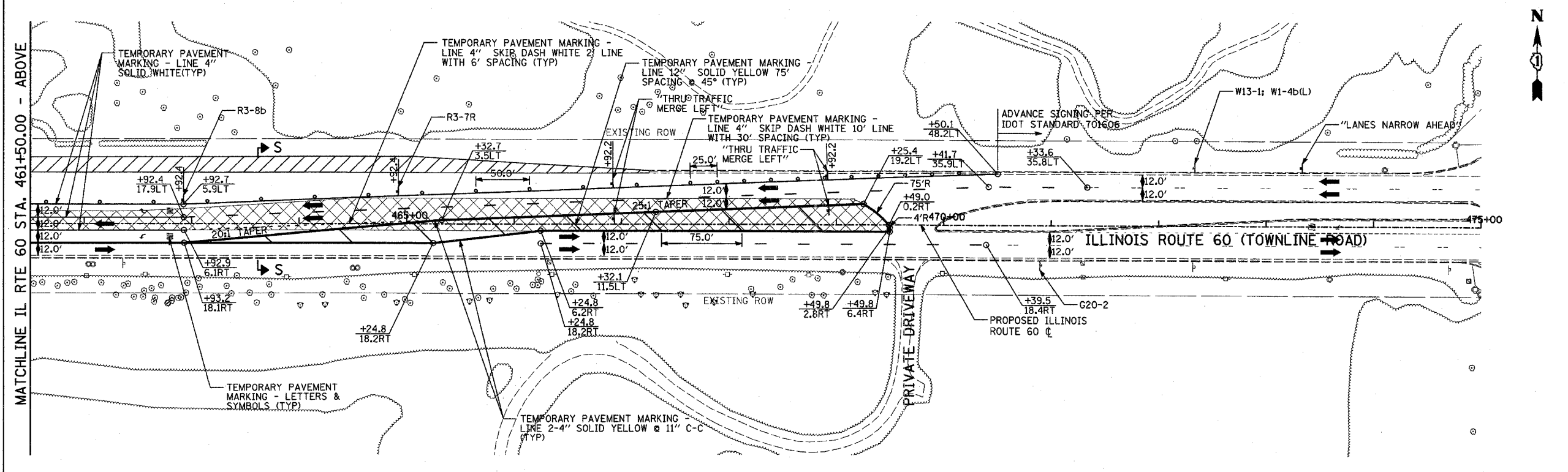
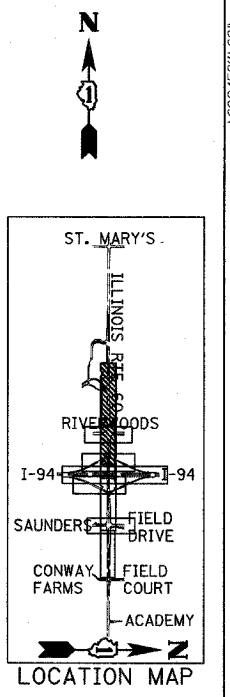

**LEGEND:**

- CONSTRUCTION ZONE
- TEMPORARY PAVEMENT
- TRAFFIC MOVEMENT
- TEMPORARY SIGN (SEE M.O.T. SIGNING LEGEND)
- TYPE II BARRICADES OR DRUMS W/ MONO-DIRECTIONAL STEADY BURNING LIGHT
- TYPE III BARRICADE W/2 FLASHING BIDIRECTIONAL LIGHTS
- TEMPORARY CONCRETE BARRIER
- ARROW BOARD
- M.O.T. APPURTENANCES REMAINING FROM PREVIOUS STAGES

50 0 50 100  
SCALE: 1" = 50'-0"

REVISIONS	
NAME	DATE

ILLINOIS DEPARTMENT OF TRANSPORTATION  
ILLINOIS RTE 60 OVER I-94  
MAINTENANCE OF TRAFFIC PLAN  
IL RTE 60 STA. 446+50.00 TO 475+00.00  
STAGE 1 - SHEET 2 OF 5

SCALE: 1"=50'-0"  
DATE: MAY 8, 2007

DRAWN BY: MPG, CBS  
CHECKED BY: JDF

TYLIN INTERNATIONAL

05/08/2007 10:56:10 AM