

F.A.P. RTE.	SECTION	COUNTY	TOTAL SHEETS	SHEET NO.
335	119R-2	LAKE	439	116
STA. 432+83.12		TO STA. 470+56.84		
FED. ROAD DIST. NO.		ILLINOIS FED. AID PROJECT		60B01

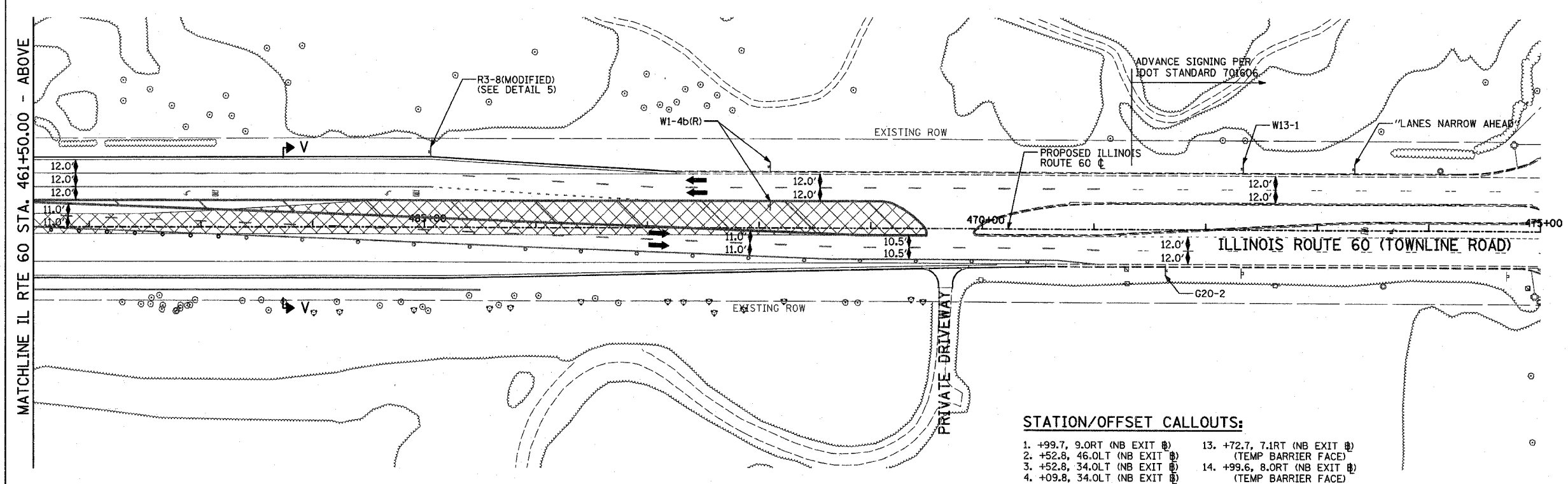

LEGEND:

- CONSTRUCTION ZONE
- TEMPORARY PAVEMENT
- TRAFFIC MOVEMENT
- TEMPORARY SIGN (SEE M.O.T. SIGNING LEGEND)
- TYPE II BARRICADES OR DRUMS W/ MONO-DIRECTIONAL STEADY BURNING LIGHT
- TYPE III BARRICADE W/2 FLASHING BIDIRECTIONAL LIGHTS
- TEMPORARY CONCRETE BARRIER
- ARROW BOARD
- M.O.T. APPURTENANCES REMAINING FROM PREVIOUS STAGES

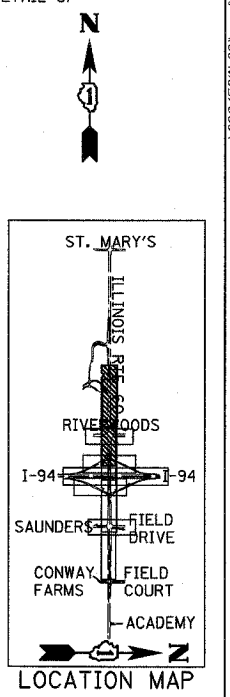
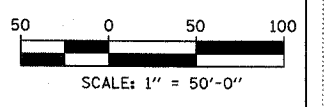

STATION/OFFSET CALLOUTS:

1. +99.7, 9.0RT (NB EXIT #)	13. +72.7, 7.1RT (NB EXIT #)
2. +52.8, 46.0LT (NB EXIT #)	(TEMP BARRIER FACE)
3. +52.8, 34.0LT (NB EXIT #)	14. +99.6, 8.0RT (NB EXIT #)
4. +09.8, 34.0LT (NB EXIT #)	(TEMP BARRIER FACE)
5. +09.8, 46.0LT (NB EXIT #)	15. +10.2, 3.0LT (NB EXIT #)
6. +04.8, 12.0LT (NB EXIT #)	16. +10.3, 10.1RT (NB EXIT #)
7. +99.0, 15.2LT (NB EXIT #)	(TEMP BARRIER FACE)
(TEMP BARRIER FACE)	17. +42.0, 15.9LT
8. +04.8, 0.0RT (NB EXIT #)	18. +52.8, 59.1LT (NB EXIT #)
9. +10.2, 7.1RT (NB EXIT #)	19. +47.1, 69.7LT (NB EXIT #)
10. +34.7, 1.5RT (NB EXIT #)	20. NOT USED
11. +35.9, 10.4LT (NB EXIT #)	21. +97.4, 68.4LT (NB EXIT #)
12. +41.3, 12.9LT (NB EXIT #)	22. +48.2, 46.0LT (NB EXIT #)
(TEMP BARRIER FACE)	

REVISIONS	
NAME	DATE

ILLINOIS DEPARTMENT OF TRANSPORTATION
 ILLINOIS RTE 60 OVER I-94
 MAINTENANCE OF TRAFFIC PLAN
 IL RTE 60 STA. 446+50.00 TO 475+00.00
 STAGE 3A - SHEET 2 OF 5

SCALE: 1"=50'-0"
 DATE: MAY 8, 2007

DRAWN BY: MPC, CBS
 CHECKED BY: JDF

TYLIN INTERNATIONAL

05/02/2007 10:30:18 AM