

MATCHLINE SB I-94 EXIT RAMP STA. 116+25.00 - SHEET 3 OF 4

F.A.P. RTE.	SECTION	COUNTY	TOTAL SHEETS	SHEET NO.
335	119R-2	LAKE	439	138
STA. 432+83.12		TO STA. 470+56.84		
FED. ROAD DIST. NO.		ILLINOIS FED. AID PROJECT		

60801

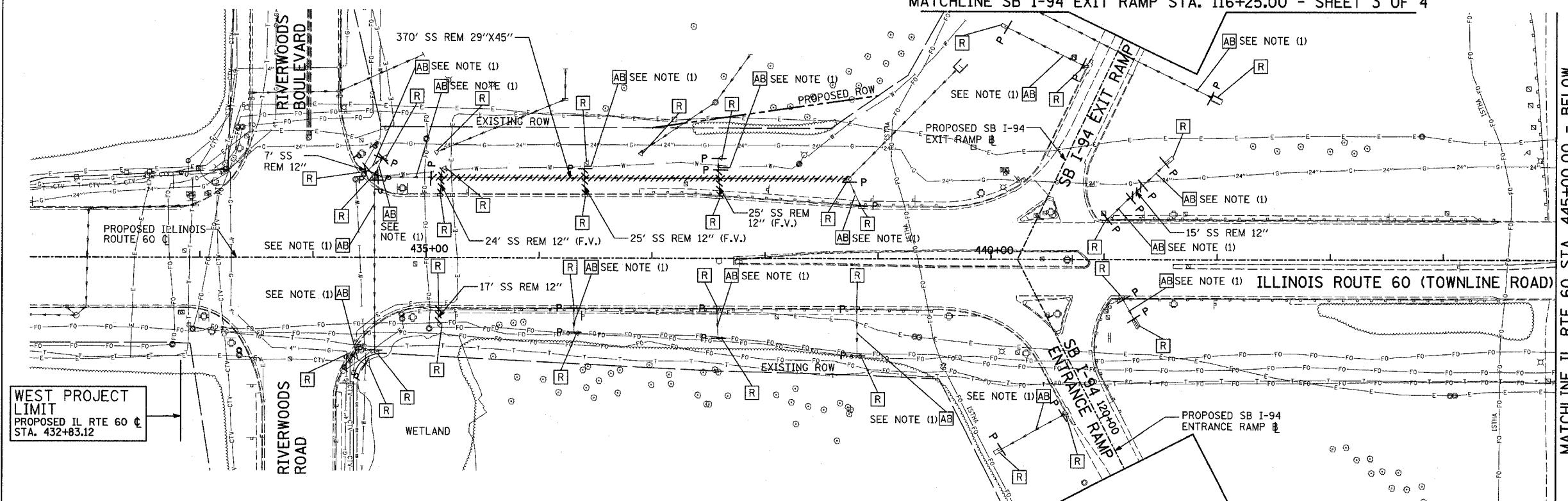

- LEGEND:**
- P SEWER PLUG
  - F.V. FIELD VERIFY
  - STORM SEWER REMOVAL
  - END SECTION

- NOTES:**
1. ABANDONED SEWER TO BE FILLED WITH CONTROLLED LOW STRENGTH MATERIAL. SEE SCHEDULE FOR DETAILS.

WEST PROJECT LIMIT  
PROPOSED IL RTE 60 CL  
STA. 432+83.12

MATCHLINE NB I-94 ENTRANCE RAMP STA. 202+25.00 - SHEET 4 OF 4

MATCHLINE SB I-94 ENTRANCE RAMP STA. 120+50.00 - SHEET 3 OF 4

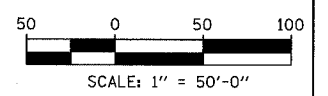
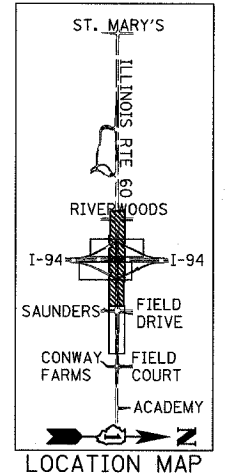
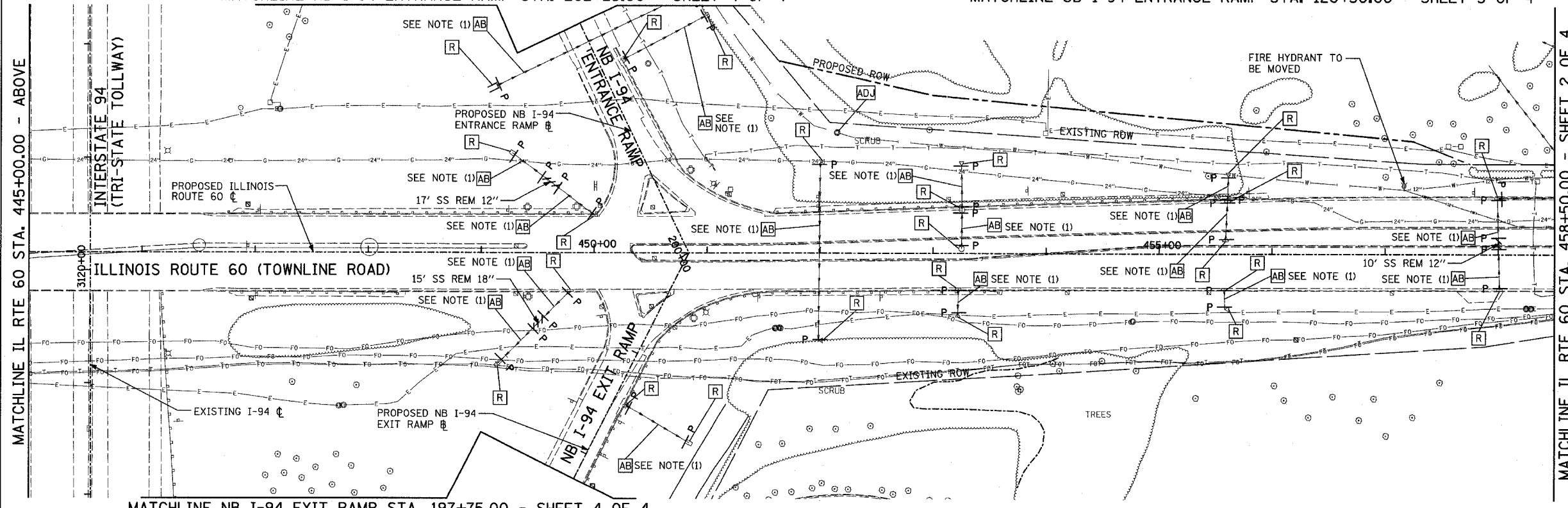

MATCHLINE NB I-94 EXIT RAMP STA. 197+75.00 - SHEET 4 OF 4

MATCHLINE IL RTE 60 STA. 445+00.00 - ABOVE

MATCHLINE IL RTE 60 STA. 458+50.00 - SHEET 2 OF 4

TYLIN INTERNATIONAL

REVISIONS	
NAME	DATE

ILLINOIS DEPARTMENT OF TRANSPORTATION  
ILLINOIS RTE 60 OVER I-94  
EXISTING UTILITIES AND  
DRAINAGE REMOVAL PLAN  
IL RTE 60 STA. 432+83.12 TO 458+50.00  
SHEET 1 OF 4

SCALE: 1"=50'-0"  
DATE: MAY 8, 2007  
DRAWN BY: NSB  
CHECKED BY: DA

05/08/2007 07:43:07 AM