

F.A.P. RTE.	SECTION	COUNTY	TOTAL SHEETS	SHEET NO.
335	119R-2	LAKE	439	233
STA.	TO STA.			
FED. ROAD DIST. NO.	ILLINOIS	FED. AID PROJECT		

60B01

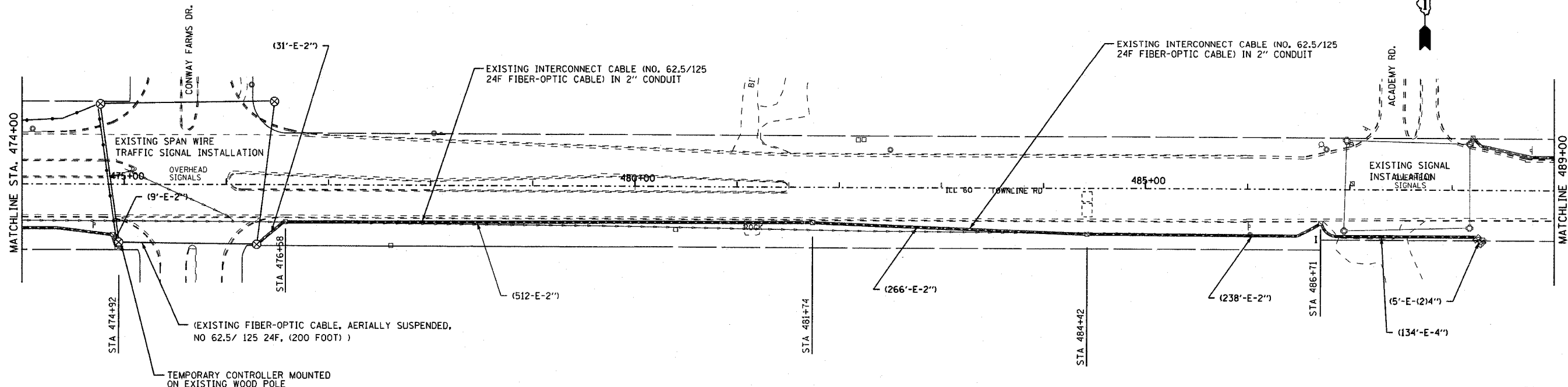

USE EXISTING FIBER OPTIC 12F CABLE FOR TEMPORARY INTERCONNECT - FROM ST. MARY'S ROAD CONTROLLER CABINET TO RIVERWOODS ROAD CONTROLLER CABINET, ALL STAGES.

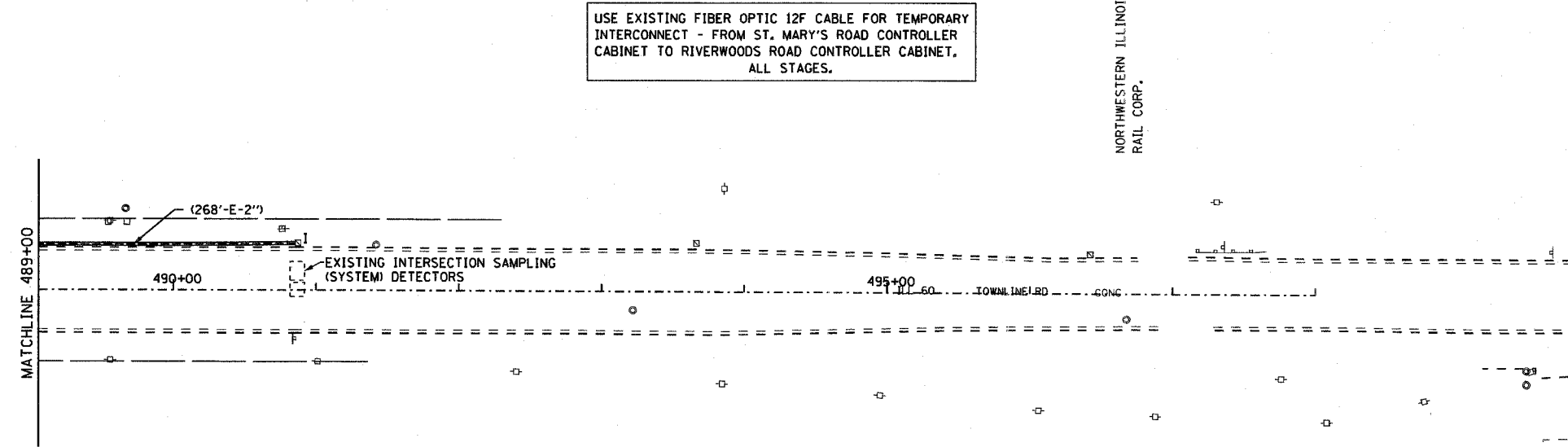

EJM ENGINEERING, INC.
411 South Wells Street Suite 800
Chicago, Illinois 60607

REVISIONS	
NAME	DATE

ILLINOIS DEPARTMENT OF TRANSPORTATION
TEMPORARY INTERCONNECT PLAN
ILL ROUTE 60
ST. MARY'S ROAD TO ACADEMY DRIVE
STAGES 3, 3A, 4, 5

S.N.
SCALE: 1" = 50'-0"
DATE: MAY 8, 2007

DESIGNED BY: JM
DRAWN BY: PK
CHECKED BY: CK