

F.A.P. RTE.	SECTION	COUNTY	TOTAL SHEETS	SHEET NO.
335	119R-2	LAKE	439	242
STA.	438+00	TO STA.	445+00	
FED. ROAD DIST. NO.	ILLINOIS	FED. AID PROJECT		

60B01

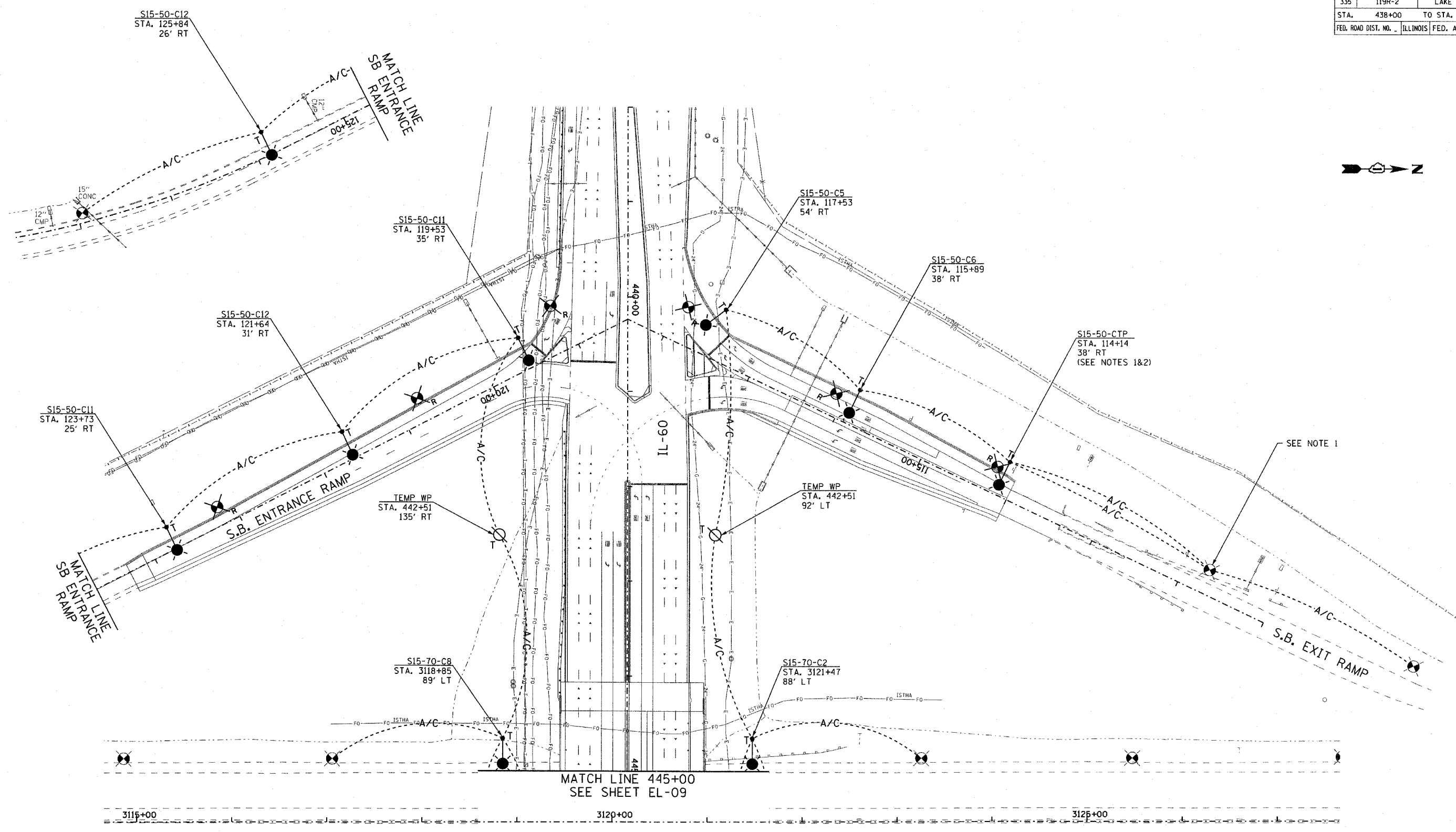

SEE NOTE 1

- NOTES:**
1. ATTACH AERIAL CABLE TO LIGHT POLE BUT DO NOT CONNECT AERIAL CABLE TO LIGHT POLE CIRCUITRY. ANY DAMAGE CAUSED BY CONNECTING THIS CIRCUIT WILL BE REPAIRED AT THE CONTRACTOR'S EXPENSE.
 2. CONNECT POLE TO EXISTING TOLL PLAZA CIRCUITRY FROM THE NORTH.

EJM ENGINEERING, INC.
 411 South Wells Street Suite 800
 Chicago, Illinois 60607

REVISIONS	
NAME	DATE

ILLINOIS DEPARTMENT OF TRANSPORTATION
 ILLINOIS RTE 60 OVER I-94
 TEMPORARY ROADWAY LIGHTING PLAN
 I-94 SOUTHBOUND RAMP

S.N. _____ DESIGNED BY: JDM
 SCALE: 1"=50'-0" DRAWN BY: JDM
 DATE: MAY 8, 2007 CHECKED BY: RES