

F.A.P. RTE.	SECTION	COUNTY	TOTAL SHEETS	SHEET NO.
335	119R-2	LAKE	439	367
STA. 432+83.12		TO STA. 470+56.84		
FED. ROAD DIST. NO.	ILLINOIS	FED. AID PROJECT		
	120	130	140	150
				60B01

NOTE: PRE-STAGE EARTHWORK ADDITIONS/SUBTRACTIONS ARE NOT INCLUDED IN THE EARTHWORK QUANTITIES FOR EACH CROSS SECTION (SEE EARTHWORK SCHEDULE FOR BREAKDOWN OF QUANTITIES BY STAGE)

EARTHWORK QUANTITIES (SF)
 EXCAVATION = 55.0
 UNSUITABLE = 74.3
 EMBANKMENT = 418.1
 EXC.(SPECIAL) = 38.5

EARTHWORK QUANTITIES (SF)
 EXCAVATION = 59.4
 UNSUITABLE = 72.3
 EMBANKMENT = 410.8
 EXC.(SPECIAL) = 31.4

PROFILE	DATE
BY	
DATE	
NO.	
NO.	

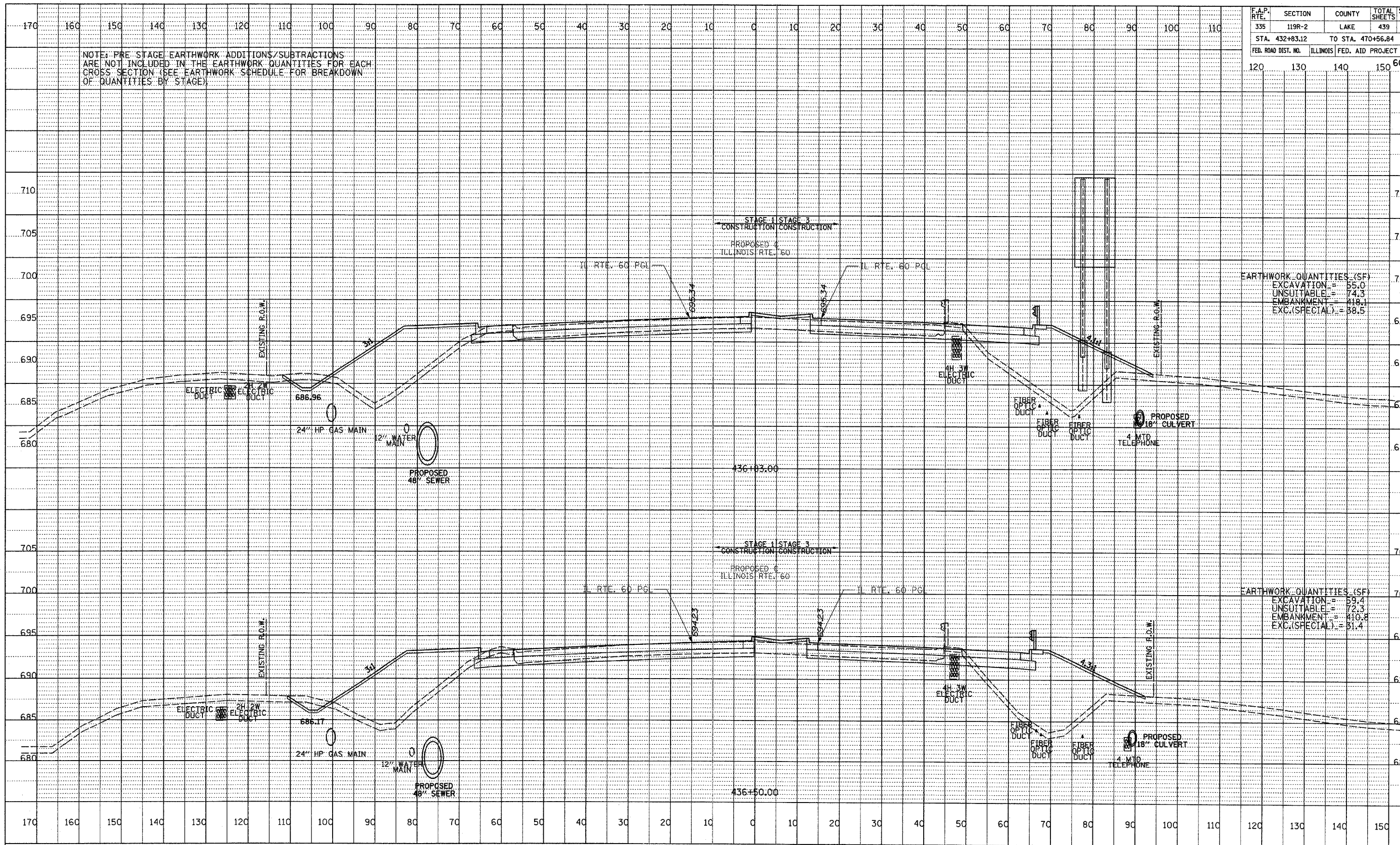

TYL INTERNATIONAL

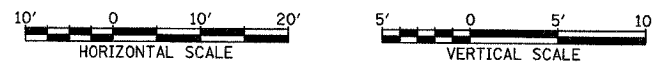

ILLINOIS RTE. 60 (TOWNLIN RD)
 STA. 436+50 TO STA. 436+83

P:\60245\81L60\Road\Wpk60\ssfdwg.dwg 5/7/2007 9:25:33 AM