

F.A.P. RTE.	SECTION	COUNTY	TOTAL SHEETS	SHEET NO.
335	119R-2	LAKE	439	372
STA. 432+83.12		TO STA. 470+56.84		
FED. ROAD DIST. NO.		ILLINOIS	FED. AID PROJECT	
120	130	140	150	60B01

NOTE: PRE-STAGE EARTHWORK ADDITIONS/SUBTRACTIONS ARE NOT INCLUDED IN THE EARTHWORK QUANTITIES FOR EACH CROSS SECTION (SEE EARTHWORK SCHEDULE FOR BREAKDOWN OF QUANTITIES BY STAGE).

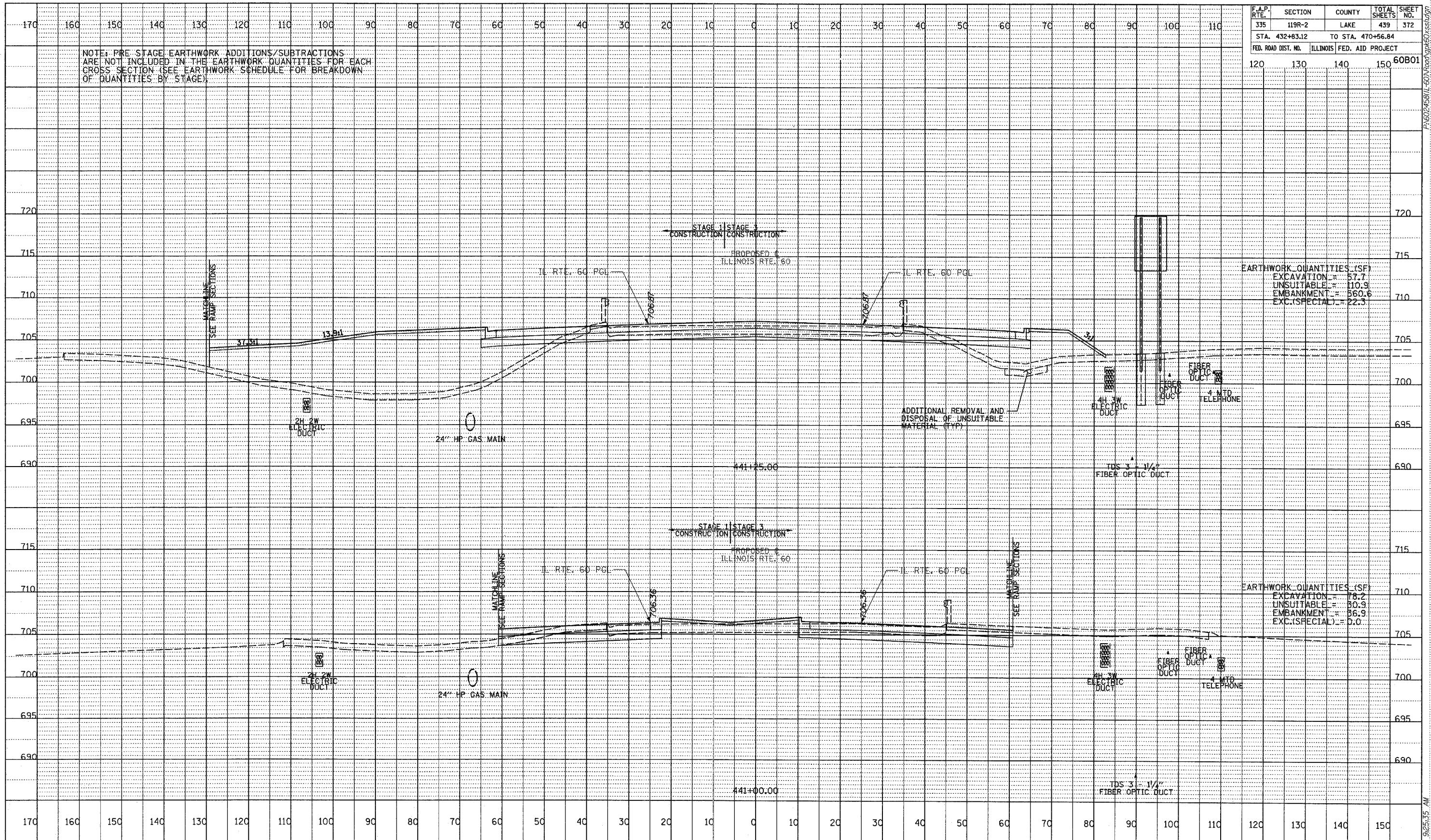

PROFILE DRAWN BY: \_\_\_\_\_ DATE: \_\_\_\_\_  
 CHECKED BY: \_\_\_\_\_  
 NOTE BOOK NO.: \_\_\_\_\_  
 STRUCTURE NOTES OFFICE

TYLINT INTERNATIONAL

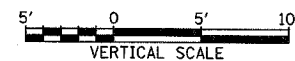
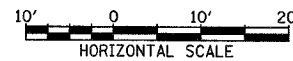

ILLINOIS RTE. 60 (TOWNLIN RD)  
 STA. 441+00 TO STA. 441+25

PA602456/11-60/road/1p4k60-rss1ad7r 9:25:35 AM 5/7/2001