

170 160 150 140 130 120 110 100 90 80 70 60 50 40 30 20 10 0 10 20 30 40 50 60 70 80 90 100 110

F.A.P. RTE.	SECTION	COUNTY	TOTAL SHEETS	SHEET NO.
335	119R-2	LAKE	439	379
STA. 432+83.12	TO STA. 470+56.84		60B01	
FED. ROAD DIST. NO.	ILLINOIS	FED. AID PROJECT		
120	130	140	150	

NOTE: PRE-STAGE EARTHWORK ADDITIONS/SUBTRACTIONS ARE NOT INCLUDED IN THE EARTHWORK QUANTITIES FOR EACH CROSS SECTION (SEE EARTHWORK SCHEDULE FOR BREAKDOWN OF QUANTITIES BY STAGE).

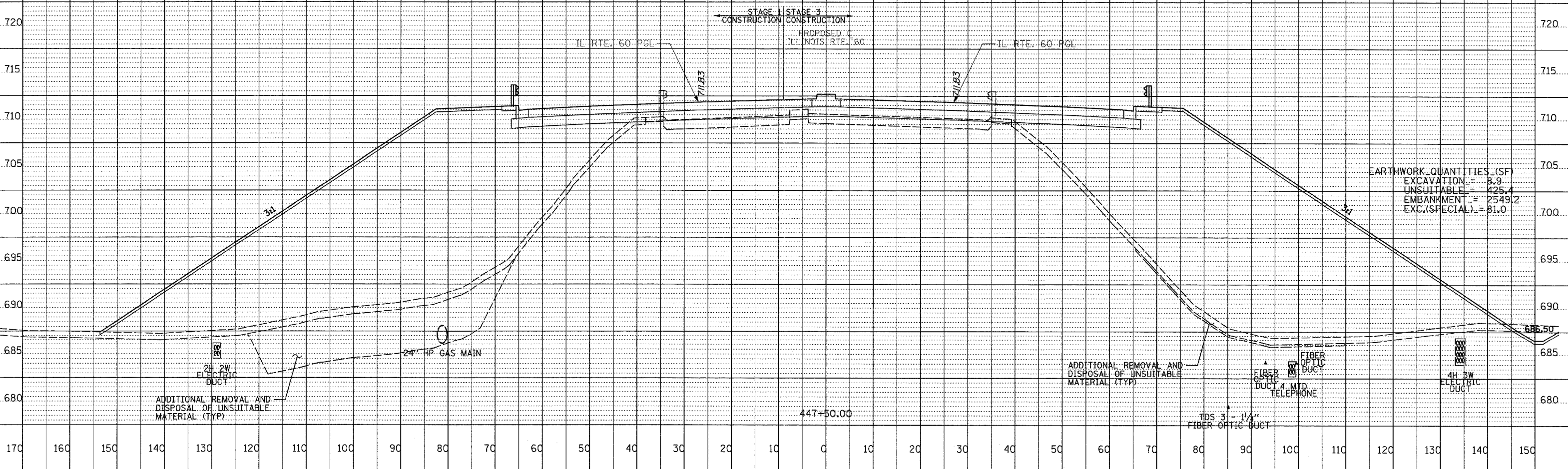

EARTHWORK QUANTITIES (SF)

EXCAVATION	= 8.9
UNSUITABLE	= 125.4
EMBANKMENT	= 2549.2
EXC.(SPECIAL)	= 81.0

ADDITIONAL REMOVAL AND DISPOSAL OF UNSUITABLE MATERIAL (TYP)

ADDITIONAL REMOVAL AND DISPOSAL OF UNSUITABLE MATERIAL (TYP)

FIBER OPTIC DUCT
FIBER OPTIC DUCT 4 MTD TELEPHONE

4H 3W ELECTRIC DUCT

447+50.00

TDS 3' - 1/4" FIBER OPTIC DUCT

