

F.A.P. RTE.	SECTION	COUNTY	TOTAL SHEETS	SHEET NO.
335	119R-2	LAKE	439	391
STA. 432+83.12		TO STA. 470+56.84		
FED. ROAD DIST. NO.		ILLINOIS FED. AID PROJECT		
120	130	140	150	60B01

NOTE: PRE-STAGE EARTHWORK ADDITIONS/SUBTRACTIONS ARE NOT INCLUDED IN THE EARTHWORK QUANTITIES FOR EACH CROSS SECTION (SEE EARTHWORK SCHEDULE FOR BREAKDOWN OF QUANTITIES BY STAGE).

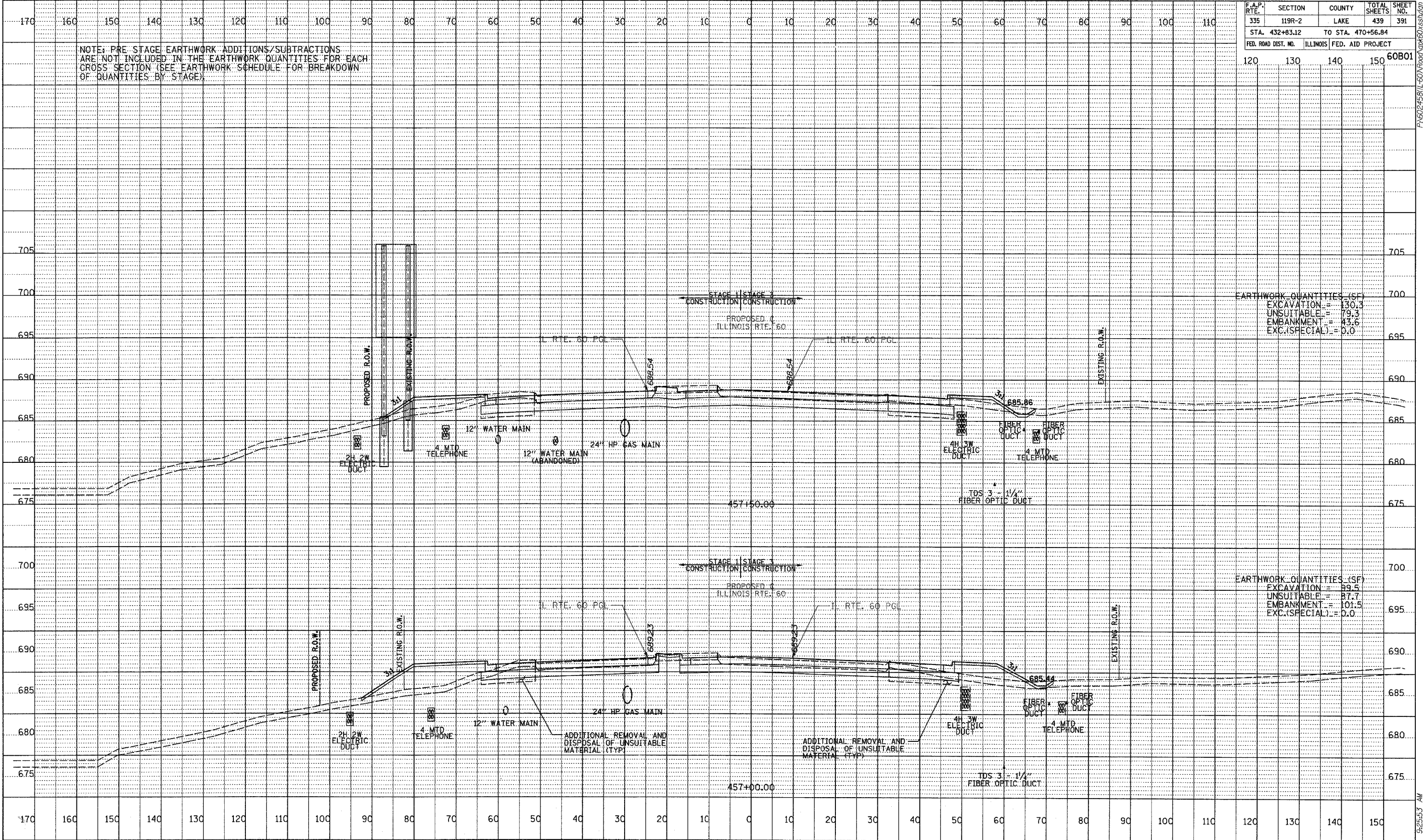

EARTHWORK QUANTITIES (SF)
 EXCAVATION = 130.3
 UNSUITABLE = 79.3
 EMBANKMENT = 43.6
 EXC.(SPECIAL) = 0.0

EARTHWORK QUANTITIES (SF)
 EXCAVATION = 99.5
 UNSUITABLE = 87.7
 EMBANKMENT = 101.5
 EXC.(SPECIAL) = 0.0

DATE	BY
PROFILE SURVEYED	GRADE CHECKED
NOTE BOOK NO.	STRUCTURE NOTATIONS CHECKED

TYLINT INTERNATIONAL

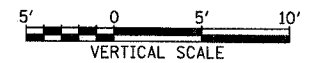

ILLINOIS RTE. 60 (TOWNLINE RD)
 STA. 457+00 TO STA. 457+50

PAGE 45B/ILL-60/Townline Rd/457+00 to 457+50 9/25/07 5:17:20 PM