

F.A.P. RTE.	SECTION	COUNTY	TOTAL SHEETS	SHEET NO.
335	119R-2	LAKE	439	402
STA. 432+83.12		TO STA. 470+56.84		
FED. ROAD DIST. NO.		ILLINOIS FED. AID PROJECT		
120	130	140	150	60B01

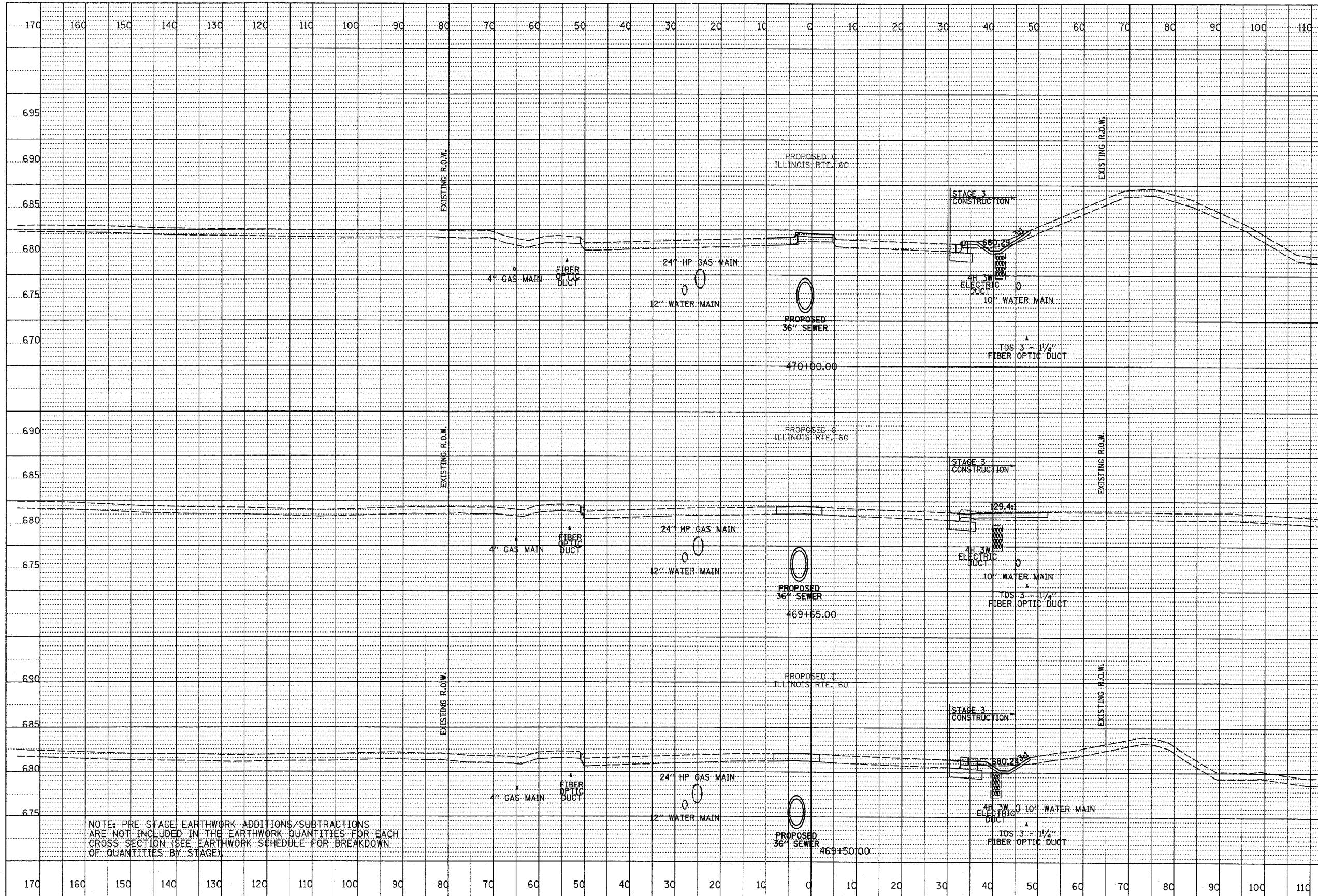

EARTHWORK QUANTITIES (SF)	
EXCAVATION	= 9.0
UNSUITABLE	= 10.5
EMBANKMENT	= 1.0
EXC.(SPECIAL)	= 0.0

EARTHWORK QUANTITIES (SF)	
EXCAVATION	= 6.7
UNSUITABLE	= 0.0
EMBANKMENT	= 0.0
EXC.(SPECIAL)	= 0.0

EARTHWORK QUANTITIES (SF)	
EXCAVATION	= 13.7
UNSUITABLE	= 9.8
EMBANKMENT	= 0.2
EXC.(SPECIAL)	= 0.0

NOTE: PRE STAGE EARTHWORK ADDITIONS/SUBTRACTIONS ARE NOT INCLUDED IN THE EARTHWORK QUANTITIES FOR EACH CROSS SECTION (SEE EARTHWORK SCHEDULE FOR BREAKDOWN OF QUANTITIES BY STAGE).

DATE	
BY	
PROFILER	
DATE	
NO.	
NO.	
NO.	

TYLIN INTERNATIONAL

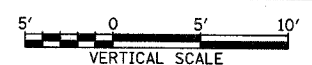

ILLINOIS RTE. 60 (TOWNLIN RD)
STA. 469+50 TO STA. 470+00

P:\60245811-60\Road\60\60\60\60.dwg 9:25:57 AM 5/7/2007