

*REF-drawn01

CONTRACT NO. 60C03

F.A.W. RTE.	SECTION	COUNTY	TOTAL SHEETS	SHEET NO.
1374	0406 WRS	COOK	43	13
STA.		TO STA.		
FED. ROAD DIST. NO.		ILLINOIS FED. AID PROJECT		

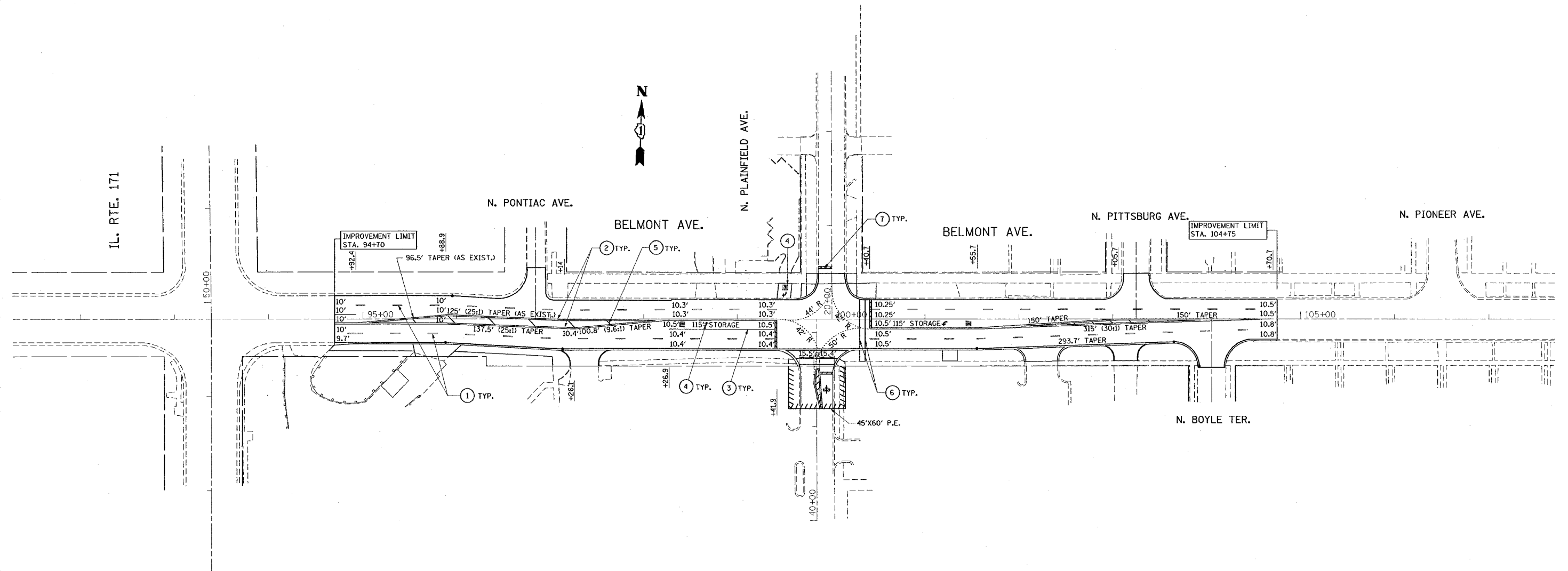

PAVEMENT MARKING LEGEND

- ① 4" LANE LINE-WHITE SKIP DASH
- ② 4" DOUBLE YELLOW SOLID LINE
- ③ 5" TURN LANE-WHITE
- ④ LETTERS & SYMBOLS-WHITE
- ⑤ 12" DIAGONALS-YELLOW @ 45°
- ⑥ 5" CROSS WALK-WHITE
- ⑦ 24" STOP BAR-WHITE

NOTES

ALL FINAL PAVEMENT MARKINGS SHALL BE THERMOPLASTIC (OF THE EXTRUDED TYPE) AND SHOULD BE PLACED IN ACCORDANCE WITH "CITY OF CHICAGO TYPICAL PAVEMENT MARKINGS" DETAIL, (TC-24).

ALL RAISED REFLECTIVE PAVEMENT MARKERS SHALL BE PLACED IN ACCORDANCE WITH THE DISTRICT ONE "TYPICAL APPLICATIONS RAISED REFLECTIVE PAVEMENT MARKER DETAIL." (TC-11).

REVISIONS	
NAME	DATE

ILLINOIS DEPARTMENT OF TRANSPORTATION

**BELMONT AVENUE
@ PLAINFIELD AVENUE
PAVEMENT MARKING PLAN**

SCALE: 1"=50'
DATE: 4/2/2007

DRAWN BY
CHECKED BY

PLOT DATE = 4/2/2007
PLOT SCALE = 90.0000 / IN
USER NAME = ulrichd