

F.A.P. RTE.	SECTION	COUNTY	TOTAL SHEETS	SHEET NO.
638	(129BR-1D)	HENRY	8	1

STATE OF ILLINOIS
 DEPARTMENT OF TRANSPORTATION
 DIVISION OF HIGHWAYS
**PROPOSED
 HIGHWAY PLANS**

FAP ROUTE 638 (IL 82)
 SECTION (129BR-1)D
 HENRY COUNTY

INDEX OF SHEETS

1. Cover Sheet, Index of Sheets, Standards
2. Summary of Quantities
3. General Notes
4. Traffic Control Plan
5. Plan and Elevation
6. Beam Details
7. Beam Details
8. Rail Details

STANDARDS

- 701006-02 Off-Road Operations, 2L, 2W, 4.5 m (15') to 600 mm (24³/₃₂) From Pavement Edge
- 701201-02 Lane Closure, 2L, 2W, Day Only, for Speeds > 45 MPH
- 701301-02 Lane Closure, 2L, 2W, Short Time Operations
- 701321-08 Lane Closure, 2L, 2W, Bridge Repair with Barrier
- 702001-06 Traffic Control Devices
- 704001-03 Temporary Concrete Barrier
- 720011 Metal Posts for Signs, Markers and Delineators
- 728001 Telescoping Steel Sign Support
- 729001 Applications of Types A and B Metal Posts (For Signs & Markers)

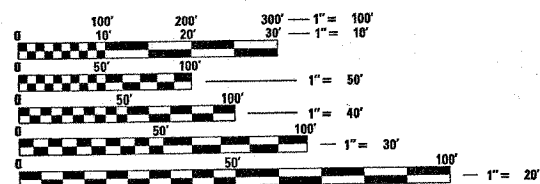

FULL SIZE PLANS HAVE BEEN PREPARED USING STANDARD ENGINEERING SCALES. REDUCED SIZED PLANS WILL NOT CONFORM TO STANDARD SCALES. IN MAKING MEASUREMENTS ON REDUCED PLANS, THE ABOVE SCALES MAY BE USED.

J.U.L.I.E.
 JOINT UTILITY LOCATION INFORMATION FOR EXCAVATION
 1-800-892-0123

CONTRACT NO. 64D73

Project Location
 Structure Number 037-0071

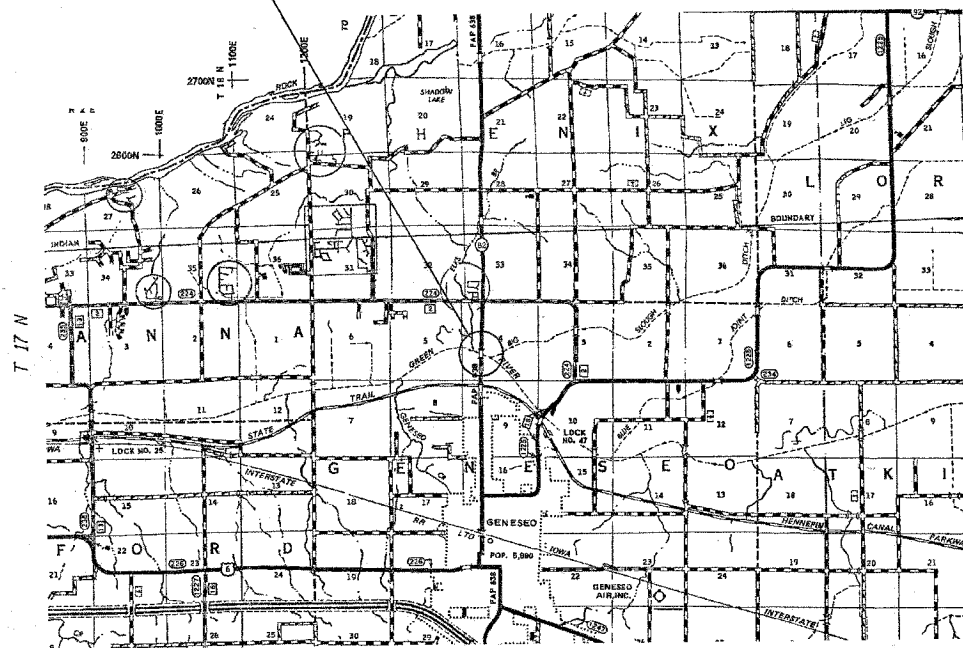

C-92-125-07

D-92-124-07

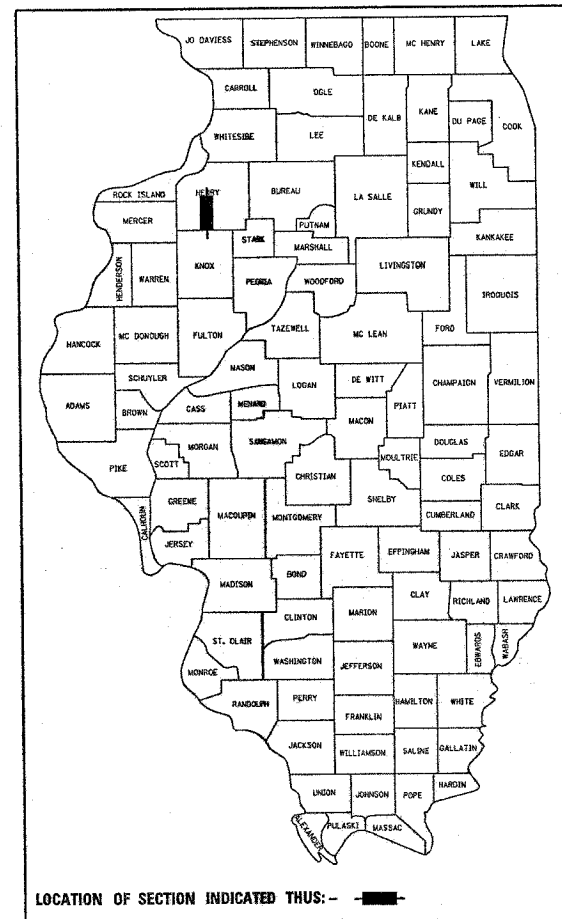

STATE OF ILLINOIS
 DEPARTMENT OF TRANSPORTATION
 DIVISION OF HIGHWAYS

SUBMITTED 06/20/07

George F. Ryan
 DEPUTY DIRECTOR OF HIGHWAYS, REGION ENGINEER

June 29, 2007
Eric E. Harn
 INTERIM ENGINEER OF DESIGN AND ENVIRONMENT

June 29, 2007
Milton R. Sees, P.E.
 DIRECTOR OF HIGHWAYS, CHIEF ENGINEER

**PRINTED BY THE AUTHORITY
 OF THE STATE OF ILLINOIS**