

F.A.P. RTE.	SECTION	COUNTY	TOTAL SHEETS	SHEET NO.
317	146-11RS-7	PEORIA	62	35
STA.		TO STA.		
FED. ROAD DIST. NO.		ILLINOIS FED. AID PROJECT		

BENCHMARK #2
TOP OF ROW MARKER @
SW CORNER OF PERU ST.
ELEV. 470.57

STA. 58+07.92 FAP 317 (US 24) =
CL ARGENTINA ST.

STA. 54+77.70 CL FAP 317 (US 24) =
CL WEST PERU ST.

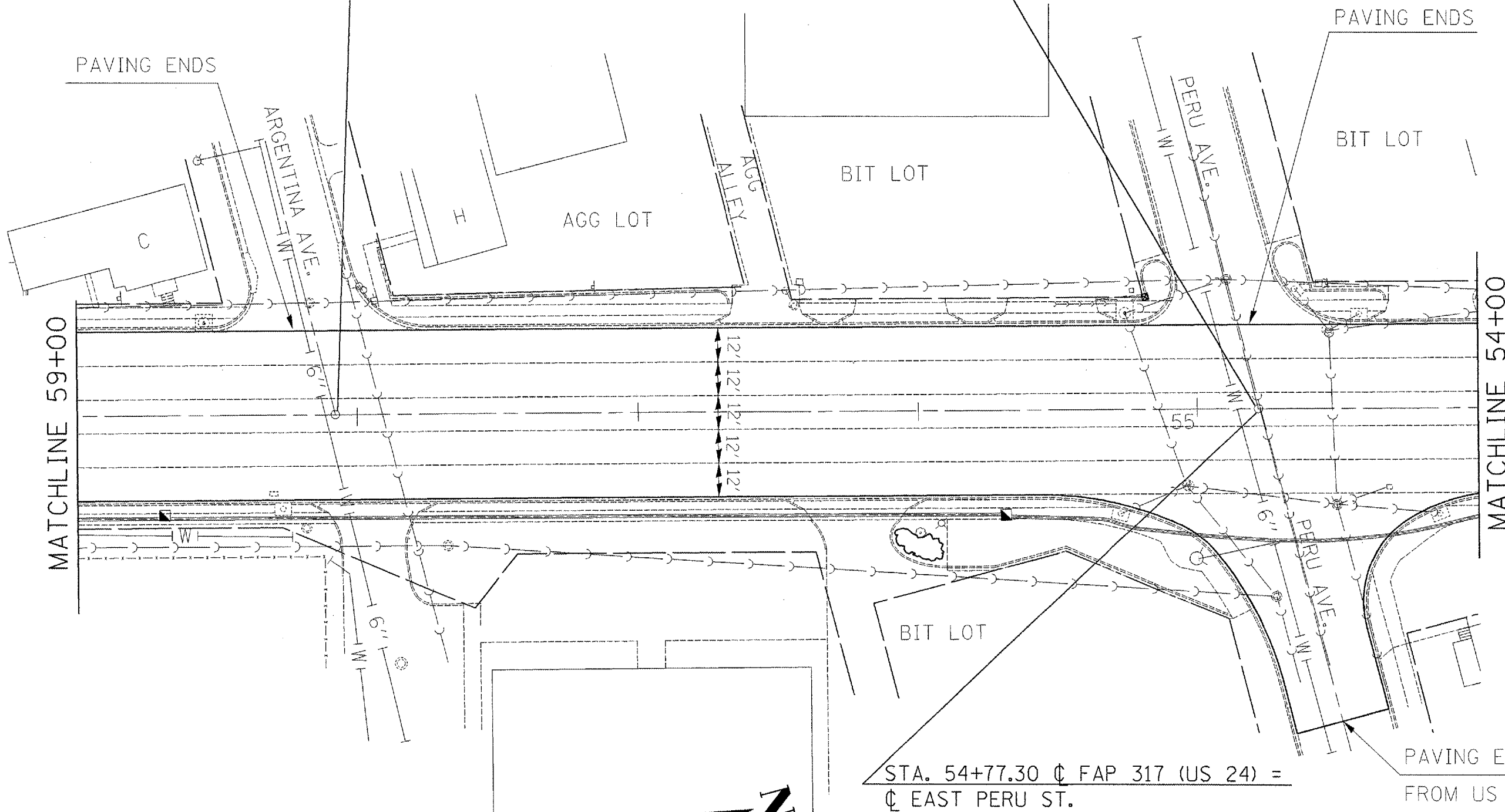

STA. 54+77.30 CL FAP 317 (US 24) =
CL EAST PERU ST.

PAVING ENDS 114.5'
FROM US 24 CL

PLOT DATE = 8/3/2007
 FILE NAME = c:\projects\us24\bar\plan\shhets.dgn
 PLOT SCALE = 1/8"=1'-0"
 USER NAME = cshoverpj

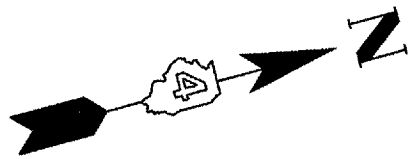

REVISIONS	
NAME	DATE

ILLINOIS DEPARTMENT OF TRANSPORTATION
PROPOSED
PLAN SHEETS
STA 59+00 - 54+00

SCALE: VERT. _____
HORIZ. _____
DATE _____

DRAWN BY _____
CHECKED BY _____