

F.A.S. RTE.	SECTION	COUNTY	TOTAL SHEETS	SHEET NO.
1388	(2-10-BR-11)-1	PEORIA	20	16
STA. 98+73.33		TO STA. 103+58.67		
FED. ROAD DIST. NO. 4 ILLINOIS FED. AID PROJECT				

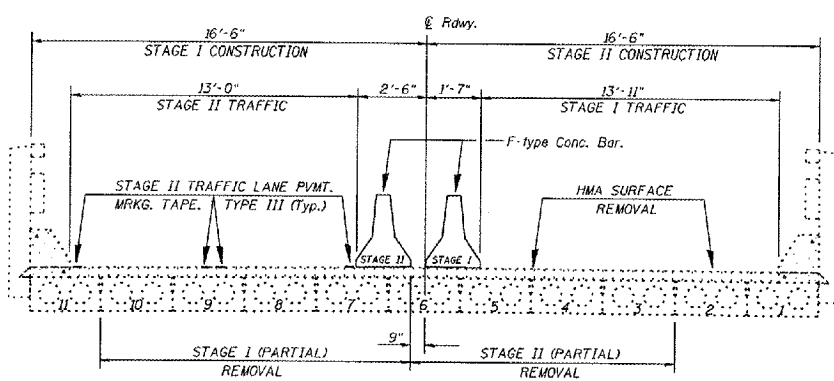

CROSS SECTION
(Looking West)

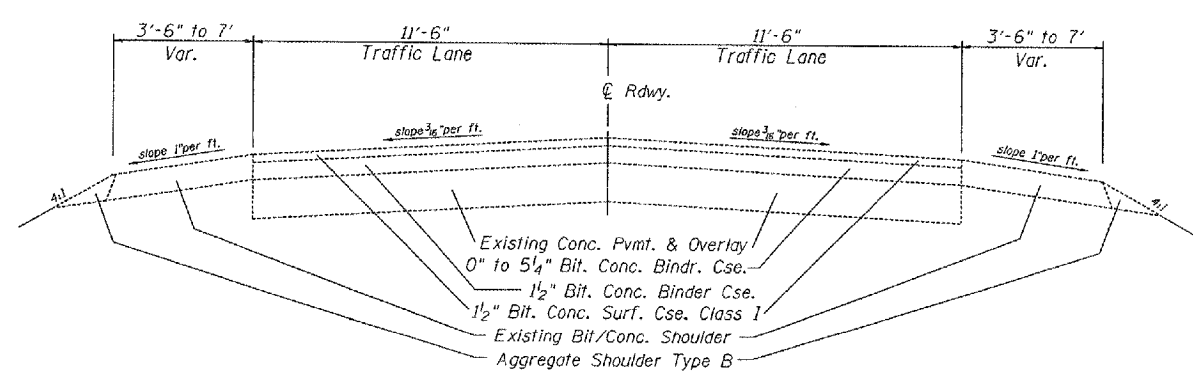

TYPICAL DETAIL

Sta. 97+27.33 to Sta. 99+77.33
Sta. 102+54.67 to Sta. 104+04.67

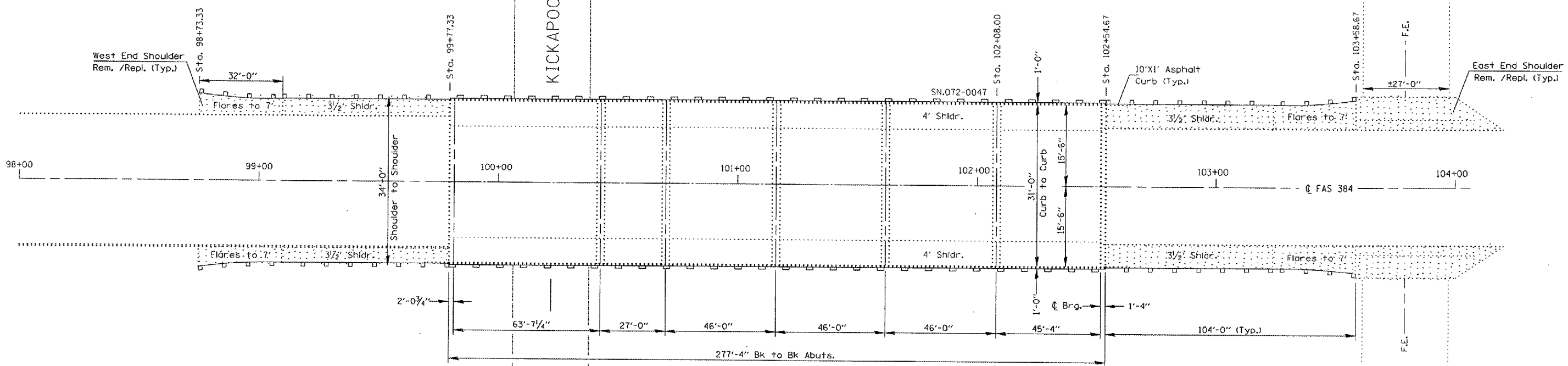

PLAN

SHOULDER QUANTITY SCHEDULE

SHOULDER REMOVAL			
LEFT WEST APPROACH	SO.YD.	LEFT EAST APPROACH	SO.YD.
Sta. 98+73.00 to Sta. 99+77.33	45.8	Sta. 102+54.67 to Sta. 104+00	77.8
RIGHT WEST APPROACH		RIGHT EAST APPROACH	
Sta. 98+73.00 to Sta. 99+77.33	45.8	Sta. 102+54.67 to Sta. 104+00	77.8
TOTAL		247.2	
SHOULDER REPLACEMENT			
LEFT WEST APPROACH	SO.YD.	LEFT EAST APPROACH	SO.YD.
Sta. 98+73.00 to Sta. 99+77.33	45.8	Sta. 102+54.67 to Sta. 104+00	77.8
RIGHT WEST APPROACH		RIGHT EAST APPROACH	
Sta. 98+73.00 to Sta. 99+77.33	45.8	Sta. 102+54.67 to Sta. 104+00	77.8
TOTAL		247.2	

BILL OF MATERIAL

ITEM	UNIT	QUANTITY
HOT MIX ASPHALT BASE COURSE WIDENING, 9"	SO.YD.	248
BITUMINOUS CONCRETE SHOULDER REMOVAL	SO.YD.	248
MOBILIZATION	LSUM	1.0
WIDTH RESTRICTION SIGNING	LSUM	1.0
TRAFFIC CONTROL AND PROTECTION, STANDARD 701321	EACH	1.0
TEMPORARY BRIDGE TRAFFIC SIGNALS	EACH	2.0
PAVEMENT MARKING TAPE, TYPE III, 4"	FOOT	1130
WORKZONE PAVEMENT MARKING REMOVAL	FOOT	1130
TEMPORARY CONCRETE BARRIER	FOOT	408
RELOCATE TEMPORARY CONCRETE BARRIER	FOOT	408
EPOXY PAVEMENT MARKING-LINE 4"	FOOT	1330
PAVEMENT MARKING REMOVAL	SO.FT.	444
IMPACT ATTENUATORS, TEMPORARY (NRD), TEST LEVEL 2	EACH	2.0
IMPACT ATTENUATORS, RELOCATE (NRD), TEST LEVEL 2	EACH	2.0

NOTES
Refer to Highway Standard 701321 for exact placement of traffic management devices and other clarifications as construction staging symbols and dimensioning were duplicated off of this standard. Shoulder removal and replacement shall be complete prior to shifting existing traffic lanes for staging. Concrete Barrier staging placement shall be as required for the specified emergency beam replacement. ReflectORIZED temporary pavement marking tape shall be placed throughout and along-side the work area. The edge line shall be yellow for left-hand lane closures.

REVISIONS 7/16/07

REVISIONS	DATE

SN. 072-0047 IL.8
over Kickapoo Crk.

ILLINOIS DEPARTMENT OF TRANSPORTATION
GENERAL LAYOUT & SHOULDER REM/REPL.

SCALE: VERT. DRAWN BY CEJ
HORIZ. CHECKED BY
DATE 05-10-2007

DATE: 05-10-07
 FILE: C:\GENDIR\PROJECTS\14-NBRIDGE Rep\Conc-socks\68751 SN072-0047-0047L\Bover\KickapooCrk.dgn
 SHEET: 2 of 7 PL
 BRGS