

F.A.S. RTE.	SECTION	COUNTY	TOTAL SHEETS	SHEET NO.
1388		PEORIA	20	3
STA.	TO STA.			
FED. ROAD DIST. NO. 4	ILLINOIS	FED. AID PROJECT		

SUMMARY OF QUANTITIES

PEORIA (URBAN) 100% STATE SAFETY - 2A

CODE NO.	ITEM	UNIT	SN072-0047	SN072-0137	TOTAL
35600712	HOT MIX ASPHALT BASE COURSE WIDENING, 9"	SQ. YD.	248	290	538
44001005	HOT MIX ASPHALT SURFACE REMOVAL	SQ. YD.	27.6	14	41.6
40603335	HOT MIX ASPHALT SURFACE COURSE, MIX "D", N50	TONS	29.5	14.4	43.9
44000920	BITUMINOUS CONCRETE SHOULDER REMOVAL	SQ. YD.	248	66	314
50300255	CONCRETE SUPERSTRUCTURES	CU YD		3.7	3.7
50400305	PPC DECK BEAMS (17" DEPTH)	SQ. FT.	0	1,155	1,155
50400405	PPC DECK BEAMS (21" DEPTH)	SQ. FT.	1225	0	1225
50400505	PPC DECK BEAMS (27" DEPTH)	SQ. FT.	957	0	957
50300300	PROTECTIVE COAT	SQ YD		50	50
50500405	FURNISHING AND ERECTING STRUCTURAL STEEL	POUND	852	1,070	1,922
50800205	REINFORCEMENT BARS, EPOXY COATED	POUND		80	80
58100200	WATERPROOFING MEMBRANE SYSTEM	SQ. YD.	262	132.5	394.5
50900905	REMOVING & RE-ERECTING EXISTING RAILING	FOOT		1,105	1,105
58300100	PORTLAND CEMENT MORTAR FAIRING COURSE	FOOT	981	456	1,437
67100100	MOBILIZATION	LSUM	0.5	0.5	1
70100405	TRAFFIC CONTROL AND PROTECTION, STANDARD 701321	EACH	1	0	1
70100450	TRAFFIC CONTROL AND PROTECTION, STANDARD 701201	LSUM	0.5	0.5	1
70100500	TRAFFIC CONTROL AND PROTECTION, STANDARD 701326	LSUM	0.5	0.5	1
70106500	TEMPORARY BRIDGE TRAFFIC SIGNALS	EACH	2	0	2
70101800	TRAFFIC CONTROL AND PROTECTION (SPECIAL)	LSUM	0	1	1

DATE: 04-18-07
 FILE: I:\AUGEN\DRWF\131DMP\MSASOUND 14\BRIDGE Rep-Contract\68751\SM72-8137\SM72-8137L.Drive\Digital\131D-C-A.dgn
 #SHEET: 3
 #SCALE: 1"=40'
 #REF:

△ REVISED 7/16/07

REVISIONS	
NAME	DATE
CEJ	04/08/07

ILLINOIS DEPARTMENT OF TRANSPORTATION

SUMMARY OF QUANTITIES

SCALE: VERT. DATE 04-20-2007
 HORIZ. DATE 04-20-2007

DRAWN BY CEJ
 CHECKED BY

F.A.S. RTE.	SECTION	COUNTY	TOTAL SHEETS	SHEET NO.
1388		PEORIA	20	7
STA. VARIOUS		TO STA. VARIOUS		
FED. ROAD DIST. NO. 4 ILLINOIS FED. AID PROJECT				
• (Z-10-BR-1)-1;(ZC-15D-BR)1				

SCHEDULE OF QUANTITIES

REMOVAL OF EXISTING PPC DECK BEAMS

SN. 072-0137 DECK REPL. LOCATIONS = 726 SQ. FT.
 SN. 072-0047 DECK REPL. LOCATIONS = 2202 SQ. FT.
2928 SQ. FT.

PPC DECK BEAMS (17" DEPTH)

SN. 072-0137 DECK REPL. LOCATIONS = 717 SQ. FT.
 SN. 072-0047 DECK REPL. LOCATIONS = 0 SQ. FT.
717 SQ. FT.

PPC DECK BEAMS (21" DEPTH)

SN. 072-0137 DECK REPL. LOCATIONS = 0 SQ. FT.
 SN. 072-0047 DECK REPL. LOCATIONS = 1225 SQ. FT.
1225 SQ. FT.

PPC DECK BEAMS (27" DEPTH)

SN. 072-0137 BRIDGE DECK LOCATIONS = 0 SQ. FT.
 SN. 072-0047 BRIDGE DECK LOCATIONS = 957 SQ. FT.
957 SQ. FT.

ASBESTOS BEARING PAD REMOVAL

SN. 072-0137 PIER REPL. LOCATIONS = 7 EACH
 SN. 072-0047 PIER REPL. LOCATIONS = 8 EACH
15 EACH

FURNISHING & ERECTING STRUCTURAL STEEL

SN. 072-0137 BEAM REPLACEMENT LOCATIONS = 746 POUND
 SN. 072-0047 BEAM REPLACEMENT LOCATIONS = 852 POUND
1598 POUND

PORTLAND CEMENT MORTAR FAIRING COURSE

SN. 072-0137 BEAM REPLACEMENT LOCATIONS = 346 FOOT
 SN. 072-0047 BEAM REPLACEMENT LOCATIONS = 981 FOOT
1327 FOOT

WATERPROOFING MEMBRANE SYSTEM

SN. 072-0137 DECK REPLACEMENT BEAMS = 93.5 SQ. YD.
 SN. 072-0047 DECK REPLACEMENT BEAMS = 262 SQ. YD.
356 SQ. YD.

HOT MIX ASPHALT SURFACE COURSE, MIX'D'', N50

SN. 072-0137 BRIDGE DECK LOCATIONS = 11.2 TONS
 SN. 072-0047 BRIDGE DECK LOCATIONS = 29.5 TONS
40.7 TONS

WORKZONE PAVEMENT MARKING REMOVAL

SN. 072-0137 LANE MARKING = 1460 FOOT
 SN. 072-0047 LANE MARKING = 1130 FOOT
2600 FOOT

EPOXY PAVEMENT MARKING-LINE 4"

CENTERLANE & E.O.P. REPLACEMENT = 3172 FOOT
 CENTERLANE & E.O.P. REPLACEMENT = 1330 FOOT
4502 FOOT

EPOXY PAVEMENT MARKING-LINE 12"

CENTERLANE DIAGONALS = 550 FOOT
 CENTERLANE DIAGONALS = 0 FOOT
550 FOOT

TEMPORARY BRIDGE TRAFFIC SIGNALS
 SN. 072-0047 TC 701321 LOCATIONS = 2 EACH

REVISIED 7/16/07

REVISIONS		ILLINOIS DEPARTMENT OF TRANSPORTATION
NAME	DATE	
		SCHEDULE OF QUANTITIES

SCALE: HORIZ.
 DATE: 05-15-2007
 DRAWN BY: CEJ
 CHECKED BY:

PLOT DATE: 05/15/07
 PLOT SCALE: 1/8"=1'-0"
 REFERENCE: SHEET # 7/20

F.A.S. RTE.	SECTION	COUNTY	TOTAL SHEETS	SHEET NO.
1388	(2-10-BR-11)-1	PEORIA	20	16
STA. 98+73.33		TO STA. 103+58.67		
FED. ROAD DIST. NO. 4 ILLINOIS FED. AID PROJECT				

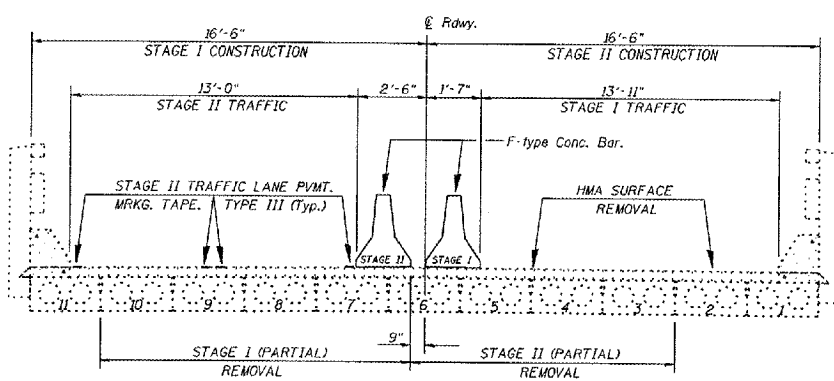

CROSS SECTION
(Looking West)

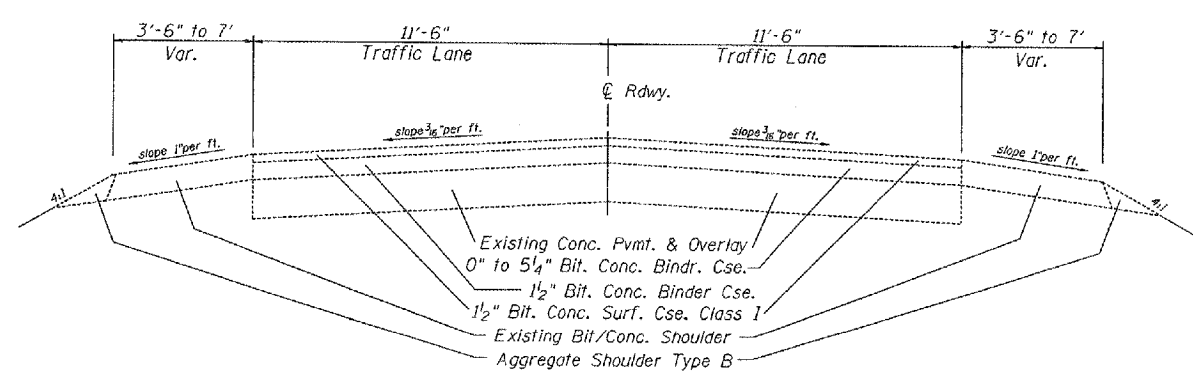

TYPICAL DETAIL
Sta. 97+27.33 to Sta. 99+77.33
Sta. 102+54.67 to Sta. 104+04.67

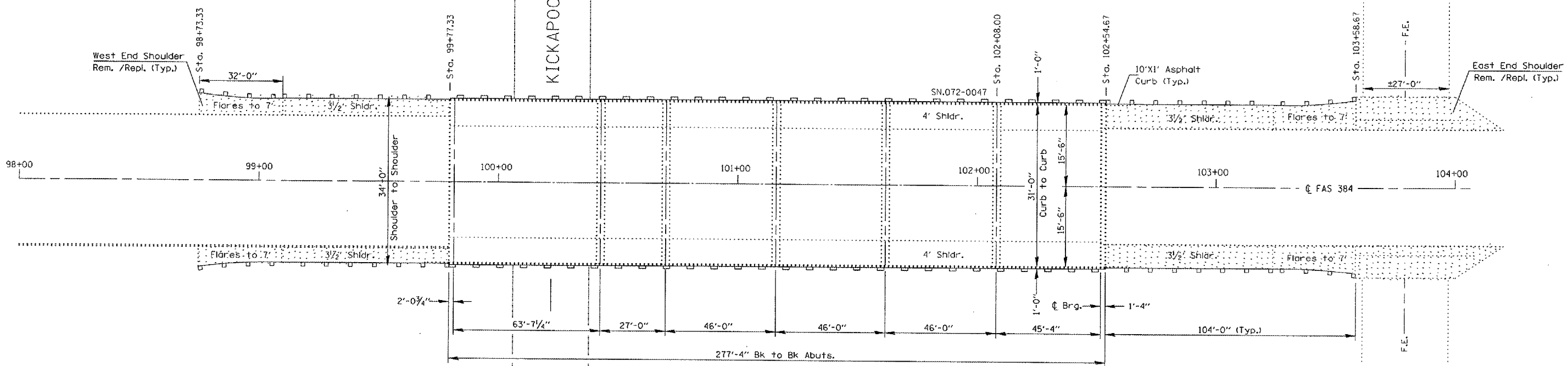

PLAN

SHOULDER QUANTITY SCHEDULE

SHOULDER REMOVAL			
LEFT WEST APPROACH	SO.YD.	LEFT EAST APPROACH	SO.YD.
Sta. 98+73.00 to Sta. 99+77.33	45.8	Sta. 102+54.67 to Sta. 104+00	77.8
RIGHT WEST APPROACH		RIGHT EAST APPROACH	
Sta. 98+73.00 to Sta. 99+77.33	45.8	Sta. 102+54.67 to Sta. 104+00	77.8
TOTAL		247.2	
SHOULDER REPLACEMENT			
LEFT WEST APPROACH	SO.YD.	LEFT EAST APPROACH	SO.YD.
Sta. 98+73.00 to Sta. 99+77.33	45.8	Sta. 102+54.67 to Sta. 104+00	77.8
RIGHT WEST APPROACH		RIGHT EAST APPROACH	
Sta. 98+73.00 to Sta. 99+77.33	45.8	Sta. 102+54.67 to Sta. 104+00	77.8
TOTAL		247.2	

BILL OF MATERIAL

ITEM	UNIT	QUANTITY
HOT MIX ASPHALT BASE COURSE WIDENING, 9"	SO.YD.	248
BITUMINOUS CONCRETE SHOULDER REMOVAL	SO.YD.	248
MOBILIZATION	LSUM	1.0
WIDTH RESTRICTION SIGNING	LSUM	1.0
TRAFFIC CONTROL AND PROTECTION, STANDARD 701321	EACH	1.0
TEMPORARY BRIDGE TRAFFIC SIGNALS	EACH	2.0
PAVEMENT MARKING TAPE, TYPE III, 4"	FOOT	1130
WORKZONE PAVEMENT MARKING REMOVAL	FOOT	1130
TEMPORARY CONCRETE BARRIER	FOOT	408
RELOCATE TEMPORARY CONCRETE BARRIER	FOOT	408
EPOXY PAVEMENT MARKING-LINE 4"	FOOT	1330
PAVEMENT MARKING REMOVAL	SO.FT.	444
IMPACT ATTENUATORS, TEMPORARY (NRD), TEST LEVEL 2	EACH	2.0
IMPACT ATTENUATORS, RELOCATE (NRD), TEST LEVEL 2	EACH	2.0

NOTES
Refer to Highway Standard 701321 for exact placement of traffic management devices and other clarifications as construction staging symbols and dimensioning were duplicated off of this standard. Shoulder removal and replacement shall be complete prior to shifting existing traffic lanes for staging. Concrete Barrier staging placement shall be as required for the specified emergency beam replacement. ReflectORIZED temporary pavement marking tape shall be placed throughout and along-side the work area. The edge line shall be yellow for left-hand lane closures.

REVISIONS 7/16/07

REVISIONS	DATE

SN. 072-0047 IL.8
over Kickapoo Crk.
ILLINOIS DEPARTMENT OF TRANSPORTATION
GENERAL LAYOUT & SHOULDER REM/REPL.
SCALE: VERT. DRAWN BY CEJ
 HORIZ. CHECKED BY
DATE 05-10-2007

DATE: 05-10-07
 FILE: C:\GENDIR\PROJECTS\14-NBRIDGE Rep\Conc-sets\68751 SN072-0047-0047L\Bover\KickapooCrk.dgn
 SHEET: 2 of 7 PL
 BRGS