

F.A.I. RTE.	SECTION	COUNTY	TOTAL SHEETS	SHEET NO.
74	*	MCLEAN	11	1

• CM PATCHING 2008-1

INDEX OF SHEETS

- 1 COVER SHEET
- 2 COMMITMENTS / GENERAL NOTES
- 3 SUMMARY OF QUANTITIES
- 4 EXISTING / PROPOSED TYPICAL SECTION
- 5 SCHEDULE OF QUANTITIES
- 6-8 PLAN SHEETS
- 9-11 PAVEMENT MARKING (MCLEAN COUNTY "SPOT" IMPROVEMENTS ONLY)

LIST OF HIGHWAY STANDARDS

- 001001-01 AREAS OF REINFORCEMENT
- 001006 DECIMAL OF AN INCH AND A FOOT
- 420001-06 PAVEMENT JOINTS
- 421001-01 BAR REINFORCEMENT FOR CRC PAVEMENT
- 442001-03 CLASS A PATCHES
- 442201-02 CLASS C AND D PATCHES
- 701400-02 APPROACH TO LANE CLOSURE, FREEWAY /EXPRESSWAY
- 701401-03 LANE CLOSURE, FREEWAY /EXPRESSWAY
- 701406-04 LANE CLOSURE, FREEWAY /EXPRESSWAY, DAY OPERATIONS ONLY
- 701411-03 LANE CLOSURE, MULTILANE, AT ENTRANCE OR EXIT RAMP, FOR SPEEDS > 45 MPH
- 702001-06 TRAFFIC CONTROL DEVICES
- 780001-01 TYPICAL PAVEMENT MARKINGS
- 781001-02 TYPICAL APPLICATION OF RAISED REFLECTIVE PAVEMENT MARKERS

STATE OF ILLINOIS
DEPARTMENT OF TRANSPORTATION
DIVISION OF HIGHWAYS

PROPOSED
HIGHWAY PLANS

FAI ROUTE 74 (I-74)
SECTION CM PATCHING 2008-1

MCLEAN COUNTY

Patching from I-55 BUSN to East of US 51



CURRENT TRAFFIC DATA	
CURRENT ADT =	16,500 (07)
2027 =	25,900
P.U. & P.C.% =	58.1
SU % =	5.5
MU % =	36.4
FUNCT. CLASS =	INTERSTATE CLASS I

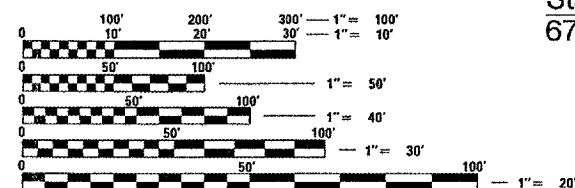

FULL SIZE PLANS HAVE BEEN PREPARED USING STANDARD ENGINEERING SCALES. REDUCED SIZED PLANS WILL NOT CONFORM TO STANDARD SCALES. IN MAKING MEASUREMENTS ON REDUCED PLANS, THE ABOVE SCALES MAY BE USED.

J.U.L.I.E.
 JOINT UTILITY LOCATION INFORMATION FOR EXCAVATION
 1-800-892-0123

Project Begins
 Sta. 603+50 (EB)
 Sta. 607+00 (WB)
 (Existing Concrete Joint)

Sta. Equ. 673+00 BK =
 670+00 AH (EB ONLY)

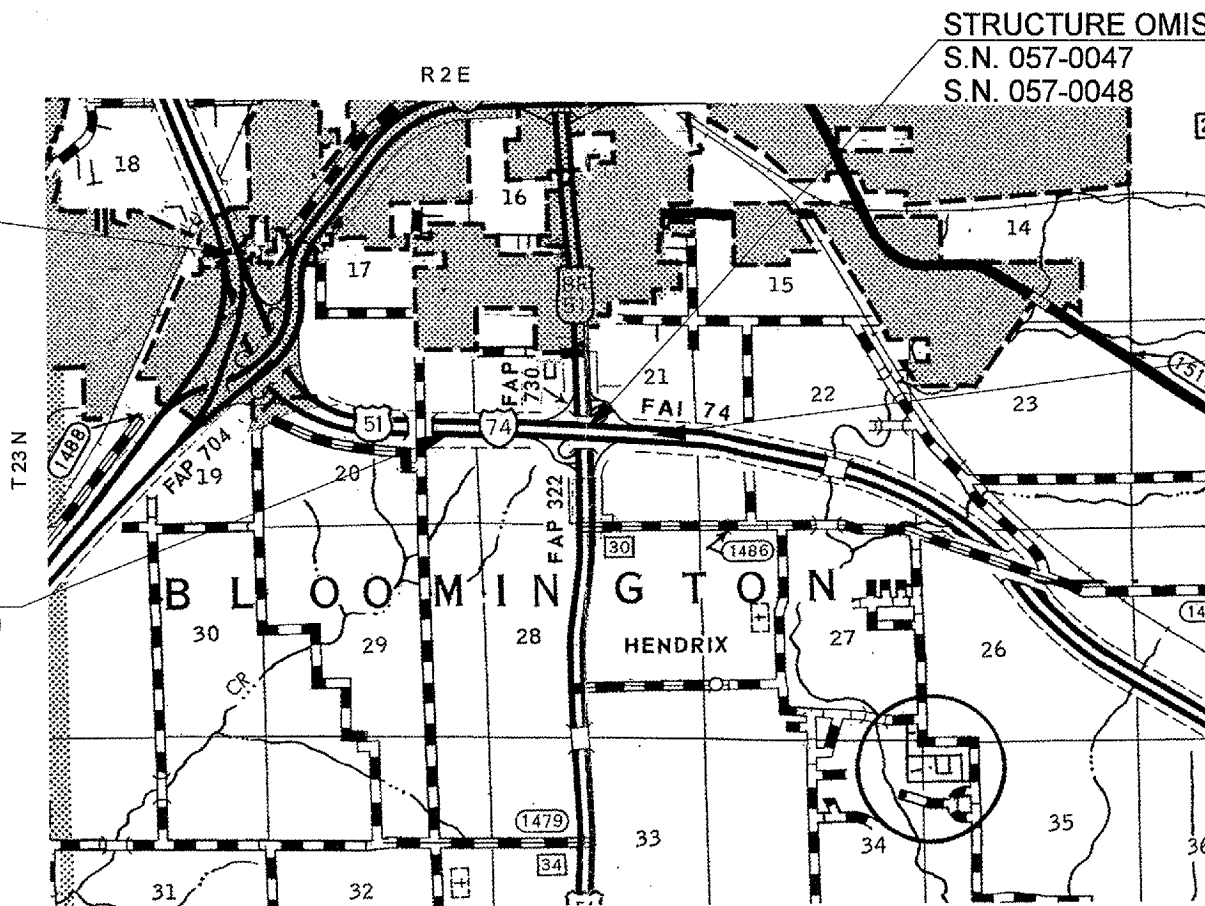

Project Ends
 Sta. 737+00 (EB & WB)

STATE OF ILLINOIS
 DEPARTMENT OF TRANSPORTATION
 DIVISION OF HIGHWAYS

SUBMITTED MAY 09 20 07

[Signature]
 DEPUTY DIRECTOR OF HIGHWAYS, REGION ENGINEER

June 29 20 07
[Signature]
 ENGINEER OF DESIGN AND ENVIRONMENT

June 29 20 07
[Signature]
 DIRECTOR OF HIGHWAYS, CHIEF ENGINEER

PRINTED BY THE AUTHORITY
OF THE STATE OF ILLINOIS

TOTAL LENGTH = 13350.0 ft = 2.528 miles
 NET LENGTH = 13128.83 ft = 2.487 miles