

F.A.U. R.T.E.	SECTION	COUNTY	TOTAL SHEETS	SHEET NO.
1223	04-00272-00-TL	LAKE	72	18
TEMPORARY CABLE PLAN				
ILLINOIS				

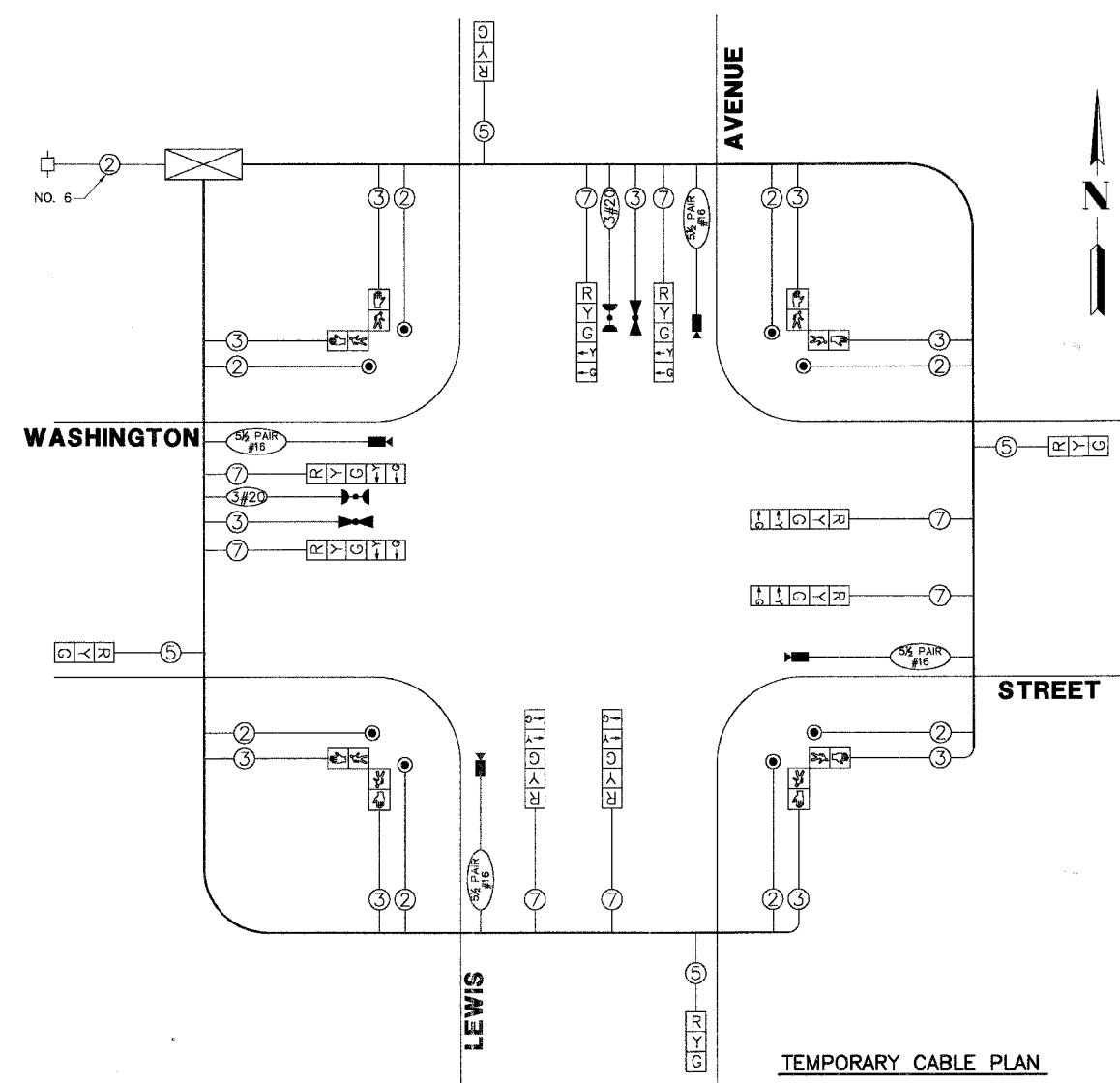

**TEMPORARY CABLE PLAN LEGEND**

- TEMPORARY TRAFFIC SIGNAL SECTION OR PEDESTRIAN SIGNAL SECTION 12'
- TEMPORARY CONTROLLER CABINET
- TEMPORARY SERVICE INSTALLATION
- INDICATES NUMBER OF CONDUCTORS IN CABLE. ALL CONDUCTORS TO BE NUMBER 14 AWG WIRE UNLESS OTHERWISE NOTED.
- EMERGENCY VEHICLE LIGHT DETECTOR
- CONFIRMATION BEACON
- VEHICLE DETECTOR, INDUCTION LOOP
- PEDESTRIAN PUSHBUTTON DETECTOR
- PEDESTRIAN SIGNAL HEAD
- VIDEO DETECTION CAMERA
- PTZ CAMERA
- LUMINAIRE
- TELEPHONE DROP
- MICROWAVE DETECTOR

TEMPORARY CABLE PLAN

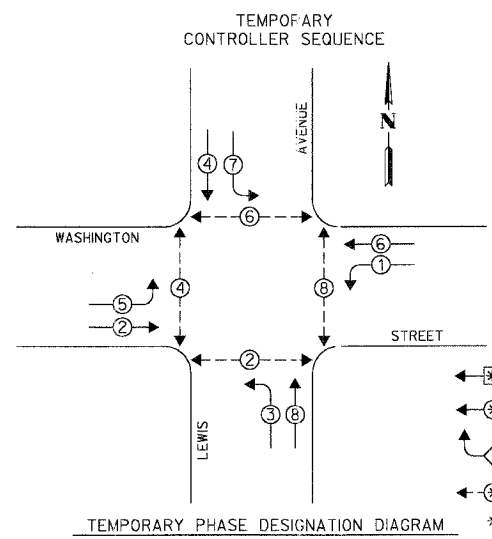

TEMPORARY PHASE DESIGNATION DIAGRAM

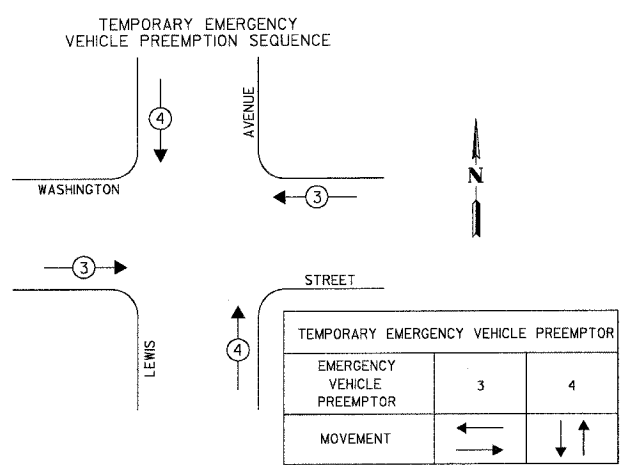

TEMPORARY EMERGENCY VEHICLE PREEMPTOR			
EMERGENCY VEHICLE PREEMPTOR	3	4	
MOVEMENT	←	→	↑

L.C.D.O.T. TRAFFIC SIGNAL INSTALLATION ELECTRICAL SERVICE REQUIREMENTS					TOTAL WATTAGE
TYPE	NO LAMPS	WATTAGE		% OPERATION	
SIGNAL (RED)	12	135	10	0.50	810.0
SIGNAL (YELLOW)	12	135	19	0.10	162.0
SIGNAL (GREEN)	12	135	11	0.40	648.0
ARROW	16	135	9	0.10	216.0
PED.SIGNAL	8	90	9	1.00	720.0
CONTROLLER	1	-	100	1.00	100.0
LUMINAIRE	4	-	250	0.50	500.0
L.E.D. ST. NAME SIGN	-	-	64	0.50	-
VIDEO SYSTEM	-	-	150	1.00	-
BATTERY BACKUP	-	-	25	1.00	-
TOTAL =					2436.0

ENERGY COSTS - BILLED TO: CITY OF WAUKEGAN  
 (ADDRESS) 100 N. M.L.K., JR. AVENUE  
 (ADDRESS) WAUKEGAN, IL  
 ENERGY SUPPLY - CONTACT: MS. ALICE TAYLOR  
 PHONE: (847) 816-5323  
 COMPANY: COMED - LIBERTYVILLE

- LEGEND**
- SINGLE ENTRY PHASE
  - DUAL ENTRY PHASE
  - OVERLAP
  - PEDESTRIAN PHASE
  - NUMBER REFERS TO ASSOCIATED PHASE

PLANS PREPARED BY:  
**GEWALT HAMILTON ASSOCIATES, INC.**  
 Consulting Engineers & Surveyors  
 850 Forest Ridge Drive  
 Vernon Hills, IL 60061  
 (847) 478-9700  
 (847) 478-9788 Fax

REVISIONS	
NAME	DATE

LAKE COUNTY DIVISION OF TRANSPORTATION  
**TEMPORARY CABLE PLAN AND TEMPORARY PHASE DESIGNATION DIAGRAM**  
 WASHINGTON STREET AND LEWIS AVENUE  
 SCALE: NONE  
 DATE: MAY 1, 2007  
 DRAWN BY: PJS  
 DESIGNED BY: JRD  
 CHECKED BY: BLS