

F.A.U. R.T.S.	SECTION	COUNTY	TOTAL SHEETS	SHEET NO.
1223	04-00272-00-TL	LAKE	72	19
GEOMETRIC PLAN				
ILLINOIS				

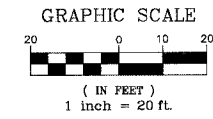

LEWIS AVE.

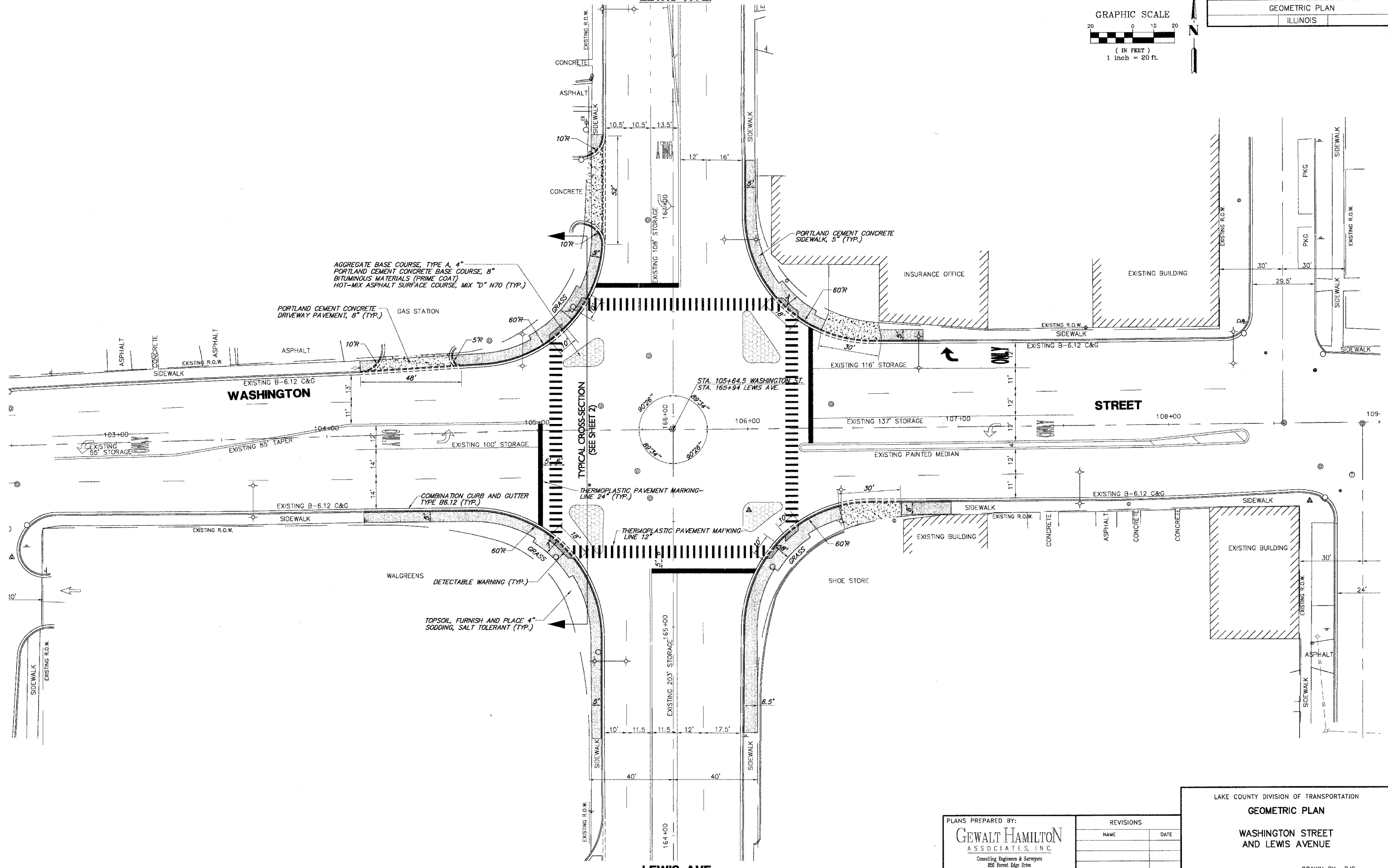

WASHINGTON

STREET

LEWIS AVE.

TYPICAL CROSS-SECTION (SEE SHEET 2)

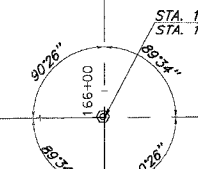

PLANS PREPARED BY:  
**GEWALT HAMILTON ASSOCIATES, INC.**  
Consulting Engineers & Surveyors  
650 Forest Edge Drive  
Vernon Hills, IL 60061  
(847) 478-9700  
(847) 478-9701 Fax

REVISIONS	
NAME	DATE

LAKE COUNTY DIVISION OF TRANSPORTATION  
**GEOMETRIC PLAN**  
**WASHINGTON STREET AND LEWIS AVENUE**

SCALE: 1"=20'  
DATE: MAY 1, 2007

DRAWN BY: PJS  
DESIGNED BY: JRD  
CHECKED BY: BLS