

F.A.U. R.T.E.	SECTION	COUNTY	TOTAL SHEETS	SHEET NO.
1223	04-00272-00-TL	LAKE	72	41
TEMPORARY CABLE PLAN				
ILLINOIS				

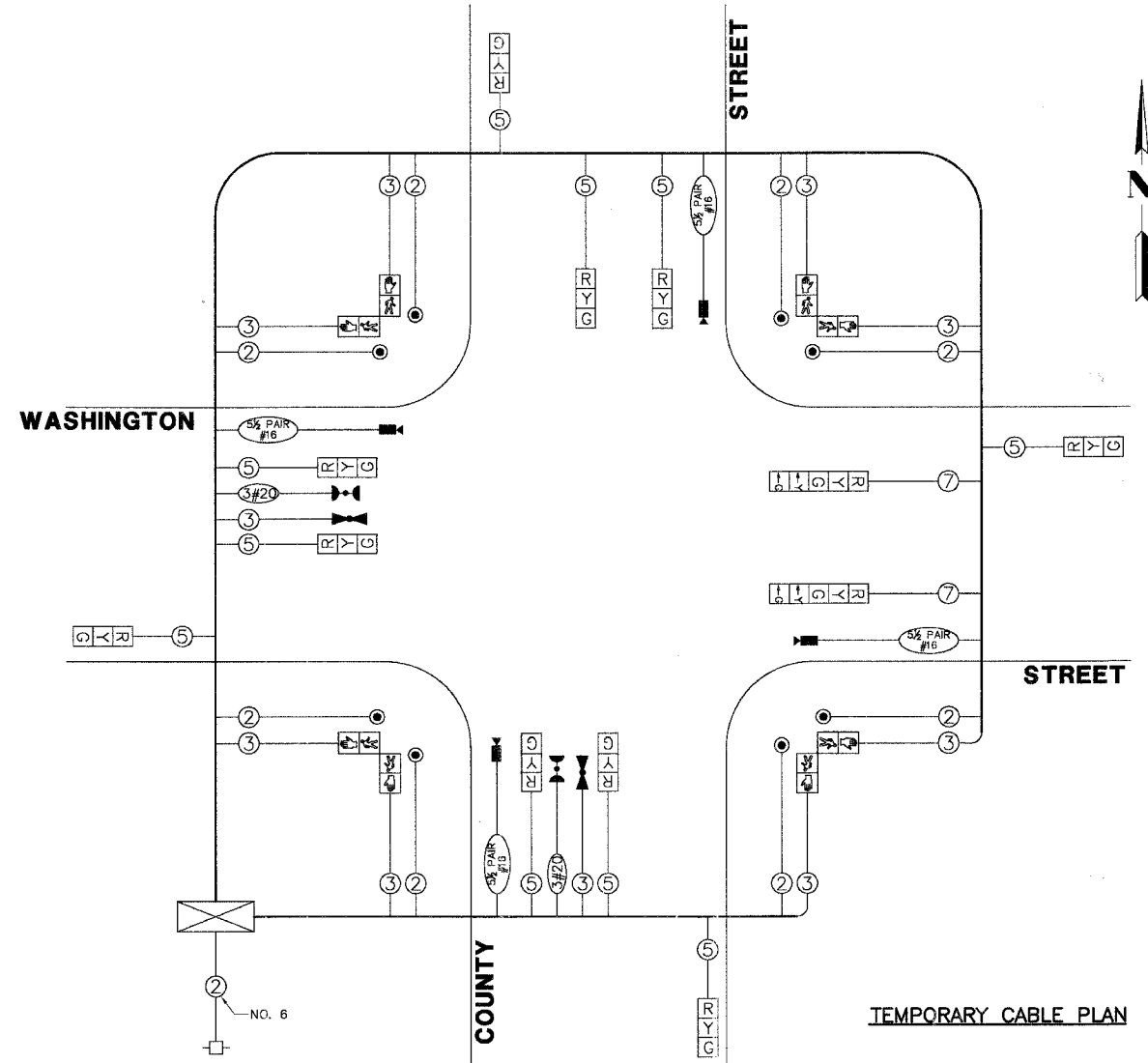

TEMPORARY CABLE PLAN LEGEND

- R TEMPORARY TRAFFIC SIGNAL SECTION OR PEDESTRIAN SIGNAL SECTION 12"
- TEMPORARY CONTROLLER CABINET
- TEMPORARY SERVICE INSTALLATION
- INDICATES NUMBER OF CONDUCTORS IN CABLE. ALL CONDUCTORS TO BE NUMBER 14 AWG WIRE UNLESS OTHERWISE NOTED.
- 5 EMERGENCY VEHICLE LIGHT DETECTOR
- 3 CONFIRMATION BEACON
- VEHICLE DETECTOR, INDUCTION LOOP
- 3 PEDESTRIAN PUSHBUTTON DETECTOR
- PEDESTRIAN SIGNAL HEAD
- VIDEO DETECTION CAMERA
- PTZ CAMERA
- LUMINAIRE
- TELEPHONE DROP
- MICROWAVE DETECTOR

L.C.D.O.T. TRAFFIC SIGNAL INSTALLATION ELECTRICAL SERVICE REQUIREMENTS					TOTAL WATTAGE
TYPE	NO LAMPS	WATTAGE		% OPERATION	
		INCAND.	L.E.D.		
SIGNAL (RED)	12	135	10	0.50	810.0
SIGNAL (YELLOW)	12	135	19	0.10	162.0
SIGNAL (GREEN)	12	135	11	0.40	648.0
ARROW	4	135	9	0.10	54.0
PED.SIGNAL	8	90	9	1.00	720.0
CONTROLLER	1	-	100	1.00	100.0
LUMINAIRE	-	-	250	0.50	-
L.E.D. ST. NAME SIGN	-	-	64	0.50	-
VIDEO SYSTEM	-	-	150	1.00	-
BATTERY BACKUP	-	-	25	1.00	-
TOTAL =					2494.0

ENERGY COSTS - BILLED TO: CITY OF WAUKEGAN
 (ADDRESS) 100 N. M.L.K. JR. AVENUE
 (ADDRESS) WAUKEGAN, IL
 ENERGY SUPPLY - CONTACT: MS. ALICE TAYLOR
 PHONE: (847) 816-5323
 COMPANY: COMED - LIBERTYVILLE

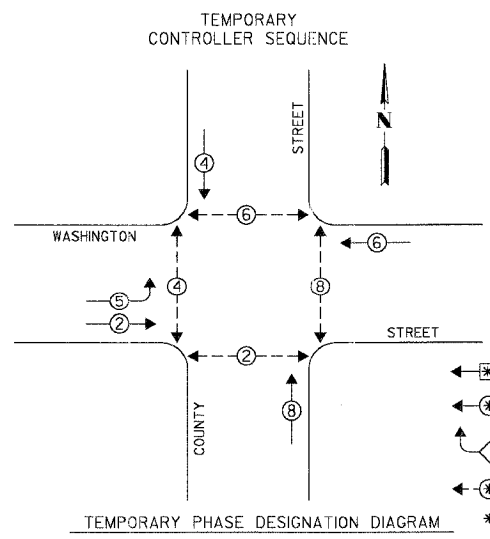

- LEGEND**
- * SINGLE ENTRY PHASE
 - * DUAL ENTRY PHASE
 - OL OVERLAP
 - * PEDESTRIAN PHASE
 - * NUMBER REFERS TO ASSOCIATED PHASE

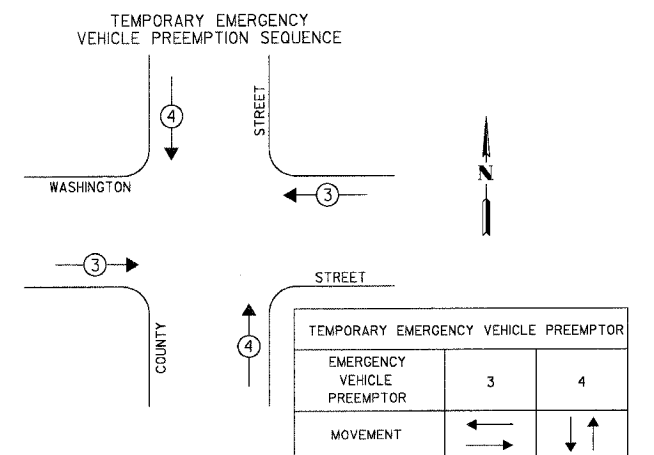

PLANS PREPARED BY:
GEWALT HAMILTON ASSOCIATES, INC.
 Consulting Engineers & Surveyors
 850 Forest Edge Drive
 Vernon Hills, IL 60061
 (847) 478-9700
 (847) 478-9702 Fax

REVISIONS	
NAME	DATE

LAKE COUNTY DIVISION OF TRANSPORTATION
TEMPORARY CABLE PLAN AND TEMPORARY PHASE DESIGNATION DIAGRAM
WASHINGTON STREET AND COUNTY STREET
 SCALE: NONE
 DATE: MAY 1, 2007
 DRAWN BY: PJS
 DESIGNED BY: JRD
 CHECKED BY: BLS