

F.A.P. RTE.	SECTION	COUNTY	TOTAL SHEETS	SHEET NO.
*	**	KENDALL	37	25

STA.	TO STA.
FED. ROAD DIST. NO., ILLINOIS	FED. AID PROJECT

FAP 591 (US 34)
SECTION 06-00034-00-RP

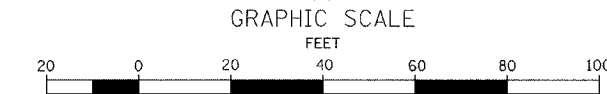
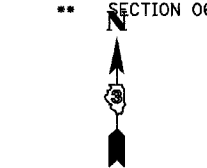

SCHEDULE OF QUANTITIES

DESCRIPTION	UNIT	TOTAL QUANTITY
CONDUIT IN TRENCH, 2" DIA., PVC	FOOT	116
CONDUIT PUSHED, 2" DIA., PVC	FOOT	99
HANDHOLE, PORTLAND CEMENT CONCRETE	EACH	1
TRENCH AND BACKFILL FOR ELECTRICAL WORK	FOOT	116
DRILL EXISTING HANDHOLE	EACH	1
ELECTRIC CABLE IN CONDUIT, TRACER, NO. 14 1C	FOOT	496
FIBER OPTIC CABLE IN CONDUIT, NO. 62.5/125, MM12F SM12F	FOOT	496

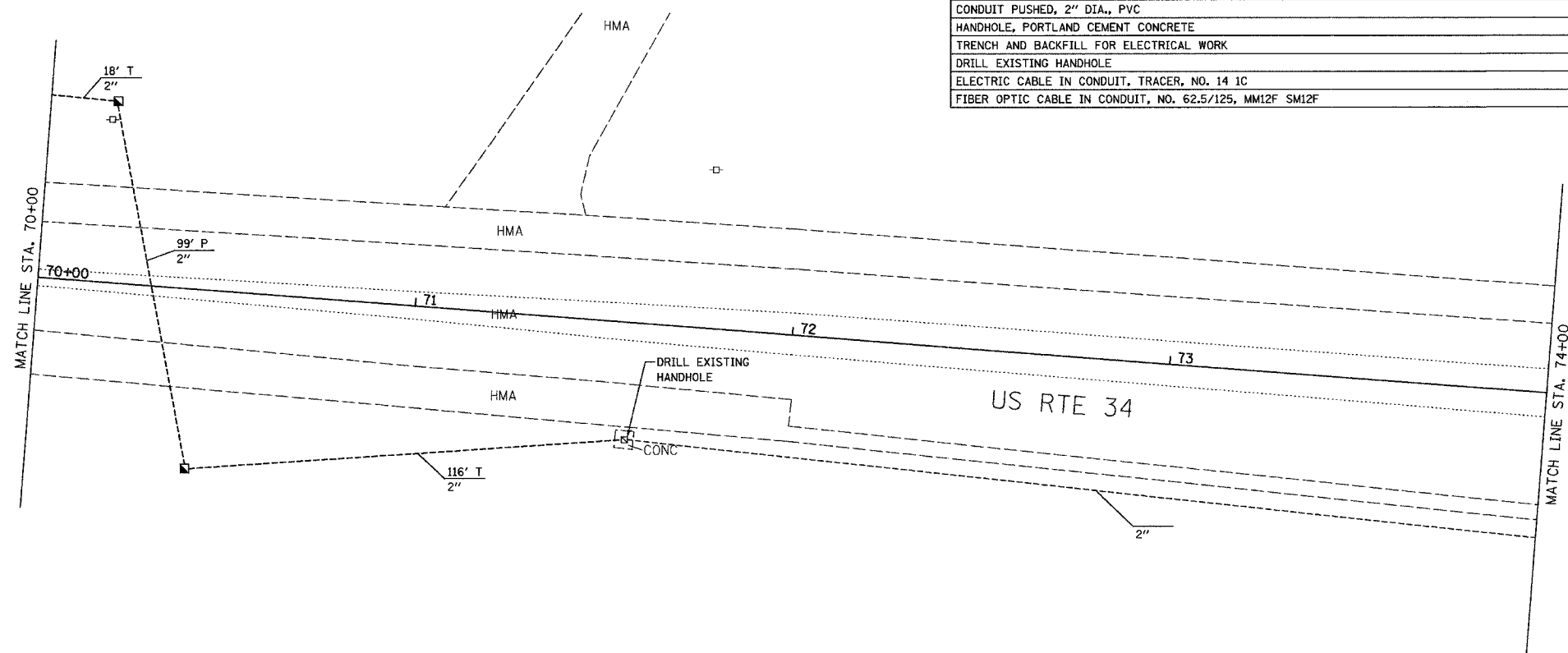

TRAFFIC SIGNAL LEGEND

- PROPOSED HANDHOLE, PORTLAND CEMENT CONCRETE
- PROPOSED DOUBLE HANDHOLE, PORTLAND CEMENT CONCRETE
- PROPOSED CONTROLLER AND TYPE IV CABINET
- EXISTING HANDHOLE
- PROPOSED CONDUIT
- EXISTING CONDUIT

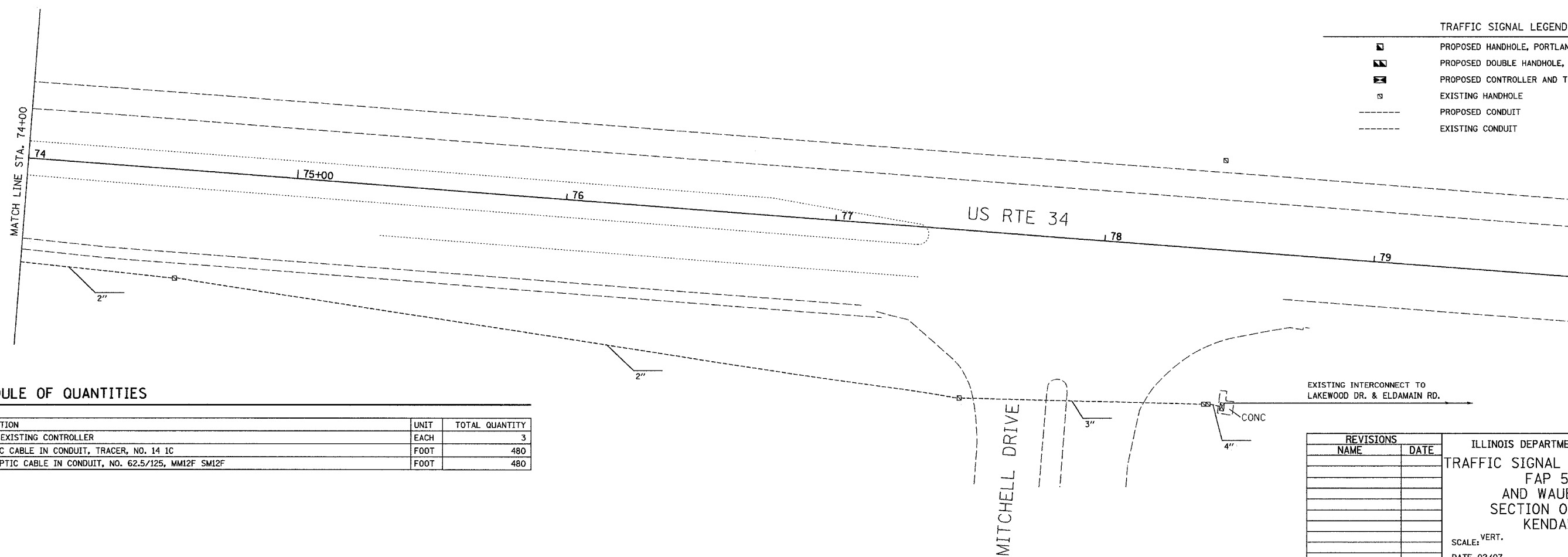

SCHEDULE OF QUANTITIES

DESCRIPTION	UNIT	TOTAL QUANTITY
MODIFY EXISTING CONTROLLER	EACH	3
ELECTRIC CABLE IN CONDUIT, TRACER, NO. 14 1C	FOOT	480
FIBER OPTIC CABLE IN CONDUIT, NO. 62.5/125, MM12F SM12F	FOOT	480

REVISIONS	
NAME	DATE

ILLINOIS DEPARTMENT OF TRANSPORTATION
TRAFFIC SIGNAL INTERCONNECT PLAN
FAP 591 (US 34)
AND WAUBONSEE DRIVE
SECTION 06-00034-00-RP
KENDALL COUNTY

SCALE: VERT. DATE 02/07
DRAWN BY ARR
CHECKED BY JLS

PLOT DATE = 02/07
PLOT NAME = 250607TSINTERCON.DGN
PLOT SCALE = 1" = 20'
USER NAME = ARR