

F.A. RTE.	SECTION	COUNTY	TOTAL SHEETS	SHEET NO.
		WOODFORD	24	8
STA. 11+00		TO STA. 16+00		
FED. ROAD DIST. NO.		ILLINOIS FED. AID PROJECT		
05-00018-00-BR		CONTRACT #89414		

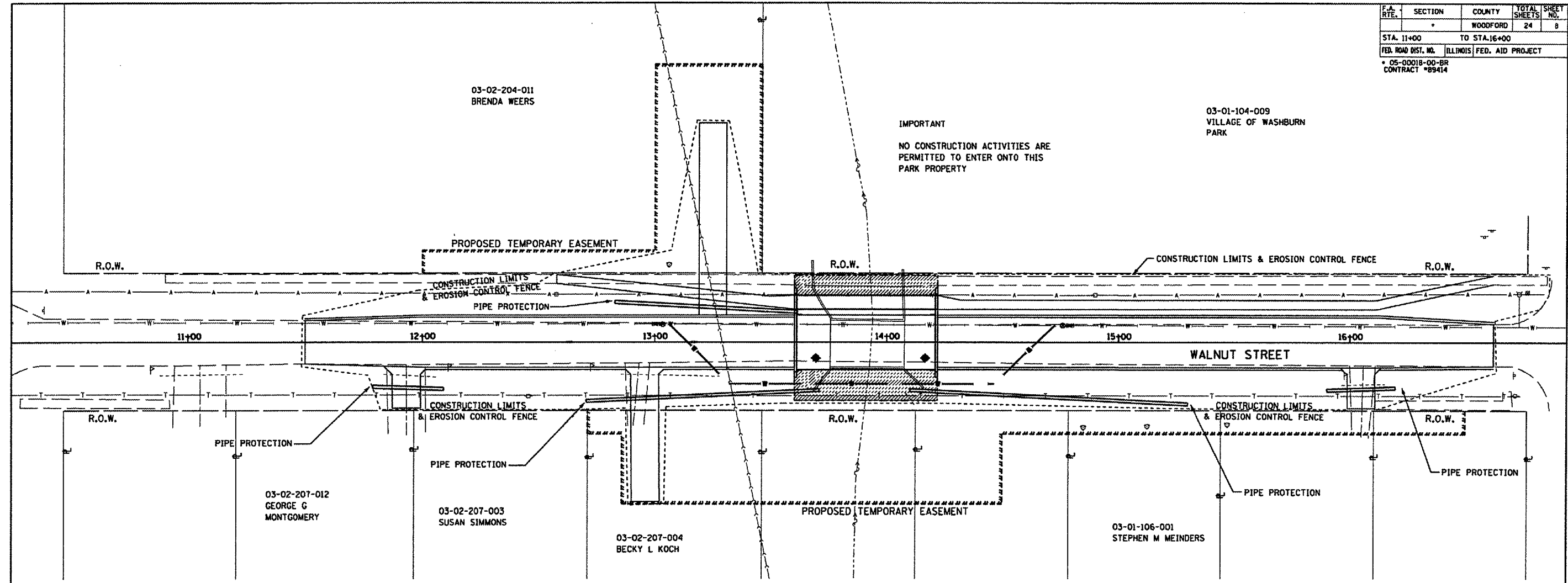

SEEDING CLASS 7

LOCATION	ACRE
STA. 11+50 TO STA. 16+62	0.75
TOTAL	0.75

SEEDING CLASS 1

LOCATION	ACRE
STA. 11+50 TO STA. 16+62	0.75
TOTAL	0.75

INLET & PIPE PROTECTION

LOCATION	EACH
STA. 11+79, 19.5' RT.	1
STA. 12+71, 28' RT.	1
STA. 12+83, 16.5' LT.	1
STA. 15+30, 21' RT.	1
STA. 16+20, 20' RT.	1
UNIDENTIFIED LOCATION	1
TOTAL	6

FENCE (EROSION CONTROL)

LOCATION	FEET
STA. 11+50 TO STA. 16+62 LT.	472
STA. 11+50 TO STA. 16+62 RT.	365
TOTAL	837

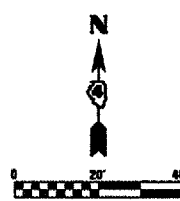

STORM WATER POLLUTION PREVENTION PLAN
WALNUT STREET OVER SNAG CREEK
SECTION 05-00018-00-BR
WOODFORD COUNTY
STATION 13+91.11

PLT DATE: 6/19/2007
 FILE NAME: D:\data\5792-09\DWG\EC-579209.dgn
 PLT SCALE: 1/8" = 1'-0"
 USER NAME: jeb