

F.A.U. RTE.	SECTION	COUNTY	TOTAL SHEETS	SHEET NO.
8146	06-00029-00-TL	SANGAMON	67	24
STA. 40+00.00		TO STA. 50+50.00		
FED. ROAD DIST. NO.	ILLINOIS	FED. AID PROJECT #		
		*HS-8146(003)		

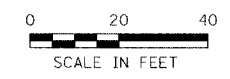

LEGEND

- SODDING
- SEEDING
- INLET AND PIPE PROTECTION
- PERIMETER EROSION BARRIER

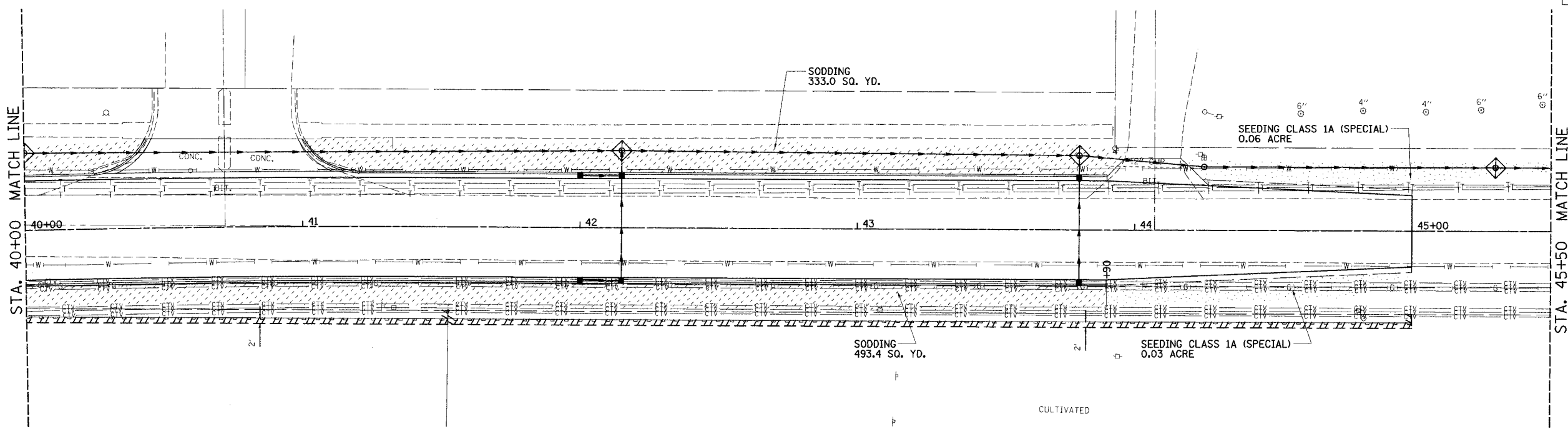

LEGEND

- SODDING
- SEEDING
- INLET AND PIPE PROTECTION
- PERIMETER EROSION BARRIER

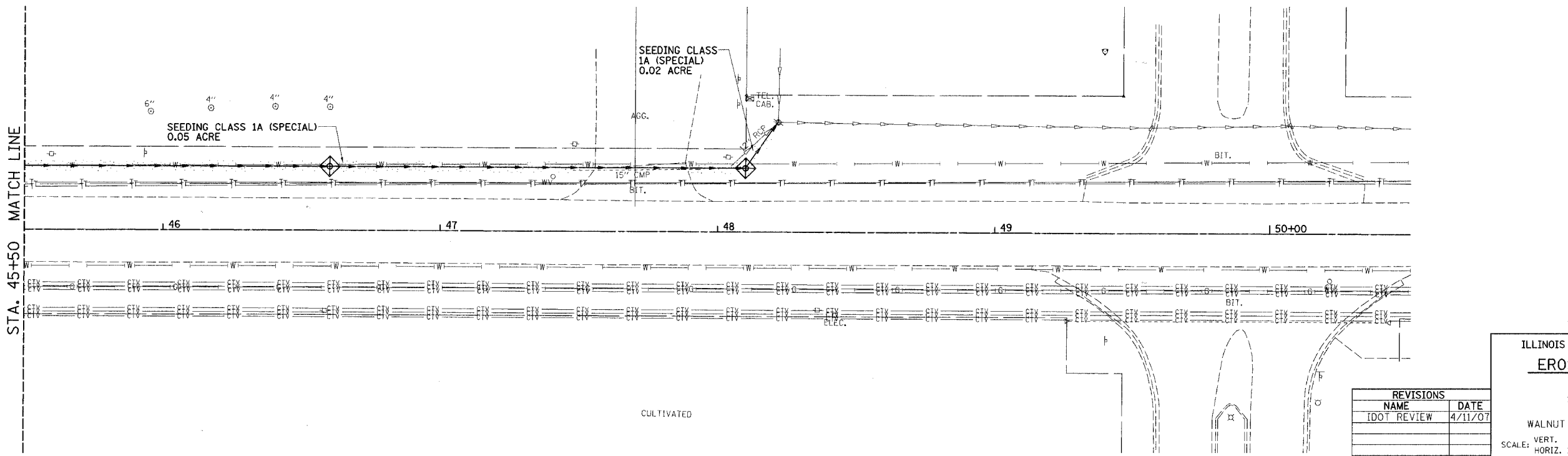

REVISIONS	
NAME	DATE
IDOT REVIEW	4/11/07

ILLINOIS DEPARTMENT OF TRANSPORTATION
EROSION CONTROL PLAN
 VILLAGE OF CHATHAM
 SECTION 06-00029-00-TL
 SANGAMON COUNTY
 WALNUT ST. / PARK AVE. IMPROVEMENTS

VERT. SCALE: 1" = 20'
 HORIZ. SCALE: 1" = 20'
 DATE: 2/01/07

DRAWN BY: SUTHEARD
 CHECKED BY: BOIT

GREENE & BRADFORD, INC.
 OF SPRINGFIELD
 CONSULTING ENGINEERS
 PROFESSIONAL DESIGN FIRM NO. 061-0078
 PROFESSIONAL & TECHNICAL PERSONNEL OPERATIONS
 601 195-8411, 618 750-2211 FAX 618 750-2211

COMPUTER FILE NO.
 06152EC
 PROJECT 06152
 4/27/07 - FAV

PLOT DATE = 4/27/07
 FILE NAME = J:\ARMS\DRAWINGS\06152EC.dgn
 PLOT SCALE = 20.0000 / IN.
 MODEL = Default
 OPERATOR = Franky

VILLAGE OF CHATHAM - WALNUT STREET - EROSION CONTROL PLAN
STA. 40+00 TO STA. 50+50