

ROUTE NO.	SECTION	COUNTY	TOTAL SHEETS	SHEET NO.
FAU 8304	#	EFFINGHAM	95	23
FED. ROAD DIST. NO. 7	ILLINOIS	FED. AID PROJECT- MPP-409(04)		

* SECTION 05-00094-01-PV
SECTION 03-00098-00-BR
CONTRACT #95503

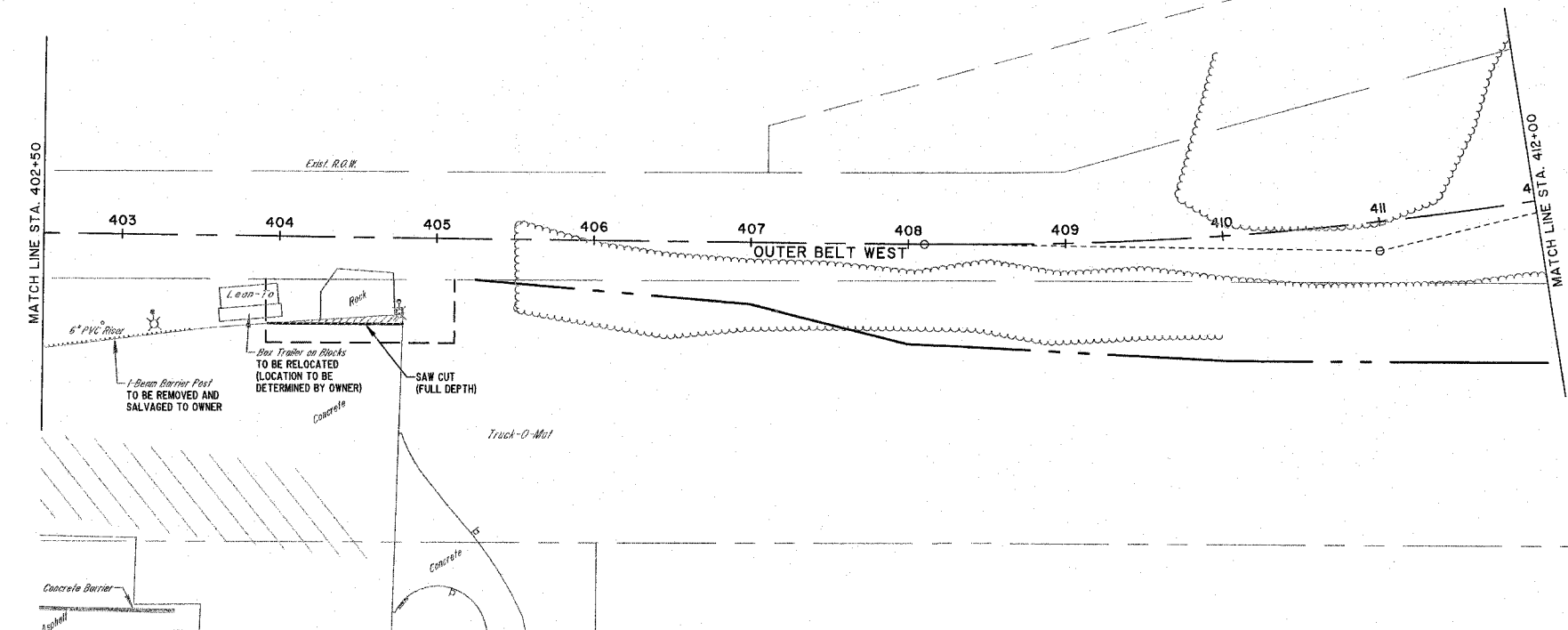

OUTER BELT WEST CURVE #1
 PI STA=411+00.01
 Delta=14°24'42"
 D=02°30'00"
 T=289.77'
 R=2291.83'
 L=576.47'
 C=574.95'
 E=18.25'
 M=18.10'
 PC STA=408+10.24
 PT STA=413+86.71

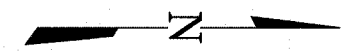
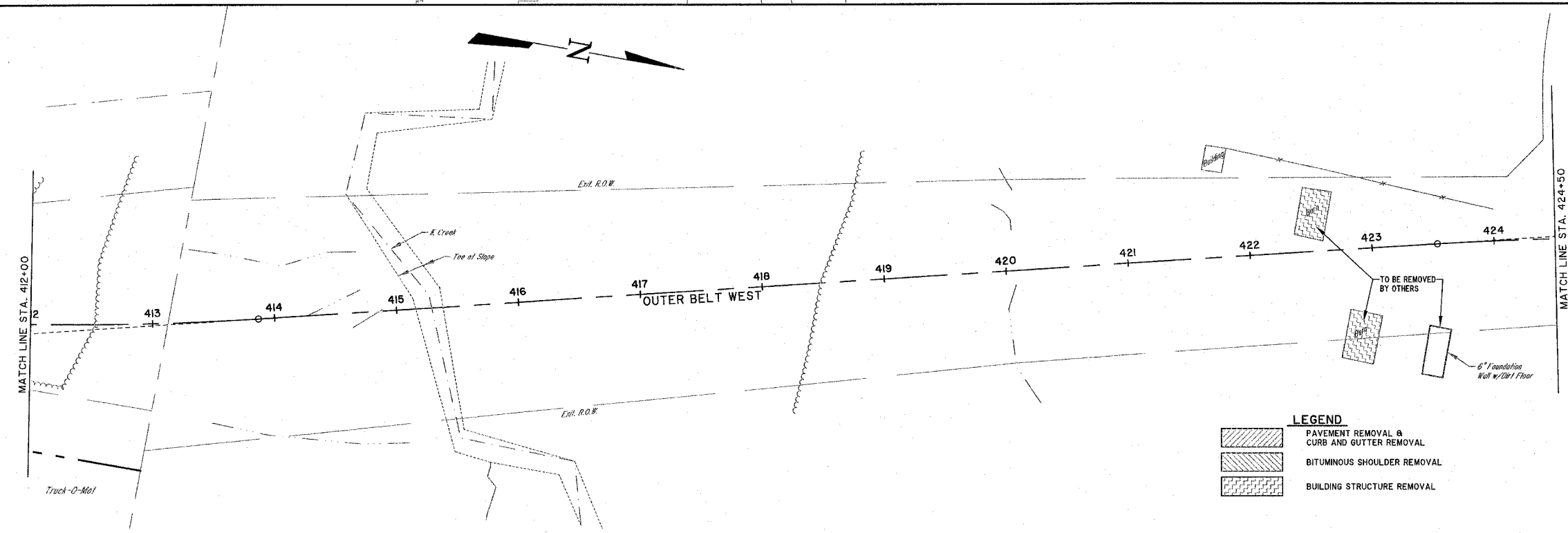
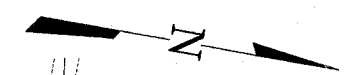

OUTER BELT WEST CURVE #1
 PI STA=411+00.01
 Delta=14°24'42"
 D=02°30'00"
 T=289.77'
 R=2291.83'
 L=576.47'
 C=574.95'
 E=18.25'
 M=18.10'
 PC STA=408+10.24
 PT STA=413+86.71

OUTER BELT WEST CURVE #2
 PI STA=426+39.94
 Delta=14°14'21"
 D=02°30'00"
 T=286.30'
 R=2291.83'
 L=569.65'
 C=568.18'
 E=17.61'
 M=17.69'
 PC STA=423+53.64
 PT STA=429+23.29

- LEGEND**
- PAVEMENT REMOVAL & CURB AND GUTTER REMOVAL
 - BITUMINOUS SHOULDER REMOVAL
 - BUILDING STRUCTURE REMOVAL

MILANO & GRUNLOH ENGINEERS, LLC
 14 WEST WASHINGTON
 P.O. BOX 897
 EFFINGHAM, ILLINOIS 62401
 PHONE: (217) 347-7282
 (800) 677-2714
 FAX #: (217) 342-3433

REMOVAL PLAN
 OUTER BELT WEST
 STA. 399+50 TO STA 424+50
 EFFINGHAM, ILLINOIS

File name: S:\DWG\05\05004\dwg\Removal Plan.dwg
 Plot date: 03/30/07 at 12:00
 FB: 555,664,603