

CONTRACT NO. 95520				
T.R. NO.	SECTION	COUNTY	TOTAL SHEETS	SHEET NO.
335A	06-15129-00-BR	SHELBY	11	9
STA. 20+00		TO STA. 23+00		
FED. ROAD DIST. NO. ILLINOIS FED. AID PROJECT				

FILED	DATE
SEARCHED	INDEXED
SERIALIZED	FILED
NOV 20 1995	
FBI - MEMPHIS	

ORIGINAL	DATE
BY	BY
NO. 1	NO. 1
NO. 2	NO. 2
NO. 3	NO. 3
NO. 4	NO. 4
NO. 5	NO. 5
NO. 6	NO. 6
NO. 7	NO. 7
NO. 8	NO. 8
NO. 9	NO. 9
NO. 10	NO. 10

PLOT DATE = 8/14/95
FILE NAME = 811111.D

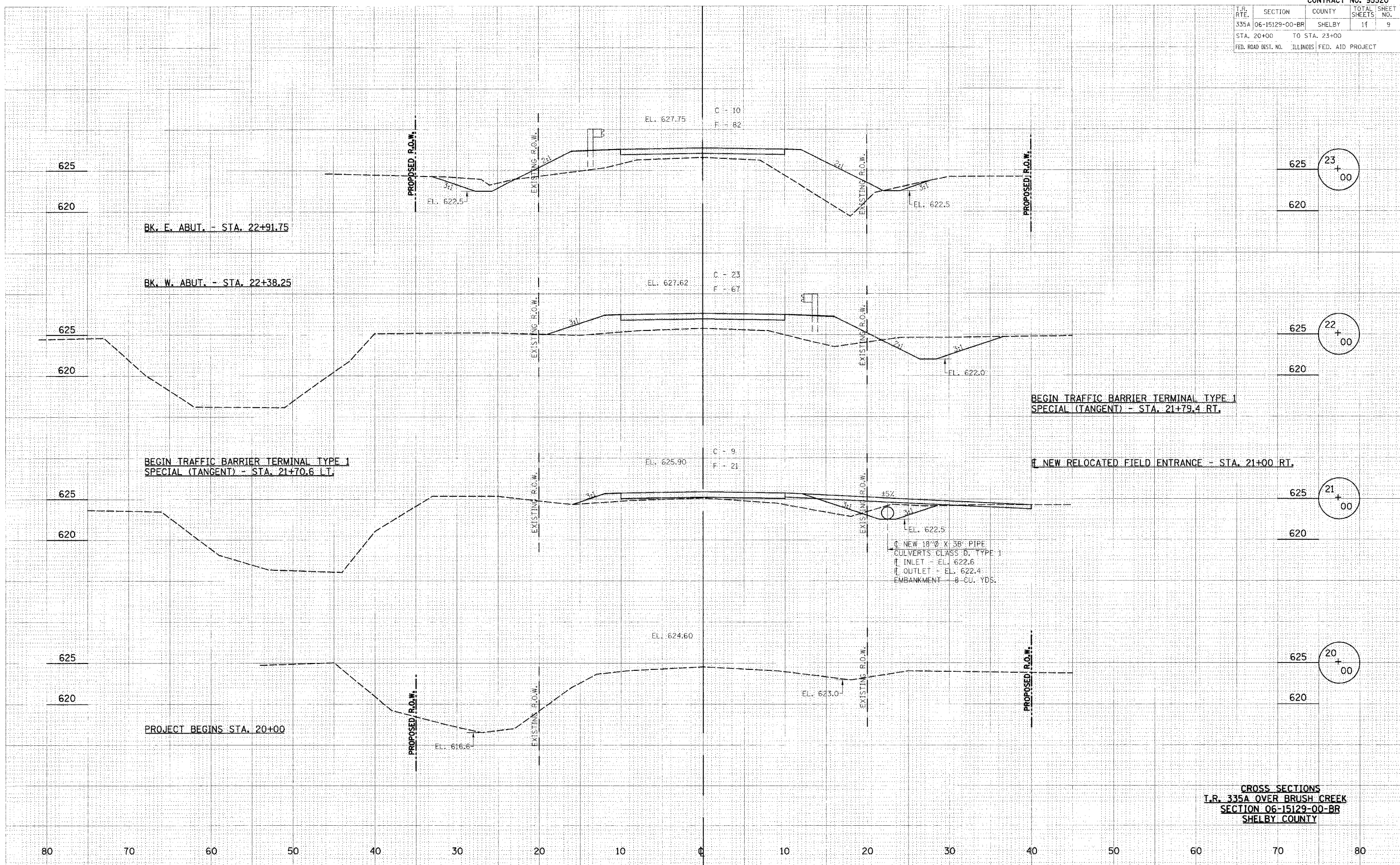

CROSS SECTIONS
I.R. 335A OVER BRUSH CREEK
SECTION 06-15129-00-BR
SHELBY COUNTY