

T.R. RTE.	SECTION	COUNTY	TOTAL SHEETS	SHEET NO.
335A	06-15129-00-BR	SHELBY	11	3
STA. 20+00		TO STA. 25+00		
FED. ROAD DIST. NO.		ILLINOIS FED. AID PROJECT		

**SCHEDULE  
TEMPORARY DITCH CHECKS**

LOCATION	QUANTITY (Each)
STA. 22+25 28' RT.	1
STA. 23+00 27' LT.	1
STA. 23+10 24' RT.	1
<b>TOTAL</b>	<b>3</b>

**SCHEDULE  
INLET & PIPE PROTECTION**

LOCATION	QUANTITY (EACH)
STA. 20+81 RT.	1
STA. 24+36 LT.	1
STA. 24+90 LT.	1
<b>TOTAL</b>	<b>3</b>

**UTILITIES**

SHELBY ELECTRIC COOPERATIVE  
NORTH ROUTE 128  
SHELBYVILLE, ILLINOIS 62565

CONSOLIDATED COMMUNICATIONS INC.  
121 SOUTH 17TH STREET  
MATTOON, ILLINOIS 61938-3915  
217-234-9971

**SECTION 16, T.10 N. R.5 E. 3rd P.M.**

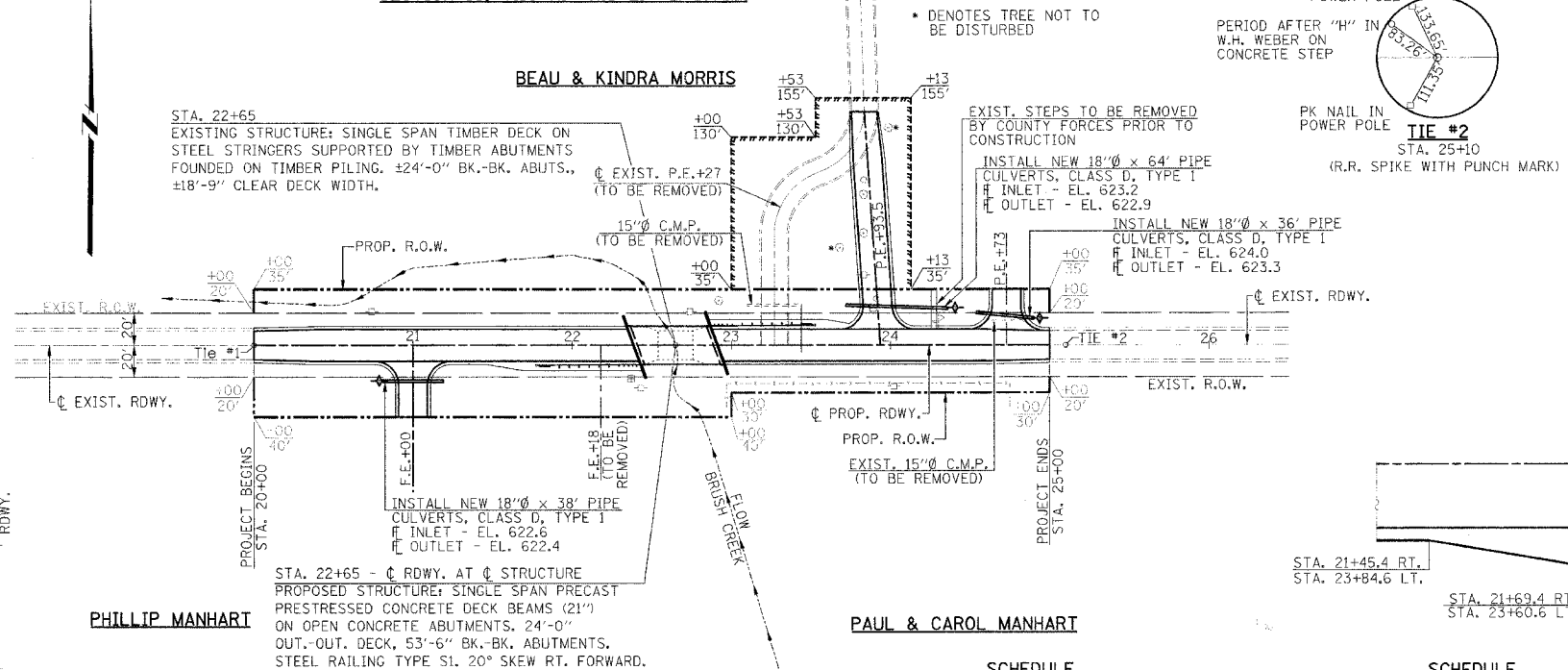

**SECTION 21, T.10 N. R.5 E. 3rd P.M.**

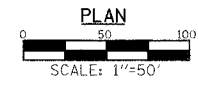

**SCHEDULE  
SEEDING CLASS 2 & MULCH, METHOD 2**

LOCATION	QUANTITY (ACRE)
STA. 20+00 TO STA. 25+00 35' LT. TO 40' RT.	0.8
<b>TOTAL</b>	<b>0.8</b>

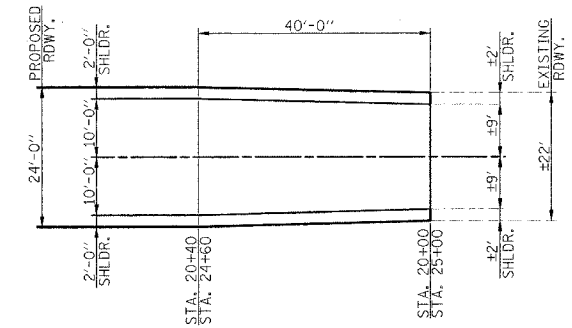

**ROADWAY TRANSITION DETAIL**

**SCHEDULE  
TREE REMOVAL (6 TO 15 UNITS DIAMETER)**

LOCATION	QUANTITY (UNIT)
STA. 23+83 70' LT.	12
STA. 23+83 94' LT.	14
<b>TOTAL</b>	<b>26</b>

**SCHEDULE  
TREE REMOVAL (OVER 15 UNITS DIAMETER)**

LOCATION	QUANTITY (UNIT)
STA. 22+92 28' LT.	32
<b>Total</b>	<b>32</b>

**GUARDRAIL LAYOUT PLAN  
(N.E. & S.W. CORNERS)**

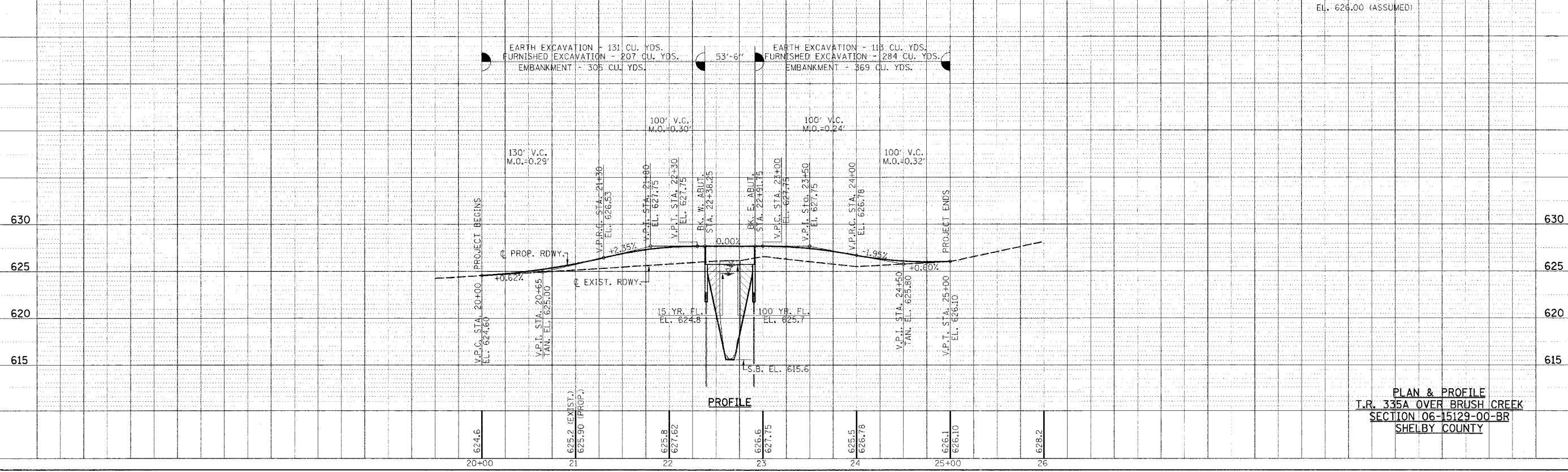
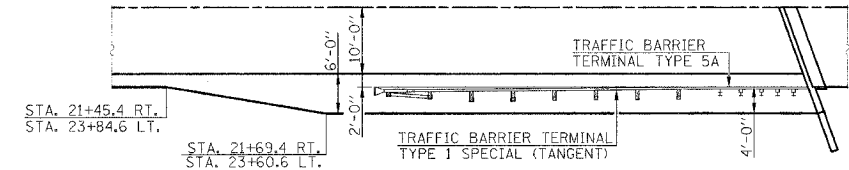

**PLAN & PROFILE  
I.R. 335A OVER BRUSH CREEK  
SECTION 06-15129-00-BR  
SHELBY COUNTY**

DATE: \_\_\_\_\_ BY: \_\_\_\_\_  
 PROJECT: \_\_\_\_\_  
 DRAWING NO.: \_\_\_\_\_  
 SHEET NO.: \_\_\_\_\_

DATE: \_\_\_\_\_ BY: \_\_\_\_\_  
 PROJECT: \_\_\_\_\_  
 DRAWING NO.: \_\_\_\_\_  
 SHEET NO.: \_\_\_\_\_

DATE: \_\_\_\_\_ BY: \_\_\_\_\_  
 PROJECT: \_\_\_\_\_  
 DRAWING NO.: \_\_\_\_\_  
 SHEET NO.: \_\_\_\_\_