

F.A.P. RTE.	SECTION	COUNTY	TOTAL SHEETS	SHEET NO.
869	104B-1, 104B-2	FRANKLIN	56	1

58

STATE OF ILLINOIS  
DEPARTMENT OF TRANSPORTATION  
DIVISION OF HIGHWAYS

**PROPOSED  
HIGHWAY PLANS**

FAP ROUTE 869 (ILLINOIS 14)  
SECTION 104B-1, 104B-2  
FRANKLIN COUNTY

C-99-063-02

PROJECT: F-0869(029)

**STRUCTURE REPLACEMENTS OVER  
ANDY CREEK AND TRIBUTARY TO ANDY CREEK**

FOR INDEX OF SHEETS, SEE SHEET NO. 2  
FOR SUMMARY OF QUANTITIES, SEE SHEET NO. 3

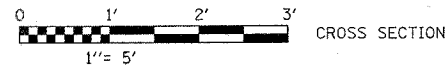
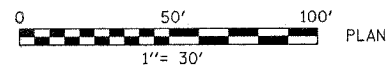
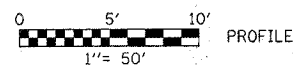
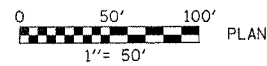

**TRAFFIC DATA**

2008 ADT = 6140  
7.5% TRUCKS  
POSTED SPEED = 55 MPH

PROPOSED BRIDGE OVER ANDY CREEK  
STRUCTURE NO. 028-0076  
SINGLE SPAN STEEL W36 BRIDGE;  
87'-0" BK TO BK ABUTMENTS; 0° SKEW  
¢ STRUCTURE STA 603+80.00  
EXISTING SN 028-0017

PROPOSED CULVERT OVER TRIBUTARY TO  
ANDY CREEK  
STRUCTURE NO. 028-2016  
DOUBLE BARREL 10'X10' CULVERT;  
43'-0" OUT TO OUT @ RIGHT ANGLES; 5° SKEW  
¢ STRUCTURE STA 579+10.00  
EXISTING SN 028-0065

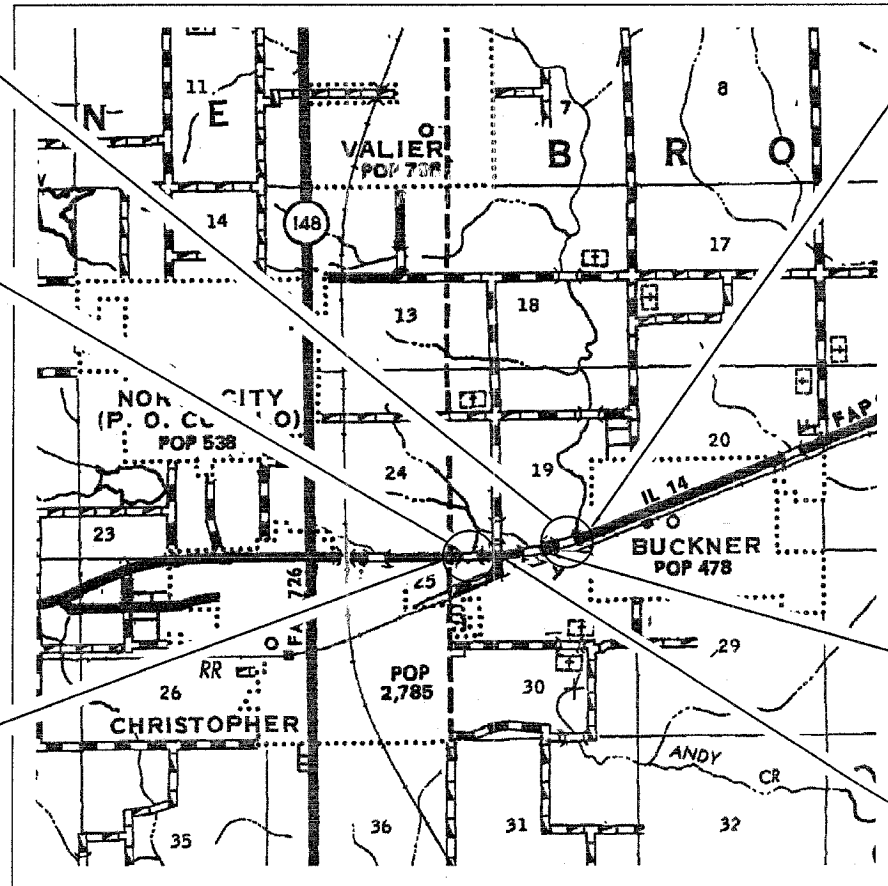

(028-0076) ENDS  
STA 604+59.50

(028-0076) BEGINS  
STA 603+00.50

(028-2016) BEGINS  
STA 578+72.50

(028-2016) ENDS  
STA 579+37.50

GROSS LENGTH OF PROJECT = 224'-0"

SN 028-2016  
ROADWAY LENGTH = 42'-6"  
CULVERT LENGTH = 22'-6"  
NET LENGTH OF PROJECT = 65'-0"

SN 028-0076  
ROADWAY LENGTH = 72'-0"  
BRIDGE LENGTH = 87'-0"  
NET LENGTH OF PROJECT = 159'-0"

D-99-004-05



LOCATION OF SECTION INDICATED THIS: — ■ —

PROJECT ENGINEER: DAVID PICHE (618)-351-5227  
DESIGNER: T. WAYNE HALSTEAD

BROWNING TOWNSHIP

FULL SIZE PLANS HAVE BEEN PREPARED USING STANDARD  
ENGINEERING SCALES. REDUCED SIZED PLANS WILL NOT  
CONFORM TO STANDARD SCALES. IN MAKING MEASUREMENTS  
ON REDUCED PLANS, THE ABOVE SCALES MAY BE USED.

J.U.L.I.E.  
JOINT UTILITY LOCATION INFORMATION FOR EXCAVATION  
1-800-892-0123

CONTRACT NO. 98775

COUNTY: FRANKLIN SECTIONS: 104B-1, 104B-2 ROUTE: FAP 869 (IL 14)

STATE OF ILLINOIS  
DEPARTMENT OF TRANSPORTATION  
DIVISION OF HIGHWAYS

SUBMITTED May 8, 2007  
Man C. Rami  
DEPUTY DIRECTOR OF HIGHWAYS, REGION ENGINEER

June 29, 2007  
Eric E. Harsh  
ENGINEER OF DESIGN AND ENVIRONMENT

June 29, 2007  
Milton R. Soes, P.E.  
DIRECTOR OF HIGHWAYS, CHIEF ENGINEER

**PRINTED BY THE AUTHORITY  
OF THE STATE OF ILLINOIS**