



FAP RTE	SECTION	COUNTY	TOTAL SHEETS	SHEET NO.
328	(105)XBR	WHITE	42	7
STA. 594+00		TO STA. 603+00		
FED. ROAD DIST. NO.		ILLINOIS	FED. AID PROJECT	

SCHEDULE OF QUANTITIES

STEEL RAILING (TEMPORARY)

STATION	TO	STATION	FEET
598+32		599+20	88
TOTAL			88

TEMPORARY CONCRETE BARRIER

STATION	TO	STATION	FEET
596+82		598+32	150
599+20		600+70	150
TOTAL			300

- TEMPORARY BRIDGE TRAFFIC SIGNALS - 1 EACH
- TEMPORARY RUMBLE STRIPS - 6 EACH
- IMPACT ATTENUATORS, TEMPORARY (NON-REDIRECTIVE), TEST LEVEL 3 - 2 EACH
- TEMPORARY TRAFFIC BARRIER TERMINAL, TYPE 11 - 2 EACH

GENERAL NOTES

1. TRAFFIC CONTROL SHALL BE ERECTED AS SHOWN AND ACCORDING TO "TRAFFIC CONTROL AND PROTECTION, STANDARD 701321."
2. SEE SPECIAL PROVISIONS FOR ADDITIONAL TRAFFIC CONTROL REQUIREMENTS.
3. COORDINATE LOCATION OF SIGNALS WITH FINAL WORK AS DIRECTED BY THE ENGINEER.
4. CONSTRUCT TEMPORARY RUMBLE STRIPS AT LOCATIONS SHOWN ON STANDARD 701321.
5. STEEL RAILING (TEMPORARY) AND TEMPORARY CONCRETE BARRIER SHALL BE CONNECTED ACCORDING TO "TRAFFIC BARRIER TERMINAL TYPE 11, STANDARD 631051."
6. EXISTING TRAFFIC CONTROL PRESENT AT THE BRIDGE SITE IS TO REMAIN OPERATIONAL UNTIL STAGE I TC&P IS IMPLEMENTED. REMOVAL OF THE EXISTING TRAFFIC CONTROL WILL BE PAID FOR AS "TEMPORARY TRAFFIC CONTROL REMOVAL."

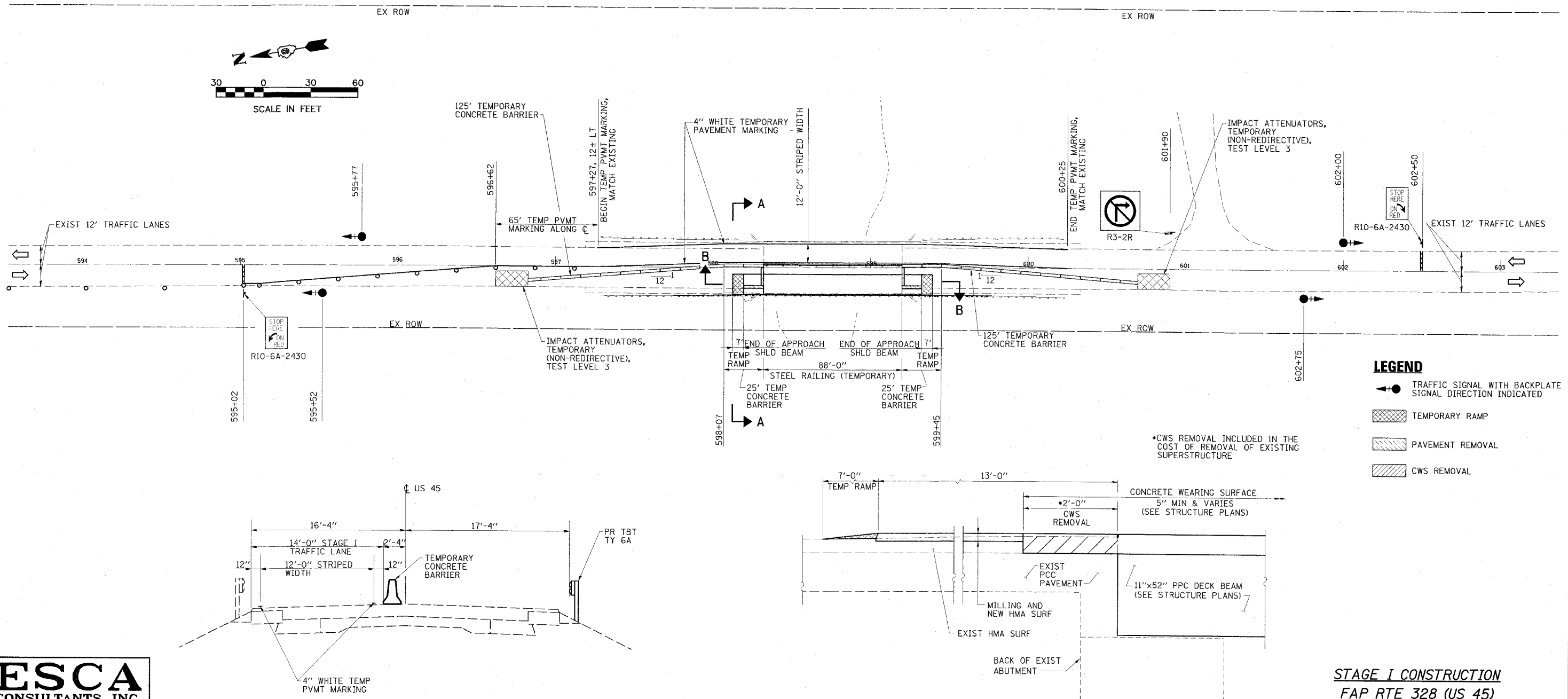
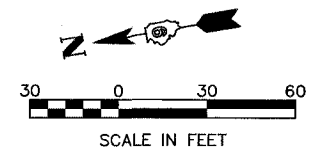

LEGEND

- TRAFFIC SIGNAL WITH BACKPLATE SIGNAL DIRECTION INDICATED
- ▨ TEMPORARY RAMP
- ▨ PAVEMENT REMOVAL
- ▨ CWS REMOVAL

*CWS REMOVAL INCLUDED IN THE COST OF REMOVAL OF EXISTING SUPERSTRUCTURE

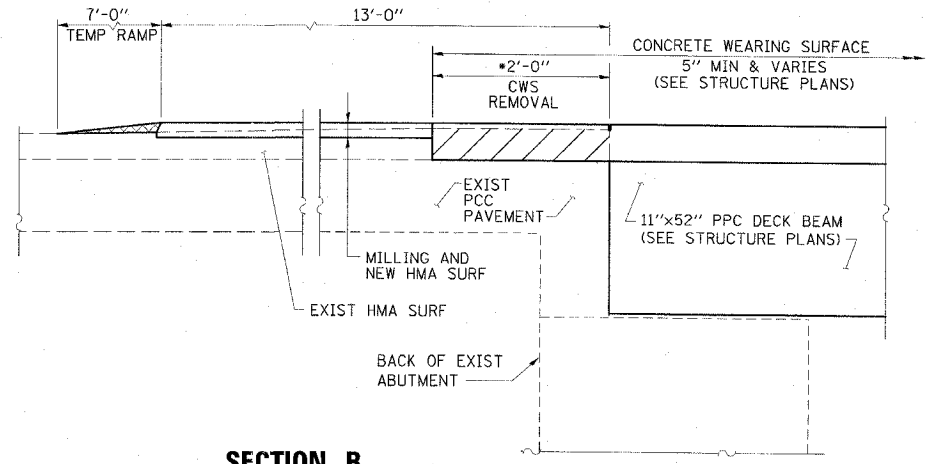
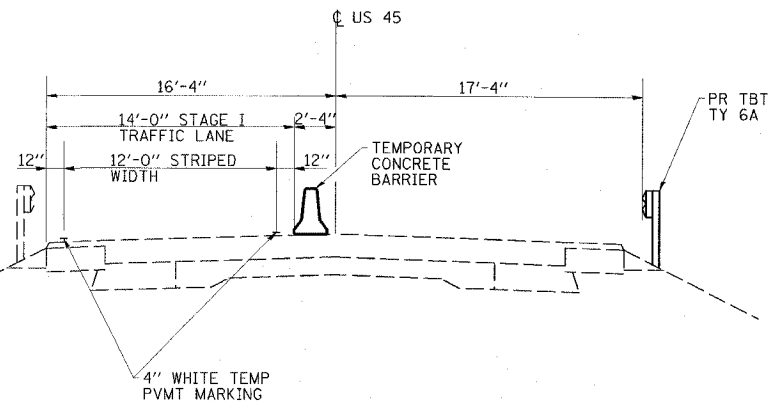

ESCA CONSULTANTS, INC.

DESIGNED BY:	JMS/MTD	02/07
DRAWN BY:	JPC	02/07
CHECKED BY:	MTD	02/07
APPROVED BY:	RDP	04/07

STAGE I CONSTRUCTION
FAP RTE 328 (US 45)
SECTION (105)XBR
WHITE COUNTY

DATE = #DATE#
 FILE NAME = #FILE#
 PLOT SCALE = #SCALE#
 REFERENCE = #REF#