

JUN 08, 2007 9:57 AM CAH
 \\AIRPORTS\LITCHFIELD\814-07APN\AIRPORT\SHEETS\R-121CON.DWG - STA. 13+25 TO STA. 18+00

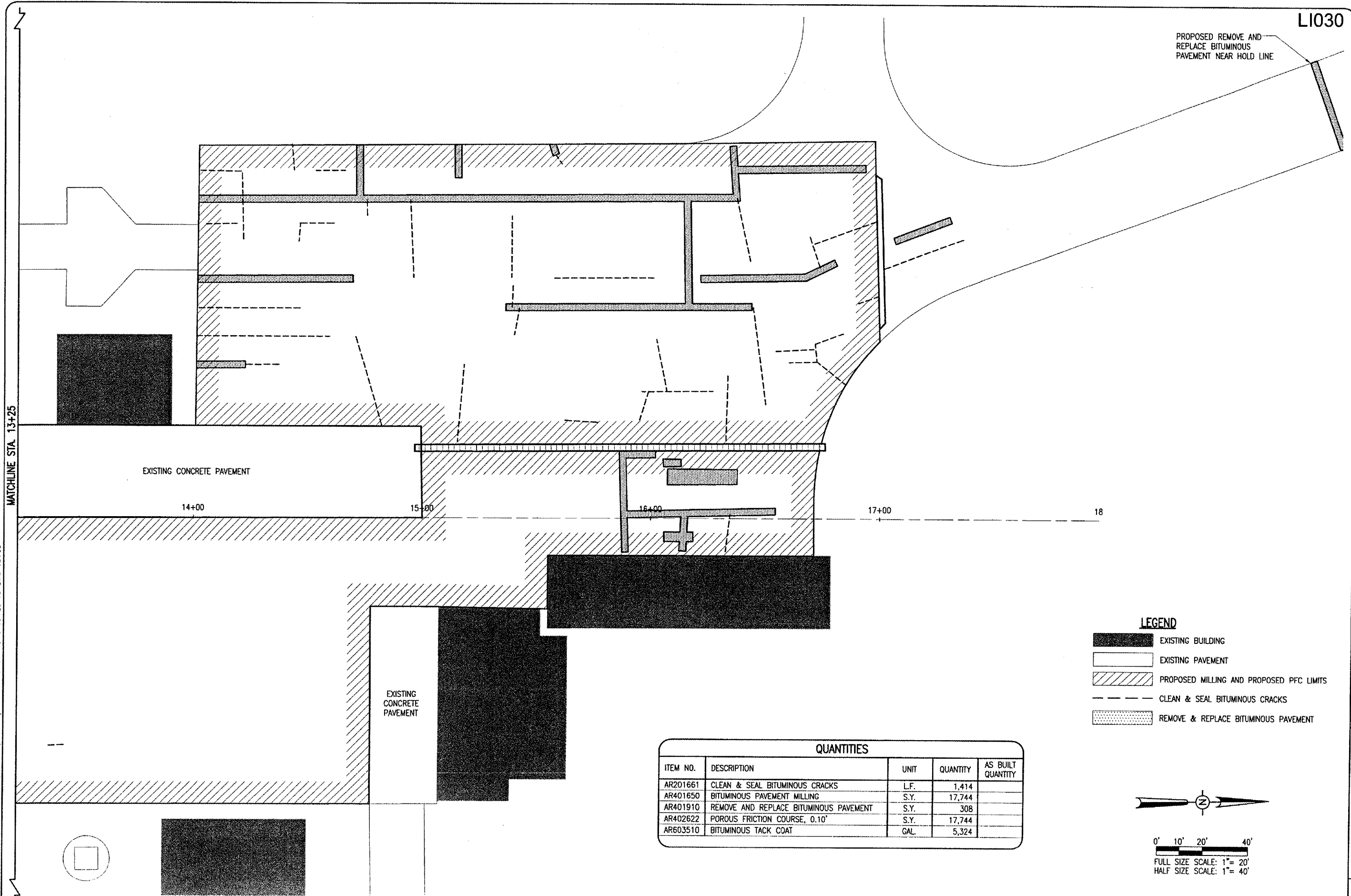

PROPOSED REMOVE AND REPLACE BITUMINOUS PAVEMENT NEAR HOLD LINE

L1030

MATCHLINE STA. 13+25

EXISTING CONCRETE PAVEMENT

14+00

15+00

16+00

17+00

18

EXISTING CONCRETE PAVEMENT

LEGEND

- EXISTING BUILDING
- EXISTING PAVEMENT
- PROPOSED MILLING AND PROPOSED PFC LIMITS
- CLEAN & SEAL BITUMINOUS CRACKS
- REMOVE & REPLACE BITUMINOUS PAVEMENT

QUANTITIES				
ITEM NO.	DESCRIPTION	UNIT	QUANTITY	AS BUILT QUANTITY
AR201661	CLEAN & SEAL BITUMINOUS CRACKS	L.F.	1,414	
AR401650	BITUMINOUS PAVEMENT MILLING	S.Y.	17,744	
AR401910	REMOVE AND REPLACE BITUMINOUS PAVEMENT	S.Y.	308	
AR402622	POROUS FRICTION COURSE, 0.10'	S.Y.	17,744	
AR603510	BITUMINOUS TACK COAT	GAL.	5,324	

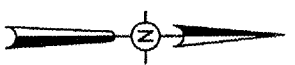

0' 10' 20' 40'
 FULL SIZE SCALE: 1" = 20'
 HALF SIZE SCALE: 1" = 40'

DATE	REVISION	BY

LITCHFIELD MUNICIPAL AIRPORT
 LITCHFIELD, ILLINOIS
 IL. PROJ.: 3LF-3645 A.I.P. PROJ.: 3-17-0063-B14

HD Project No. 814-07APND	
Electronic R-121CON.DWG	
Scale 1"=20'	
Date 01/31/07	
LAYOUT	ZSH 01/31/07
DRAWN	ZSH 01/31/07
REVIEWED	CAH 05/09/07

HANSON
 Hanson Professional Services Inc.
 1525 South Sixth Street
 Springfield, Illinois 62703-2886
 Offices Nationwide

PFC OVERLAY
 AIRCRAFT APRON
 PROPOSED
 CONSTRUCTION PLAN
 STA. 13+25 TO STA. 18+00