

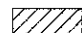

NOTES

- EXISTING SIDEWALK TO BE REMOVED TO FACILITATE DETECTABLE WARNING INSTALLATION. DETECTABLE WARNINGS SHALL FOLLOW IDOT HIGHWAY STANDARD 424006.
- CONCRETE PAD ELEVATIONS TO BE DETERMINED IN THE FIELD.
- LOCATIONS FOR BIKE SHELTERS AND BICYCLE RACKS TO BE DETERMINED IN THE FIELD.

LEGEND

-  SIDEWALK REMOVAL
-  PAVEMENT REMOVAL/CONCRETE PAD
-  BRICK PAVER REMOVAL

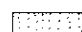
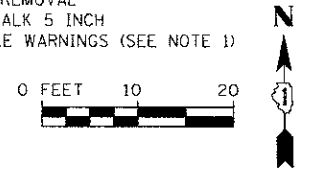
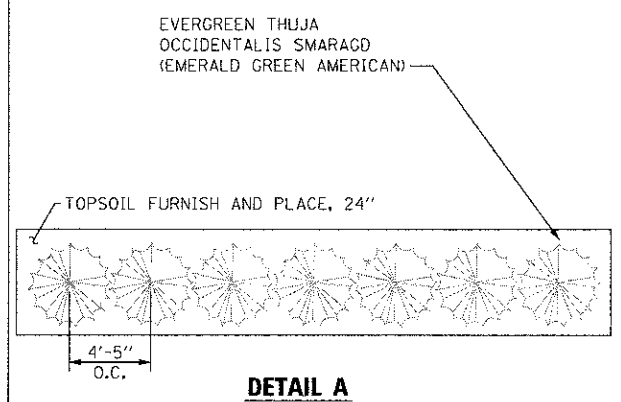
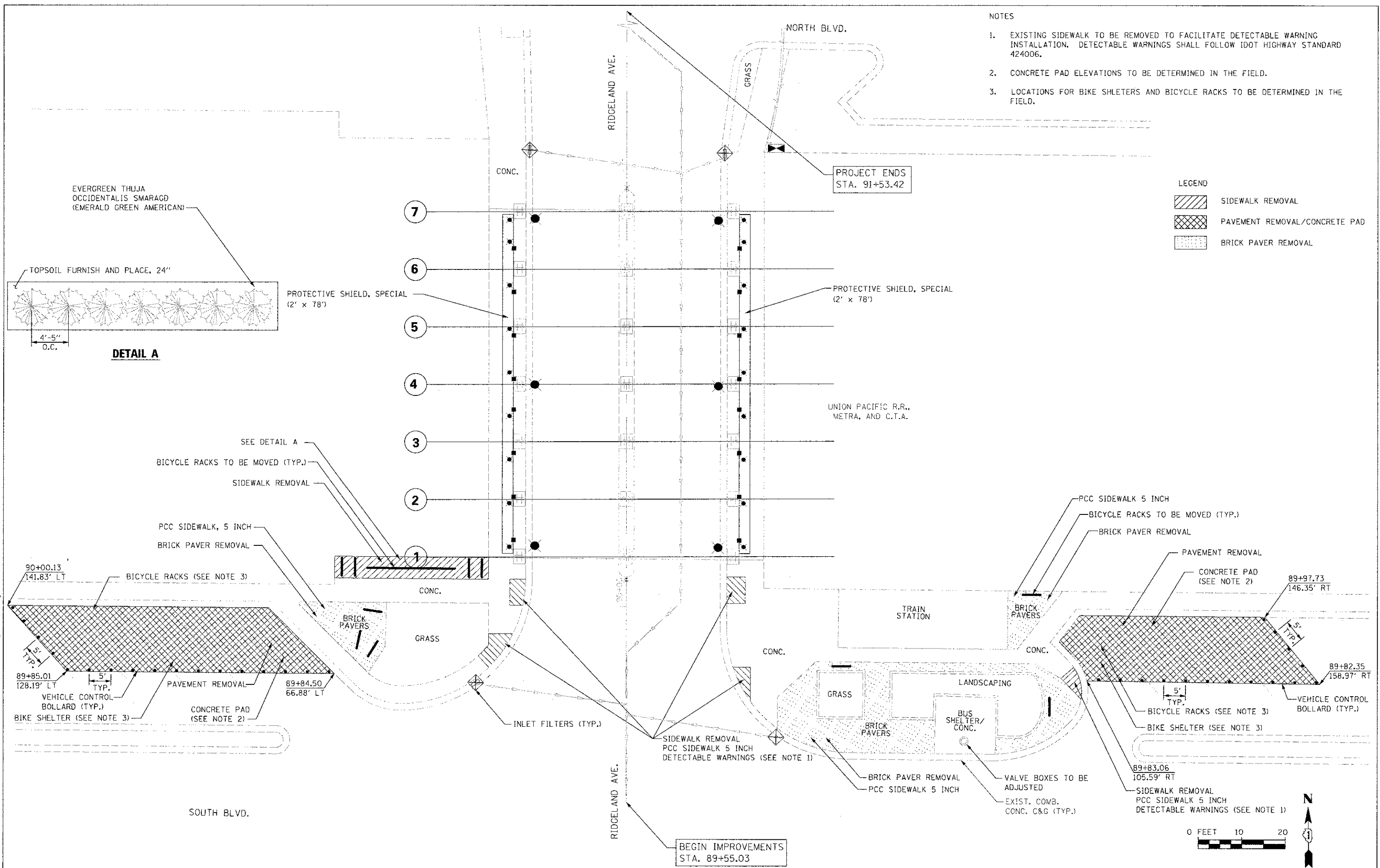

FILE NAME = S:\JUL16788-6795\6784\012\Access\CADD\_Sheets\0163722-ridgeland-plan.dgn

**SA STRAND ASSOCIATES**  
 1170 SOUTH HOUSLEY ROAD  
 JOLIET, IL, INOIS 60431  
 (815) 744-4206

USER NAME = amandej  
 DESIGNED - JDM  
 DRAWN - JKP  
 CHECKED - MTC  
 DATE - 05-07-2012  
 PLOT SCALE = 10,0000' / 1" = 1000'  
 PLOT DATE = 5/30/2012

REVISED -  
 REVISED -  
 REVISED -  
 REVISED -

**STATE OF ILLINOIS  
 DEPARTMENT OF TRANSPORTATION**

**RIDGE LAND AVENUE PLAN**  
 SCALE: AS SHOWN SHEET NO. OF SHEETS STA. TO STA.

F.A.U. RTE.	SECTION	COUNTY	TOTAL SHEETS	SHEET NO.
2783	11-00253-00-LS	COOK	24	11

CONTRACT NO. 63722  
 ILLINOIS FED. AID PROJECT