

CCQA CONCRETE

08-03-12 LETTING ITEM 030

STATE OF ILLINOIS  
DEPARTMENT OF TRANSPORTATION  
DIVISION OF HIGHWAYS

PROPOSED  
HIGHWAY PLANS

ROUTE VARIOUS  
SECTION D4 FLASHING YELLOW ARROWS 2012  
PROJECT HSIP-0005(904)  
TYPE of IMPROVEMENT HSIP  
KNOX COUNTY  
C-94-077-12

F.A.U. RTE.	SECTION	COUNTY	TOTAL SHEETS	SHEET NO.
6791	D4 FYA 2012	KNOX	29	1
		ILLINOIS	CONTRACT NO. 68A98	

D-94-044-12

FOR INDEX OF SHEETS AND STANDARDS,  
SEE SHEET NO. 2

FAU 6791 (US 150)  
ADT = 10,000 (2010)  
MU = 1.19%  
SU = 2.38%

FAU 6801 (IL 41)  
ADT = 6,350 (2011)  
MU = 2.36%  
SU = 2.76%

FAU 6801 (Seminary St)  
ADT = 7200 (2007)  
MU = 3.82%  
SU = 0.83%

DESIGN DESIGNATION  
CLASS II TRUCK ROUTE

FUNCTIONAL CLASSIFICATION  
MINOR ARTERIAL

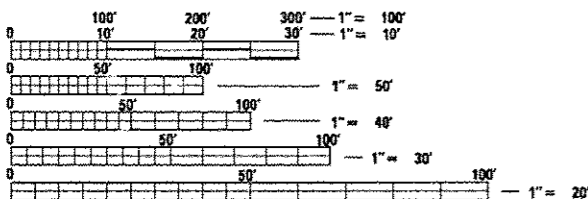

FULL SIZE PLANS HAVE BEEN PREPARED USING STANDARD  
ENGINEERING SCALES. REDUCED SIZED PLANS WILL NOT  
CONFORM TO STANDARD SCALES. IN MAKING MEASUREMENTS  
ON REDUCED PLANS, THE ABOVE SCALES MAY BE USED.

J.U.L.I.E.  
JOINT UTILITY LOCATION INFORMATION FOR EXCAVATION  
1-800-892-0123  
OR 811

PROJECT ENGINEER SEAN COYLE (309) 671-3456  
PROJECT MANAGER JENNIFER RUDZINSKI (309) 671-3457  
CATALOG NO. 034796-00D  
CONTRACT NO. 68A98

GROSS LENGTH = 380 FT. = .07 MILE  
NET LENGTH = 380 FT. = .07 MILE

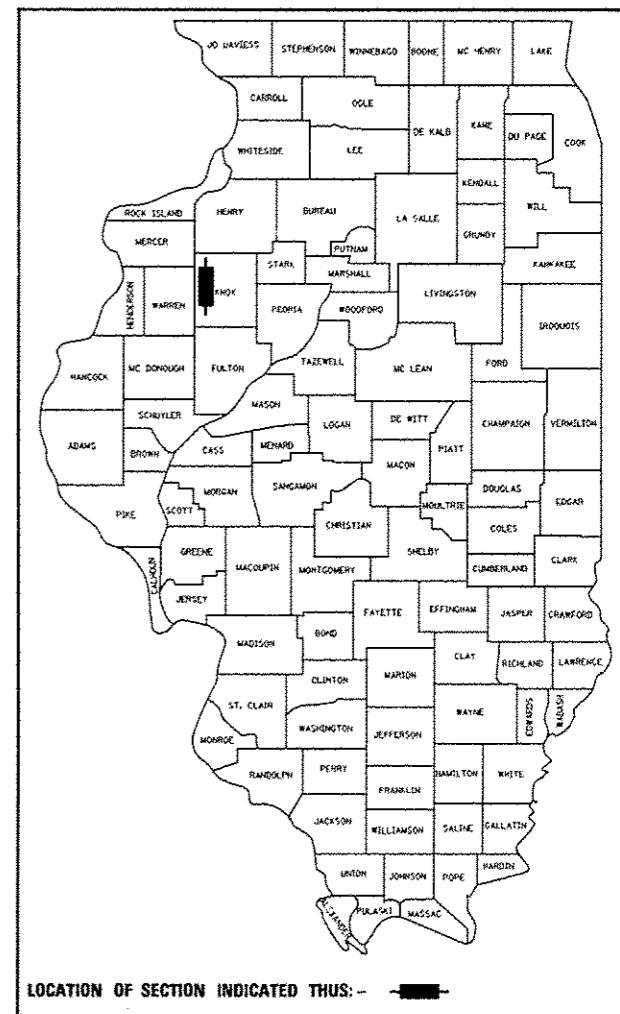

DESCRIPTION OF WORK:

THE PROPOSED IMPROVEMENT CONSISTS OF INSTALLATION  
OF FLASHING YELLOW ARROWS AT 10 LOCATIONS IN  
GALESBURG, AND CONSTRUCTION OF AN OFFSET LEFT  
TURN AT US 150 AND CARL SANDBURG DRIVE.

STATE OF ILLINOIS  
DEPARTMENT OF TRANSPORTATION  
DIVISION OF HIGHWAYS

SUBMITTED May 21 2012

Joseph E. Brown  
DEPUTY DIRECTOR OF HIGHWAYS, REGION ENGINEER

June 29 2012  
John D. Baranzelli, P.E.  
acting ENGINEER OF DESIGN AND ENVIRONMENT

June 29 2012  
William R. Frey  
acting DIRECTOR OF HIGHWAYS, CHIEF ENGINEER

PRINTED BY THE AUTHORITY  
OF THE STATE OF ILLINOIS

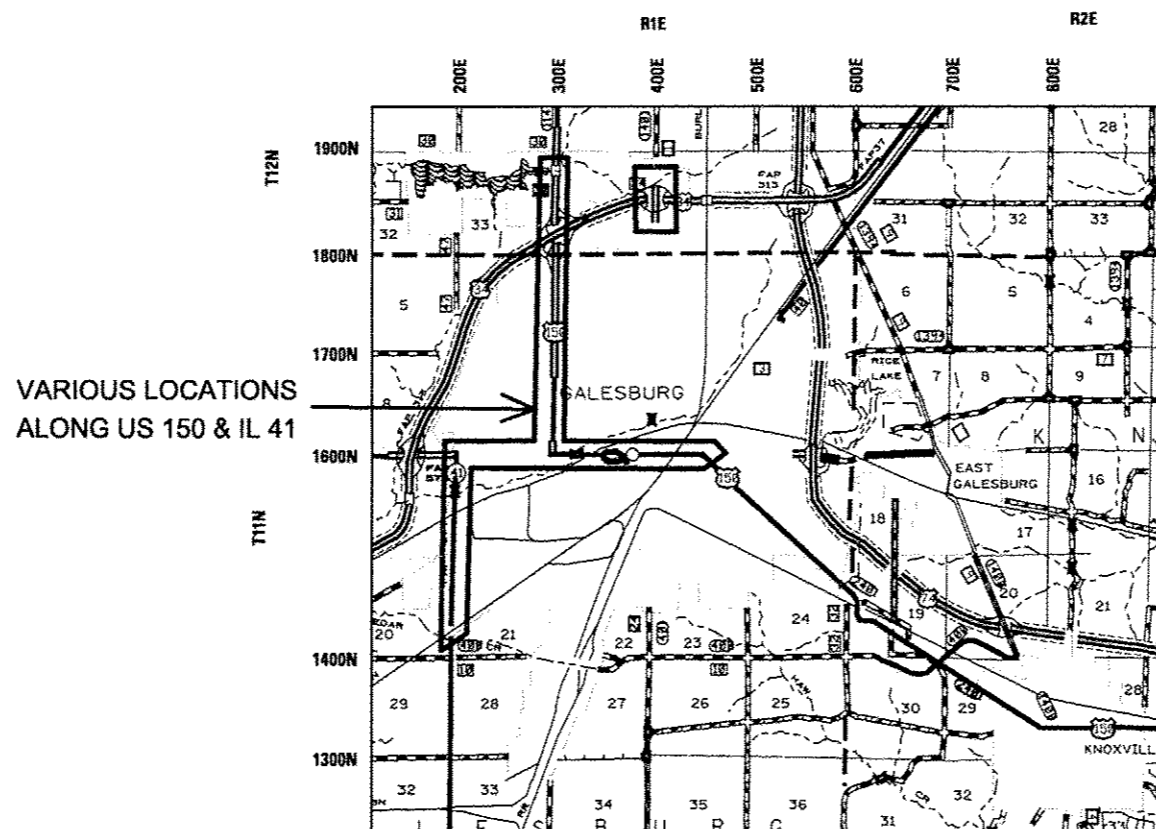

# INDEX OF SHEETS

SHEET NO.	DESCRIPTION
1	COVER SHEET
2	INDEX OF SHEETS
3 - 4	GENERAL NOTES
5	PROJECT SPECIFIC NOTES
6 - 7	TYPICAL SECTIONS
8 - 11	SUMMARY OF QUANTITIES
12 - 13	SCHEDULE OF QUANTITIES
14	REMOVAL ITEMS
15	PROPOSED PLAN
16	PAVEMENT MARKING DETAIL
17 - 19	TRAFFIC SIGNAL DETAILS
20 - 23	SIDEWALK DETAILS
24	INLETS, SPECIAL DETAIL
25 - 27	DISTRICT DETAILS
28 - 29	CROSS SECTIONS

# STANDARDS

STANDARD NO.	DESCRIPTION
000001-06	STANDARD SYMBOLS, ABBREVIATIONS AND PATTERNS
001001-02	AREAS OF REINFORCEMENT BARS
420001-07	PAVEMENT JOINTS
420101-04	24' (7.2m) JOINTED PCC PAVEMENT
424001-06	CORNER PARALLEL CURB RAMPS FOR SIDEWALKS
424011	PERPENDICULAR CURB RAMPS FOR SIDEWALKS
424031	MEDIAN PEDESTRIAN CROSSINGS
606301-04	PC CONCRETE ISLANDS AND MEDIANS
701422-04	URBAN LANE CLOSURE, MULTILANE INTERSECTION
701701-08	LANE CLOSURE, MULTILANE, FOR SPEEDS > 45 MPH TO 55 MPH
701801-05	SIDEWALK CORNER OR CROSSWALK CLOSURE
701901-02	TRAFFIC CONTROL DEVICES
780001-03	TYPICAL PAVEMENT MARKINGS
781001-03	TYPICAL APPLICATIONS RAISED REFLECTIVE PAVEMENT MARKERS
814001-02	HANDHOLES
877001-05	STEEL MAST ARM ASSEMBLY AND POLE 16' THROUGH 55'
878001-09	CONCRETE FOUNDATION DETAILS
880006-01	TRAFFIC SIGNAL MOUNTING DETAILS - POST & BRACKET MOUNT
886001-01	DETECTOR LOOP INSTALLATIONS
886006-01	TYPICAL LAYOUTS FOR DETECTION LOOPS
701101-02	
701426-04	

FILE NAME *	USER NAME = rudzinski.jl	DESIGNED - J.R.	REVISED -	<b>STATE OF ILLINOIS DEPARTMENT OF TRANSPORTATION</b>	<b>INDEX OF SHEETS &amp; STANDARDS</b>	F.A.U. RTE.	SECTION	COUNTY	TOTAL SHEETS	SHEET NO.	
c:\pwork\pwork\rudzinski.jl\0301011\04	88A98-ehs-10S.dgn	DRAWN - J.R.	REVISED -			6791	D4 FYA 2012	KNOX	29	2	
	PLOT SCALE = 20.0000' / 1" =	CHECKED -	REVISED -			SCALE: SHEET OF SHEETS STA. TO STA.		ILLINOIS FED. AID PROJECT		CONTRACT NO. 68A98	
	PLOT DATE = 6/18/2012	DATE -	REVISED -								

**AVAILABILITY OF ELECTRONIC FILES**

MICRO STATION AND GEOPAK FILES OF THIS PROJECT WILL BE MADE AVAILABLE TO THE CONTRACTOR. IF THERE IS A CONFLICT BETWEEN THE ELECTRONIC FILES AND THE PRINTED CONTRACT PLANS AND DOCUMENTS, THE PRINTED CONTRACT PLANS AND DOCUMENTS SHALL TAKE PRECEDENCE OVER THE ELECTRONIC FILES. THE CONTRACTOR SHALL ACCEPT ALL RISK ASSOCIATED WITH USING THE ELECTRONIC FILES AND SHALL HOLD THE DEPARTMENT HARMLESS FOR ANY ERRORS OR OMISSIONS IN THE ELECTRONIC FILES AND THE DATA CONTAINED THEREIN. ERRORS OR DELAYS RESULTING FROM THE USE OF THE ELECTRONIC BY THE CONTRACTOR SHALL NOT RESULT IN AN EXTENSION OF TIME FOR ANY INTERIM OR FINAL COMPLETION DATE OR SHALL NOT BE CONSIDERED CAUSE FOR ADDITIONAL COMPENSATION. THE CONTRACTOR SHALL NOT USE, SHARE, OR DISTRIBUTE THESE ELECTRONIC FILES EXCEPT FOR THE PURPOSE OF CONSTRUCTING THIS CONTRACT. ANY CLAIMS BY THIRD PARTIES DUE TO USE OR ERRORS SHALL BE THE RESPONSIBILITY OF THE CONTRACTOR. THE CONTRACTOR SHALL INCLUDE THIS DISCLAIMER WITH THE TRANSFER OF THESE ELECTRONIC FILES TO ANY OTHER PARTIES AND SHALL INCLUDE APPROPRIATE LANGUAGE BINDING THEM TO SIMILAR RESPONSIBILITIES.

**UTILITIES – LOCATIONS/INFORMATION ON PLANS**

THE LOCATION OF EXISTING WATER MAINS, GAS MAINS, SEWERS, ELECTRONIC POWER LINES, TELEPHONE LINES AND OTHER UTILITIES AS SHOWN ON THE PLANS ARE BASED ON CAREFUL FIELD INVESTIGATION AND THE BEST INFORMATION AVAILABLE, BUT THEY ARE NOT GUARANTEED. UNLESS ELEVATIONS ARE SHOWN – ALL UTILITIES LOCATIONS SHOWN ON THE CROSS SECTIONS ARE BASED ON THE APPROXIMATE DEPTH SUPPLIED BY THE UTILITY COMPANY. IT SHALL BE THE CONTRACTOR'S RESPONSIBILITY TO ASCERTAIN THEIR EXACT LOCATION FROM THE UTILITY COMPANIES AND BY FIELD INSPECTION.

**PLAN ELEVATIONS – USGS MEAN SEA LEVEL DATUM**

ALL ELEVATIONS SHOWN ON THE PLANS ARE ESTABLISHED FROM THE USGS MEAN SEA LEVEL DATUM

**PROPERTY OWNER ACCESS REQUIREMENTS**

ACCESS MUST BE MAINTAINED TO ALL EXISTING PROPERTIES DURING CONSTRUCTION PER ARTICLE 107.09 UNLESS ARRANGEMENTS ARE MADE IN WRITING BY THE CONTRACTOR WITH THE PROPERTY OWNERS WITH A COPY TO THE ENGINEER FOR SHORT TERM CLOSURES.

**EARTH EXCAVATION – INCIDENTAL TO CURB, GUTTER AND DRIVEWAYS**

EARTH EXCAVATION AND BACKFILL FOR THE PROPOSED CURB & GUTTER AND DRIVEWAY PAVEMENTS SHALL BE INCLUDED IN THE UNIT COST OF THE VARIOUS ITEMS.

**SIGNING**

SIGN LOCATIONS MAY VARY FROM THE STATIONS SHOWN ON THE PLANS IN ACCORDANCE WITH DIRECTIONS FROM THE ENGINEER AT THE TIME OF CONSTRUCTION. SIGN LOCATIONS MAY BE ADJUSTED IN THE FIELD TO AVOID ANY FOUND UTILITIES.

ALL WOOD POST LOCATIONS SHALL BE VERIFIED WITH THE BUREAU OF OPERATIONS, TRAFFIC SECTION, BEFORE INSTALLATION.

**ENVIRONMENTAL REVIEWS**

PRIOR TO THE USE OF ANY PROPOSED BORROW AREAS, USE AREAS (TEMPORARY ACCESS ROADS, DETOURS, RUN-AROUNDS, ETC.) AND/OR WASTE AREAS, THE CONTRACTOR SHALL FILE THE REQUIRED ENVIRONMENTAL RESOURCE REQUEST ACCORDING TO SECTION 107.22 OF THE STANDARD SPECIFICATIONS. THESE SURVEYS ARE REQUIRED IN ORDER FOR THE DEPARTMENT TO CONDUCT CULTURAL AND BIOLOGICAL RESOURCE SURVEYS FOR THE PROPOSED SITE.

PRIOR TO ANY WASTE MATERIALS BEING REMOVED FROM THE CONSTRUCTION SITE THE REQUIRED ENVIRONMENTAL RESOURCE SURVEYS WILL NEED TO BE OBTAINED AND FILED BY THE CONTRACTOR. EXCESS WASTE PRODUCTS REMOVED FROM THE CONSTRUCTION SITE SHALL BE DISPOSED OF AS REQUIRED IN SECTION 202.03.

ANY PROTRUDING METAL BARS SHALL BE REMOVED PRIOR TO THE DISPOSAL OF BROKEN CONCRETE AT APPROVED DISPOSAL SITES.

THE REQUIRED ENVIRONMENTAL RESOURCE DOCUMENTATION SHALL INCLUDE THE FOLLOWING

\*BDE FORM 2289 (ENVIRONMENTAL SURVEY REQUEST)

\*A LOCATION MAP SHOWING THE SIZE LIMITS AND LOCATION OF THE USE AREA

\*SIGNED PROPERTY OWNER AGREEMENT FORM-D4 PI0100

\*COLOR PHOTOGRAPHS DEPICTING THE USE AREA

\*BORROW AREA ENTRY AGREEMENT FORM-D4 PI0101

PLEASE NOTE THAT A MINIMUM OF TWO WEEKS SHALL BE ALLOWED FOR THE DISTRICT TO OBTAIN THE REQUIRED ENVIRONMENTAL CLEARANCES.

FILE NAME = D468A98-shr-105.dgn	USER NAME = rudzinskijl	DESIGNED - JLR	REVISED -	<b>STATE OF ILLINOIS DEPARTMENT OF TRANSPORTATION</b>	<b>GENERAL NOTES</b>				F.A.U RTE.	SECTION	COUNTY	TOTAL SHEETS	SHEET NO.
	PLOT SCALE = 28,800' / 1" = 1"	DRAWN - JLR	REVISED -						6791	D4 FYA 2012	KNOX	29	3
	PLOT DATE = 5/23/2012	CHECKED -	REVISED -		SCALE: SHEET OF SHEETS STA. TO STA.				CONTRACT NO. 68A98				
		DATE -	REVISED -		ILLINOIS FED. AID PROJECT								

**EXISTING DRAINAGE PIPES CONNECTED TO NEW STRUCTURES**

IN ACCORDANCE WITH SECTION 602 OF THE STANDARD SPECIFICATIONS, THE CONNECTING OF EXISTING DRAIN TILES, PIPE CULVERTS, OR STORM SEWERS TO THE PROPOSED DRAINAGE SYSTEM STRUCTURES WILL NOT BE PAID FOR SEPERATELY BUT SHALL BE CONSIDERED AS INCLUDED IN THE PAY ITEMS PROVIDED.

**MEDIAN AND ISLAND NOSES**

WHEN CONSTRUCTING MEDIAN AND ISLAND NOSES THE FOLLOWING CRITERIA SHOULD BE USED:

\*BARRIER CURB SHALL BE USED TO CONSTRUCT NOSES WHEN THE MEDIAN OR ISLAND SURROUNDS A MAST ARM OR OTHER NON-BREAKAWAY FOUNDATION.

\*RAMPED NOSES SHALL BE USED ON MEDIAN OR ISLANDS WITH BREAKAWAY POSTS

**SIGN POST HOLES**

VERTICAL HOLES SHALL BE CONSTRUCTED IN THE ISLAND PAVEMENT AND/OR CONCRETE MEDIAN OF THE TYPE SPECIFIED OR CONCRETE MEDIAN SURFACE 4 INCHES (100MM). THE HOLES SHALL BE 24 INCHES (600MM) IN DIAMETER OR 24 INCHES (600MM) SQUARE AND THEY SHALL BE FREE OF ANY OBSTRUCTION, EXCEPT EARTH, FOR A DEPTH OF 5 FEET (1.5M) AT THE LOCATIONS SHOWN ON THE PLANS OR AS DIRECTED THE ENGINEER. ANY HOLES NOT USED FOR THE PLACEMENT OF SIGNS SHALL BE FILLED AND COMPACTED FLUSH WITH THE TOP OF THE ISLAND PAVEMENT, CONCRETE MEDIAN OF THE TYPES SPECIFIED, OR CONCRETE MEDIAN SURFACE 4 INCHES (100MM). THE TOP 3 INCHES OF THE SAID COMPACTED FILL SHALL CONSIST OF A HOT MIX ASPHALT MIXTURE. ALL HOLES IN WHICH THE SIGN POSTS ARE INSTALLED AT THE TIME OF THIS CONTRACT SHALL BE SIMILARLY FILLED.

THIS WORK, INCLUDING ANY REQUIRED PAVEMENT REMOVAL NECESSARY TO CONSTRUCT THE SIGN POST HOLES, WILL NOT BE PAID FOR SEPERATELY BUT SHALL BE INCLUDED IN THE CONTRACT UNIT PRICE PER SQUARE FOOT (SQUARE METER) FOR ISLAND PAVEMENT AND/OR CONCRETE MEDIAN OF THE TYPE SPECIFIED, OR CONCRETE MEDIAN SURFACE, 4 INCHES (100MM)

**TRANSITION PAVEMENT METHOD - NEWOLD CONSTRUCTION**

THREE METER (10FT)(3M) TRANSITIONS SHALL BE USED TO MATCH PROPOSED ITEMS OF WORK TO EXISTING ITEMS IN THE FIELD UNLESS OTHERWISE SHOWN. THE TRANSITION SHALL BE PAID FOR AT THE CONTRACT UNIT PRICE FOR THE PROPOSED ITEM OF WORK SPECIFIED.

**ENGINEERS FIELD OFFICE**

ADD THE FOLLOWING SENTENCE TO THE END OF THE PARAGRAPH 670.02(i) AND 670.04(e): ALL THE TELEPHONE LINES PROVIDED SHALL HAVE UNPUBLISHED NUMBERS.

**COMMITMENTS**

COMMITMENTS ARE NOT TO BE ALTERED WITHOUT THE WRITTEN APPROVAL OF ALL PARTIES TO WHICH THE COMMITMENT WAS MADE.

**NO COMMITMENTS HAVE BEEN MADE.**

FILE NAME = 04EBA98-shr-105.dgn	USER NAME = rudzinskij	DESIGNED - JLR	REVISED -	<b>STATE OF ILLINOIS DEPARTMENT OF TRANSPORTATION</b>	<b>GENERAL NOTES</b>				F.A.U RTE.	SECTION	COUNTY	TOTAL SHEETS	SHEET NO.
	PLOT SCALE = 20.0/13 ' / in.	DRAWN - JLR	REVISED -						6791	04 FYA 2012	KNOX	29	4
PLOT DATE = 5/23/2012	CHECKED -	REVISED -	CONTRACT NO. 68A98										
	DATE -	REVISED -	SCALE:		SHEET	OF	SHEETS	STA.	TO STA.	ILLINOIS FED. AID PROJECT			

THE ENGINEER SHALL CONTACT RANDY LANINGA AT 309-671-4477 TO SCHEDULE THE INSTALLATION OF ADDITIONAL SIGNS NEEDED FOR THE INTERSECTION OF US 150 & CARL SANDBURG DRIVE.

BEFORE THE CONTRACTOR CLOSES THE LEFT TURN LANE FROM SOUTHBOUND US 150 TO CARL SANDBURG DRIVE, THE CONTRACTOR AND ENGINEER SHALL CONTACT RANDY LANINGA AT 309-671-4477 TO DISCUSS MODIFYING SIGNAL TIMING TO ALLOW FOR LEFT TURNS FROM A TEMPORARY LEFT TURN LANE DURING THE CLOSURE OF THE PERMANENT LEFT TURN LANE.

WHEN THE EXISTING DRAINAGE STRUCTURES LOCATED AT STA 493+67 ARE REMOVED, ANY PIPES DRAINING INTO THE EXISTING STRUCTURES SHALL BE TIED INTO THE NEW DRAINAGE STRUCTURE.

THE REMOVAL OF PAVEMENT MARKINGS ON EXISTING SURFACES THAT ARE NOT GOING TO BE MILLED OR REMOVED SHALL BE DONE BY WATER BLASTING.

TIE BARS SHALL BE USED IN THE PROPOSED WIDENING TO TIE IT TO THE EXISTING PAVEMENT. TIE BARS SHALL ALSO BE USED IN THE PROPOSED CURB AND GUTTER TO TIE IT TO THE EXISTING PAVEMENT OR THE PROPOSED WIDENING. TIE BARS SHALL BE INSTALLED AS SHOWN IN HIGHWAY STANDARD 420001. THE COST OF THIS WORK SHALL BE INCLUDED IN THE VARIOUS PROPOSED CONCRETE ITEMS INVOLVED, AS NOTED IN ARTICLE 508.07 OF THE STANDARD SPECIFICATIONS.

EXISTING ADJACENT PAVEMENT IS JOINTED AT 15 FT. SPACING. PROPOSED JOINTS SHOULD BE LINED UP WITH ADJACENT EXISTING JOINTS. JOINT SPACING SHALL NOT EXCEED 15 FT.

FILE NAME = 0468A98-sh1-105.dgn	USER NAME = ruderakjtl	DESIGNED - JLR	REVISED -	<b>STATE OF ILLINOIS DEPARTMENT OF TRANSPORTATION</b>	<b>JOB SPECIFIC NOTES</b>	F.A.U. RTE.	SECTION	COUNTY	TOTAL SHEETS	SHEET NO.
	PLOT SCALE = 20.0/113 1/2 in.	DRAWN - JLR	REVISED -			6791	04 FYA 2012	KNOX	29	5
	PLOT DATE = 5/23/2012	CHECKED -	REVISED -			CONTRACT NO. 68A98				
	DATE -	REVISED -	SCALE:			SHEET	OF	SHEETS	STA.	TO





CODE NO.	ITEM	UNIT	TOTAL QUANTITY	CONSTRUCTION CODE			
				0021	0021	0021	0021
				FAU 6791	FAU 6801	FAU 6791	FAP 574
				90 FED/10 ST	90 FED/10 ST	90 F/5 ST/5 C	90 F/5 ST/5 C
20200100	EARTH EXCAVATION	CU YD	167.1	167.1			
31100910	SUB-BASE GRANULAR MATERIAL, TYPE A 12"	SQ YD	476.5	476.5			
42000546	PORTLAND CEMENT CONCRETE PAVEMENT 12 1/4", JOINTED	SQ YD	332	332			
42400800	DETECTABLE WARNINGS	SQ FT	60	60			
44000100	PAVEMENT REMOVAL	SQ YD	287	287			
44000500	COMBINATION CURB AND GUTTER REMOVAL	FOOT	380	380			
44000600	SIDEWALK REMOVAL	SQ FT	422	422			
44003100	MEDIAN REMOVAL	SQ FT	19	19			
44213200	SAW CUTS	FOOT	226.5	226.5			
60605000	COMBINATION CURB AND GUTTER, TYPE B-6. 24 ↑ CONCRETE	FOOT	22	22			
67100100	MOBILIZATION	L SUM	1	1			
70100320	TRAFFIC CONTROL AND PROTECTION, STANDARD 701422	L SUM	1	1			
70102635	TRAFFIC CONTROL AND PROTECTION, STANDARD 701701	L SUM	1	1			
70102640	TRAFFIC CONTROL AND PROTECTION, STANDARD 701801	L SUM	1	1			

URBAN

FILE NAME * D468A98-sht-105.dgn	USER NAME * ruzinskijl	DESIGNED - JLR	REVISED -
		DRAWN - JLR	REVISED -
	PLOT SCALE = 1/8" = 100.0000' / 1" = 100'	CHECKED -	REVISED -
	PLOT DATE = 5/23/2012	DATE - 5/23/2012	REVISED -

STATE OF ILLINOIS  
DEPARTMENT OF TRANSPORTATION

SUMMARY OF QUANTITIES

F.A.U. RTE. 6791	SECTION 04 FYA 2012	COUNTY KNOX	TOTAL SHEETS 293	SHEET NO. 13
ILLINOIS FED. AID PROJECT			CONTRACT NO. 68A98	



CODE NO.	ITEM	UNIT	URBAN TOTAL QUANTITY	CONSTRUCTION CODE			
				0021	0021	0021	0021
				FAU 6791 90 FED/10 ST	FAU 6801 90 FED/10 ST	FAU 6791 90 F/5 ST/5 C	FAP 574 90 F/5 ST/5 C
70103815	TRAFFIC CONTROL SURVEILLANCE	CAL DA	4	4			
70106800	CHANGEABLE MESSAGE SIGN	CAL MO	1	1			
70300100	SHORT TERM PAVEMENT MARKING	FOOT	208	208			
70301000	WORK ZONE PAVEMENT MARKING REMOVAL	SQ FT	69	69			
+ X 72000100	SIGN PANEL - TYPE 1	SQ FT	160	5	5	110	40
X 78009000	MODIFIED URETHANE PAVEMENT MARKING - LETTERS AND SYMBOLS	SQ FT	18	18			
X 78009008	MODIFIED URETHANE PAVEMENT MARKING - LINE 8"	FOOT	849	849			
X 78009012	MODIFIED URETHANE PAVEMENT MARKING - LINE 12"	FOOT	56.7	56.7			
X 78009024	MODIFIED URETHANE PAVEMENT MARKING - LINE 24"	FOOT	158	158			
X 78100100	RAISED REFLECTIVE PAVEMENT MARKER	EACH	15	15			
X 78200300	PRISMATIC CURB REFLECTOR	EACH	18	18			
81028360	UNDERGROUND CONDUIT, PVC, 2 1/2" DIA.	FOOT	28				28
87301245	ELECTRIC CABLE IN CONDUIT, SIGNAL NO. 14 5C	FOOT	8441.5	214.5	335	5303.5	2588.5
87301255	ELECTRIC CABLE IN CONDUIT, SIGNAL NO. 14 7C	FOOT	1537				1537

+ 100% STATE

X SPECIALTY ITEM

FILE NAME =  
D468A98-ahs-105.dgn

USER NAME = rudzsnakjll  
PLOT SCALE = 100.4566' / 1" =  
PLOT DATE = 5/23/2012

DESIGNED - JLR  
DRAWN - JLR  
CHECKED -  
DATE - 5/23/2012

REVISED -  
REVISED -  
REVISED -  
REVISED -

STATE OF ILLINOIS  
DEPARTMENT OF TRANSPORTATION

SUMMARY OF QUANTITIES

F.A.U. RTE. 6791	SECTION D4 FYA 2012	COUNTY KNOX	TOTAL SHEETS 29	SHEET NO. 9
CONTRACT NO. 68A98				
[ILLINOIS] FED. AID PROJECT				

CODE NO.	ITEM	UNIT	TOTAL QUANTITY	CONSTRUCTION CODE			
				URBAN			
				0021 FAU 6791 90 FED/10 ST	0021 FAU 6801 90 FED/10 ST	0021 FAU 6791 90 F/5 ST/5 C	0021 FAP 574 90 F/5 ST/5 C
87700280	STEEL MAST ARM ASSEMBLY AND POLE, 48 FT.	EACH	1				1
87700290	STEEL MAST ARM ASSEMBLY AND POLE, 50 FT.	EACH	1				1
87700320	STEEL MAST ARM ASSEMBLY AND POLE, 55 FT.	EACH	1				1
87800415	CONCRETE FOUNDATION, TYPE E 36-INCH DIAMETER	FOOT	41				41
87900200	DRILL EXISTING HANDHOLE	EACH	3				3
88030020	SIGNAL HEAD, LED, 1-FACE, 3-SECTION, MAST-ARM MOUNTED	EACH	5				5
88030050	SIGNAL HEAD, LED, 1-FACE, 3-SECTION, BRACKET MOUNTED	EACH	10			6	4
88030070	SIGNAL HEAD, LED, 1-FACE, 4-SECTION, BRACKET MOUNTED	EACH	5	2			3
88030080	SIGNAL HEAD, LED, 1-FACE, 4-SECTION, MAST-ARM MOUNTED	EACH	3				3
88200310	TRAFFIC SIGNAL BACKPLATE, LOUVERED, PLASTIC	EACH	19	1		6	12
88600100	DETECTOR LOOP, TYPE 1	FOOT	175			175	
89502105	REBUILD EXISTING SIGNAL HEAD, LED	EACH	56		2	44	10
89502210	MODIFY EXISTING CONTROLLER CABINET	EACH	10	1	1	6	2
89502375	REMOVE EXISTING TRAFFIC SIGNAL EQUIPMENT	EACH	1				1

FILE NAME =  
D:\68A98\shc-IDS.dgn

USER NAME = rudzinskijl	DESIGNED - JLR	REVISED -
PLOT SCALE = 100.4566' / in.	DRAWN - JLR	REVISED -
PLOT DATE = 5/23/2012	CHECKED -	REVISED -
	DATE - 5/23/2012	REVISED -

STATE OF ILLINOIS  
DEPARTMENT OF TRANSPORTATION

SUMMARY OF QUANTITIES

F.A.U. RTE.	SECTION	COUNTY	TOTAL SHEETS	SHEET NO.
6791	D4 FYA 2012	KNOX	29	10
CONTRACT NO. 68A98				
ILLINOIS FED. AID PROJECT				

CODE NO.	ITEM	UNIT	TOTAL QUANTITY	CONSTRUCTION CODE			
				0021	0021	0021	0021
				FAU 6791	FAU 6801	FAU 6791	FAP 574
				90 FED/10 ST	90 FED/10 ST	90 F/5 ST/5 C	90 F/5 ST/5 C
89502378	REBUILD EXISTING HANDHOLE TO HEAVY DUTY HANDHOLE	EACH	1			1	
X0323071	SPARE FULL ACTUATED CONTROLLER, SPECIAL	EACH	1			1	
X4240420	PORTLAND CEMENT CONCRETE SIDEWALK 4 INCH, SPECIAL	SQ FT	422	422			
X4402815	ISLAND PAVEMENT REMOVAL AND REPLACEMENT	SQ FT	196	196			
X6024240	INLETS, SPECIAL	EACH	1	1			
X6060714	CONCRETE MEDIAN (SPECIAL)	SQ FT	1266	1266			
X X7830068	GROOVING FOR RECESSED PAVEMENT MARKING, LETTERS, NUMBERS AND SYMBOLS	SQ FT	18	18			
X X7830076	GROOVING FOR RECESSED PAVEMENT MARKING 9"	FOOT	849	849			
X X7830078	GROOVING FOR RECESSED PAVEMENT MARKING 13"	FOOT	57	57			
X X7830090	GROOVING FOR RECESSED PAVEMENT MARKING 25"	FOOT	158	158			
Z0013798	CONSTRUCTION LAYOUT	L SUM	1	1			

**XSPECIALTY ITEM**

FILE NAME = D468A98-shr-IDS.dgn	USER NAME = rudzinskijl	DESIGNED - JLR	REVISED -
		DRAWN - JLR	REVISED -
	PLOT SCALE = 1/88.0000' / in.	CHECKED -	REVISED -
	PLOT DATE = 5/23/2012	DATE - 5/23/2012	REVISED -



**STATE OF ILLINOIS  
DEPARTMENT OF TRANSPORTATION**

**SUMMARY OF QUANTITIES**

F.A.U. RTE. 6791	SECTION D4 FYA 2012	COUNTY KNOX	TOTAL SHEETS 29	SHEET NO. 11
			CONTRACT NO. 68A98	
ILLINOIS FED. AID PROJECT				



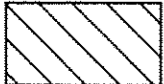

	PAVEMENT REMOVAL
	MEDIAN REMOVAL
	SIDEWALK REMOVAL
	CONCRETE CURB AND GUTTER REMOVAL

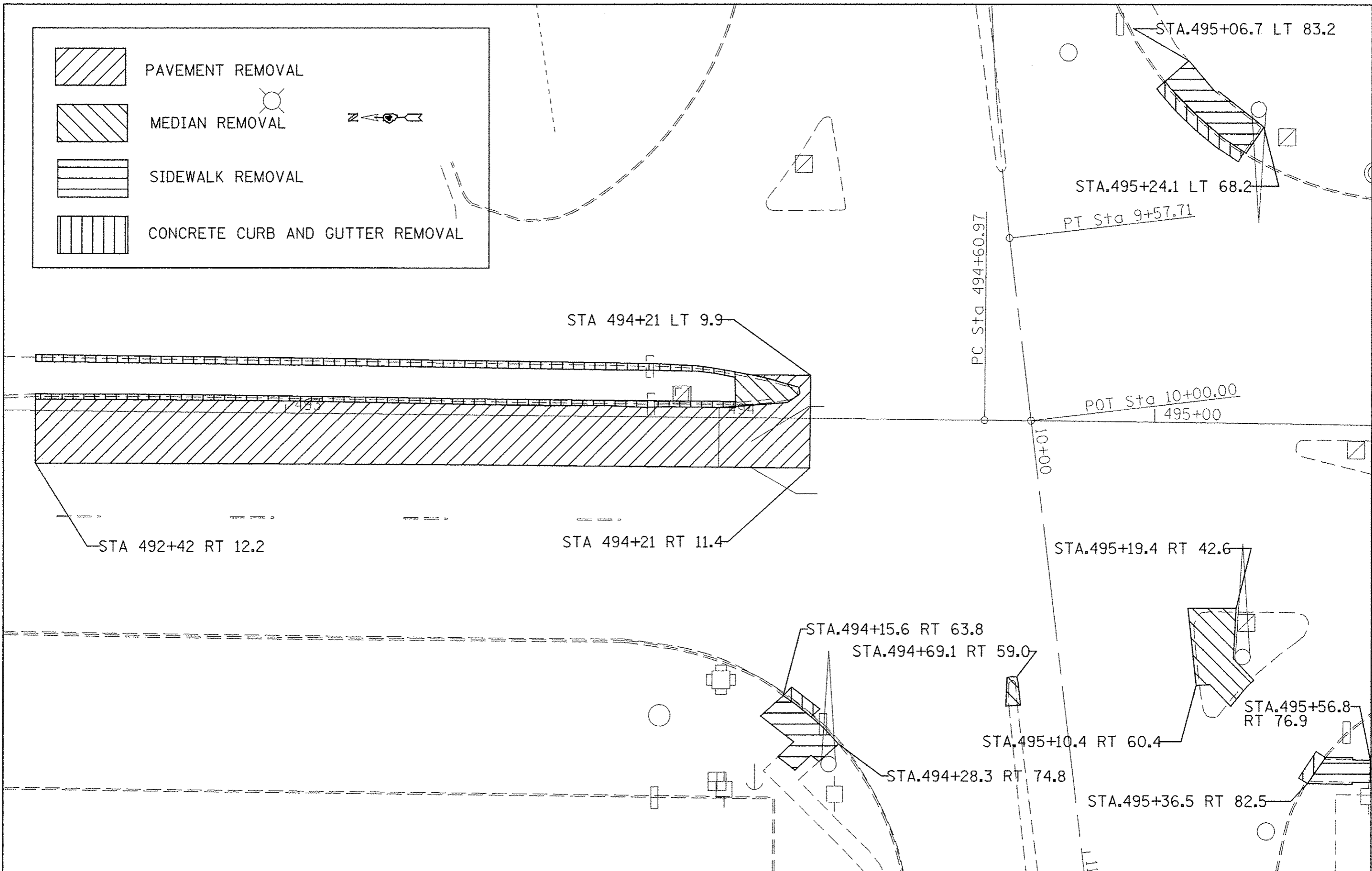

FILE NAME =	D468A98-ahz-105.dgn
-------------	---------------------

USER NAME =	rudzinski.jl
DESIGNED -	
DRAWN -	
CHECKED -	
DATE -	5/23/2012

REVISD -	
REVISD -	
REVISD -	
REVISD -	

REVISD -	
REVISD -	
REVISD -	
REVISD -	

**STATE OF ILLINOIS  
DEPARTMENT OF TRANSPORTATION**

SCALE:	SHEET	OF	SHEETS	STA.	TO STA.
--------	-------	----	--------	------	---------

F.A.U. RTE.	SECTION	COUNTY	TOTAL SHEETS	SHEET NO.
679L	D4 FYA 2012	KNOX	29	14
CONTRACT NO. 68A98				
ILLINOIS FED. AID PROJECT				

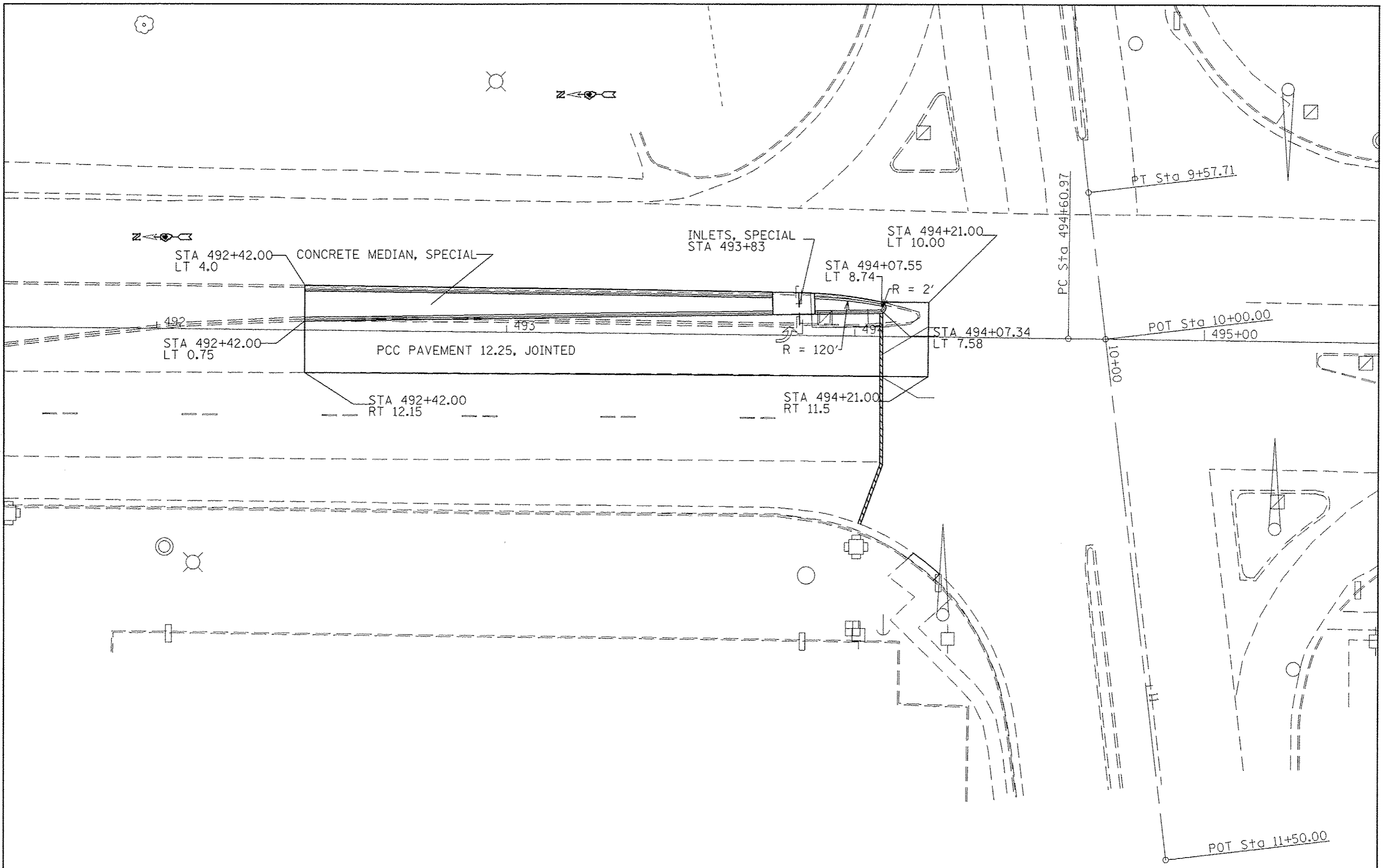

FILE NAME =  
D468A98-aht-105.dgn

USER NAME = rudzinaki,jl  
PLOT SCALE = 20.0000' / in.  
PLOT DATE = 5/23/2012

DESIGNED -  
DRAWN -  
CHECKED -  
DATE -

REVISED -  
REVISED -  
REVISED -  
REVISED -

**STATE OF ILLINOIS  
DEPARTMENT OF TRANSPORTATION**

**PROPOSED PLAN**

SCALE: SHEET OF SHEETS STA. TO STA.

F.A.U. RTE.	SECTION	COUNTY	TOTAL SHEETS	SHEET NO.
679L	D4 FYA 2012	KNOX	29	15
CONTRACT NO. 68A98				
ILLINOIS FED. AID PROJECT				

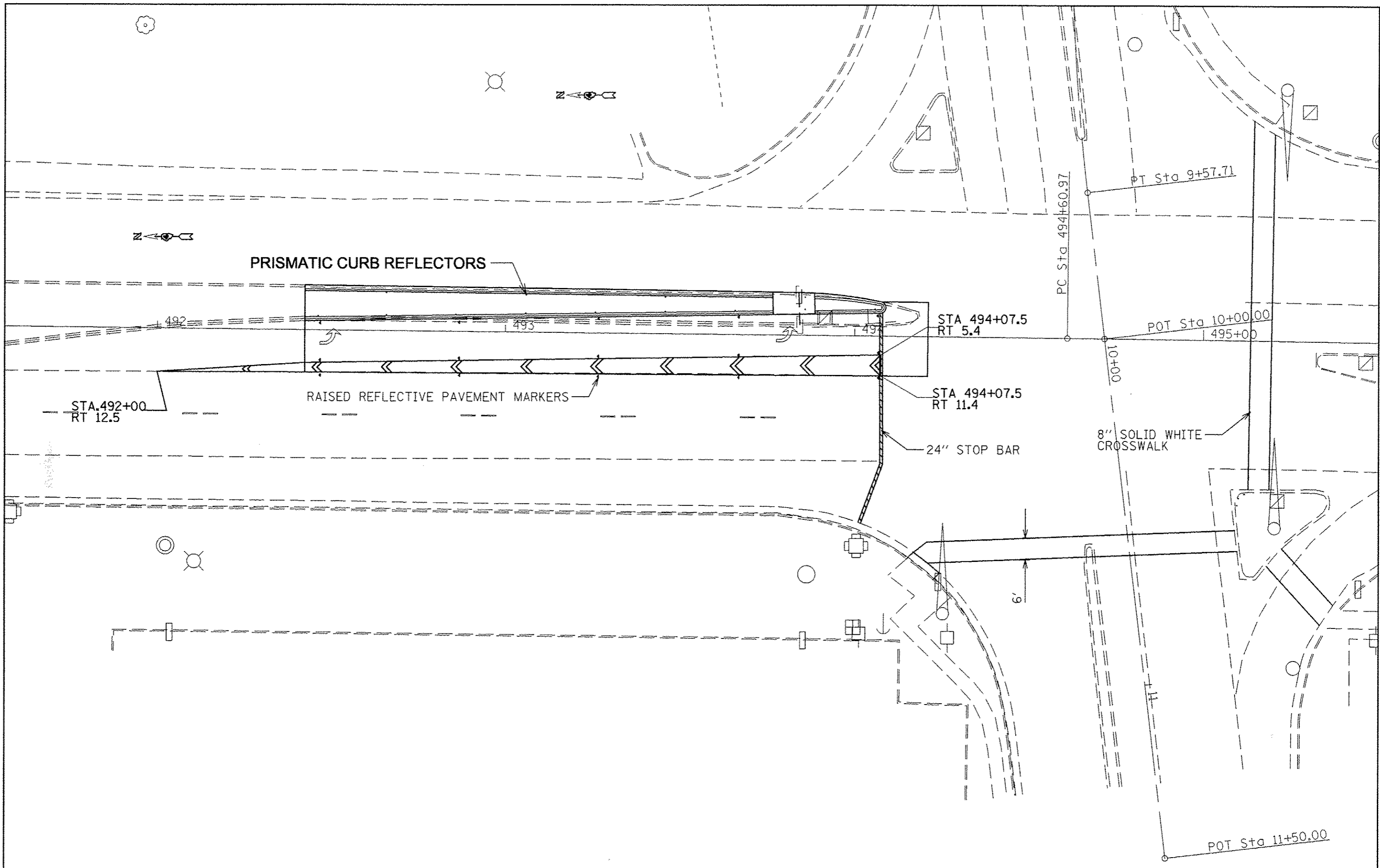

FILE NAME =  
D468A98-eh1-ID5.dgn

USER NAME = wudziubskj,l  
PLOT SCALE = 20.0000' / 1" = 1/32"  
PLOT DATE = 5/23/2012

DESIGNED -  
DRAWN -  
CHECKED -  
DATE -

REVISED -  
REVISED -  
REVISED -  
REVISED -

**STATE OF ILLINOIS  
DEPARTMENT OF TRANSPORTATION**

**PROPOSED PAVEMENT MARKINGS**

SCALE: SHEET OF SHEETS STA. TO STA.

F.A.U. RTE. 6791	SECTION D4 FYA 2012	COUNTY KNOX	TOTAL SHEETS 29	SHEET NO. 16
CONTRACT NO. 68A98				
ILLINOIS FED. AID PROJECT				



**CONTROLLER CABINET MODIFICATION - CONSTRUCTION NOTES**

1. THE CONTRACTOR SHALL SCHEDULE THE MODIFICATIONS OF THE THE EXISTING CONTROLLER CABINETS ONLY DURING THE HOURS OF 8:00 AM TO 3:30 PM MONDAY THROUGH FRIDAY.
2. THE CONTRACTOR WILL BE ALLOWED TO PLACE THE INTERSECTION INTO ALL-RED FLASH MODE AND ALL-WAY STOP CONTROL ONLY DURING THE HOURS SPECIFIED ABOVE TO PERFORM MODIFICATIONS TO THE EXISTING CONTROLLER CABINETS.
4. THE CONTRACTOR SHALL FURNISH AND INSTALL A MINIMUM OF TWO STOP SIGNS PER APPROACH WHEN THE INTERSECTION IS OPERATING IN ALL-RED FLASH MODE OR ALL-WAY STOP CONTROL. THE STOP SIGNS SHALL BE DISPLAYED IN ACCORDANCE WITH ALL APPLICABLE MUTCD REQUIREMENTS.
6. ALL COSTS (LABOR, MATERIALS, AND EQUIPMENT) ASSOCIATED WITH THESE REQUIREMENTS SHALL BE INCLUDED IN THE CONTRACT BID PRICE FOR THE MODIFY EXISTING CONTROLLER CABINET PAY ITEM. THERE WILL BE NO ADDITIONAL COMPENSATION FOR THIS WORK.

**CONSTRUCTION NOTES**

1. THE CONTRACTOR SHALL REMOVE THE EXISTING TRAFFIC SIGNAL COMPONENTS (HEADS, HEAD SECTIONS, LED MODULES, CONTROLLERS, CMU, ETC.) AND DELIVER THEM TO THE CITY OF GALESBURG FACILITY LOCATED AT 200 SOUTH HENDERSON STREET, GALESBURG. THE CONTRACTOR SHALL NOTIFY BILL CAMPER, AT (309) 299-0534 FORTY-EIGHT HOURS IN ADVANCE OF EQUIPMENT DELIVERY.
2. THE CONTRACTOR SHALL REMOVE THE EXISTING MAST ARMS AND DELIVER THEM TO THE IDOT WAREHOUSE LOCATED AT 6504 WEST US ROUTE 150, EDWARDS. THE CONTRACTOR SHALL NOTIFY PAUL GRANT, AT (309) 671-4474 FORTY-EIGHT HOURS IN ADVANCE OF EQUIPMENT DELIVERY.
3. ANY MAINTENANCE OF EXISTING TRAFFIC SIGNALS WILL BE CONSIDERED EXTRA WORK IN ACCORDANCE WITH ARTICLE 109.04 OF THE STANDARD SPECIFICATIONS.
4. THE LOCATION OF ALL UTILITIES AND PRIVATELY OWNED FACILITIES SHALL BE FIELD VERIFIED BY THE CONTRACTOR PRIOR TO THE INSTALLATION OF ANY COMPONENTS.
5. THE CONTRACTOR SHALL BE RESPONSIBLE FOR LOCATING EXISTING IDOT ELECTRICAL FACILITIES AT HIS/HER OWN EXPENSE IF REQUIRED. THE CONTRACTOR SHALL ALSO BE LIABLE FOR ANY DAMAGE TO IDOT FACILITIES RESULTING FROM INACCURATE LOCATING.
6. ELECTRICAL WORK SHALL CONFORM WITH NATIONAL, STATE, AND LOCAL CODES.
7. ALL TRAFFIC SIGNAL SECTIONS SHALL HAVE 12" SINGLE LED LENSES.
8. THE RED SECTIONS OF THE SIGNAL HEADS SHARING THE SAME MAST ARM SHALL BE LEVEL WITH ONE ANOTHER AND MAINTAIN A 16 FT. MINIMUM CLEARANCE FROM THE HIGHEST POINT OF THE ROADWAY.
9. ALL TRAFFIC SIGNAL HEAD BRACKETS ARE TO BE ALUMINUM WITH A NATURAL FINISH.
10. THE EXISTING TRAFFIC SIGNALS SHALL REMAIN IN OPERATION DURING THE CONSTRUCTION OF THE PROPOSED TRAFFIC SIGNALS.
11. THE CONTRACTOR SHALL PROVIDE ELECTRICAL CABLE SLACK IN ACCORDANCE WITH ARTICLE 873.03.
12. ELECTRICAL CABLE WILL BE MEASURED FOR PAYMENT IN ACCORDANCE WITH ARTICLE 873.04.
13. ALL SURPLUS MATERIALS SHALL BE DISPOSED OF IN ACCORDANCE WITH ARTICLE 202.03 OF THE STANDARD SPECIFICATIONS.
14. REMOVAL OF EXISTING TRAFFIC SIGNAL ITEMS WILL NOT BE PAID FOR SEPARATELY, BUT SHALL BE INCLUDED IN THE UNIT BID PRICES FOR THE PROPOSED ITEMS UNLESS SPECIFIED OTHERWISE.
15. THE CONTRACTOR SHALL INSTALL A 1" DIAMETER DETECTOR LOOP RISER INTO THE PROPOSED REBUILT HANDHOLE FOR THE DETECTOR LOOP. THIS WORK SHALL BE INCLUDED IN THE BID PRICE FOR DETECTOR LOOP TYPE I.
16. A TYPE II SPLICE SHALL BE USED FOR ALL DETECTOR LEAD-INS.
17. ALL DETECTOR LOOPS SHALL BE INSTALLED IN THE CENTER OF THEIR RESPECTIVE TRAVEL LANES.

**TRAFFIC SIGNALS - BILL OF MATERIALS**

ITEM DESCRIPTION	UNIT	TOTAL QTY.
SIGN PANEL - TYPE 1	SQ FT	160.0
UNDERGROUND CONDUIT, PVC, 2 1/2" DIA.	FOOT	28.0
ELECTRIC CABLE IN CONDUIT, SIGNAL NO. 14 5C	FOOT	8441.5
ELECTRIC CABLE IN CONDUIT, SIGNAL NO. 14 7C	FOOT	1537.0
STEEL MAST ARM ASSEMBLY AND POLE, 48 FT.	EACH	1.0
STEEL MAST ARM ASSEMBLY AND POLE, 50 FT.	EACH	1.0
STEEL MAST ARM ASSEMBLY AND POLE, 55 FT.	EACH	1.0
CONCRETE FOUNDATION, TYPE E 36-INCH DIAMETER	FOOT	41.0
DRILL EXISTING HANDHOLE	EACH	3.0
SIGNAL HEAD, LED, 1-FACE, 3-SECTION, MAST ARM MOUNTED	EACH	5.0
SIGNAL HEAD, LED, 1-FACE, 3-SECTION, BRACKET MOUNTED	EACH	10.0
SIGNAL HEAD, LED, 1-FACE, 4-SECTION, BRACKET MOUNTED	EACH	5.0
SIGNAL HEAD, LED, 1-FACE, 4-SECTION, MAST ARM MOUNTED	EACH	3.0
TRAFFIC SIGNAL BACKPLATE, LOUVERED, PLASTIC	EACH	19.0
DETECTOR LOOP, TYPE I	FOOT	175.0
REBUILD EXISTING SIGNAL HEAD, LED	EACH	56.0
MODIFY EXISTING CONTROLLER CABINET	EACH	10.0
REMOVE EXISTING TRAFFIC SIGNAL EQUIPMENT	EACH	1.0
REBUILD EXISTING HANDHOLE TO HEAVY-DUTY HANDHOLE	EACH	1.0
SPARE FULL ACTUATED CONTROLLER, SPECIAL	EACH	1.0

FILE NAME =	USER NAME = rudzinski.jl	DESIGNED -	REVISED -
68A98 - Galesburg FYA Final Revised 3-2-12 (2).dgn		DRAWN -	REVISED -
	PLOT SCALE = 25.314 / 1 in.	CHECKED -	REVISED -
	PLOT DATE = 5/24/2012	DATE -	REVISED -

**STATE OF ILLINOIS  
DEPARTMENT OF TRANSPORTATION**

**TRAFFIC SIGNAL SCHEDULE OF QUANTITIES AND CONSTRUCTION NOTES**

SCALE: TRAFFIC SIGNALS SHEET 1 OF 3 STA. TO STA.

F.A.P. RTE.	SECTION	COUNTY	TOTAL SHEETS	SHEET NO.
VAR	D4 FLASHING YELLOW ARROWS 2012	KNOX	29	17
			CONTRACT NO. 68A98	
ILLINOIS FED. AID PROJECT				

INTERSECTION	NUMBER OF FYA PHASES	STATE (%)	CITY (%)	REBUILD EX SIG HD LED (EACH)				ELCBL C SIGNAL 14 5C (FOOT)	TS BACK PLATE (EACH)	SH LED 1F 4S BM (EACH)	SH LED 1F 3S BM (EACH)	MOD EX CONTR CAB (EACH)	SIGN PANEL T1 (SQ FT)	REBLD EX HH TO HD HH	DET LOOP T1
				4-SECT (MAM)	4-SECT (BM)	5-SECT (MAM)	5-SECT (BM)								
US 34 WB RAMPS & SEMINARY	1	100	0	1.0	1.0			335.0				1.0	5.0		
US 150 & LAKE STOREY RD	1	100	0					214.5	1.0	2.0		1.0	5.0		
US 150 (HENDERSON) & CARL SANDBURG	2	50	50			2.0	2.0	842.0	2.0		2.0	1.0	10.0	1.0	175.0
US 150 (HENDERSON) & HOME BLVD	4	50	50			4.0	4.0	1025.5	2.0		2.0	1.0	20.0		
US 150 (HENDERSON) & DAYTON	4	50	50			4.0	4.0	1150.5	2.0		2.0	1.0	20.0		
US 150 (HENDERSON) & FREMONT	4	50	50			4.0	4.0	842.0				1.0	20.0		
US 150 (HENDERSON) & LOSEY	4	50	50			4.0	4.0	609.5				1.0	20.0		
US 150 (HENDERSON) & MAIN	4	50	50			4.0	4.0	834.0				1.0	20.0		
IL 41 (MONMOUTH BLVD) & LINWOOD	4	50	50			4.0	4.0	1438.5	2.0		2.0	1.0	20.0		
				1.0	1.0	26.0	26.0								
<b>TOTALS</b>						54.0		7291.5	9.0	2.0	8.0	9.0	140.0	1.0	175.0

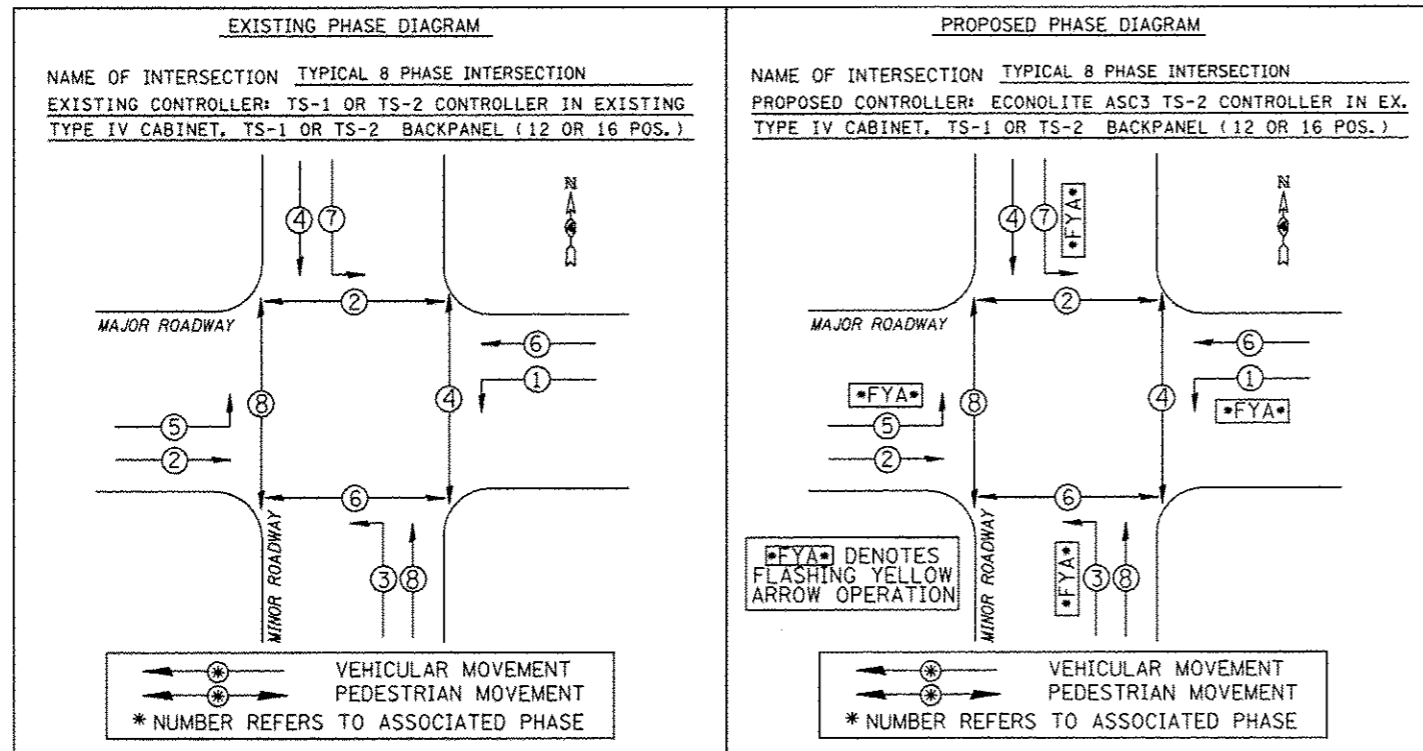

PROPOSED CABLE DIAGRAM

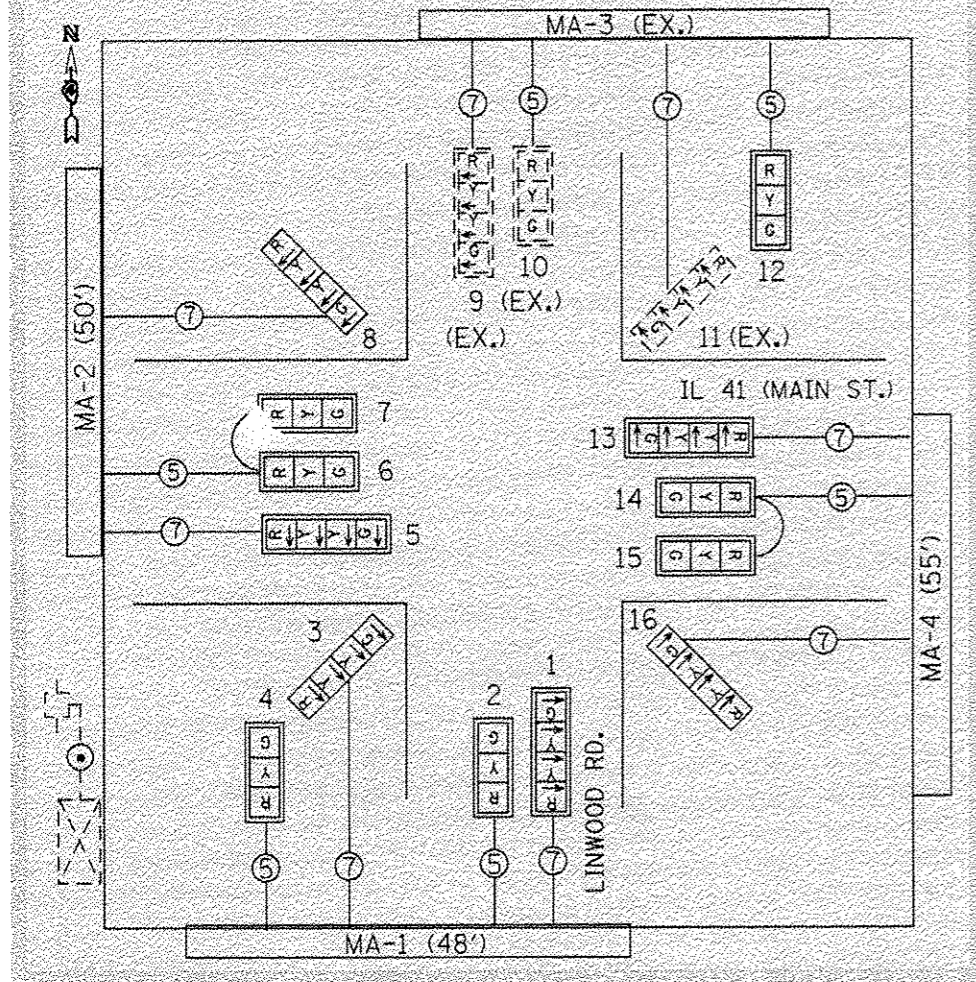

MAST ARM SCHEDULE		
DESIG	LOCATION	TYPE
MA-1	SOUTHWEST QUADRANT	STEEL MAST ARM ASSEMBLY AND POLE, 48 FT.
MA-2	NORTHWEST QUADRANT	STEEL MAST ARM ASSEMBLY AND POLE, 50 FT.
MA-3	NORTHEAST QUADRANT	EXISTING MAST ARM
MA-4	SOUTHEAST QUADRANT	STEEL MAST ARM ASSEMBLY AND POLE, 55 FT.

TRAFFIC SIGNAL HEAD SCHEDULE		
QTY.	TYPE	LOCATION
2.0 EACH	SH LED 1F 3S BM	4, 12
5.0 EACH	SH LED 1F 3S MAM	2, 6, 7, 14, 15
3.0 EACH	SH LED 1F 4S BM	3, 8, 16
3.0 EACH	SH LED 1F 4S MAM	1, 5, 13
10.0 EACH	TS BACKPLATE LOU PLAS	1, 2, 4, 5, 6, 7, 12, 13, 14, 15
2.0 EACH	REBUILD EX SIG HD LED	9 (EX 5-SECTION), 11 (EX 5-SECTION)

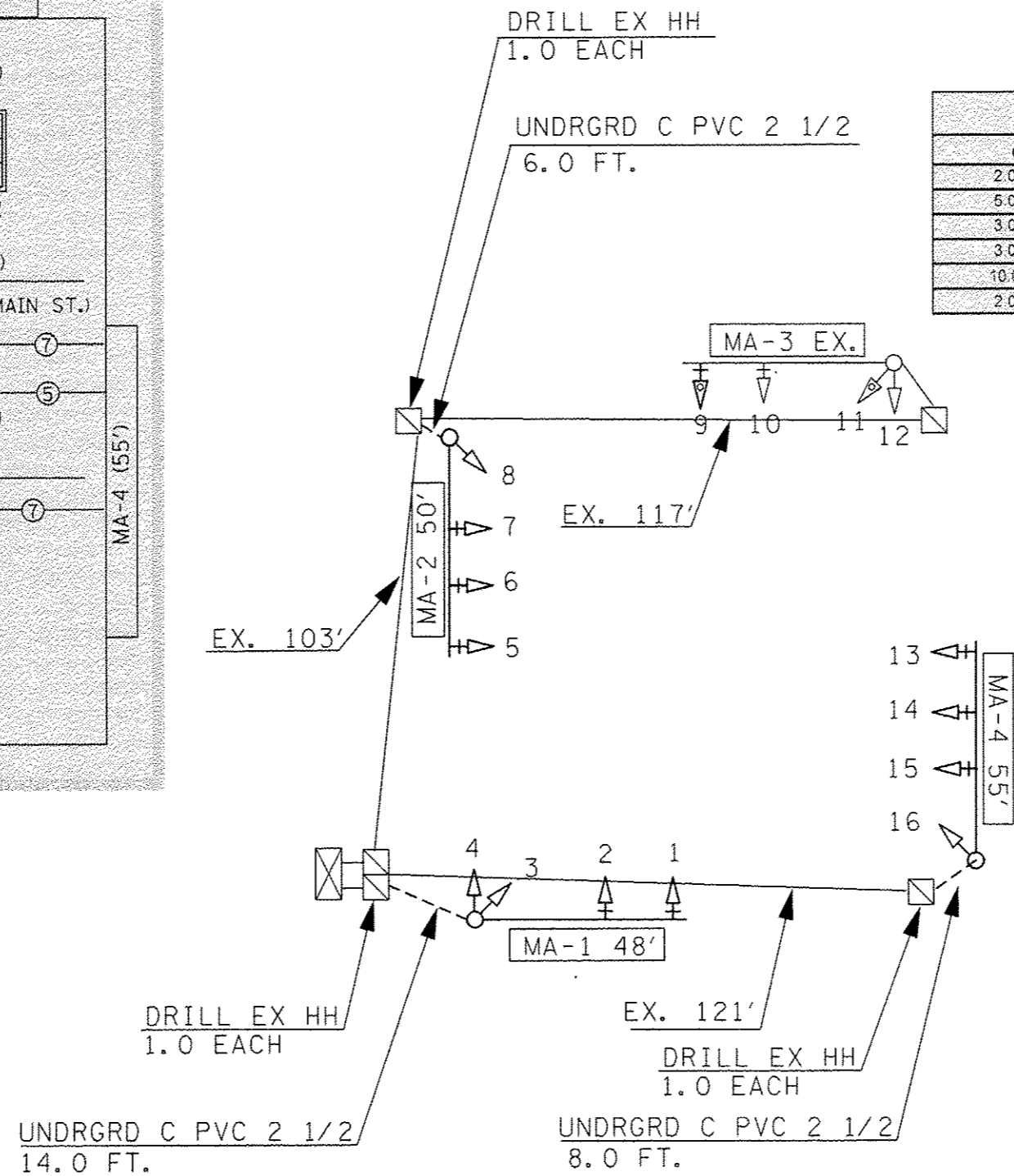

IL 41 (MAIN ST.)

IL 41 (MAIN ST.) & LINWOOD - BILL OF MATERIALS		
SIGN PANEL - TYPE 1	SQ FT	20.0
UNDERGROUND CONDUIT, PVC, 2 1/2" DIA	FOOT	28.0
ELECTRIC CABLE IN CONDUIT, SIGNAL NO. 14 5C	FOOT	1150.0
ELECTRIC CABLE IN CONDUIT, SIGNAL NO. 14 7C	FOOT	1537.0
STEEL MAST ARM ASSEMBLY AND POLE, 48 FT	EACH	1.0
STEEL MAST ARM ASSEMBLY AND POLE, 50 FT.	EACH	1.0
STEEL MAST ARM ASSEMBLY AND POLE, 55 FT.	EACH	1.0
CONCRETE FOUNDATION, TYPE E 36-INCH DIAMETER	FOOT	41.0
DRILL EXISTING HANDHOLE	EACH	3.0
SIGNAL HEAD, LED, 1-FACE, 3-SECTION, MAST ARM MOUNTED	EACH	5.0
SIGNAL HEAD, LED, 1-FACE, 3-SECTION, BRACKET MOUNTED	EACH	2.0
SIGNAL HEAD, LED, 1-FACE, 4-SECTION, BRACKET MOUNTED	EACH	3.0
SIGNAL HEAD, LED, 1-FACE, 4-SECTION, MAST ARM MOUNTED	EACH	3.0
TRAFFIC SIGNAL BACKPLATE, LOUVERED, PLASTIC	EACH	10.0
REBUILD EXISTING SIGNAL HEAD, LED	EACH	2.0
MODIFY EXISTING CONTROLLER CABINET	EACH	1.0
REMOVE EXISTING TRAFFIC SIGNAL EQUIPMENT	EACH	1.0

TRAFFIC SIGNAL LEGEND	
	EX. HANDHOLE
	EX. CONDUIT
	EX. TRAFFIC SIGNAL CONTROLLER
	EX. TRAFFIC SIGNAL HEAD
	EX. SIGNAL HEAD (REBUILT)
	PROP. SIGNAL HEAD
	PROP. CONDUIT

FILE NAME = 68A98 - Galesburg FYA Final (Revised 3-2-12).dgn	USER NAME = rudzinski,j	DESIGNED -	REVISED -
PLOT SCALE = 25,114' / 1" =		DRAWN -	REVISED -
PLOT DATE = 5/23/2012		CHECKED -	REVISED -
		DATE -	REVISED -

STATE OF ILLINOIS  
DEPARTMENT OF TRANSPORTATION

PROPOSED TRAFFIC SIGNALS  
IL 41 (MAIN) & LINWOOD - GALESBURG

SCALE: TRAFFIC SIGNALS SHEET 3 OF 3 STA. TO STA.

F.A.P. RTE.	SECTION	COUNTY	TOTAL SHEETS	SHEET NO.
VAR	D4 FLASHING YELLOW ARROWS 2012	KNOX	29	19
			CONTRACT NO. 68A98	
ILLINOIS FED. AID PROJECT				

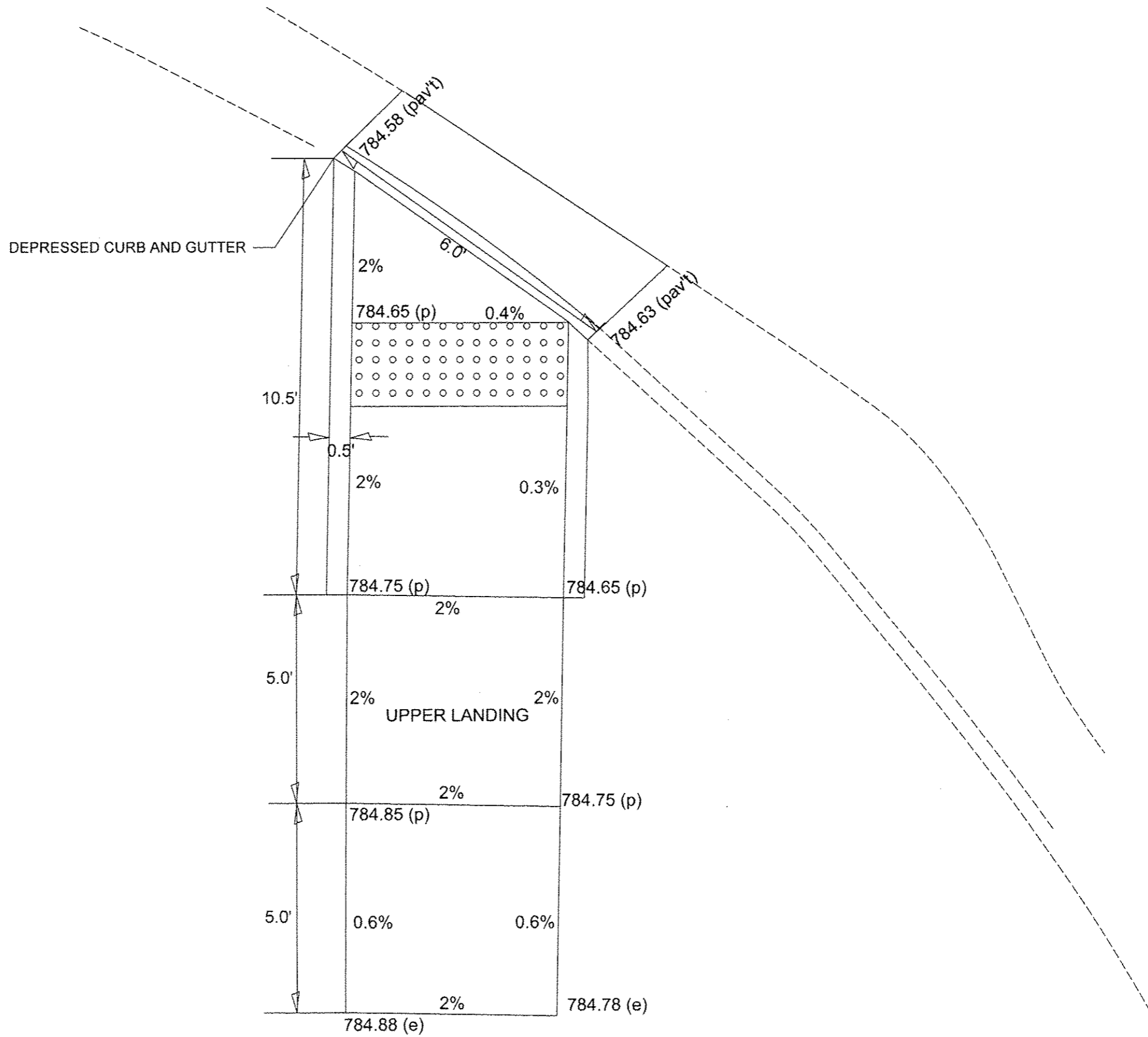

FILE NAME *	USER NAME * KAMESD
D468A98-SHT-105.DGN	

DESIGNED - SDK	REVISD -
DRAWN - SDK	REVISD -
CHECKED -	REVISD -
DATE -	REVISD -

DESIGNED - SDK	REVISD -
DRAWN - SDK	REVISD -
CHECKED -	REVISD -
DATE -	REVISD -

DESIGNED - SDK	REVISD -
DRAWN - SDK	REVISD -
CHECKED -	REVISD -
DATE -	REVISD -

**STATE OF ILLINOIS  
DEPARTMENT OF TRANSPORTATION**

**SIDEWALK DETAILS**

SCALE: \_\_\_\_\_ SHEET \_\_\_\_\_ OF \_\_\_\_\_ SHEETS STA. \_\_\_\_\_ TO STA. \_\_\_\_\_

F.A.P. RTE.	SECTION	COUNTY	TOTAL SHEETS	SHEET NO.
6791	04 FYA 2012	KNOX	29	20
CONTRACT NO. 68A98			ILLINOIS FED. AID PROJECT	

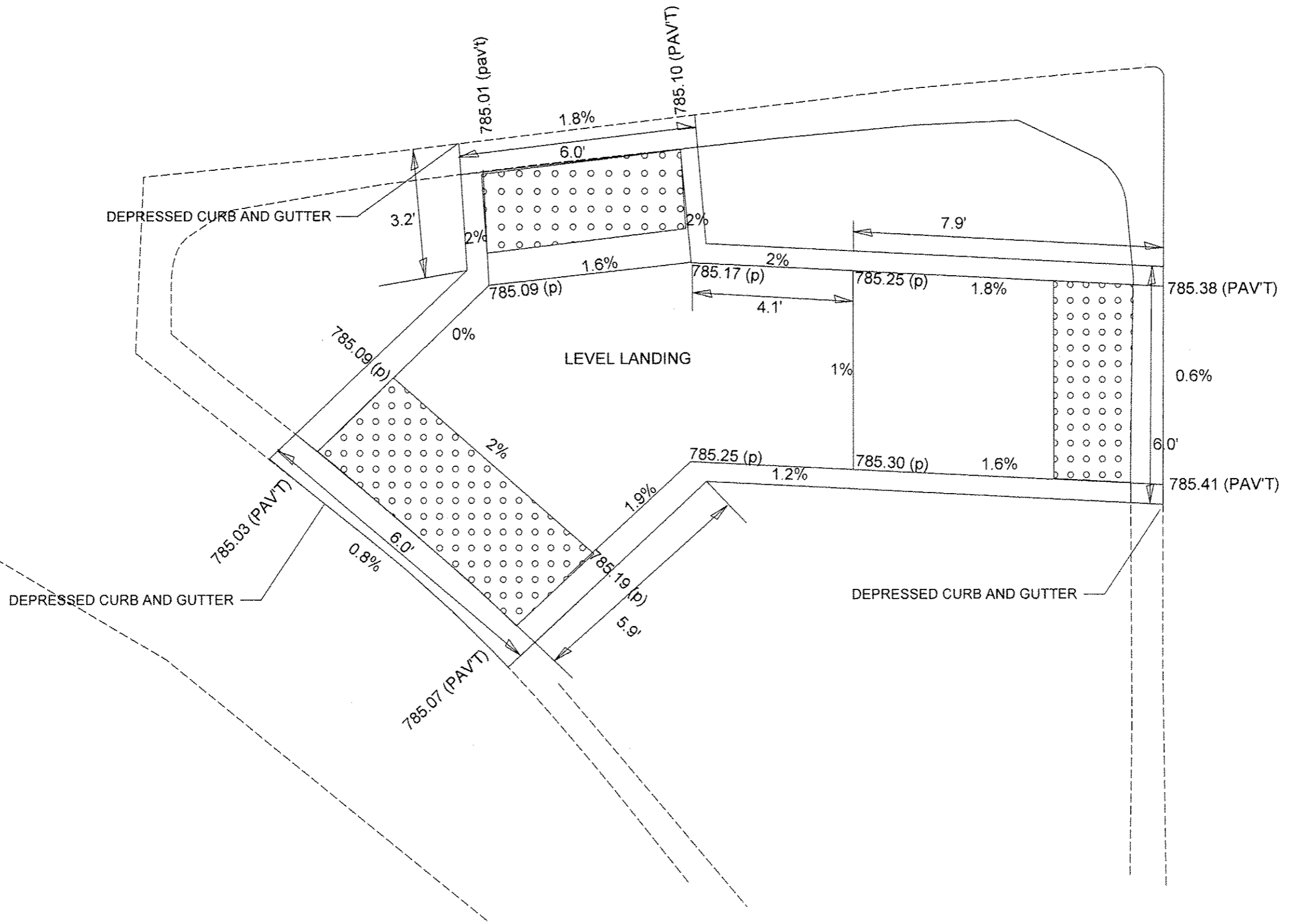

FILE NAME * D46BA98-SHT-105.DGN	USER NAME * KANE5D	DESIGNED - SDK	REVISED -	<b>STATE OF ILLINOIS DEPARTMENT OF TRANSPORTATION</b>	<b>SIDEWALK DETAILS</b>	F.A.P. RTE. 6791	SECTION D4 FYA 2012	COUNTY KNOX	TOTAL SHEETS 70	SHEET NO. 21
PLOT SCALE * 40,800'/IN	CHECKED -	REVISED -	CONTRACT NO. 68A98			ILLINOIS FED. AID PROJECT				
PLOT DATE * 3/23/2012	DATE -	REVISED -	SCALE: _____			SHEET _____	OF _____	SHEETS	STA. _____	TO STA. _____

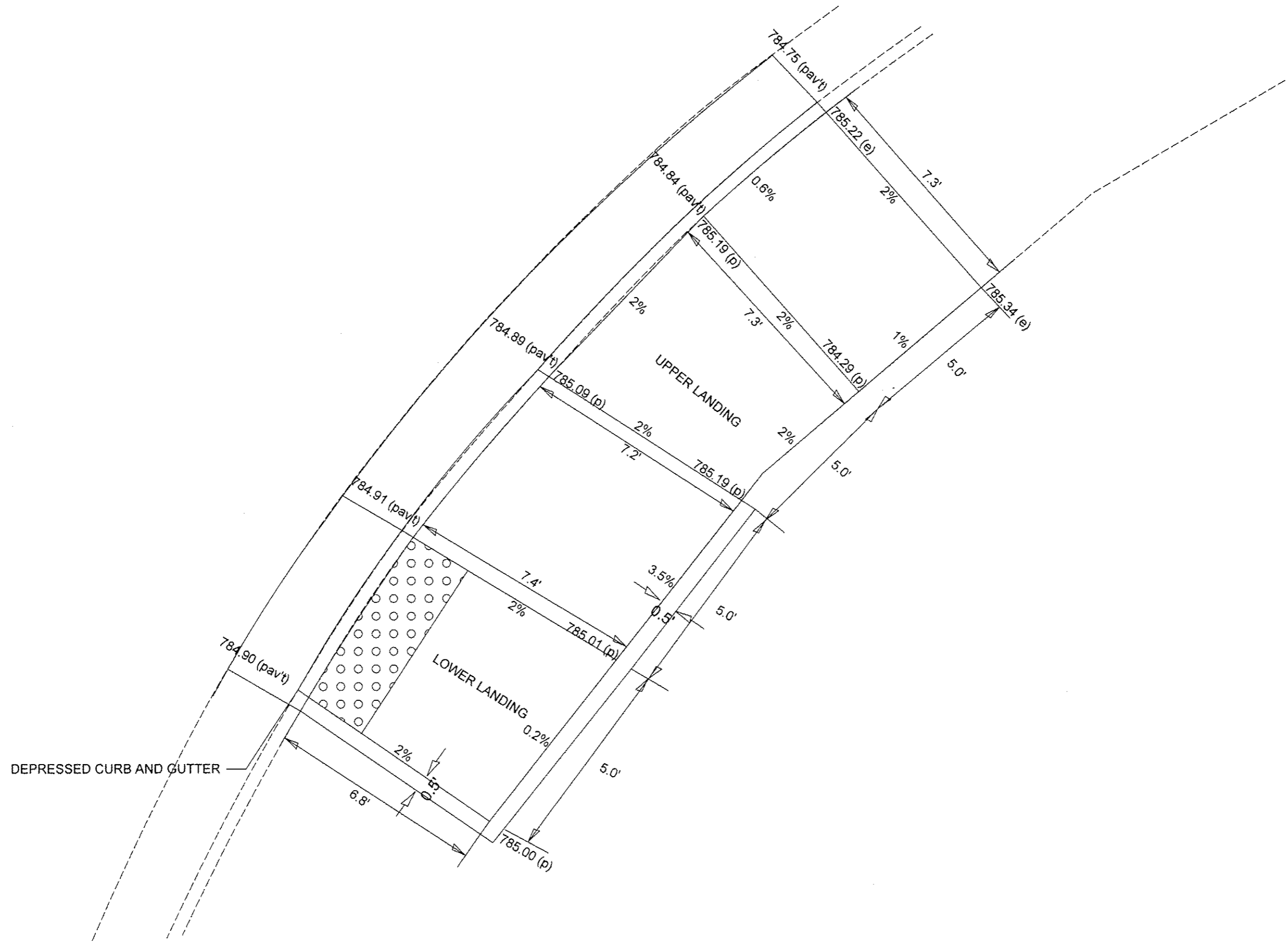

FILE NAME * 0468A98-SHT-105.DGN	USER NAME * KANESO	DESIGNED - SOK	REVISED -	<b>STATE OF ILLINOIS DEPARTMENT OF TRANSPORTATION</b>	<b>SIDEWALK DETAILS</b>			F.A.P. RTE.	SECTION	COUNTY	TOTAL SHEETS	SHEET NO.
	PLOT SCALE * 40.000'/IN	DRAWN - SOK	REVISED -					6791	04 FYA 2012	KNOX	20	22
	PLOT DATE * 3/23/2012	CHECKED -	REVISED -					CONTRACT NO. 68A98			ILLINOIS FED. AID PROJECT	
				SCALE: _____ SHEET _____ OF _____ SHEETS STA. _____ TO STA. _____								

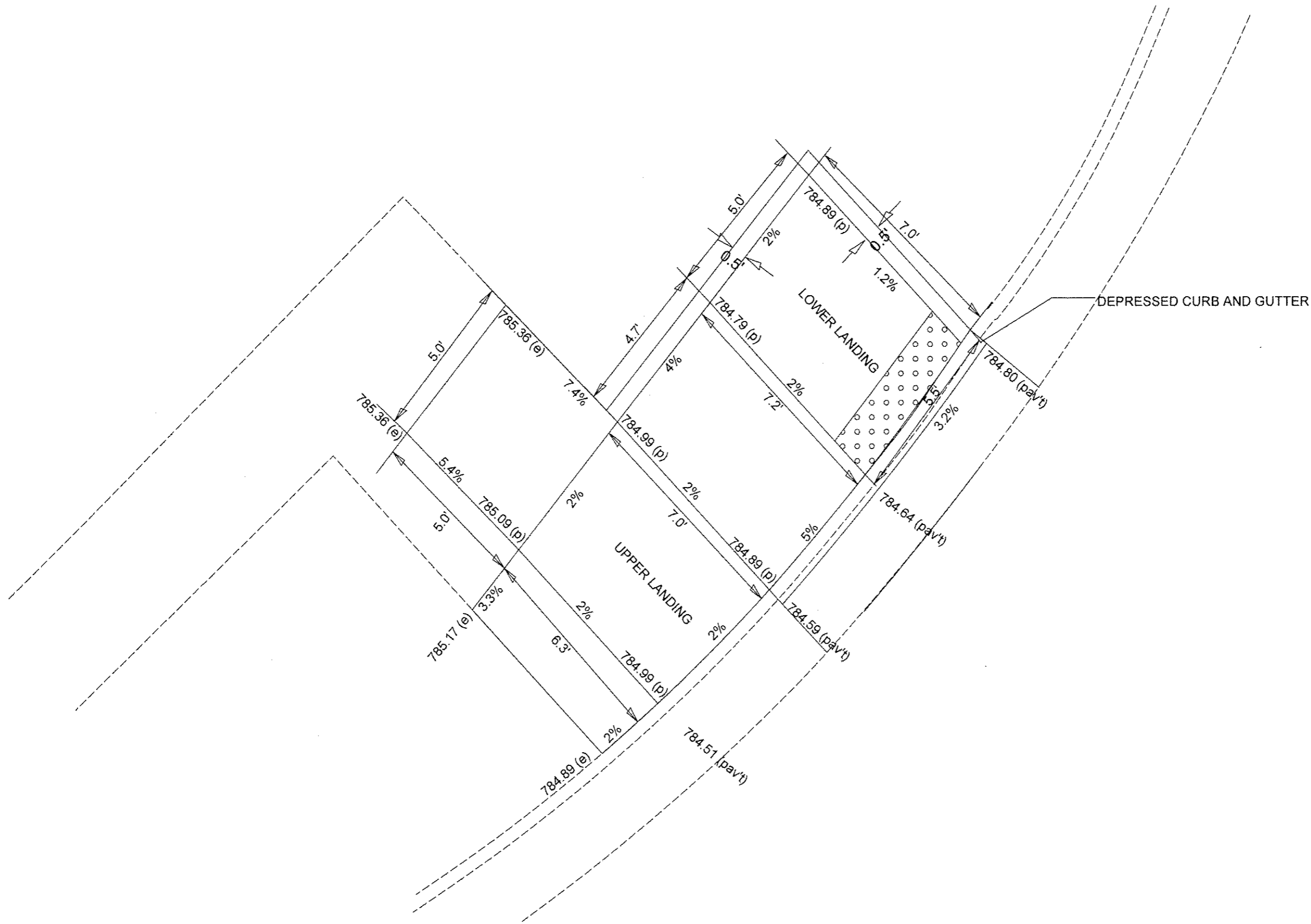

DEPRESSED CURB AND GUTTER

FILE NAME 0468A98-SHT-105.DGN	USER NAME KANE50	DESIGNED SDK	REVISED ---	STATE OF ILLINOIS DEPARTMENT OF TRANSPORTATION	SIDEWALK DETAILS	F.A.I.L. RTE.	SECTION	COUNTY	TOTAL SHEETS	SHEET NO.
	PLOT SCALE 40.000'/IN	DRAWN SDK	REVISED ---			6791	04 FYA 2012	KNOX	29	23
	PLOT DATE 3/23/2012	CHECKED ---	REVISED ---			CONTRACT NO. 68A98			ILLINOIS FED. AID PROJECT	

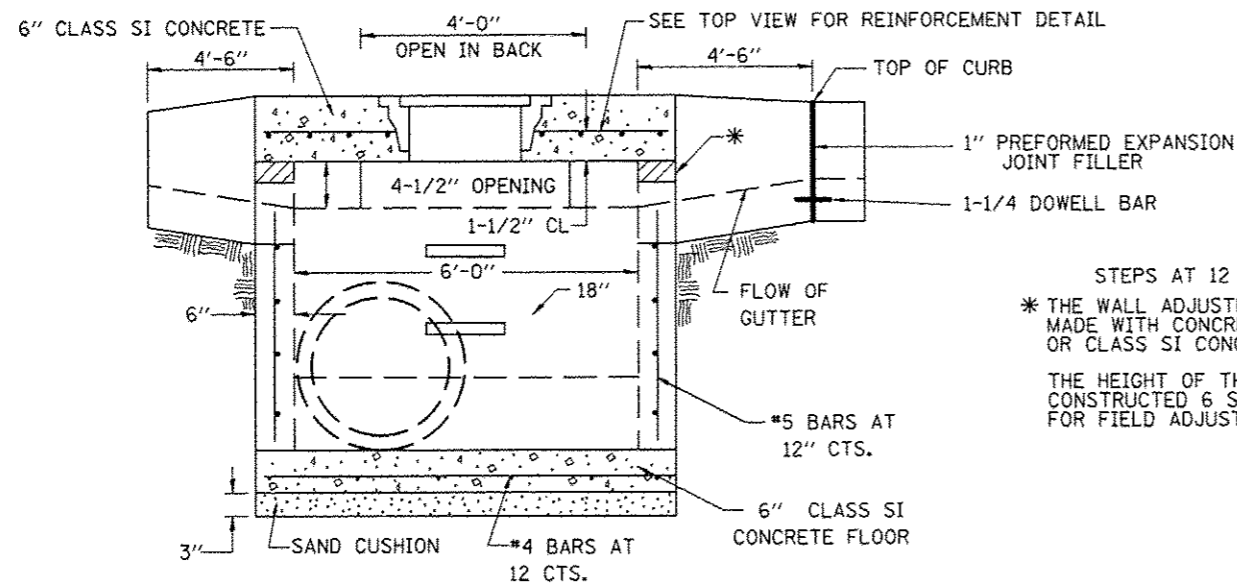

**FRONT VIEW**

**FRONT VIEW**

SEE STANDARD 602701 FOR DETAILS OF STEPS.

1" PREFORMED EXPANSION JOINTS AS SHOWN SHALL BE PROVIDED ON EACH SIDE OF INLET.

CLASS SI CONCRETE OR PRECAST CONCRETE SHALL BE USED THROUGHOUT.

THE SIDE WALLS MAY BE BUILT AS PRECAST SEGMENTAL SECTIONS.

**LIGHT WEIGHT MANHOLE CASTING**

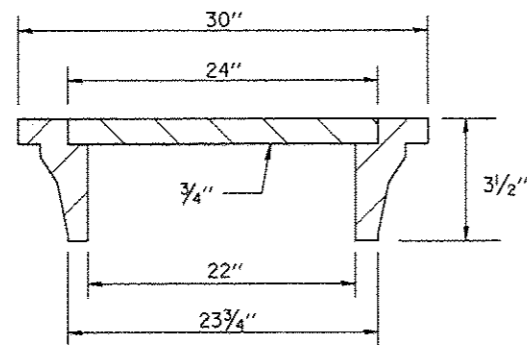

TOTAL WEIGHT 160 LBS.

STEPS AT 12 TO 16 CTS.  
 \* THE WALL ADJUSTMENTS SHALL BE MADE WITH CONCRETE BUILDING BRICK OR CLASS SI CONCRETE.  
 THE HEIGHT OF THE BOX MAY BE CONSTRUCTED 6 SHORT TO ALLOW FOR FIELD ADJUSTMENTS.

**NOTES**

STEPS SHALL BE OMITTED WHEN DEPTH OF INLET IS LESS THAN 5 FOOT.

THE INLET SHALL BE CAST IN PLACE OR PRECAST.

EXCEPT AS NOTED HEREON INLET SPECIAL SHALL BE CONSTRUCTED IN ACCORDANCE WITH SECTION 602 OF THE STANDARD SPECIFICATIONS.

THE CONTRACT UNIT PRICE EACH FOR INLET SPECIAL SHALL INCLUDE THE COST OF FURNISHING AND INSTALLING THE FRAME, LID, REINFORCEMENT BARS, FLOOR AND TOP SLABS, CAST IRON STEPS (IF USED).

THE CURB AND GUTTER WILL BE PAID FOR SEPARATELY AND WILL BE MEASURED THROUGH THE INLET.

THE CURB AND GUTTER ADJACENT TO AND 4'-6" ON EITHER SIDE OF THE INLET SHALL BE CONSTRUCTED AS SHOWN WITH NO ADDITIONAL COMPENSATION FOR THE TRANSITION.

ALL PIPE UNDERDRAIN CONNECTIONS WHEN SPECIFIED SHALL BE DONE IN ACCORDANCE WITH ART. 601 OF THE STANDARD SPECIFICATIONS. THIS WORK WILL BE PAID FOR AT THE CONTRACT UNIT PRICE PER (FOOT) FOR PIPE UNDERDRAINS (SPECIAL) OF THE DIAMETER SPECIFIED WHICH PRICE SHALL INCLUDE THE CA 7 OR CA 16 AND THE CONNECTION TO THE INLET.

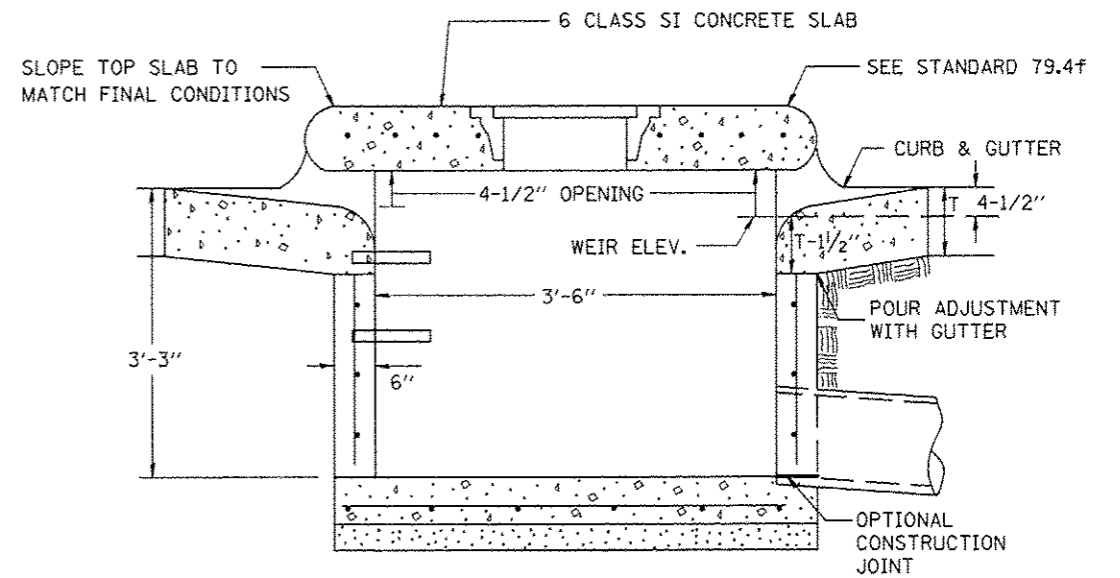

**SECTION A-A**

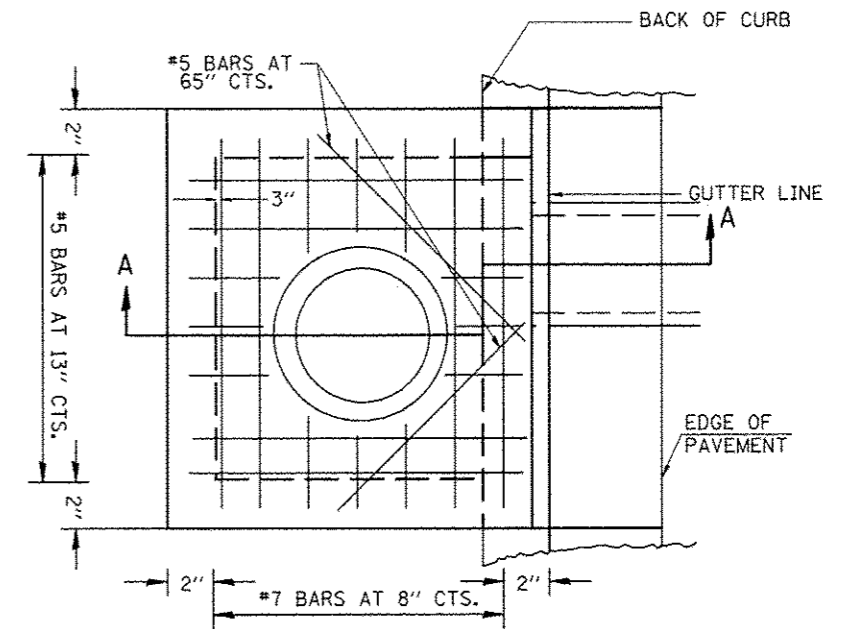

**TOP VIEW**

ALL DIMENSIONS ARE IN INCHES UNLESS OTHERWISE NOTED.

<b>STATE OF ILLINOIS DEPARTMENT OF TRANSPORTATION</b>				<b>INLETS, SPECIAL</b>				79.4a	
NOT TO SCALE									
F.A.U. RTE.	SECTION	COUNTY	TOTAL SHEETS	SHEET NO.					
5791	D4 FYA 2012	KNOX	22	24					
				CONTRACT NO. 68A98					
FED. ROAD DIST. NO.		ILLINOIS FED. AID PROJECT							



DESIGNER NOTES:  
 1. THIS DRAWING SHOULD BE USED IN CONJUNCTION WITH STATE STANDARD 424001 AND DISTRICT CADD STDS.  
 "CURB RAMPS ACCESSIBLE TO THE DISABLED" AND "COMBINATION CONCRETE CURB & SIDEWALK 4" (100mm).

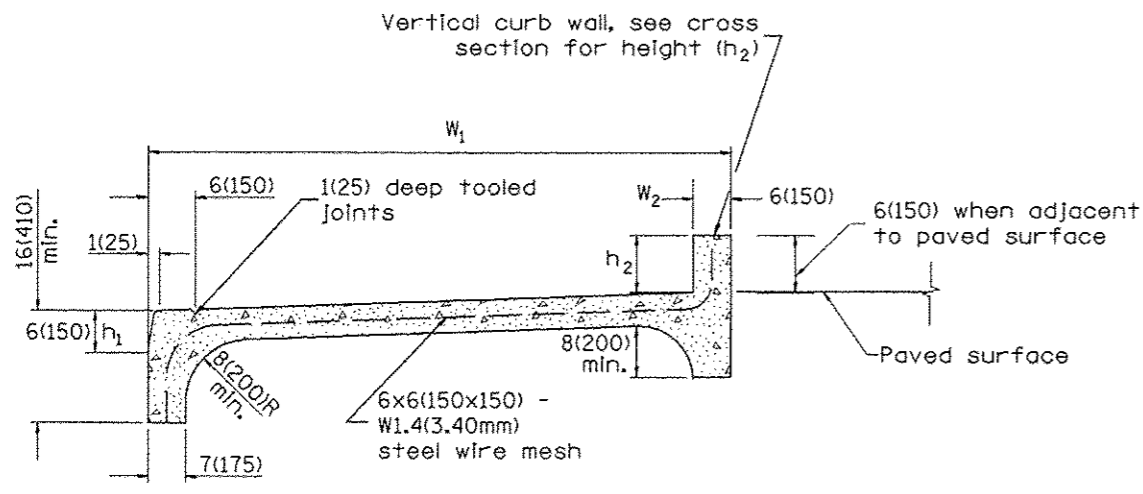

**COMBINATION CONCRETE CURB-SIDEWALK 4" (100mm)  
(SPECIAL)**

Measurement formula:  $(W_1 + W_2 + h_1 + h_2) \times \text{length constructed} =$   
 Payment area in square feet (square meters)

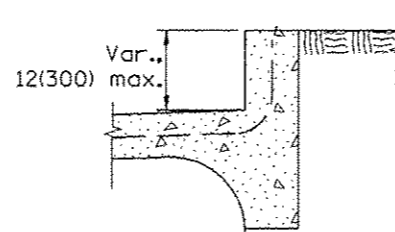

**WITH TURF BORDER**

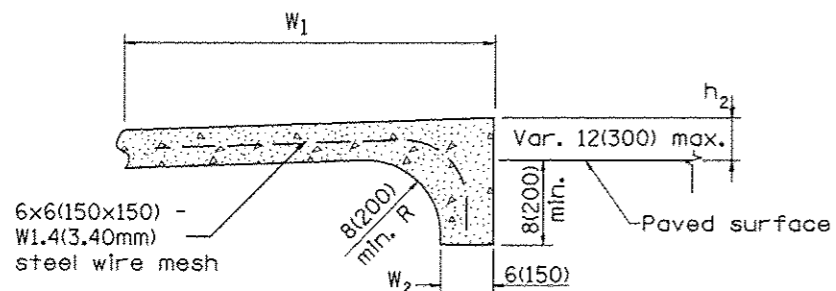

**ALTERNATE BACK DETAIL  
WHEN SIDEWALK GRADE ABOVE EXISTING GRADE**

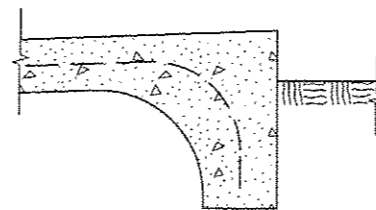

**WITH TURF BORDER**

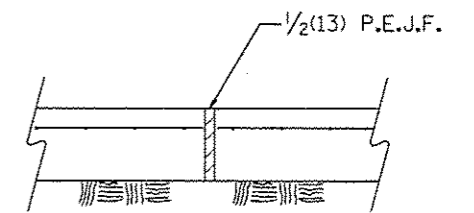
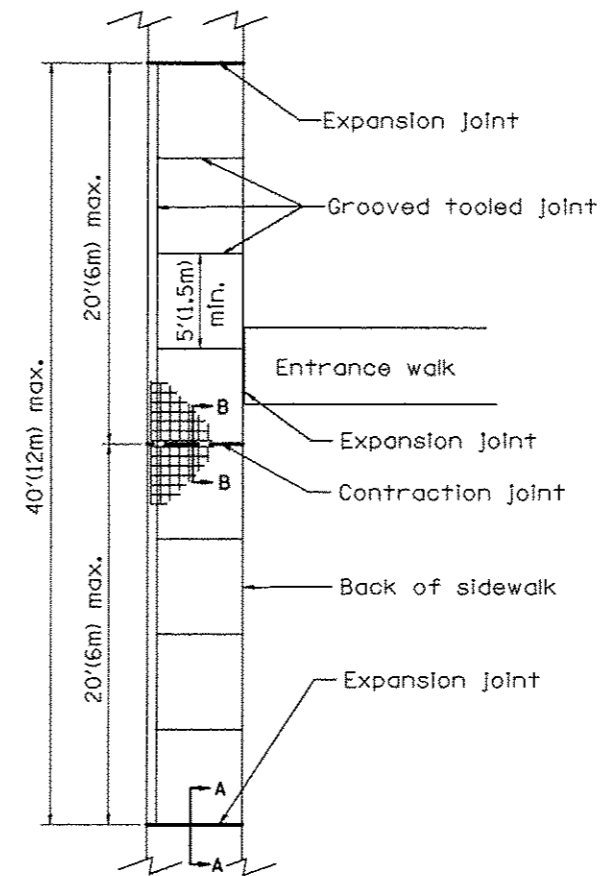

**SEC. A-A  
Expansion Joint**

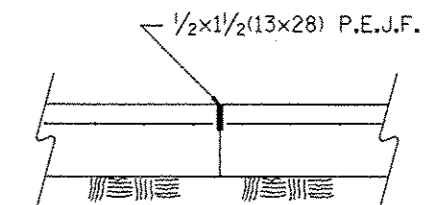

**SEC. B-B  
Contraction Joint**

**GENERAL NOTES:**

- All provisions in Section 424 of the Standard Specifications shall apply, unless otherwise shown.

All dimensions are in inches (millimeters) unless otherwise noted.

01-01-97	RENUM. A-5.03, NEW REVISION BOX	T.P.															
10-16-06	REVISED TO 2007 SPEC.	M.A.															
<b>STATE OF ILLINOIS DEPARTMENT OF TRANSPORTATION</b>										<b>COMBINATION CONCRETE CURB-SIDEWALK 4" (100mm), (SPECIAL)</b>							
NOT TO SCALE										CADD STD. 424106-04							
										SECTION		COUNTY		TOTAL SHEETS		SHEET NO.	
										CONTRACT NO.		79		25			
										FED. ROAD DIST. NO. ILLINOIS FED. AID PROJECT							

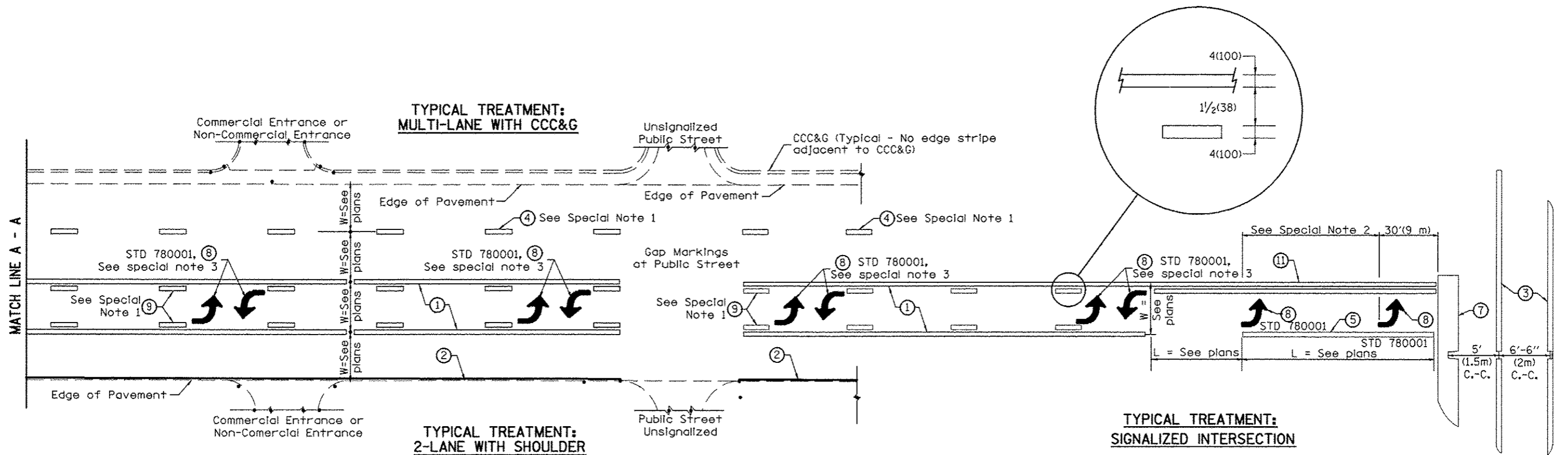

**FLUSH PAVED MEDIAN: TWO-WAY LEFT TURN LANE  
WITH ONE-WAY LEFT TURN LANE AT SIGNALIZED INTERSECTION**

**TYPICAL PAVEMENT MARKING LEGEND**

(Note: This is a District Standard Legend. Some elements may not apply to specific project.)

- ① 4(100) Solid (Yellow)
- ② 4(100) Solid (White)
- ③ 2-6(150) Crosswalk @ 6'-6" (2m)min C.-C. (White)  
2-8(200) Crosswalk @ 6'-6" (2m)min C.-C. (White) (When traffic signals are present.)
- ④ 6(150) Skip-Dash (White) (See Special Note 1)
- ⑤ 8(200) Solid (White)
- ⑥ 12(300) Diagonal (White) (Item ⑥ is shown on Std. 780001)
- ⑦ 24(600) Stop Bar (White)
- ⑧ Letters & Arrows (See Std. 780001 and Special Notes 2 & 3)
- ⑨ 4(100) Skip-Dash (Yellow) (See Special Note 1)
- ⑩ 12(300) Diagonal (Yellow) (See Table A)
- ⑪ 4(100) Double Solid (Yellow)

**SPECIAL NOTES**

1. Skip-Dash markings will be centered between both ends of city blocks and shall be placed in alignment transversely across the pavement.
2. The following shall apply to arrows located in one-way left turn lanes:
  - A. A minimum of two (2) arrows is required.
  - B. The maximum spacing between arrows is 80' (24 m).
  - C. Arrows shall be evenly spaced if three (3) or more are required.
3. The following shall apply to arrow pairs located in two-way left turn lanes:
  - A. A minimum of two (2) arrow pairs is required.
  - B. The maximum spacing between arrow pairs is 200' (61 m).
  - C. Arrow pairs shall be evenly spaced if three (3) or more are required.
  - D. The spacing between BI Directional Left Turn Arrows is 33' (10 m).

**GENERAL NOTES**

1. Refer to State Standard 780001 for additional Pavement Markings including letters & arrows.
2. See Plans for Pavement Markings adjacent to curbed islands and medians, and through lane reductions.

DESIGNER NOTES:  
1. Include State Standard 780001 (Typical Pavement Markings)

01-01-97	RENUM. F-8.03, NEW REVISION BOX	T.P.	10-16-06	REVISED TO 2007 SPEC.	<b>STATE OF ILLINOIS DEPARTMENT OF TRANSPORTATION</b>	<b>TYPICAL PAVEMENT MARKINGS</b>	F.A.U. RTE.	SECTION	COUNTY	TOTAL SHEETS	SHEET NO.	
02-07-97	ADD BI DIRECTIONAL DIMENSION	J.A.					6791	D4 FYA 2012	KNOX	29	26	
10-97	CORRECT BI DIRECTIONAL DIMENSION	J.A.					SHT. 1 OF 2 CADD STD. 780001-D4					
08-02	ADD CROSSWALK DMNS. WITH T.S.	M.A.					CONTRACT NO. 68A98					

**TYPICAL TREATMENT:  
MULTI-LANE WITH CCC&G**

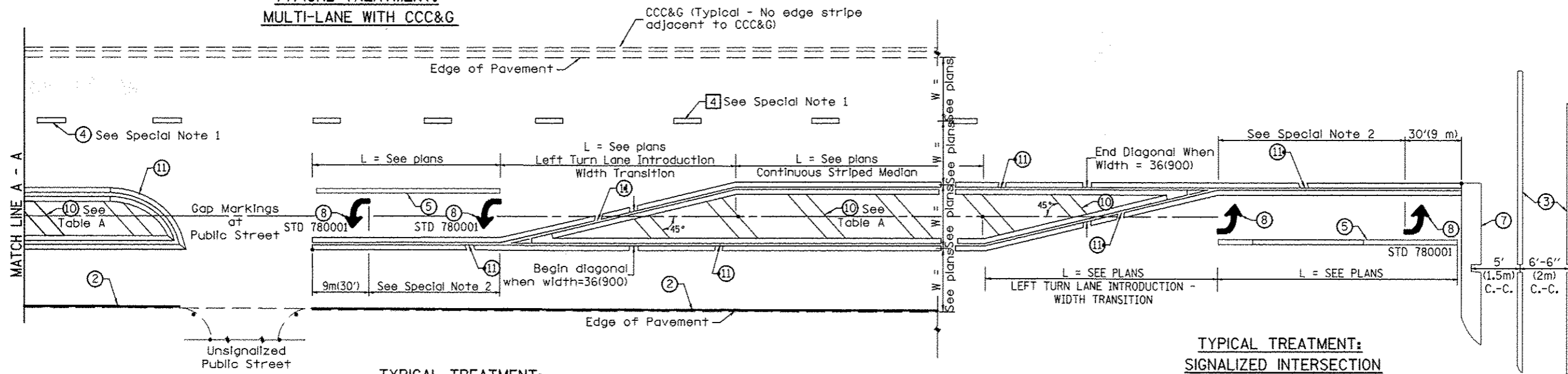

**TYPICAL TREATMENT:  
2-LANE WITH SHOULDER**

**TYPICAL MEDIAN TRANSITIONS**

**TYPICAL TREATMENT:  
SIGNALIZED INTERSECTION**

**FLUSH PAVED MEDIAN: RESTRICTED LEFT TURN LANE**

**TABLE A**

**RECOMMENDED SPACING BETWEEN DIAGONAL LINES**

SPEED LIMIT RANGE	INTERSECTION CHANNELIZATION (Includes Width Transitions for Median and Left Turn Lane Introductions)	
	CONTINUOUS	
Less Than 30 mph (50 km/h)	50' (15m)	15' (5m)
30 - 45 mph (50 - 70 km/h)	75' (23m)	20' (6m)
Over 45 mph (70 km/h)	150' (46m)	30' (9m)

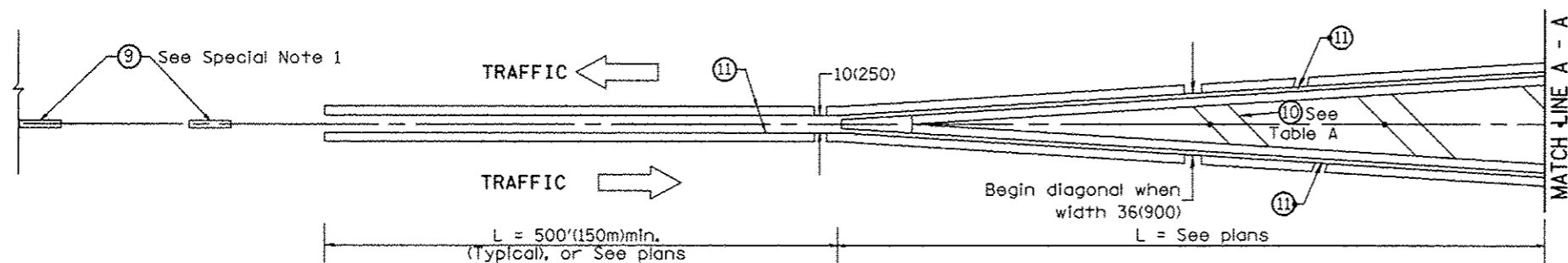

**MEDIAN INTRODUCTION - WIDTH TRANSITIONS**

All dimensions are in inches (millimeters)  
unless otherwise noted.

DATE	
BY	
SURVEYED	
PLotted	
NOTE BOOK	
AREAS CHECKED	

DATE	
BY	
SURVEYED	
PLotted	
NOTE BOOK	
AREAS CHECKED	

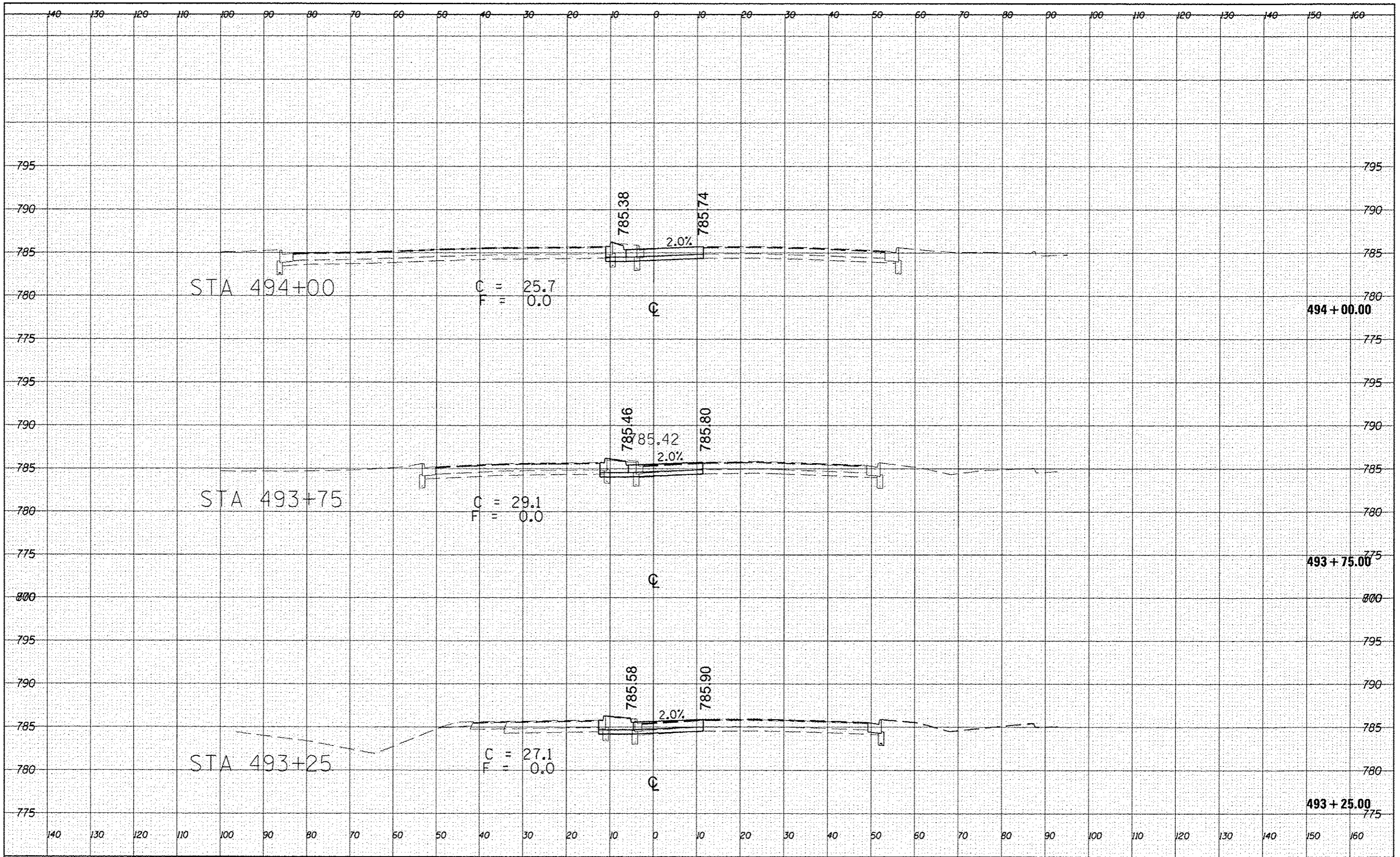

FILE NAME =	USER NAME = rudzinski.j	DESIGNED -	REVISED -	<b>STATE OF ILLINOIS DEPARTMENT OF TRANSPORTATION</b>	<b>CROSS SECTIONS</b>		F.A.U. RTE. = 5791	SECTION = 04 FYA 2012	COUNTY = KNOX	TOTAL SHEETS = 29	SHEET NO. = 28	
c:\pawork\pawidot\rudzinski.j\0301611\0468998-	PLT SCALE = 20.0000' / in.	DRAWN -	REVISED -		SCALE:	SHEET	OF	SHEETS	STA.	TO	STA.	ILLINOIS FED. AID PROJECT
	PLT DATE = 6/18/2012	CHECKED -	REVISED -									CONTRACT NO. 68A98
		DATE -	REVISED -									

DATE	
BY	
FINISHED	
SURVEYED	
PLOTTED	
NOTED	
AREAS CHECKED	
NO.	

DATE	
BY	
ORIGINAL	
SURVEYED	
PLOTTED	
NOTED	
AREAS CHECKED	
NO.	

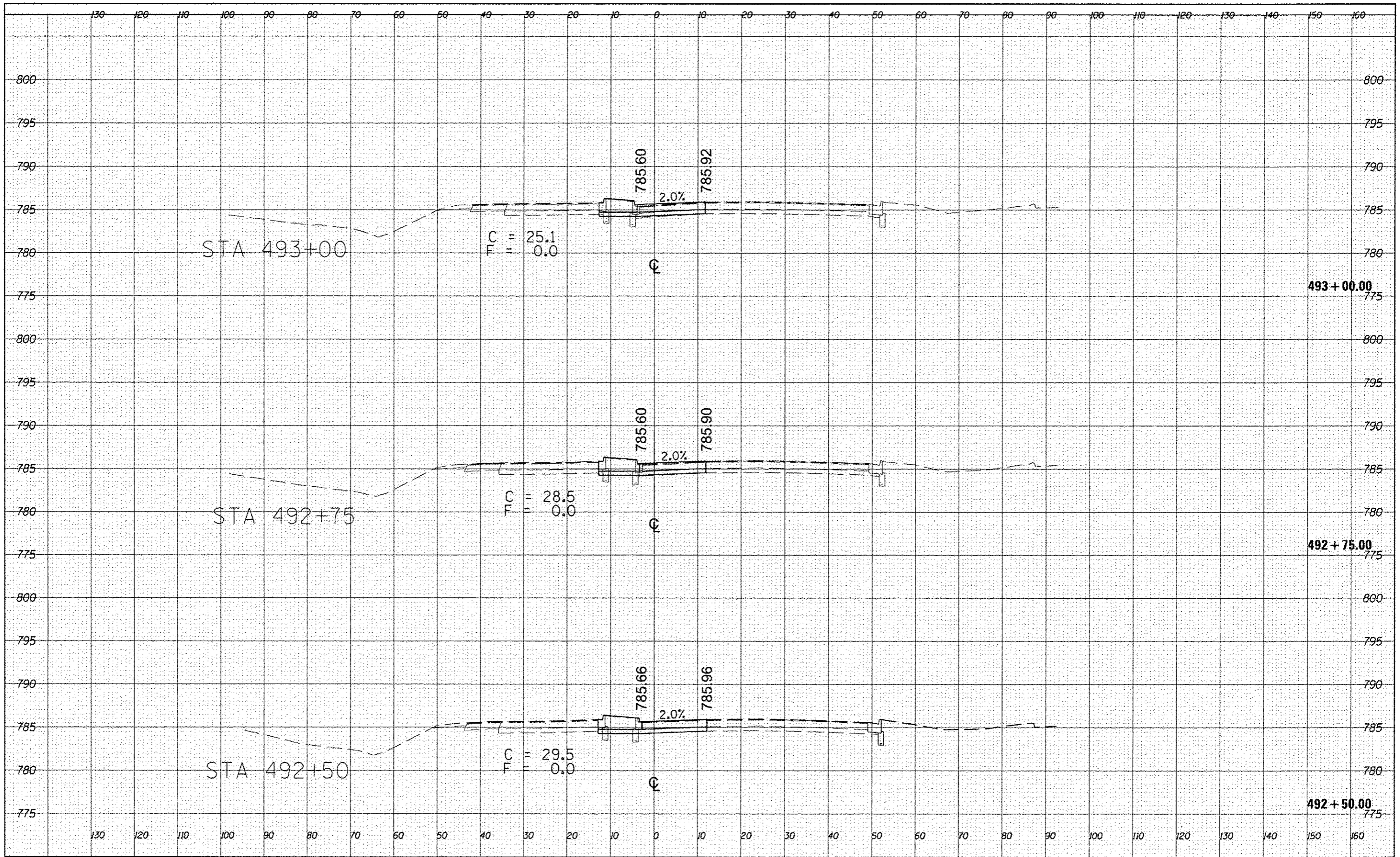

FILE NAME =	USER NAME = rudzinski.jl	DESIGNED -	REVISED -	<b>STATE OF ILLINOIS DEPARTMENT OF TRANSPORTATION</b>	<b>CROSS SECTIONS</b>	F.A.U. RTE.	SECTION	COUNTY	TOTAL SHEETS	SHEET NO.	
c:\pwork\p10105\p10105\p10105.dgn	PLLOT SCALE = 28.8888' / in.	DRAWN -	REVISED -			6791	D4 FYA 2012	KNOX	29	29	
	PLLOT DATE = 6/18/2012	CHECKED -	REVISED -			CONTRACT NO. 68A98					
		DATE -	REVISED -			ILLINOIS FED. AID PROJECT					