

LEGEND

- PROPOSED TYPE IV CABINET, TRAFFIC SIGNAL CONTROLLER, HIGHWAY LIGHTING CONTROLLER, AND SERVICE INSTALLATION
- PROPOSED STEEL COMBINATION MAST ARM ASSEMBLY AND POLE WITH TENON FOR LUMINAIRE
- PROPOSED TRAFFIC SIGNAL POST AND SIGNAL HEAD
- PROPOSED SIGNAL HEAD WITH BACKPLATE, MAST ARM MOUNTED
- PROPOSED GULFBOX JUNCTION
- PROPOSED CONCRETE HANDHOLE
- PROPOSED PVC CONDUIT
- PEDESTRIAN SIGNAL HEAD, POLYCARBONATE, LED, 1 FACE, BRACKET MOUNTED
- PEDESTRIAN SIGNAL HEAD, POLYCARBONATE, LED, 2 FACE, BRACKET MOUNTED

- T CONDUIT IN TRENCH
- P CONDUIT, PUSHED
- 2" PVC SIZE OF CONDUIT
- ⊕ PEDESTRIAN PUSH-BUTTON
- ⊗ LUMINAIRE, SODIUM VAPOR, MULTI-MOUNT, 250 WATT

NOTES:

1. ALL LUMINAIRES ON MAST ARM ASSEMBLY AND POLE ARE LUMINAIRE, SODIUM VAPOR, MULTI-MOUNT, 250 WATT
2. EXISTING CABLES AND CONDUIT THAT DO NOT INTERFERE WITH PROPOSED WORK MAY BE ABANDONED IN PLACE.
3. RELOCATE EXISTING STREET NAME SIGNS ONTO NEW MAST ARMS PER STANDARD 720016-01.

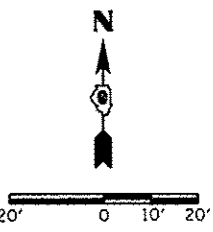
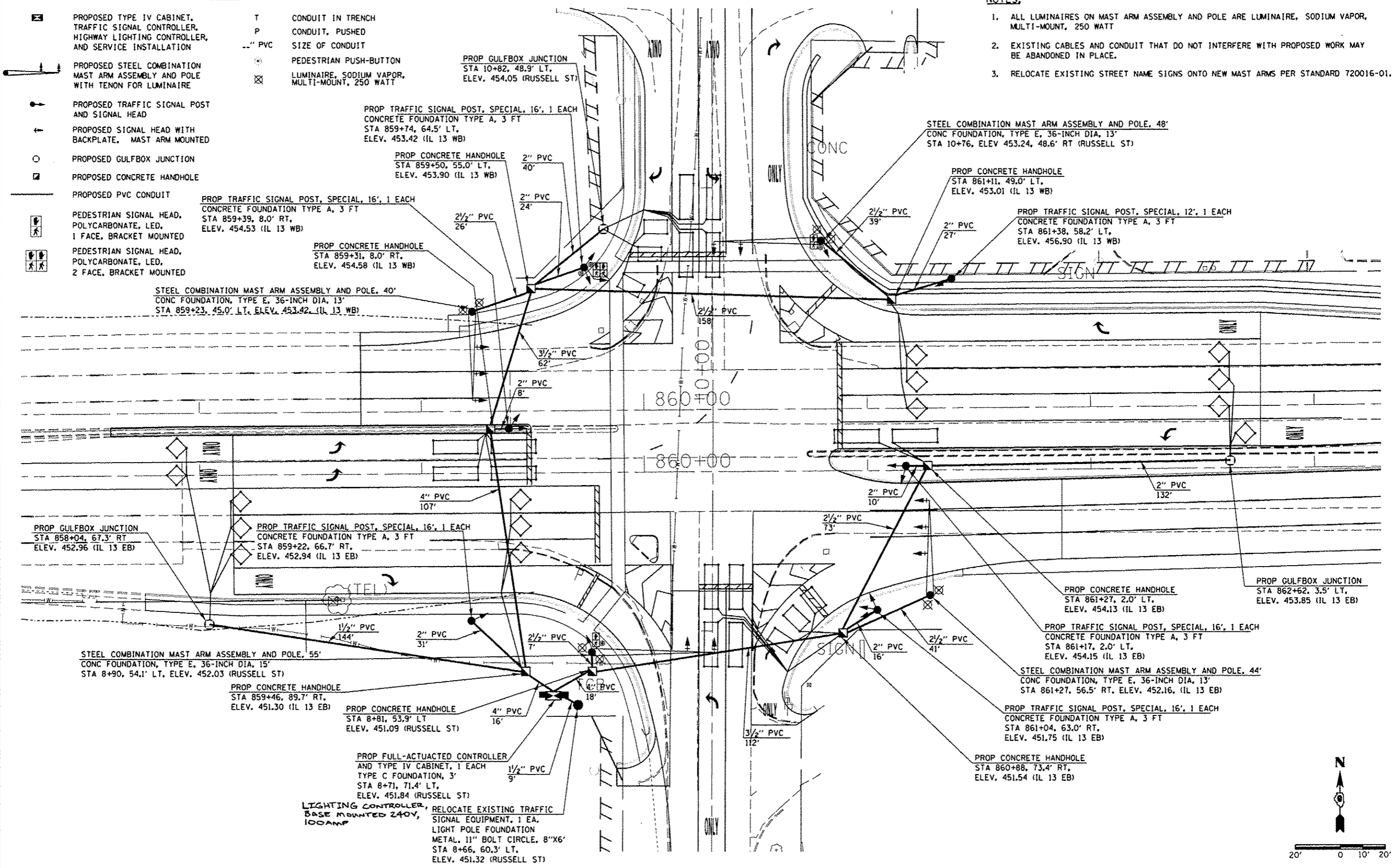

FILE NAME =	USER NAME = #USER#	DESIGNED -	REVISED -
er\paw\work\pawidat\kellyk\d010445\170203-shr-tsig.dgn		DRAWN -	REVISED -
		CHECKED -	REVISED -
		DATE -	REVISED -

**STATE OF ILLINOIS
DEPARTMENT OF TRANSPORTATION**

PROPOSED TRAFFIC SIGNALS AND LIGHTING - IL 13 / RUSSELL ST.			
SCALE:	SHEET NO. OF SHEETS	STA. TO STA.	

F.A. RTE.	SECTION	COUNTY	TOTAL SHEETS	SHEET NO.
331	(1X-1)R-9,RS-3,N-5,TS-4	WILLIAMSON	288	133
CONTRACT NO. 78203			ILLINOIS FED. AID PROJECT	