

### TRAFFIC CONTROL LEGEND

- ◇ ROAD WORK AHEAD-W20-1-48
- ⊠ RIGHT LANE MUST TURN RIGHT-R3-7 36" x 36"
- ⊡ WORKERS-W21-1a(O)-48
- ⊠ TYPE III BARRICADES, R-11-2-6030 (ROAD CLOSED) SIGNS, AND TYPE A LOW INTENSITY FLASHING LIGHTS
- ⊠ 24" x 24" BARRICADES
- CONE, DRUM, OR BARRICADE



48" x 48" FLUORESCENT ORANGE

### PROJECT LOCATION DETAIL

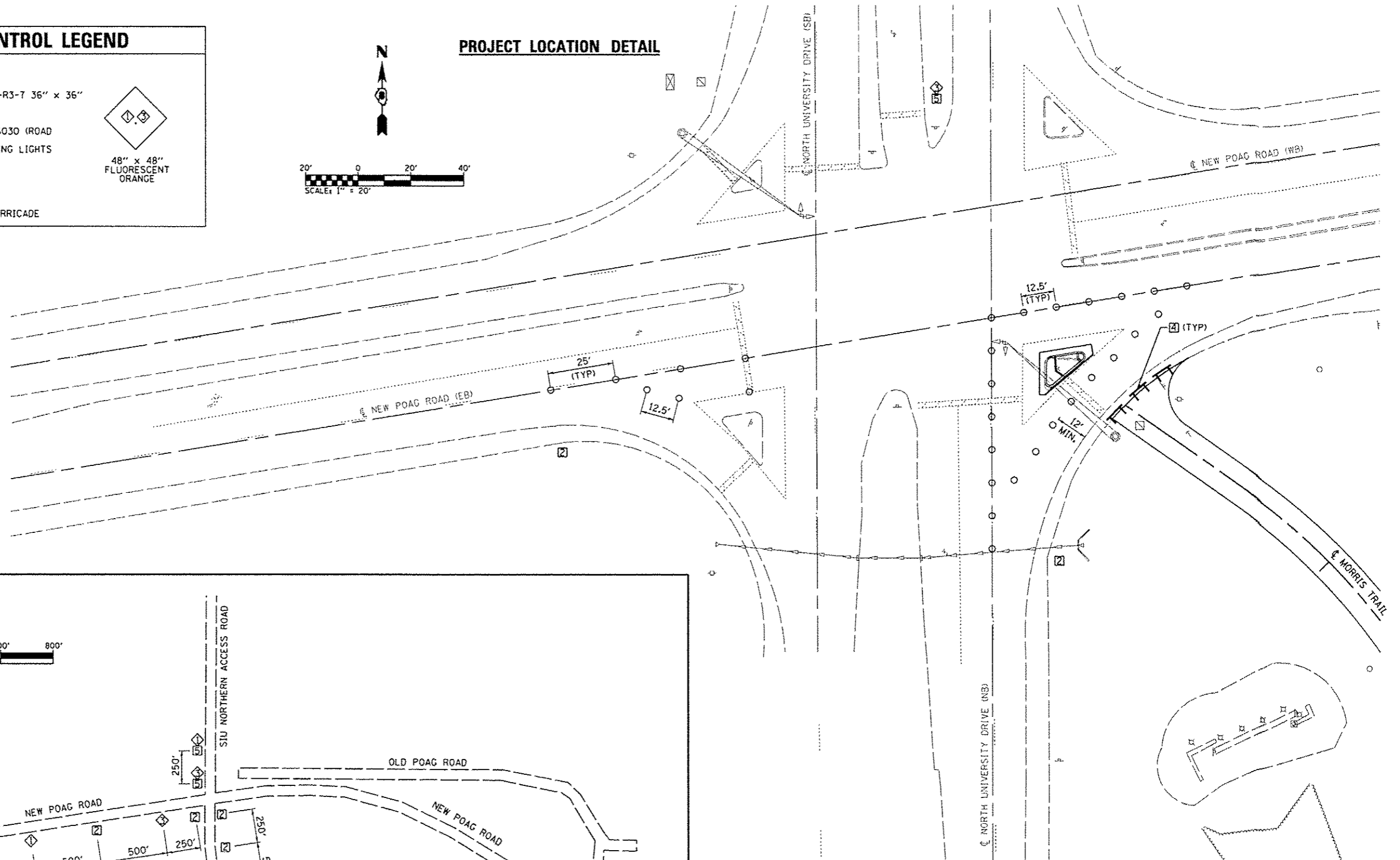
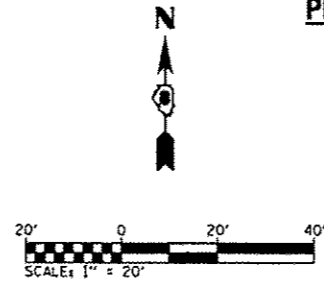

### TRAFFIC CONTROL NOTES

WHEN RE-CONSTRUCTING THE CORNER ISLAND, SET UP TRAFFIC CONTROL USING HIGHWAY STD 701701 AND ACCORDING TO THE LAYOUT SHOWN ON THIS SHEET.

THE ARROW BOARD IS NOT REQUIRED AS SHOWN ON STD 701701, HOWEVER, THE FLAGGER IS REQUIRED DURING CORNER ISLAND CONSTRUCTION OPERATIONS.

AT THE END OF EACH DAY, THE CONTRACTOR SHALL REMOVE THE CONES, DRUMS, OR BARRICADES IN THE WEST QUADRANT AND RE-LOCATE THOSE IN THE SE QUADRANT CLOSER TO THE CORNER ISLAND TO UNOBSTRUCT ALL TRAFFIC LANES. THE "RIGHT LANE MUST TURN RIGHT" SIGNS SHALL ALSO BE TAKEN DOWN DURING THIS TIME.

ALL CONSTRUCTION SIGNS TO BE INCLUDED IN THE COST OF TRAFFIC CONTROL AND PROTECTION, (SPECIAL).

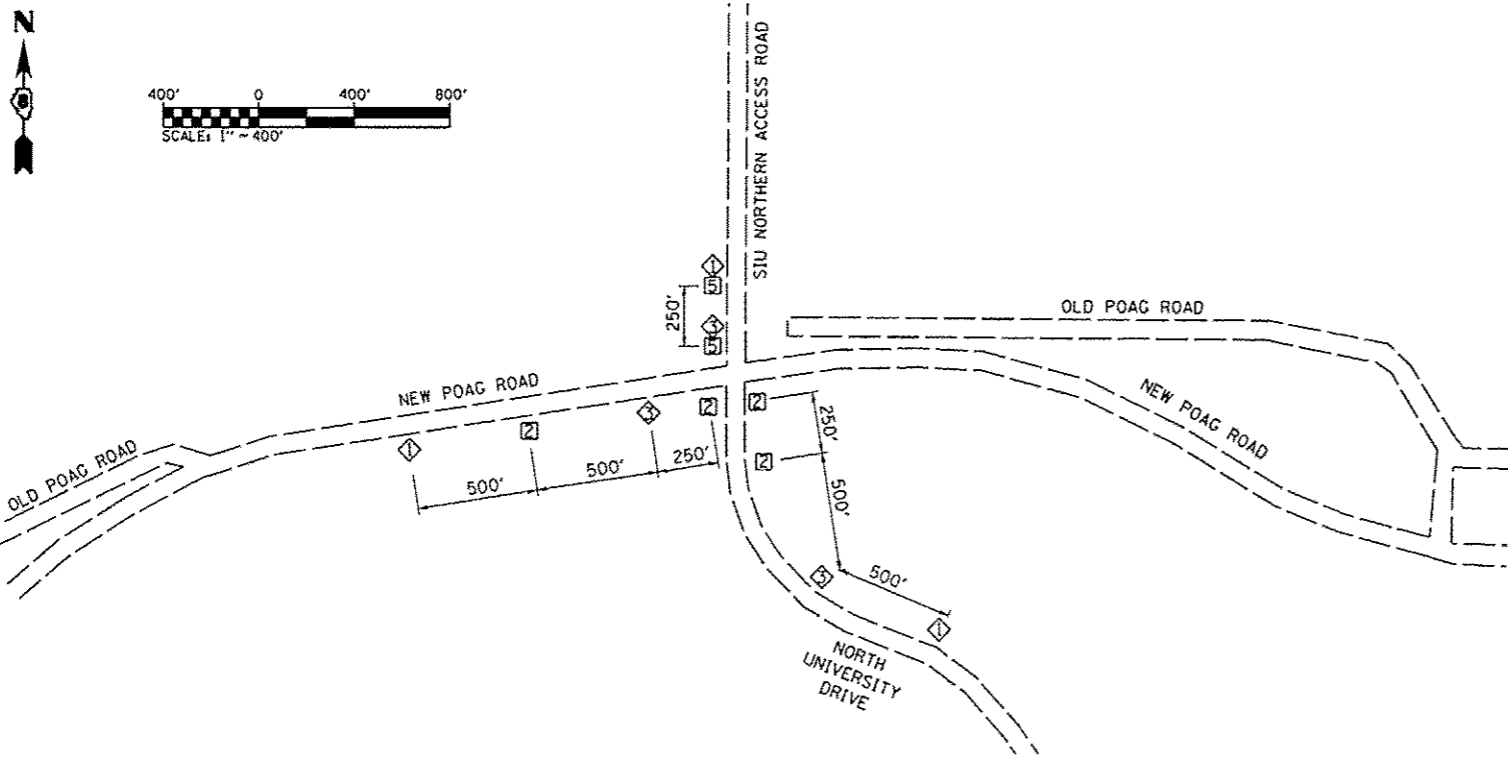

FILE NAME \*  
0829873-shc-staging.dgn

USER NAME \* rardy  
PLOT TIME \* 11:44:45 PM  
PLOT SCALE \* 40,0000' / IN.  
PLOT DATE \* 5/30/2012

DESIGNED -  
DRAWN -  
CHECKED -  
DATE -

REVISED -  
REVISED -  
REVISED -  
REVISED -

**STATE OF ILLINOIS  
DEPARTMENT OF TRANSPORTATION**

**TRAFFIC CONTROL PLAN**

SCALE: SHEET 1 OF 1 SHEETS STA. TO STA.

F.A. RTE.	SECTION	COUNTY	TOTAL SHEETS	SHEET NO.
	10-00006-01-87	MADISON	33	13
MORRIS TRAIL			CONTRACT NO. 97499	
ILLINOIS REG. AID PROJECT				