

F.A.P. BTE	SECTION	COUNTY	TOTAL SHEETS	SHEET NO.
41	(15Z)PP	LIVINGSTON	7	1
			CONTRACT NO. 66J35	

INDEX OF SHEETS

08-03-2018 LETTING ITEM 023

1. COVER SHEET
2. GENERAL NOTES
3. SUMMARY OF QUANTITIES
4. TYPICAL SECTIONS
5. SCHEDULES
- 6 - 7. CLASS B PATCHING DETAILS

STATE OF ILLINOIS
DEPARTMENT OF TRANSPORTATION

**PROPOSED
HIGHWAY PLANS**

F.A.P. ROUTE 41 (IL 17)
SECTION (15Z)PP
PROJECT

PAVEMENT PATCHING
LIVINGSTON

C-93-079-18

STANDARDS

- 000001-06 STANDARD SYMBOLS, ABBREVIATIONS AND PATTERNS
- 001006 DECIMAL OF AN INCH AND OF A FOOT
- 701001-02 OFF-ROAD OPERATIONS 2L, 2W, MORE THAN 15' (4.5 m) AWAY
- 701006-05 OFF-ROAD OPERATIONS 2L, 2W, 15' (4.5 m) TO 24" (600 mm) FROM PAVEMENT EDGE
- 701201-04 LANE CLOSURE, 2L, 2W, DAY ONLY, FOR SPEEDS \geq 45 MPH
- 701501-06 URBAN LANE CLOSURE, 2L, 2W, UNDIVIDED
- 701901-07 TRAFFIC CONTROL DEVICES

D-93-075-18

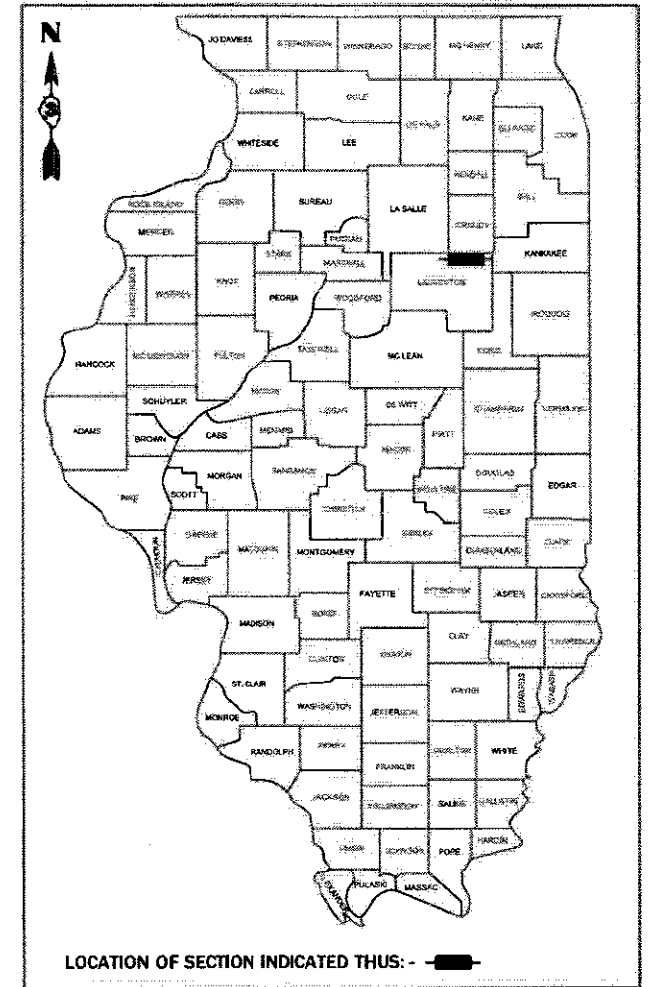

LOCATION OF SECTION INDICATED THUS: - [thick black line] -

FUNCTIONAL CLASSIFICATION

URBAN MINOR ARTERIAL

F.A.P. ROUTE 41 (IL 17)

2017 ADT = 3950

P.V. 91.2% S.U. 4.0% M.U. 4.8%

END IMPROVEMENT
INTERSECTION OF IL 17 AND IL 47
(STA. 54 + 36)

BEGIN IMPROVEMENT
INTERSECTION OF IL 17 AND WAUPANSIE ST.
(STA. 1 + 75)

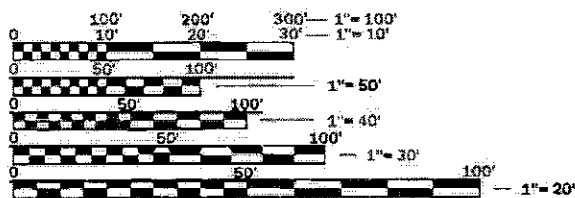
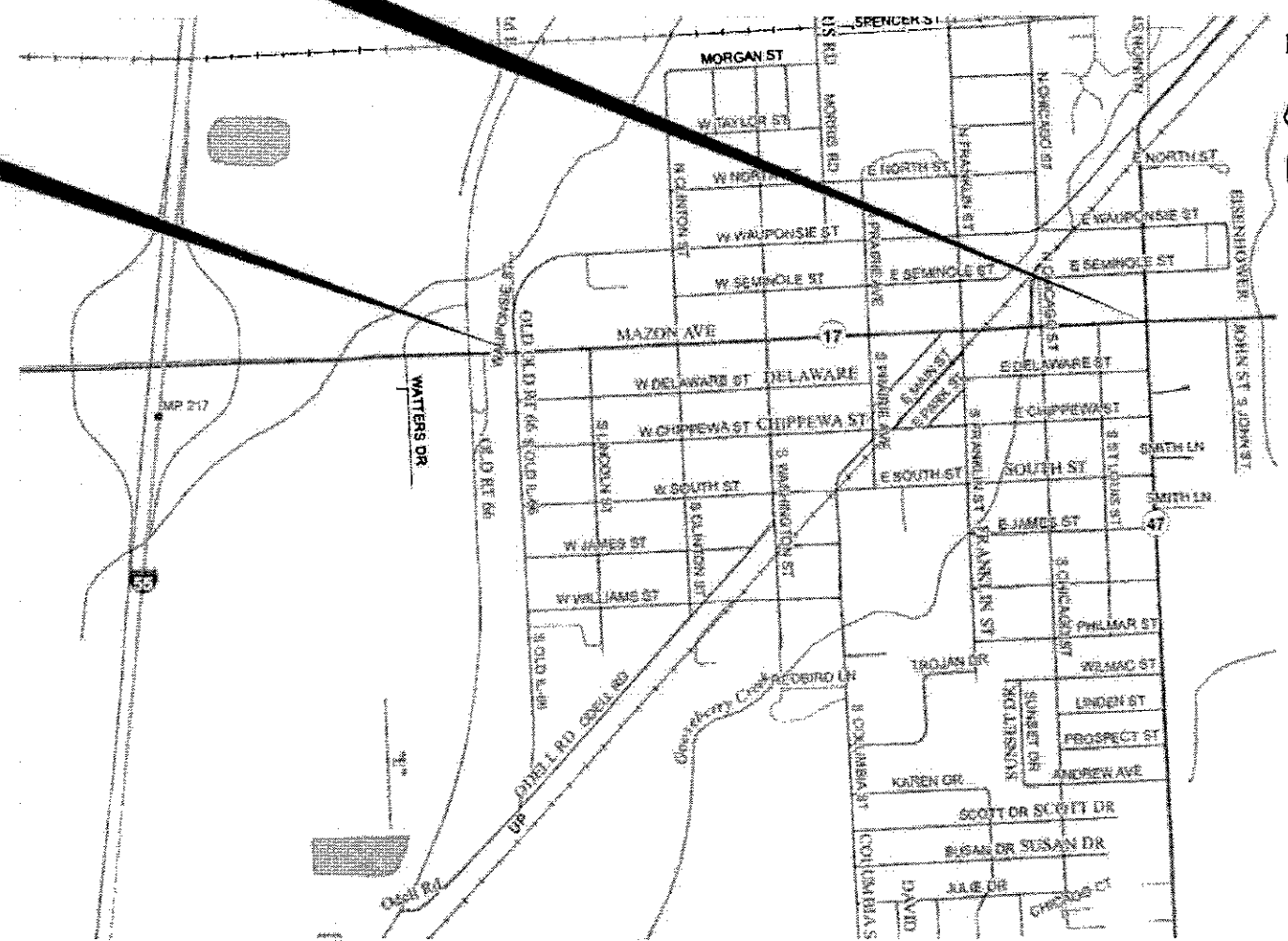

FULL SIZE PLANS HAVE BEEN PREPARED USING STANDARD ENGINEERING SCALES. REDUCED SIZED PLANS WILL NOT CONFORM TO STANDARD SCALES. IN MAKING MEASUREMENTS ON REDUCED PLANS, THE ABOVE SCALES MAY BE USED.

J.U.L.I.E.
JOINT UTILITY LOCATION INFORMATION FOR EXCAVATION
1-800-892-0123
OR 811

PROJECT ENGINEER: JOE KANNEL P.E.
UNIT CHIEF: RON WOODSHANK
DISTRICT 3 NO. (815) 434-6131
CONTRACT NO. 66J35

GROSS LENGTH = 5261 FT. = 1.0 MILE
NET LENGTH = 344 FT. = 0.065 MILE

STATE OF ILLINOIS
DEPARTMENT OF TRANSPORTATION

SUBMITTED 05/11 2018
Kris [Signature]
REGIONAL ENGINEER

June 29 2018
A. Elk
ENGINEER OF DESIGN AND ENVIRONMENT

June 29 2018
Paul P. [Signature]
DIRECTOR OF HIGHWAYS PROJECT IMPLEMENTATION

**PRINTED BY THE AUTHORITY
OF THE STATE OF ILLINOIS**

GENERAL NOTES

PLAN DIMENSIONS AND DETAILS RELATIVE TO EXISTING PLANS ARE SUBJECT TO NOMINAL CONSTRUCTION VARIATIONS. THE CONTRACTOR SHALL FIELD VERIFY EXISTING DIMENSIONS AND DETAILS AFFECTING NEW CONSTRUCTION AND MAKE NECESSARY APPROVED ADJUSTMENTS PRIOR TO CONSTRUCTION OR ORDERING OF MATERIALS. SUCH VARIATIONS SHALL NOT BE CAUSE FOR ADDITIONAL COMPENSATION FOR A CHANGE IN SCOPE OF WORK; HOWEVER, THE CONTRACTOR WILL BE PAID FOR THE QUANTITY ACTUALLY FURNISHED AT THE UNIT PRICE BID FOR THE WORK.

FOR STABILIZATION, ALL TYPE III BARRICADES WILL REQUIRE A MINIMUM OF FOUR SAND BAGS PER BARRICADE.

ALL EXCAVATED MATERIAL, WHICH INCLUDES DIGGING OR GRADING OF ANY SOIL OR FILL MATERIAL, WITH THE EXCEPTION OF AGGREGATE FILLS, MUST BE INCORPORATED WITHIN THE IDOT RIGHT OF WAY DUE TO ENVIRONMENTAL DOCUMENTATION REQUIREMENTS.

ANY REFERENCE TO A STANDARD IN THESE PLANS SHALL BE INTERPRETED TO MEAN THE EDITION AS INDICATED BY THE SUBNUMBER SHOWN IN THE LIST OF STANDARDS OR THE COPY INCLUDED IN THESE PLANS.

THE CONTRACTOR SHALL CONTACT JULIE AT LEAST 48 HOURS PRIOR TO EXCAVATION TO DETERMINE WHICH UTILITIES ARE IN THE AREA.

COMMITMENTS

STATE OF ILLINOIS
DEPARTMENT OF TRANSPORTATION
DISTRICT THREE
AS BUILT INFORMATION

SUPERVISING CONSTRUCTION FIELD ENGINEER

RESIDENT ENGINEER / TECHNICIAN

START & END DATES
OF CONSTRUCTION:

INSPECTORS:

STATE OF ILLINOIS
DEPARTMENT OF TRANSPORTATION
DISTRICT THREE

PREPARED BY: *Benil*
DISTRICT STUDIES & PLANS ENGINEER

DATE: May 10, 2018

EXAMINED BY: *[Signature]*
DISTRICT CONSTRUCTION ENGINEER

Michael A. Sht
DISTRICT MATERIALS ENGINEER

[Signature]
DISTRICT OPERATIONS ENGINEER

FILE NAME =	USER NAME = woodywp	DESIGNED - RW	REVISED -
DT Office\District 3\Projects\1306.135\CADD\1618.05-cover.dwg		DRAWN - RW	REVISED -
	PLOT SCALE = 100,0000' / 1"	CHECKED - JW	REVISED -
Default	PLOT DATE = 5/9/2018	DATE = 05/09/2018	REVISED -

STATE OF ILLINOIS
DEPARTMENT OF TRANSPORTATION

GENERAL NOTES

SCALE: SHEET 1 OF 1 SHEETS STA. TO STA.

F.A.P. RTE.	SECTION	COUNTY	TOTAL SHEETS	SHEET NO.
41	(16.152)PP	LIVINGSTON	7	2
CONTRACT NO. 86J35				
ILLINOIS FED. AID PROJECT				

CODE NO.	ITEM	UNIT	TOTAL QUANTITY	CONSTR. CODE	
				CONTRACT MAINTENANCE	100% STATE
				ROADWAY	
				0006	
				URBAN	
44200970	CLASS B PATCHES, TYPE II, 10 INCH	SQ YD	460	460	
44201299	DOWEL BARS 1 1/2"	EACH	1120	1120	
44213200	SAW CUTS	FOOT	3048	3048	
67100100	MOBILIZATION	L SUM	1	1	
70102620	TRAFFIC CONTROL AND PROTECTION, STANDARD 701501	L SUM	1	1	
X7010520	TRAFFIC CONTROL AND PROTECTION, STANDARD 701201 (SPECIAL)	L SUM	1	1	
Z0030850	TEMPORARY INFORMATION SIGNING	SQ FT	42	42	

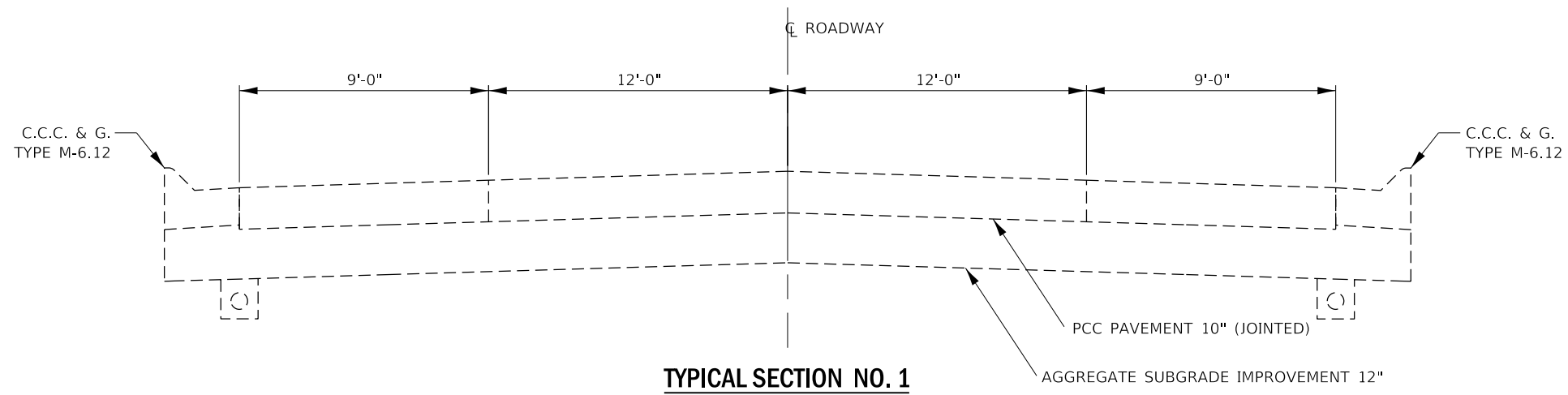

TYPICAL SECTION NO. 1

STA. 1+75 - STA. 39+23
 STA. 40+54 - STA. 54+36

***RAILROAD OMISSION**
STA. 32+90 - STA. 44+60

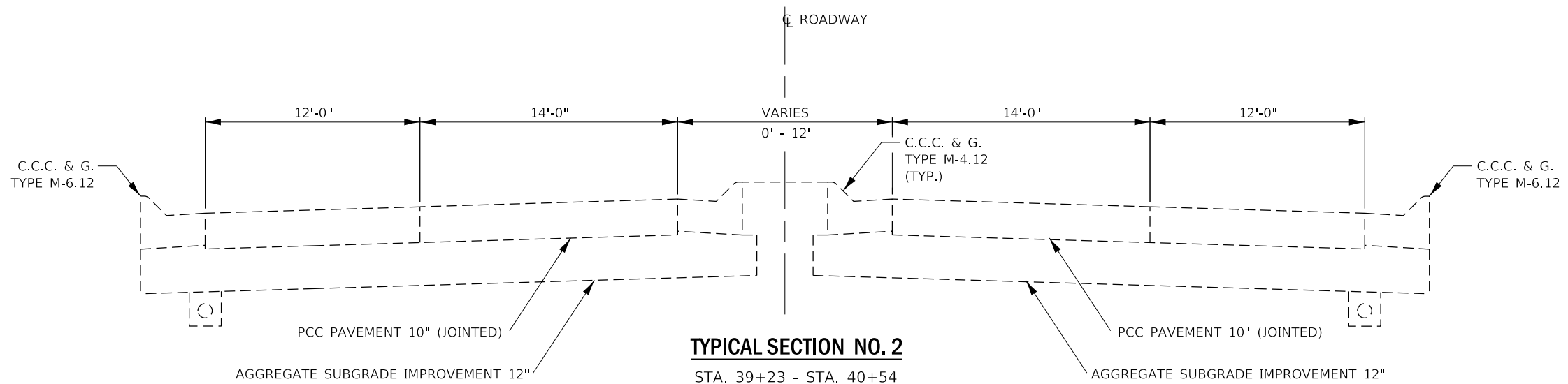

TYPICAL SECTION NO. 2

STA. 39+23 - STA. 40+54

FILE NAME =	USER NAME = woodyetjp	DESIGNED - RW	REVISED -
pw:\IL084EBIDINTEG\ilnotes.gov\PWIDOT\Documents\DOT Offices\District 3\Projects\D366J35\CADDData\66J35-cover.dgn		DRAWN - RW	REVISED -
Default	PLOT SCALE = 100.0000' / in.	CHECKED - JW	REVISED -
	PLOT DATE = 5/9/2018	DATE - 05/09/2018	REVISED -

STATE OF ILLINOIS
DEPARTMENT OF TRANSPORTATION

TYPICAL SECTION

SCALE: SHEET 1 OF 1 SHEETS STA. TO STA.

F.A.P. RTE.	SECTION	COUNTY	TOTAL SHEETS	SHEET NO.
41	(16.15Z)PP	LIVINGSTON	7	4
CONTRACT NO. 66J35				
ILLINOIS		FED. AID PROJECT		

**SCHEDULE
EASTBOUND LANE PATCHING**

LOCATION	DRIVING LANE			
	PATCH LENGTH	CLASS B PATCHING TYPE II 10"	DOWEL BARS 1 1/2"	SAW CUTS
LOG MILE	(FT)	SQ YD	EACH	FOOT
2+28	6	8	20	54
4+39	6	8	20	54
7+03	6	8	20	54
8+61	8	11	20	60
9+67	6	8	20	54
12+31	6	8	20	54
14+95	6	8	20	54
17+59	6	8	20	54
20+23	6	8	20	54
20+23	6	8	20	54
21+29	6	8	20	54
21+29	6	8	20	54
22+87	6	8	20	54
23+40	6	8	20	54
24+98	6	8	20	54
25+51	6	8	20	54
25+51	6	8	20	54
26+57	6	8	20	54
28+68	8	11	20	60
30+79	6	8	20	54
31+32	6	8	20	54
44+52	6	8	20	54
44+52	6	8	20	54
51+91	6	8	20	54
52+44	6	8	20	54
52+44	6	8	20	54
52+97	6	8	20	54
54+29	6	8	20	54
TOTALS		230	560	1524

**SCHEDULE
WESTBOUND LANE PATCHING**

LOCATION	DRIVING LANE			
	PATCH LENGTH	CLASS B PATCHING TYPE II 10"	DOWEL BARS 1 1/2"	SAW CUTS
LOG MILE	(FT)	SQ YD	EACH	FOOT
53+83	6	8	20	54
51+72	6	8	20	54
51+72	6	8	20	54
50+66	6	8	20	54
50+66	6	8	20	54
49+08	6	8	20	54
49+08	6	8	20	54
48+55	6	8	20	54
33+24	6	8	20	54
33+24	6	8	20	54
30+60	6	8	20	54
30+60	6	8	20	54
30+60	6	8	20	54
29+54	8	11	20	60
27+96	6	8	20	54
27+96	6	8	20	54
26+38	6	8	20	54
26+38	6	8	20	54
22+68	6	8	20	54
20+04	6	8	20	54
19+51	6	8	20	54
17+40	6	8	20	54
9+48	6	8	20	54
9+48	6	8	20	54
8+42	8	11	20	60
6+84	6	8	20	54
5+78	6	8	20	54
4+20	6	8	20	54
TOTALS		230	560	1524

FILE NAME =	USER NAME = woodyetjp	DESIGNED - RW	REVISED -
pw:\IL084EBIDINTEG\ifnotes\gov\PWIDOT\Documents\DOT Offices\District 3\Projects\0366\J35\CADDData\66J35-cover.dgn		DRAWN - RW	REVISED -
Default	PLOT SCALE = 100.0000' / in.	CHECKED - JW	REVISED -
	PLOT DATE = 5/9/2018	DATE - 05/09/2018	REVISED -

**STATE OF ILLINOIS
DEPARTMENT OF TRANSPORTATION**

SCHEDULES

SCALE: SHEET 1 OF 1 SHEETS STA. TO STA.

F.A.P. RTE.	SECTION	COUNTY	TOTAL SHEETS	SHEET NO.
41	(16.15Z)PP	LIVINGSTON	7	5
CONTRACT NO. 66J35				
ILLINOIS		FED. AID PROJECT		

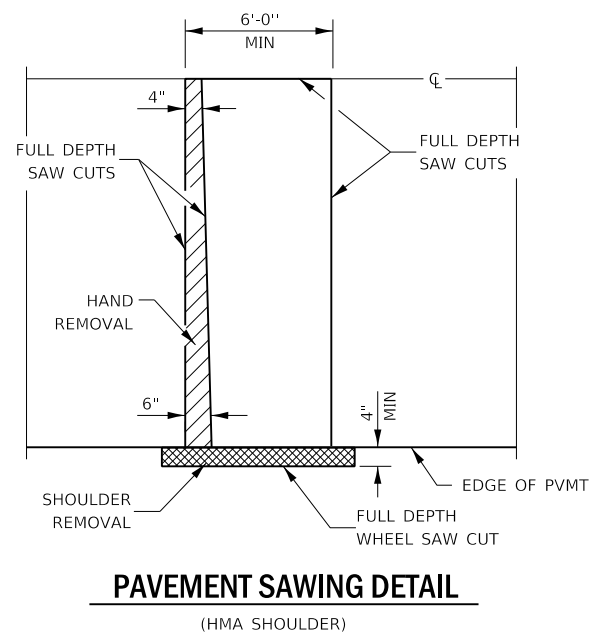

PAVEMENT SAWING DETAIL
(HMA SHOULDER)

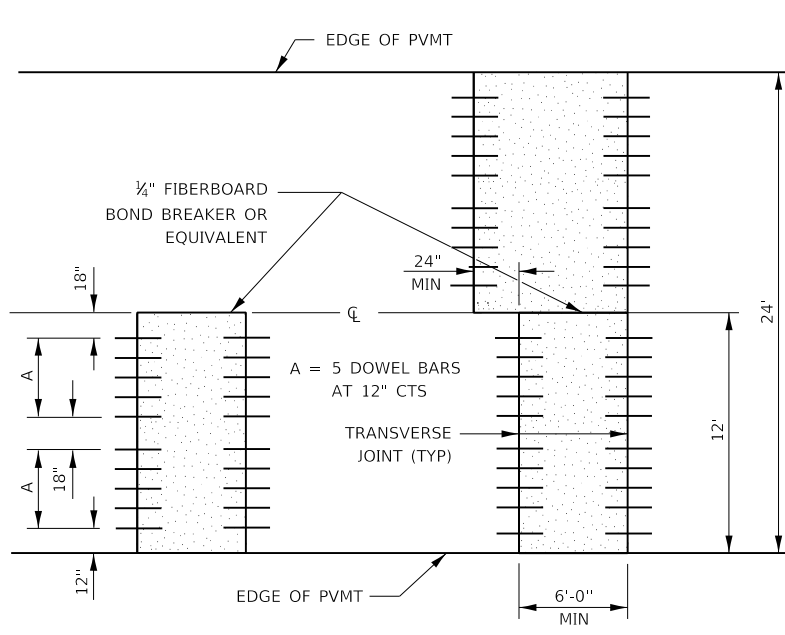

12' WIDE LANES

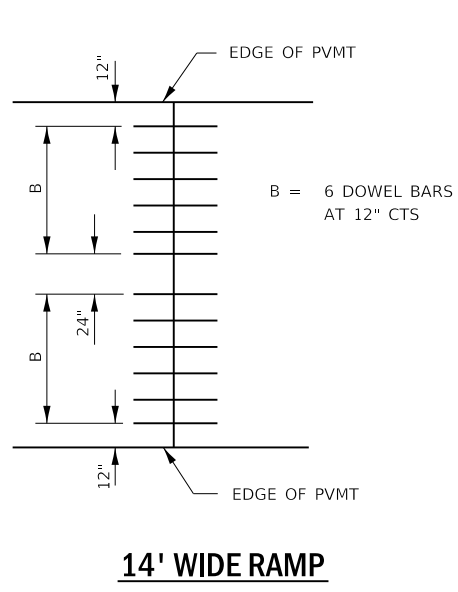

14' WIDE RAMP

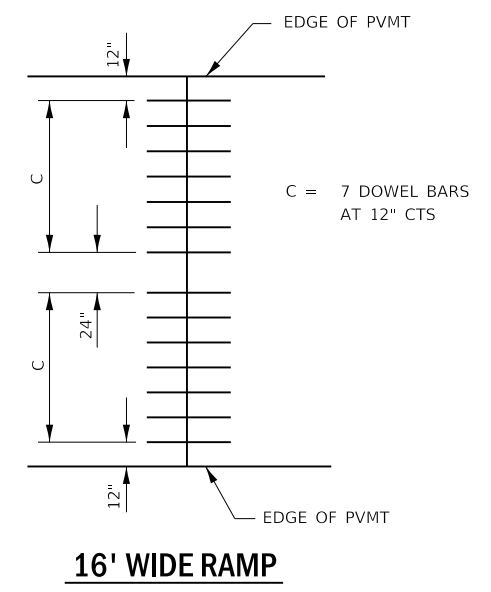

16' WIDE RAMP

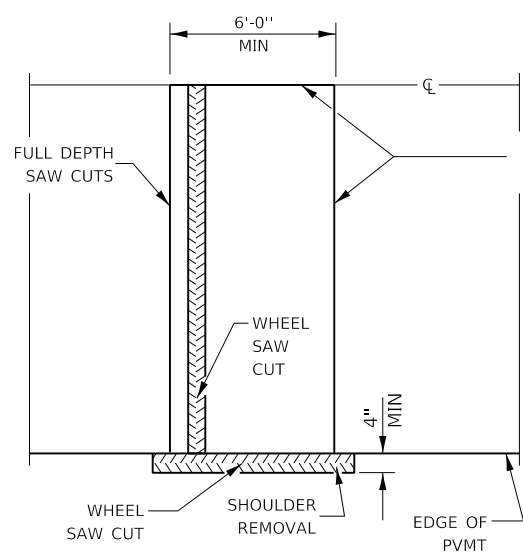

ALTERNATE SAWING DETAIL
(HMA SHOULDER)

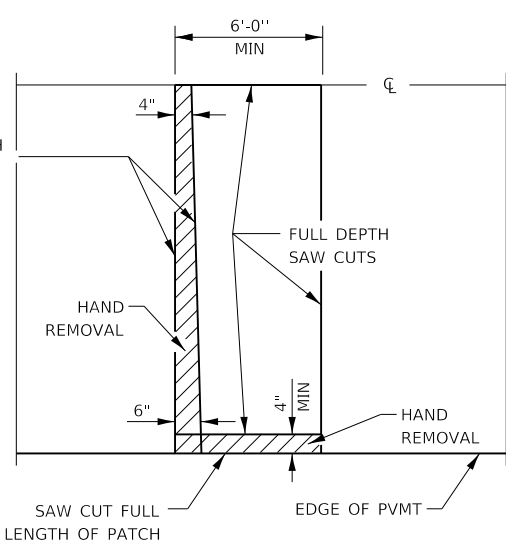

PAVEMENT SAWING DETAIL
(PCC SHOULDER)

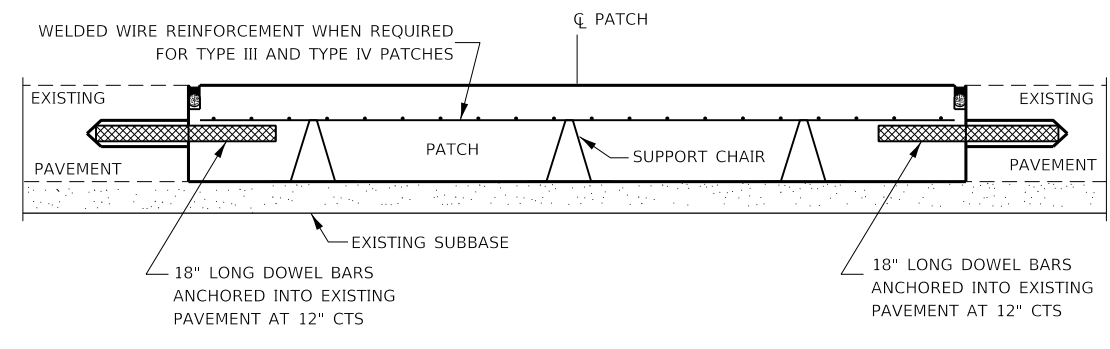

PATCHING WITHOUT HMA OVERLAY

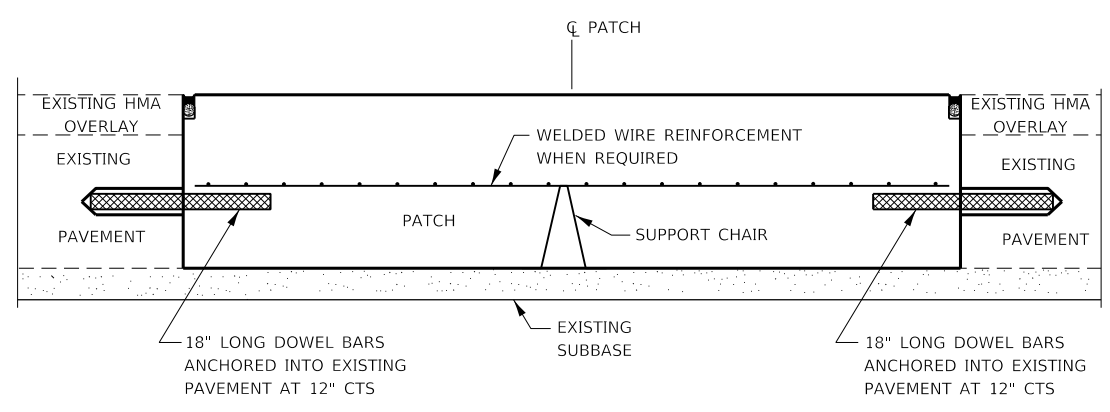

PATCHING WITH HMA OVERLAY

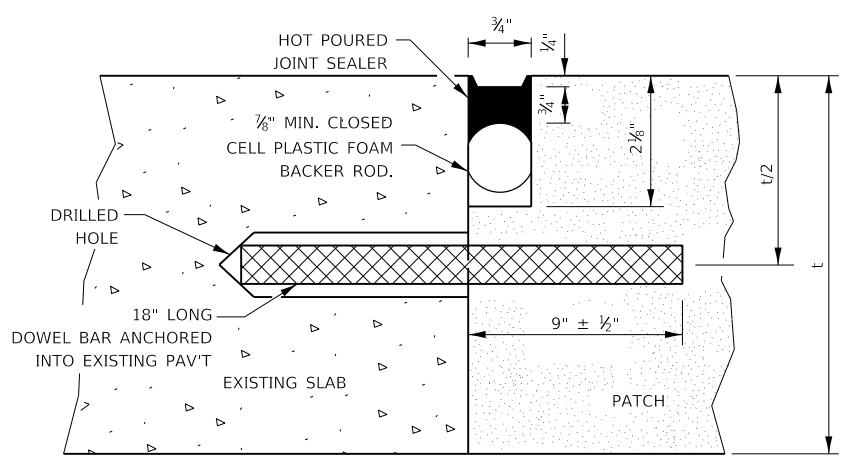

TRANSVERSE JOINT

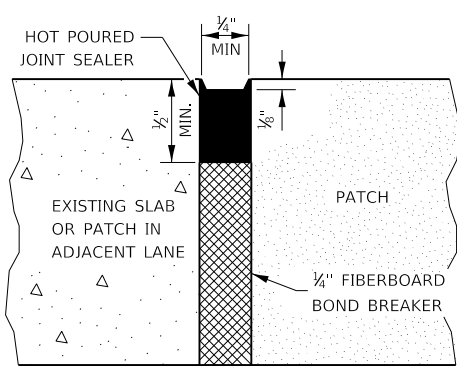

CENTERLINE JOINT

DOWEL BAR TABLE		
PAVEMENT THICKNESS	DOWEL BAR DIAMETER	HOLE DIAMETER
8" OR GREATER	1 1/2"	1 3/8"
7" THRU 7.99"	1 1/4"	1 3/8"
LESS THAN 7"	1"	1 1/8"

GENERAL NOTES

THE TRANSVERSE JOINTS FOR CLASS B PATCHES SHALL ALIGN WITH JOINTS OR CRACKS IN THE ADJACENT LANE WHENEVER POSSIBLE.
SEE STANDARD 420701 FOR DETAILS OF PAVEMENT WELDED WIRE REINFORCEMENT.

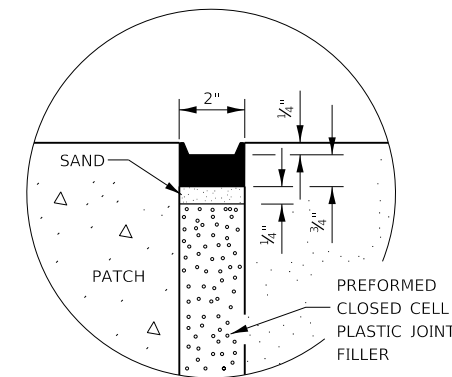
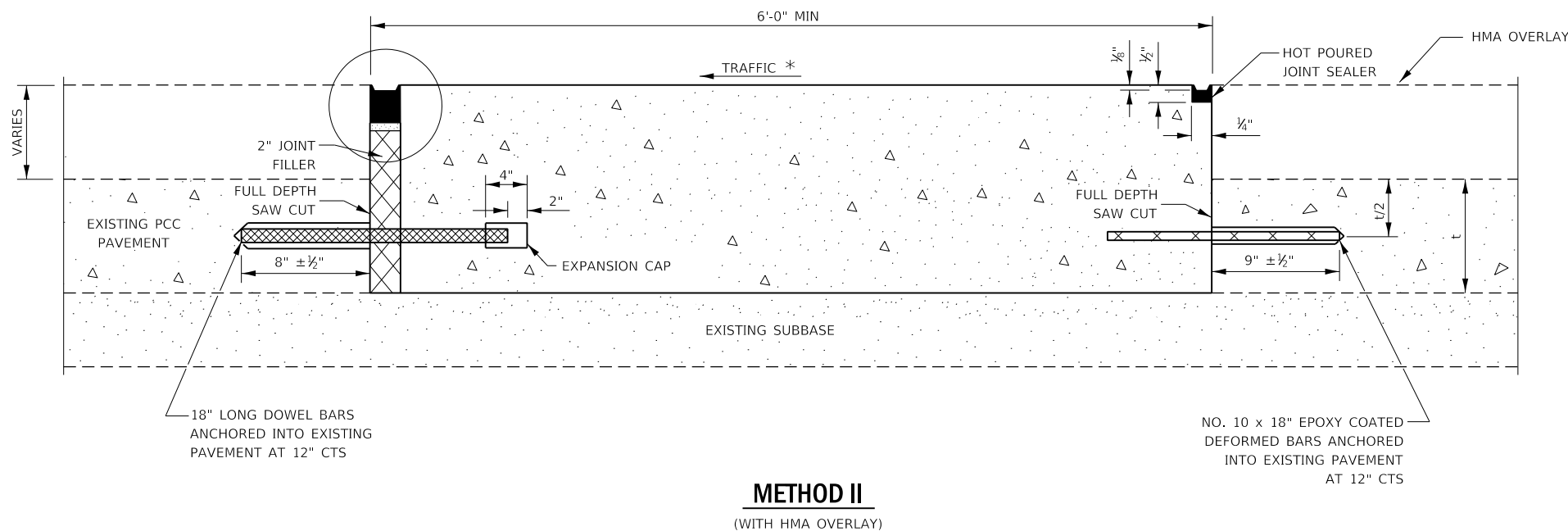
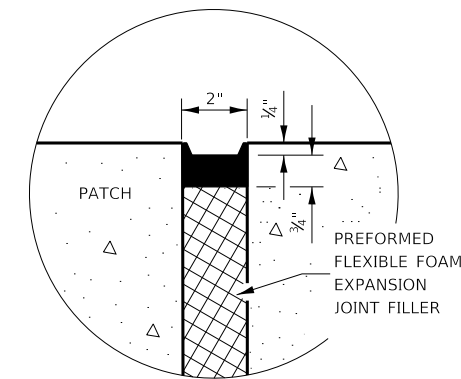
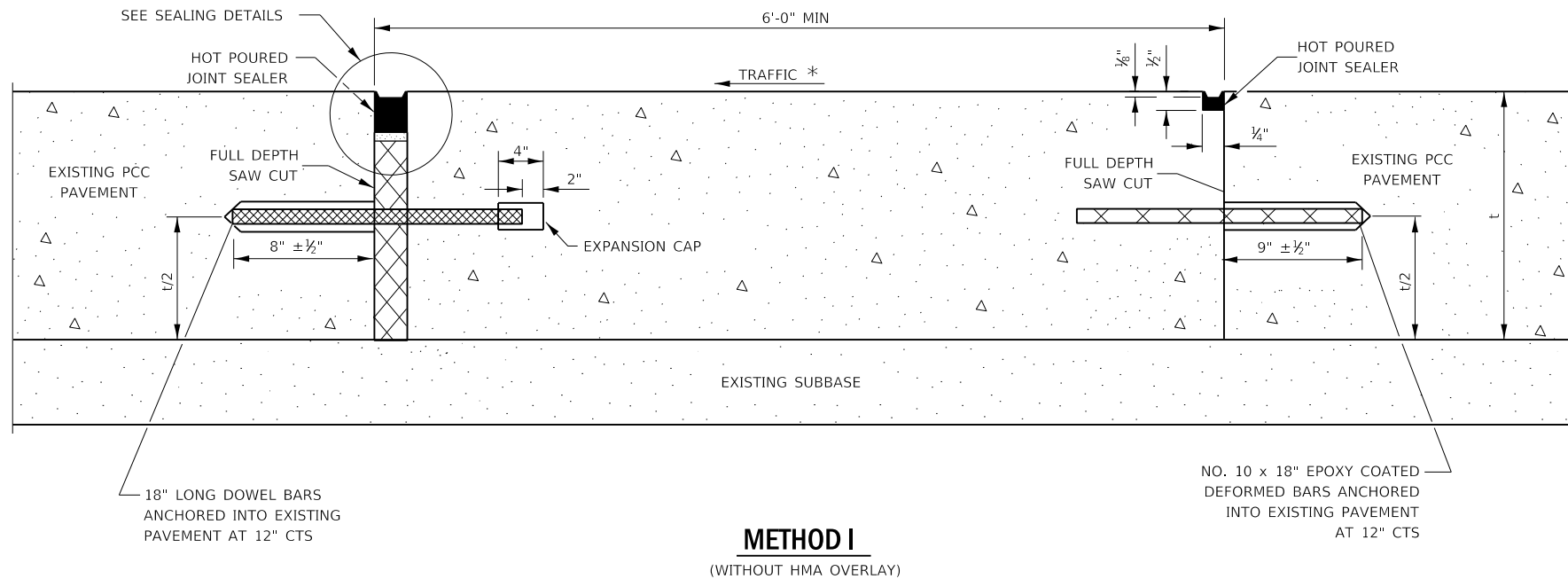

NOTE

* WHEN RE-ESTABLISHING A TRANSVERSE EXPANSION JOINT ON A TWO-WAY ROAD, REVERSE THE ORIENTATION OF THE DOWEL BARS WITH RESPECT TO TRAFFIC FOR ONE OF THE PATCHES SUCH THAT THE JOINT WILL BE CONTINUOUS ACROSS BOTH LANES.

FILE NAME =	USER NAME = woodyetjp	DESIGNED - RW	REVISED -	STATE OF ILLINOIS DEPARTMENT OF TRANSPORTATION	CLASS B PATCHING DETAILS			F.A.P. RTE.	SECTION	COUNTY	TOTAL SHEETS	SHEET NO.
pw:\IL084EBIDINTEG\ilnotes.gov\PWIDOT\Documents\DOT Offices\District 3\Projects\D366J35\CADData\66J35-cover.dgn		DRAWN - RW	REVISED -					41	(16.15Z)PP	LIVINGSTON	7	7
PLOT SCALE = 100.0000' / in.		CHECKED - JW	REVISED -		CONTRACT NO. 66J35							
Default	PLOT DATE = 5/9/2018	DATE - 05/09/2018	REVISED -		SCALE:	SHEET 2 OF 2 SHEETS	STA.	TO STA.	ILLINOIS FED. AID PROJECT			