

STATE OF ILLINOIS  
DEPARTMENT OF TRANSPORTATION

F.A.P. RTE.	SECTION	COUNTY	TOTAL SHEETS	SHEET NO.
799	1-BR, DS-2	ST. CLAIR	16	1
		ILLINOIS	CONTRACT NO. 76J69	

FOR INDEX OF SHEETS, SEE SHEET NO. 2

**PROPOSED  
HIGHWAY PLANS**

FAP ROUTE 799 (ILLINOIS AVE.)  
SECTION 1-BR, DS-2  
PROJECT NHPP-BT5L(364)  
BRIDGE DECK SEALING  
ST. CLAIR COUNTY

C-98-243-18

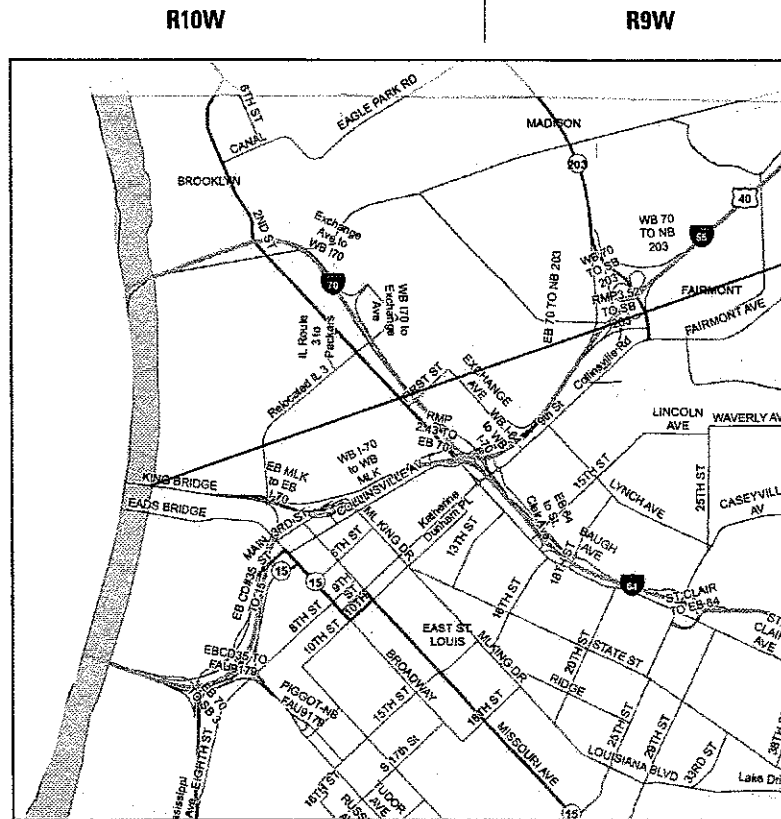
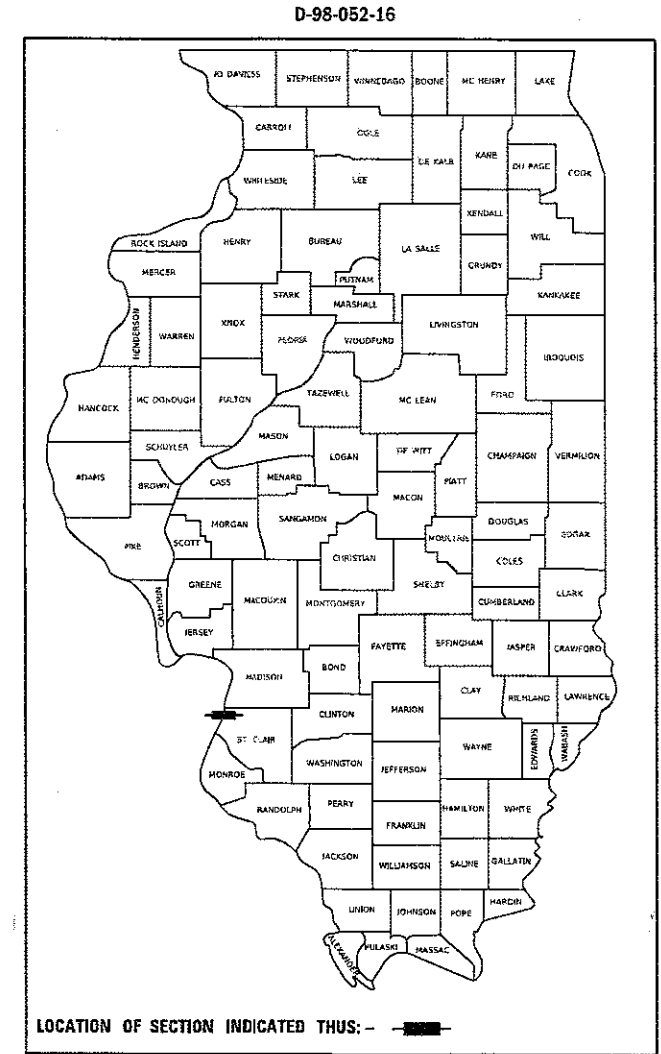

**PROJECT LOCATION**  
**MARTIN LUTHER KING BRIDGE**  
SN 082-6001  
LAT: 38.63093  
LONG: -90.17830

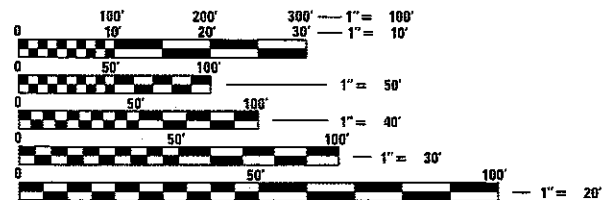

FULL SIZE PLANS HAVE BEEN PREPARED USING STANDARD ENGINEERING SCALES. REDUCED SIZED PLANS WILL NOT CONFORM TO STANDARD SCALES. IN MAKING MEASUREMENTS ON REDUCED PLANS, THE ABOVE SCALES MAY BE USED.

J.U.L.I.E.  
JOINT UTILITY LOCATION INFORMATION FOR EXCAVATION  
1-800-892-0123  
OR 811

PROJECT ENGINEER: HERVE GELIN (618) 346-3179  
PROJECT MANAGER: BILLIE OWEN (618) 346-3209

CONTRACT NO. 76J69

ADT  
2017 = 11,950 (ACTUAL)  
2018 = 12,100 (ESTIMATED)  
2038 = 14,700 (ESTIMATED)  
SU = 1.7% MU = 1.9%  
WB = 40% / EB = 60%

GROSS / NET LENGTH = 4,010.3 FT. = 0.76 MILE

STATE OF ILLINOIS  
DEPARTMENT OF TRANSPORTATION

SUBMITTED *April 26, 2018*

*Jeffrey Z. Kan...*  
REGIONAL ENGINEER

*June 29, 2018*  
ENGINEER OF DESIGN AND ENVIRONMENT

*June 29, 2018*  
DIRECTOR OF HIGHWAYS PROJECT IMPLEMENTATION

**PRINTED BY THE AUTHORITY  
OF THE STATE OF ILLINOIS**

**INDEX OF SHEETS**

- 1. COVER SHEET
- 2. INDEX OF SHEETS, HIGHWAY STANDARDS, GENERAL NOTES, AND COMMITMENTS
- 3. SUMMARY OF QUANTITIES
- 4-12 TYPICAL SECTIONS AND PLAN VIEWS
- 13-16 ELEVATIONS

**HIGHWAY STANDARDS**

000001-06  
001006

**GENERAL NTOES**

- 1. ILLINOIS STATE LAW REQUIRES A 48-HOUR NOTICE BE GIVEN TO ALL UTILITIES WITHIN THE PROJECT AREA BEFORE DIGGING. FIELD MARKING OF FACILITIES MAY BE OBTAINED BY CONTACTING J.U.L.I.E. OR FOR NON-MEMBERS, THE UTILITY COMPANY DIRECTLY. AGENCIES KNOWN TO HAVE FACILITIES WITHIN THE PROJECT AREA ARE AS FOLLOWS:

- \* AMEREN ILLINOIS
- \* AT&T ILLINOIS
- \* AT&T CORPORATION
- \* CENTURY LINK
- \* CITY OF EAST ST. LOUIS
- \* EXPLORER PIPELINE COMPANY
- \* ILLINOIS AMERICAN WATER COMPANY
- \* LEVEL (3) COMMUNICATIONS, LLC
- \* METRO COMMUNICATIONS COMPANY, INC.
- \* SPIRE ENERGY
- \* SPRINT/NEXTEL
- \* WINDSTREAM KDL, INC.

MEMBERS OF J.U.L.I.E. CALL TOLL FREE (800) 892-0123 OR 811 AND ARE INDICATED BY \*. NON- J.U.L.I.E. MEMBERS MUST BE NOTIFIED INDIVIDUALLY.

- 2. NO CONCRETE SEALER WILL BE APPLIED TO THE PARAPETS ON SPANS 8, 9, AND 10. BARRIER BETWEEN EAST AND WEST BOUND TRAFFIC WILL REQUIRE SEALER.
- 3. THE DEPARTMENT STRONGLY ENCOURAGES THE PRIME CONTRACTOR AND THEIR APPROVED SUB-CONTRACTORS TO HIRE MINORITY, WOMEN AND DISADVANTAGED INDIVIDUALS FROM ITS FEDERALLY FUNDED HIGHWAY CONSTRUCTION CAREERS TRAINING PROGRAM (HCCTP) TO HELP MEET WORKFORCE AND TRAINEE GOALS. THIS PROGRAM IS TRAINING MINORITIES, WOMEN AND DISADVANTAGED INDIVIDUALS IN HIGHWAY CONSTRUCTION-RELATED SKILLS, E.G., MATH FOR THE TRADES, JOB READINESS, TECHNICAL SKILLS COURSEWORK (CARPENTRY, CONCRETE FLATWORK, BLUEPRINT READING, SITE PLANS, SITE WORK, TOOLS USE, ETC.) AND OSHA 10 HOUR CERTIFICATION, TO PREPARE THEM FOR A CAREER IN THE HIGHWAY CONSTRUCTION TRADES. GRADUATES ARE WELL-TRAINED AND READY TO BECOME PRODUCTIVE ENTRY-LEVEL CONSTRUCTION WORKERS. CONTACT THE DISTRICT 8 EEO OFFICE AT 618-346-3360 AND/OR THE HCCTP COORDINATOR AT 618-874-6528 TO LEARN MORE ABOUT THE PROGRAM AND FOR ASSISTANCE IN MEETING WORKFORCE AND TRAINEE GOALS.

**COMMITMENTS**

NONE

MODEL: Default  
 FILE: \\nashc-pw\ill08a\EBID\NTEC\Illinois.gov\PW\DOT\Documents\1\DOT\_Offices\District 8\Projects\0876\69\CADD\ana\CD\sheet\0876\69-ah-eg-emr08.docx

USER NAME = challandeske	DESIGNED -	REVISED -
	DRAWN -	REVISED -
PLOT SCALE = 100,0000 ' / in.	CHECKED -	REVISED -
PLOT DATE = 4/23/2018	DATE -	REVISED -

**STATE OF ILLINOIS  
DEPARTMENT OF TRANSPORTATION**

**INDEX OF SHEETS, HIGHWAY STANDARDS  
GENERAL NOTES AND COMMITMENTS**

SCALE: SHEET OF SHEETS STA. TO STA.

F.A.P. RTE.	SECTION	COUNTY	TOTAL SHEETS	SHEET NO.
799	1-BR, DS-2	ST. CLAIR	16	2
			CONTRACT NO. 76J69	
		ILLINOIS	FED. AID PROJECT	



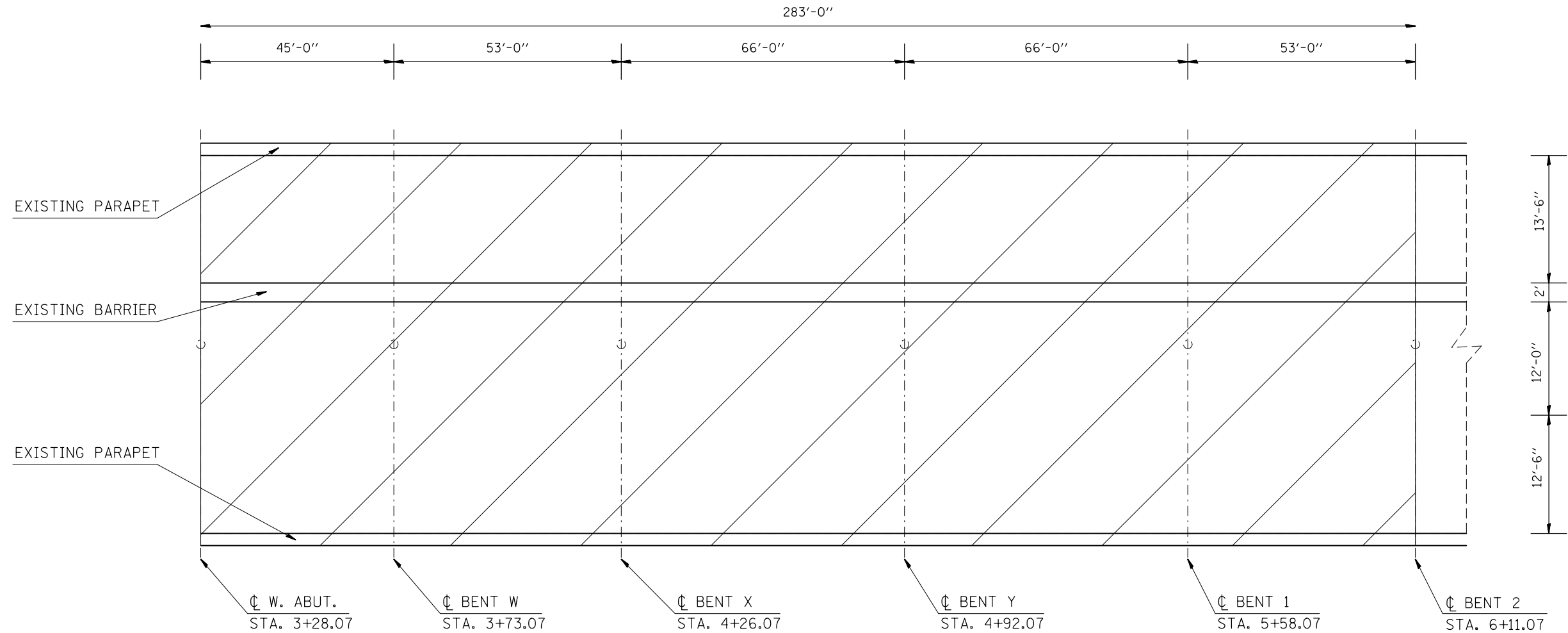

PLAN  
SPANS W THROUGH 2

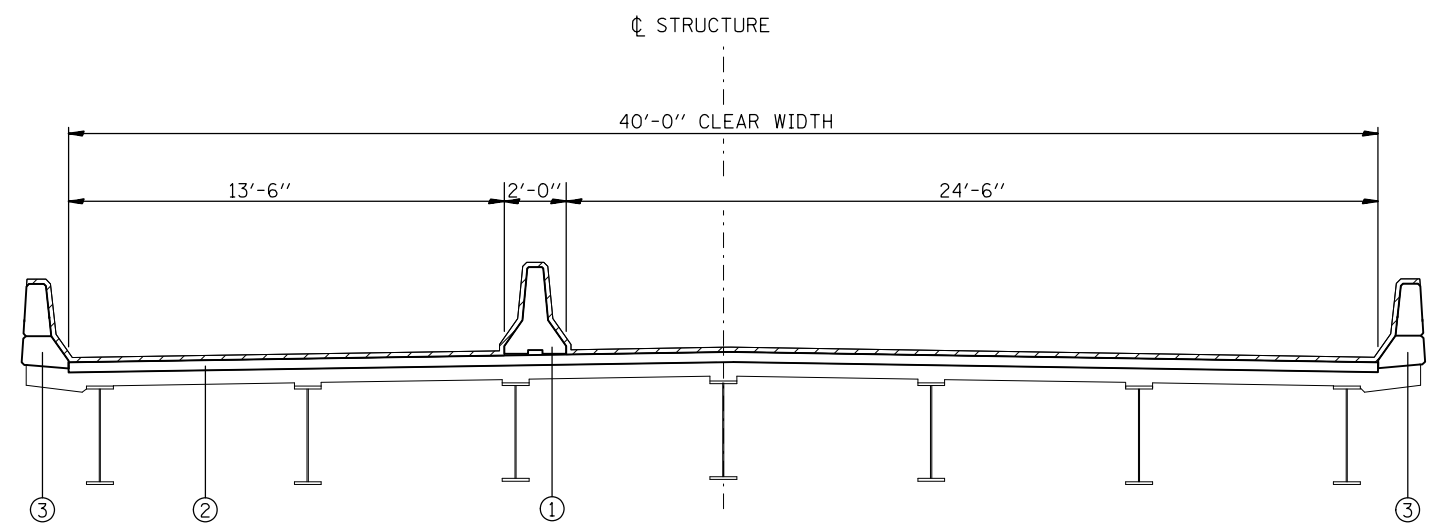

TYPICAL SECTION  
(LOOKING EAST)

BILL OF MATERIALS

ITEM	UNIT	TOTAL
CONCRETE SEALER	SQ FT.	14,641

LEGEND

- ① EXISTING CONCRETE SAFETY BARRIER, SPECIAL
- ② EXISTING PCC BRIDGE DECK
- ③ EXISTING CONCRETE PARAPET
- \* EXISTING ALUMINUM PARAPET SPAN 8-10

- AREA TO BE SEALED

MODEL: Default  
 FILE: \\nas01.cas.llnwd.net\llnwd\proj\7669\CADD\Drawings\DOT Documents\1807669\CADD\Drawings\DOT Documents\1807669-ah-ty-2\plan.dgn

USER NAME = challeske	DESIGNED -	REVISED -
PLOT SCALE = 100.0000' / in.	DRAWN -	REVISED -
PLOT DATE = 3/26/2018	CHECKED -	REVISED -
	DATE -	REVISED -

STATE OF ILLINOIS  
DEPARTMENT OF TRANSPORTATION

TYPICAL SECTION AND PLAN VIEW

SCALE: SHEET 1 OF 9 SHEETS STA. TO STA.

F.A.P. RTE.	SECTION	COUNTY	TOTAL SHEETS	SHEET NO.
799	1-BR, DS-2	ST CLAIR	16	4
ILLINOIS FED. AID PROJECT			CONTRACT NO. 76J69	

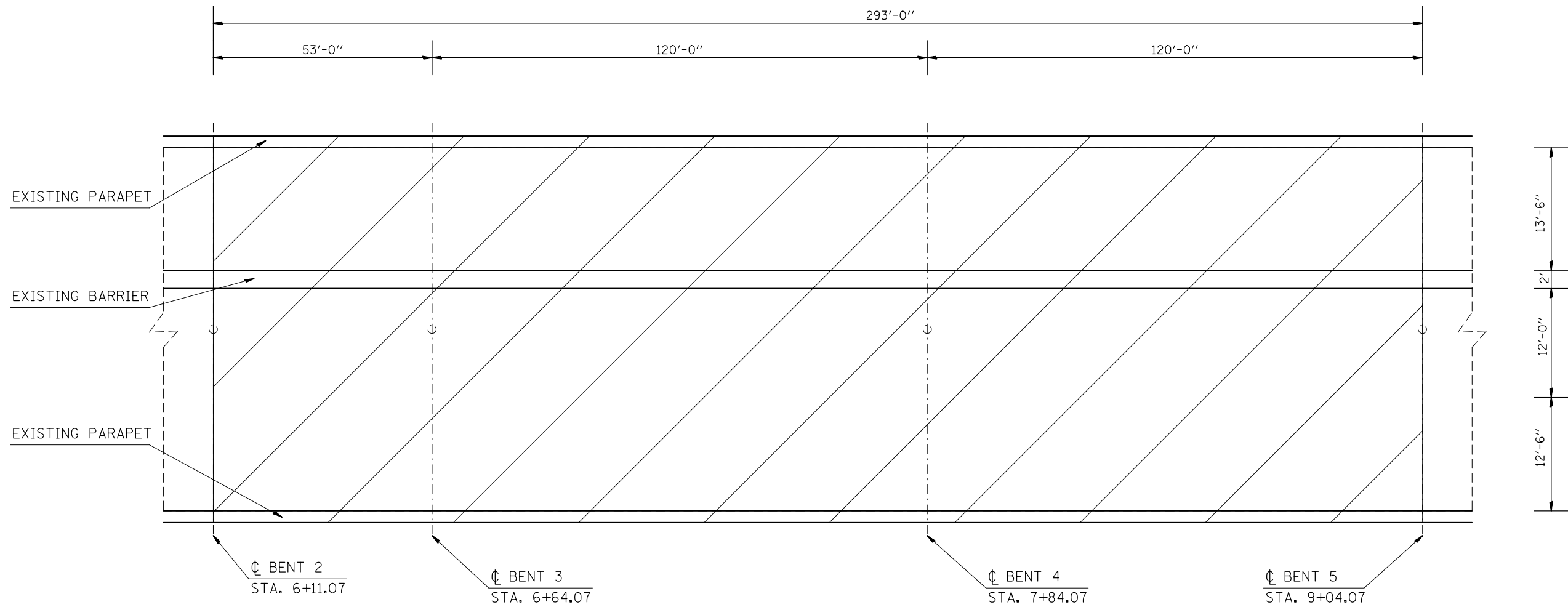

PLAN  
SPANS 3 THROUGH 5

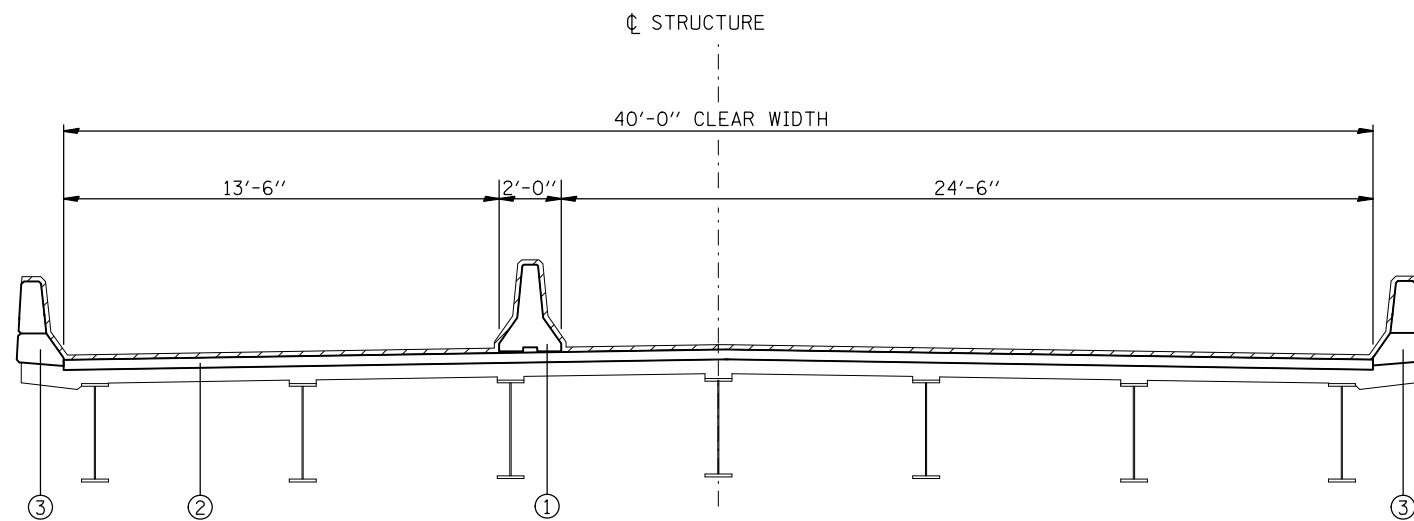

TYPICAL SECTION  
(LOOKING EAST)

BILL OF MATERIALS

ITEM	UNIT	TOTAL
CONCRETE SEALER	SQ. FT.	15,159

LEGEND

- ① EXISTING CONCRETE SAFETY BARRIER, SPECIAL
- ② EXISTING PCC BRIDGE DECK
- ③ EXISTING CONCRETE PARAPET
- \* EXISTING ALUMINUM PARAPET SPAN 8-10

- AREA TO BE SEALED

MODEL: Default  
 FILE: \\mspc-pw\ulb\BEBID\NTEC\Illinois.gov\FWIDOT\Documents\DOT\_Offices\Director\Projects\087669\CADD\Drawings\087669-8th-by\picad.dgn

USER NAME = challandeske	DESIGNED -	REVISED -
PLOT SCALE = 100.0000' / in.	DRAWN -	REVISED -
PLOT DATE = 3/26/2018	CHECKED -	REVISED -
	DATE -	REVISED -

STATE OF ILLINOIS  
DEPARTMENT OF TRANSPORTATION

TYPICAL SECTION AND PLAN VIEW

SCALE: SHEET 2 OF 9 SHEETS STA. TO STA.

F.A.P. RTE.	SECTION	COUNTY	TOTAL SHEETS	SHEET NO.
799	1-BR, DS-2	ST CLAIR	16	5
CONTRACT NO. 76J69			ILLINOIS FED. AID PROJECT	

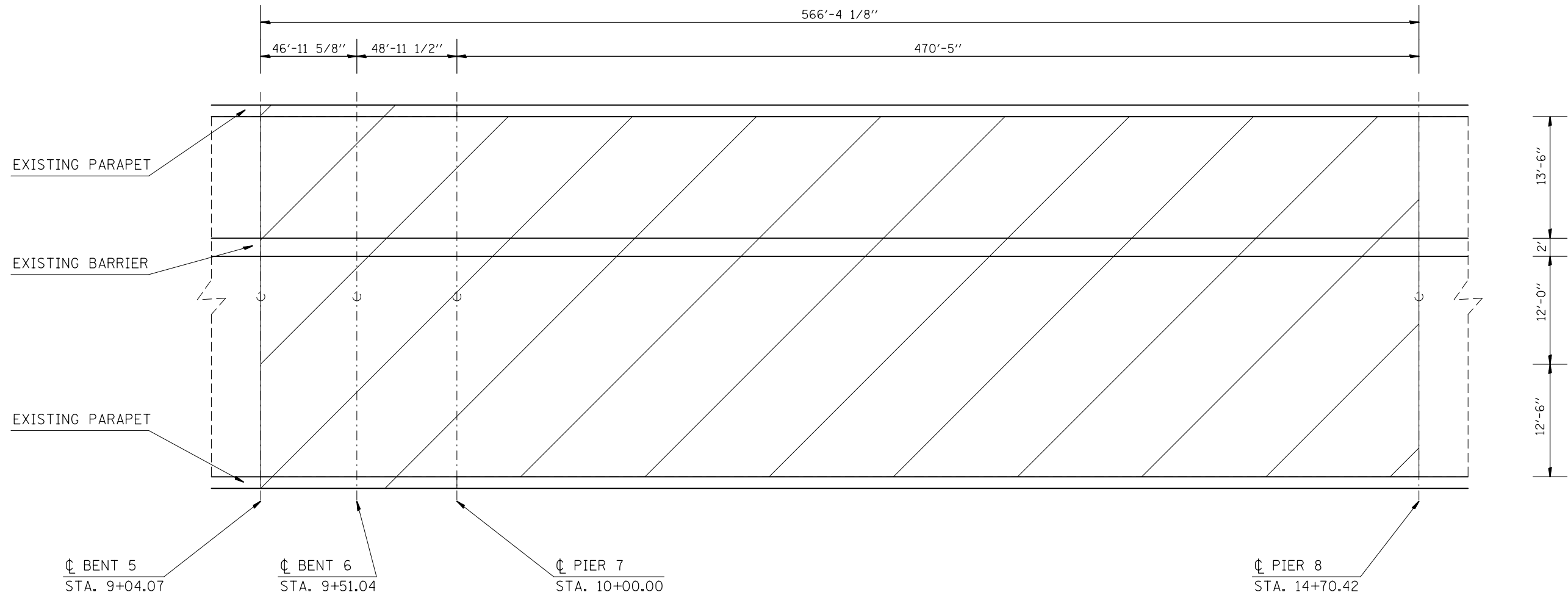

PLAN  
SPANS 6 THROUGH 8

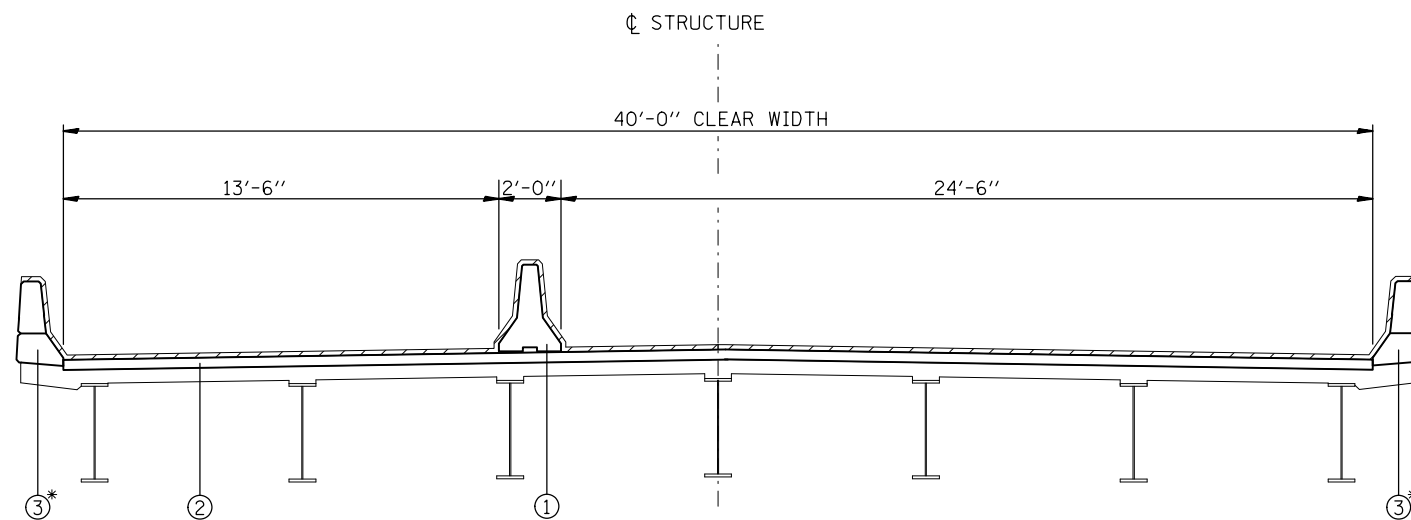

TYPICAL SECTION  
(LOOKING EAST)

BILL OF MATERIALS

ITEM	UNIT	TOTAL
CONCRETE SEALER	SQ FT.	25,846

LEGEND

- ① EXISTING CONCRETE SAFETY BARRIER, SPECIAL
- ② EXISTING PCC BRIDGE DECK
- ③ EXISTING CONCRETE PARAPET
- \* EXISTING ALUMINUM PARAPET SPAN 8-10

- AREA TO BE SEALED

MODEL: Default  
 FILE: \\mspc-pw\ulb\BID\NTEC\Illinois\gov\PIW\DOT\Documents\1\DOT\_Offices\Director\B\Projects\0876\99\CADD\Bans\CAD\sheet\0876\99-ah-ty-2\pic.dgn

USER NAME = challandeske	DESIGNED -	REVISED -
PLOT SCALE = 100.0000' / in.	DRAWN -	REVISED -
PLOT DATE = 3/26/2018	CHECKED -	REVISED -
	DATE -	REVISED -

STATE OF ILLINOIS  
DEPARTMENT OF TRANSPORTATION

TYPICAL SECTION AND PLAN VIEW

SCALE: SHEET 3 OF 9 SHEETS STA. TO STA.

F.A.P. RTE.	SECTION	COUNTY	TOTAL SHEETS	SHEET NO.
799	1-BR, DS-2	ST CLAIR	16	6
CONTRACT NO. 76J69			ILLINOIS FED. AID PROJECT	

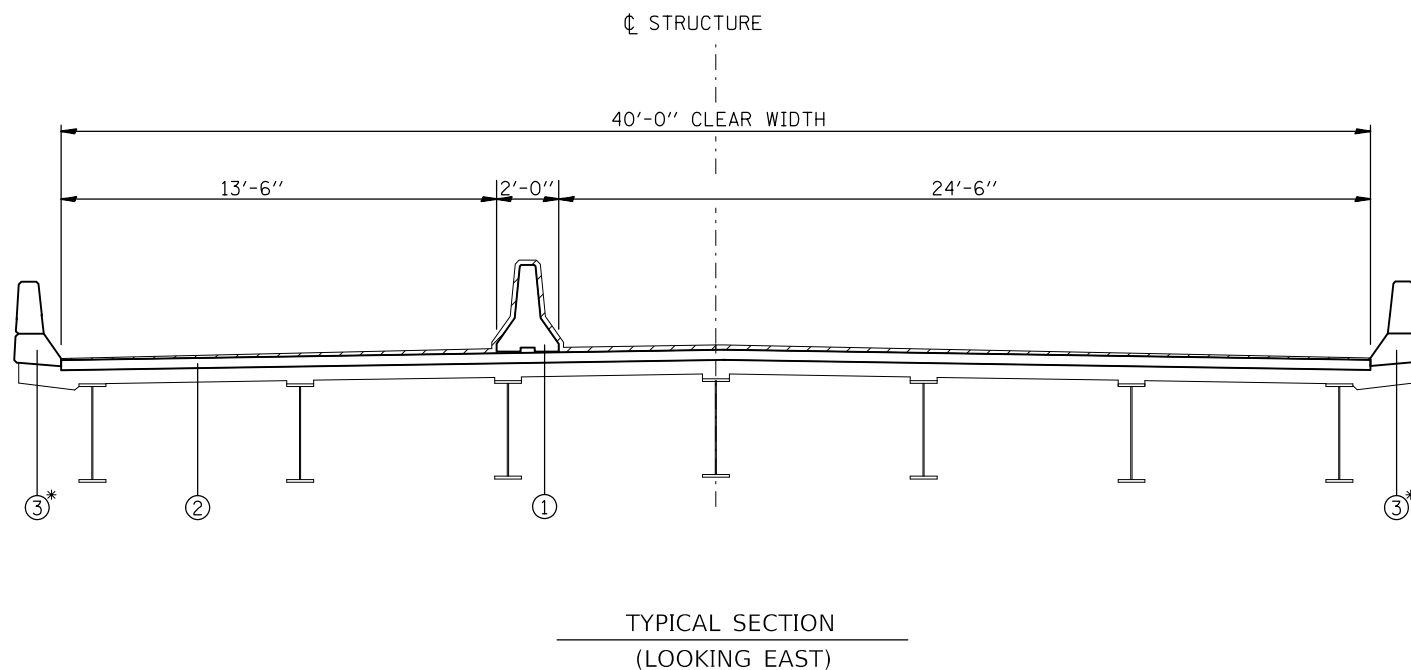
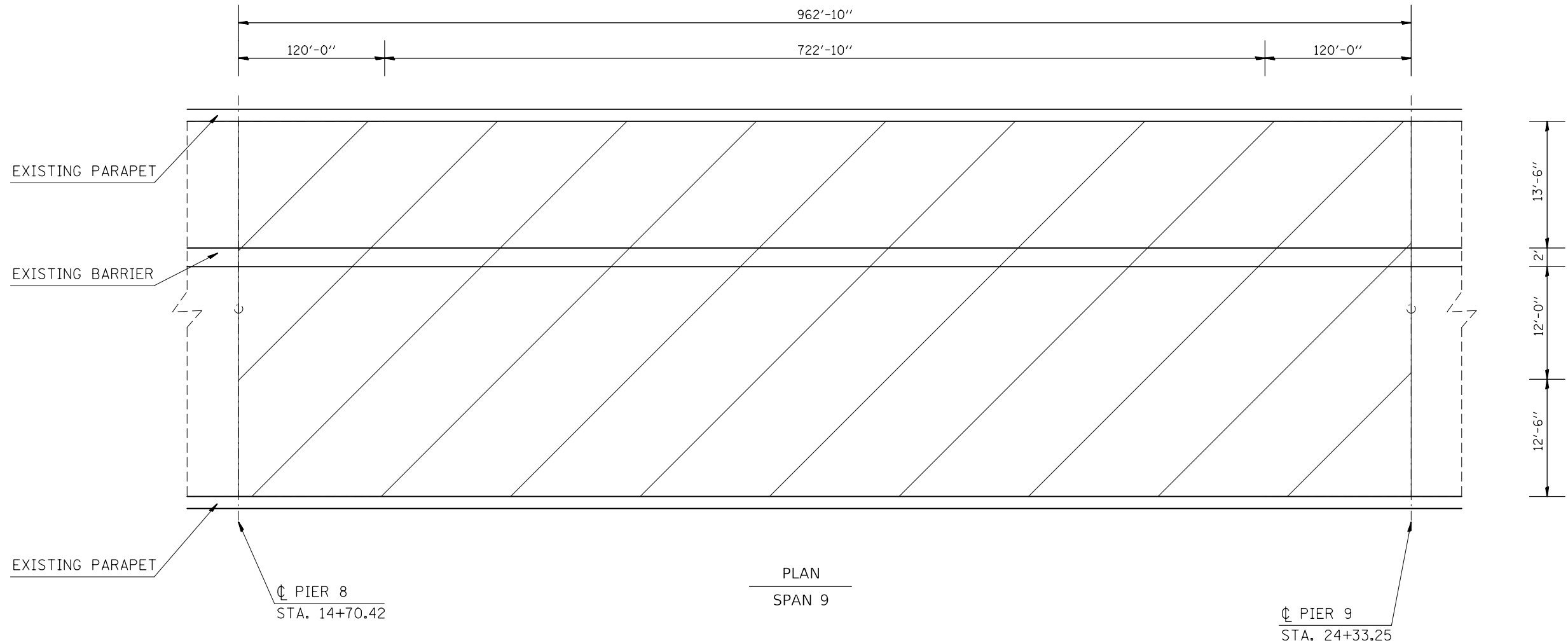

TYPICAL SECTION  
(LOOKING EAST)

- AREA TO BE SEALED

**BILL OF MATERIALS**

ITEM	UNIT	TOTAL
CONCRETE SEALER	SQ. FT.	42,742

**LEGEND**

- ① EXISTING CONCRETE SAFETY BARRIER, SPECIAL
- ② EXISTING PCC BRIDGE DECK
- ③ EXISTING CONCRETE PARAPET
- \* EXISTING ALUMINUM PARAPET SPAN 8-10

MODEL: Default  
 FILE NAME: P:\ILLINOIS\BID\DOT\Illinois\gov\PIV\DOT\Documents\DOT - Office\Director\B\Projects\087669\CADD\Bans\CDS\sheet\087669-8ht-ypic.dgn

USER NAME = challeske	DESIGNED -	REVISED -
	DRAWN -	REVISED -
PLOT SCALE = 100.0000' / in.	CHECKED -	REVISED -
PLOT DATE = 3/26/2018	DATE -	REVISED -

**STATE OF ILLINOIS  
DEPARTMENT OF TRANSPORTATION**

**TYPICAL SECTION AND PLAN VIEW**

SCALE: SHEET 4 OF 9 SHEETS STA. TO STA.

F.A.P. RTE.	SECTION	COUNTY	TOTAL SHEETS	SHEET NO.
799	1-BR, DS-2	ST CLAIR	16	7
CONTRACT NO. 76J69			ILLINOIS FED. AID PROJECT	





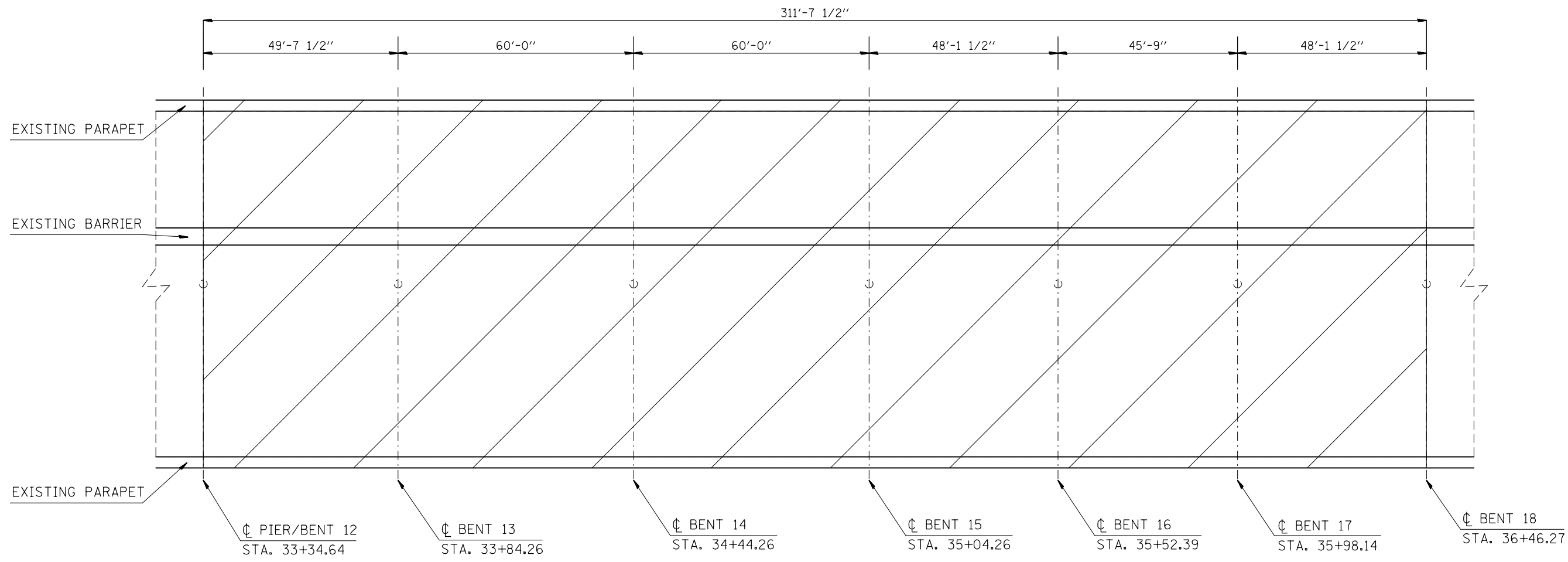

PLAN  
SPANS 13 THROUGH 18

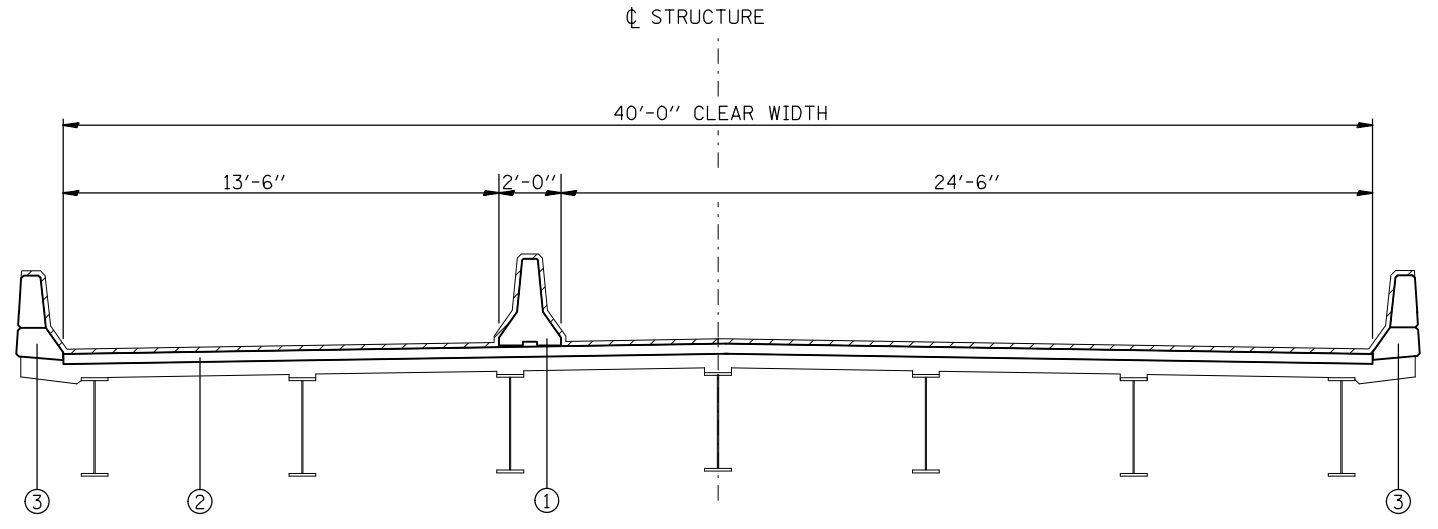

TYPICAL SECTION  
(LOOKING EAST)

BILL OF MATERIALS

ITEM	UNIT	TOTAL
CONCRETE SEALER	SQ FT.	16,123

LEGEND

- ① EXISTING CONCRETE SAFETY BARRIER, SPECIAL
- ② EXISTING PCC BRIDGE DECK
- ③ EXISTING CONCRETE PARAPET
- \* EXISTING ALUMINUM PARAPET SPAN 8-10

- AREA TO BE SEALED

MODEL: Default  
 FILE NAME: P:\ILLINOIS\BID\NTEC\Illinois.gov\FWIDOT\Documents\DOT\_Offices\Director\_8\Projects\0876\89\CADD\Bans\CDSheets\0876\89-ah-by-pk1.dgn

USER NAME = challeske	DESIGNED -	REVISED -
PLOT SCALE = 100.0000' / in.	DRAWN -	REVISED -
PLOT DATE = 3/26/2018	CHECKED -	REVISED -
	DATE -	REVISED -

STATE OF ILLINOIS  
DEPARTMENT OF TRANSPORTATION

TYPICAL SECTION AND PLAN VIEW

SCALE: SHEET 6 OF 9 SHEETS STA. TO STA.

F.A.P. RTE.	SECTION	COUNTY	TOTAL SHEETS	SHEET NO.
799	1-BR, DS-2	ST CLAIR	16	9
CONTRACT NO. 76J69			ILLINOIS FED. AID PROJECT	

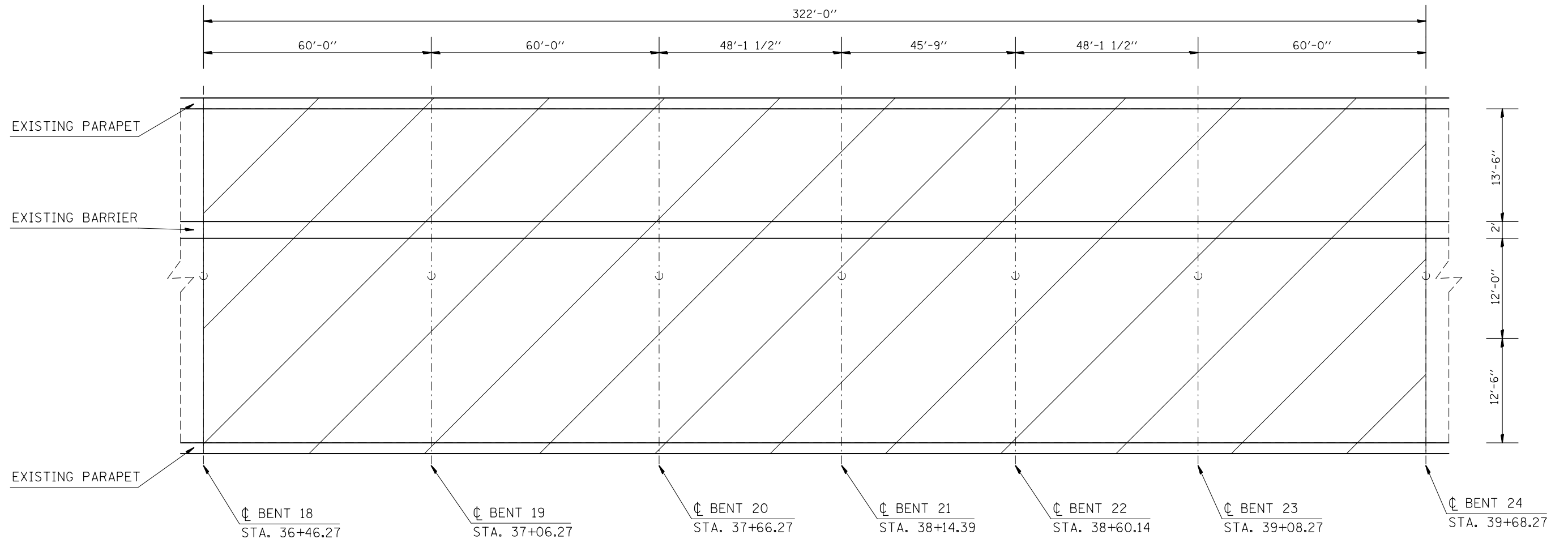

PLAN  
SPANS 19 THROUGH 24

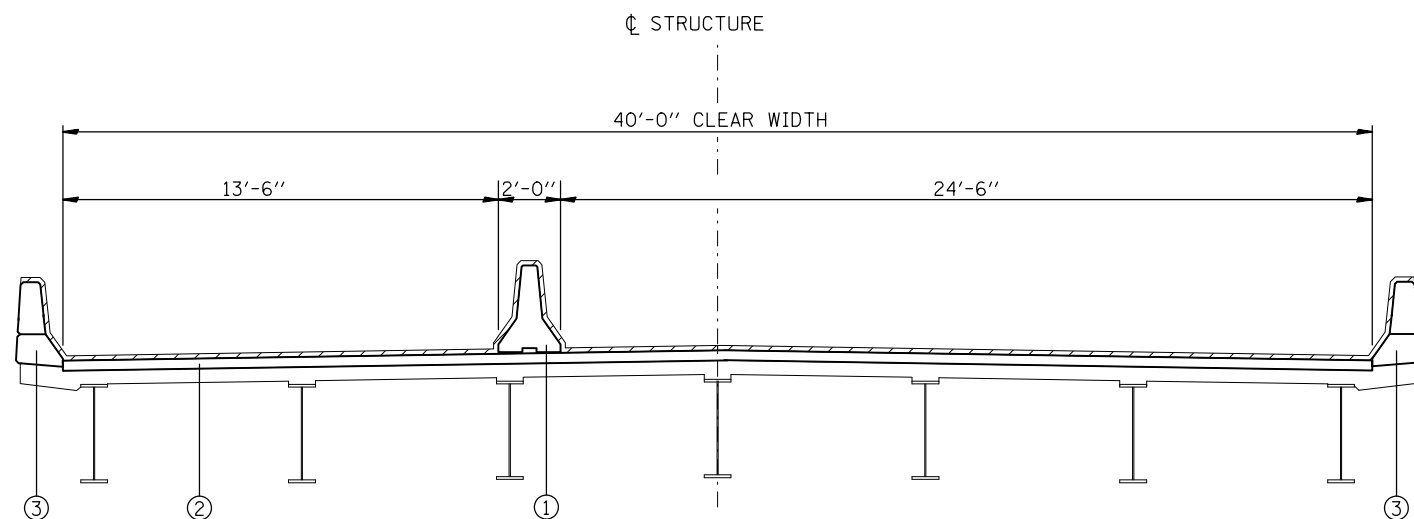

TYPICAL SECTION  
(LOOKING EAST)

BILL OF MATERIALS

ITEM	UNIT	TOTAL
CONCRETE SEALER	SQ. FT.	16,659

LEGEND

- ① EXISTING CONCRETE SAFETY BARRIER, SPECIAL
- ② EXISTING PCC BRIDGE DECK
- ③ EXISTING CONCRETE PARAPET
- \* EXISTING ALUMINUM PARAPET SPAN 8-10

- AREA TO BE SEALED

MODEL: Default  
 FILE: \\nas0101\B&E\BID\NTEC\Illinois\gov\FWID\DOT\Documents\1\DOT - Offices\Director\B\Projects\087669\CADD\B&E\CAD\Sheet\087669-ah-ty-2\plc.dgn

USER NAME = challeske	DESIGNED -	REVISED -
	DRAWN -	REVISED -
PLOT SCALE = 100.0000' / in.	CHECKED -	REVISED -
PLOT DATE = 3/26/2018	DATE -	REVISED -

**STATE OF ILLINOIS  
DEPARTMENT OF TRANSPORTATION**

TYPICAL SECTION AND PLAN VIEW

SCALE: SHEET 7 OF 9 SHEETS STA. TO STA.

F.A.P. RTE.	SECTION	COUNTY	TOTAL SHEETS	SHEET NO.
799	1-BR, DS-2	ST CLAIR	16	10
CONTRACT NO. 76J69			ILLINOIS FED. AID PROJECT	

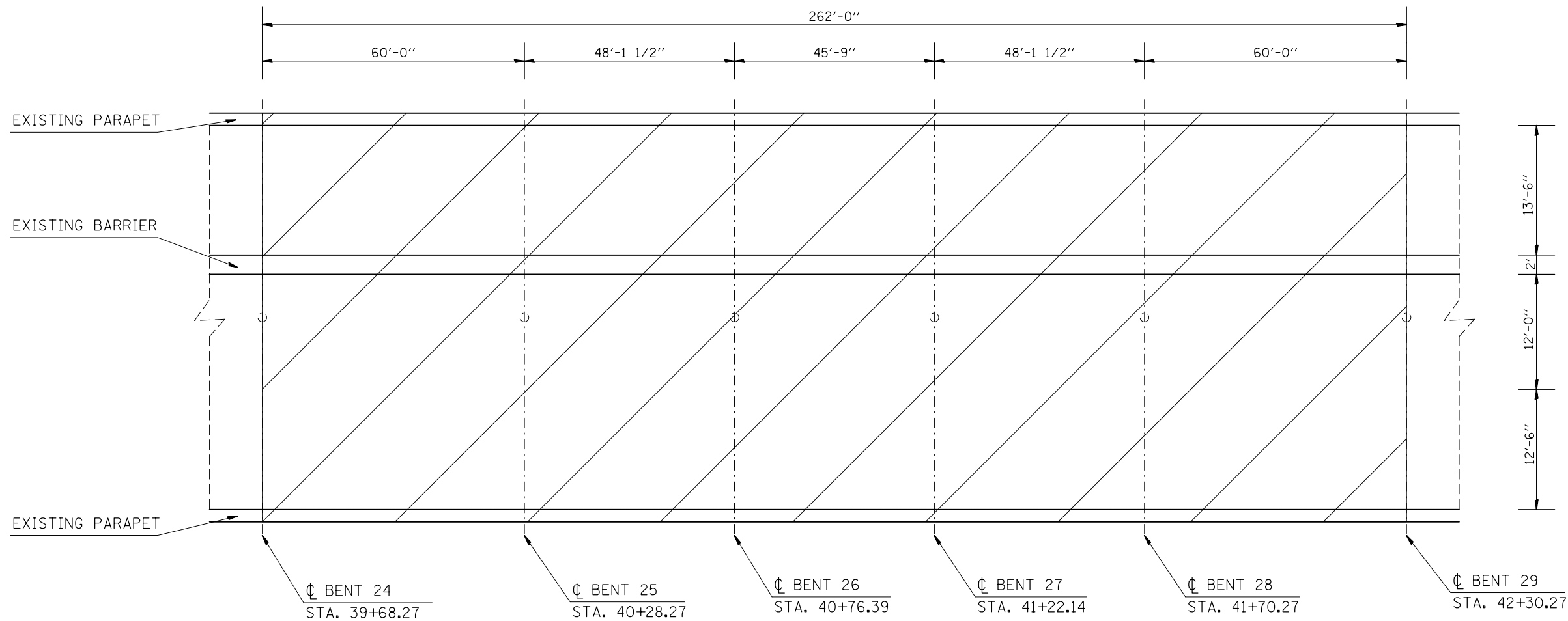

PLAN  
SPANS 25 THROUGH 29

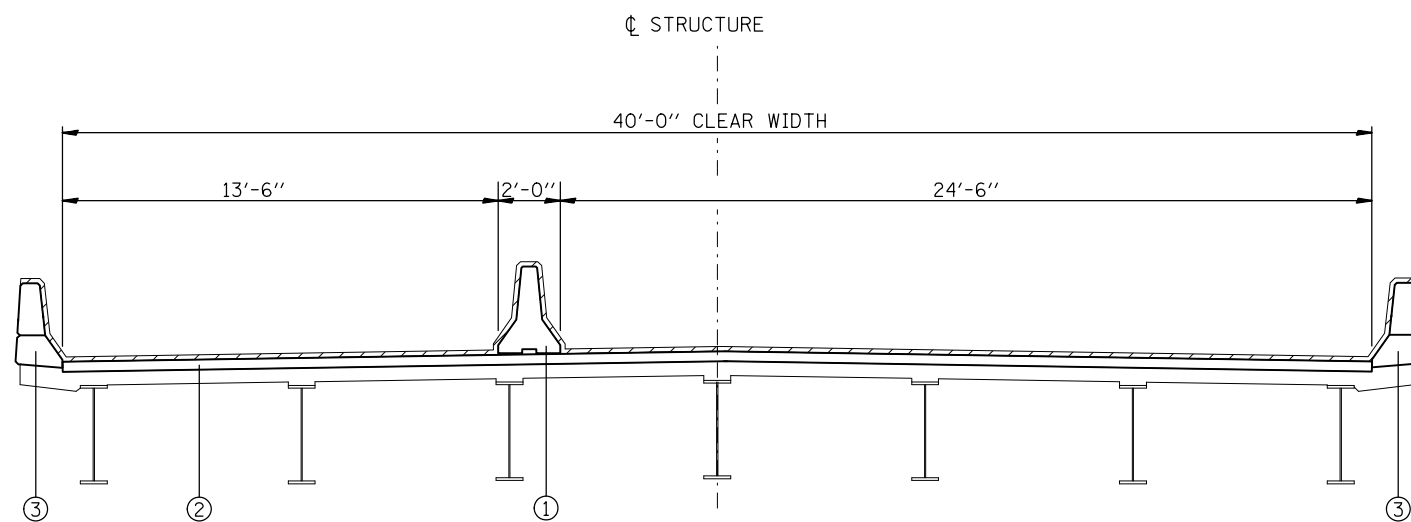

TYPICAL SECTION  
(LOOKING EAST)

BILL OF MATERIALS

ITEM	UNIT	TOTAL
CONCRETE SEALER	SQ FT.	13,555

LEGEND

- ① EXISTING CONCRETE SAFETY BARRIER, SPECIAL
- ② EXISTING PCC BRIDGE DECK
- ③ EXISTING CONCRETE PARAPET
- \* EXISTING ALUMINUM PARAPET SPAN 8-10

- AREA TO BE SEALED

MODEL: Default  
 FILE NAME: P:\ILLINOIS\BID\NTEC\Illinois.gov\PI\DOT\Documents\DOT\_Offices\Director\Projects\087669\CADD\Drawings\087669-8th-ly\pic1.dgn

USER NAME = challeske	DESIGNED -	REVISED -
	DRAWN -	REVISED -
PLOT SCALE = 100.0000' / in.	CHECKED -	REVISED -
PLOT DATE = 3/26/2018	DATE -	REVISED -

STATE OF ILLINOIS  
DEPARTMENT OF TRANSPORTATION

TYPICAL SECTION AND PLAN VIEW

SCALE: SHEET 8 OF 9 SHEETS STA. TO STA.

F.A.P. RTE.	SECTION	COUNTY	TOTAL SHEETS	SHEET NO.
799	1-BR, DS-2	ST CLAIR	16	11
CONTRACT NO. 76J69				
ILLINOIS FED. AID PROJECT				

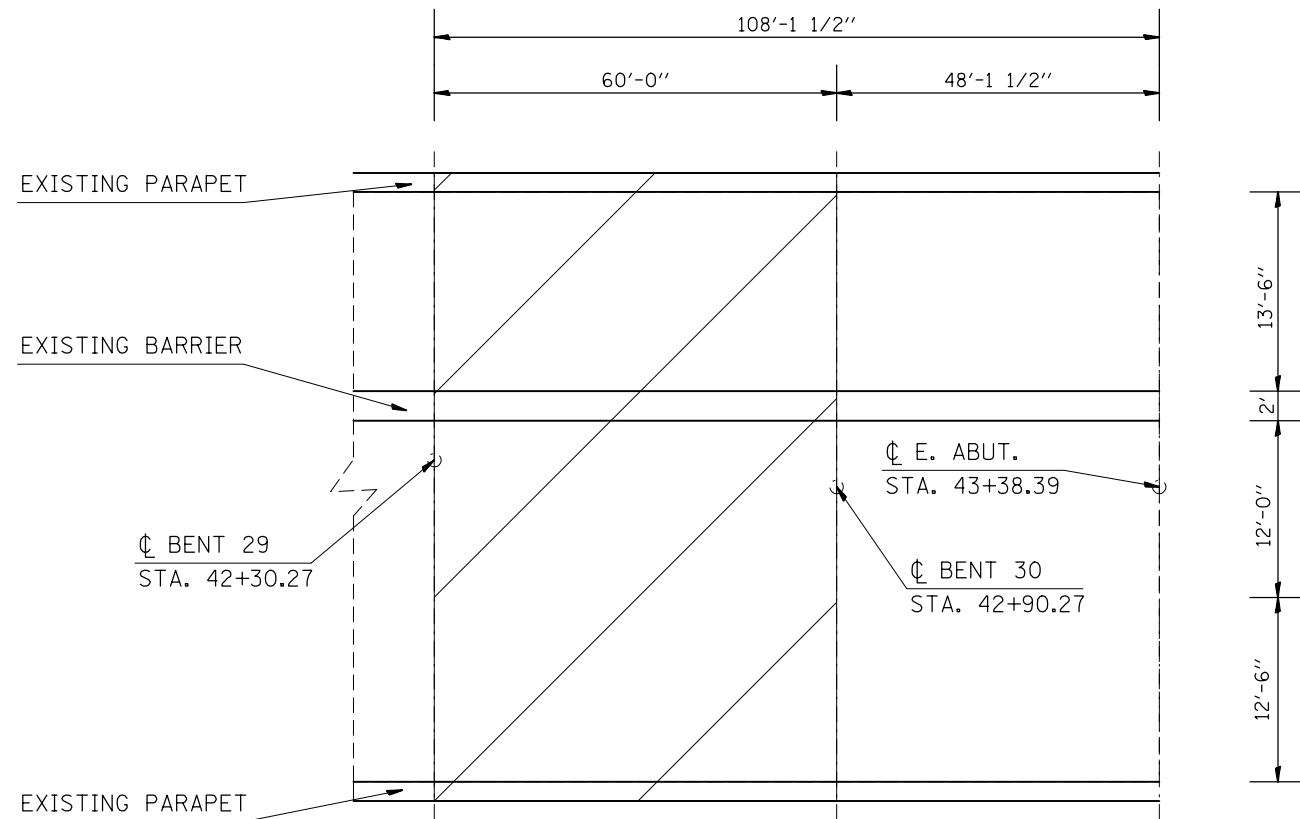

PLAN  
SPAN 30 AND EAST ABUTMENT

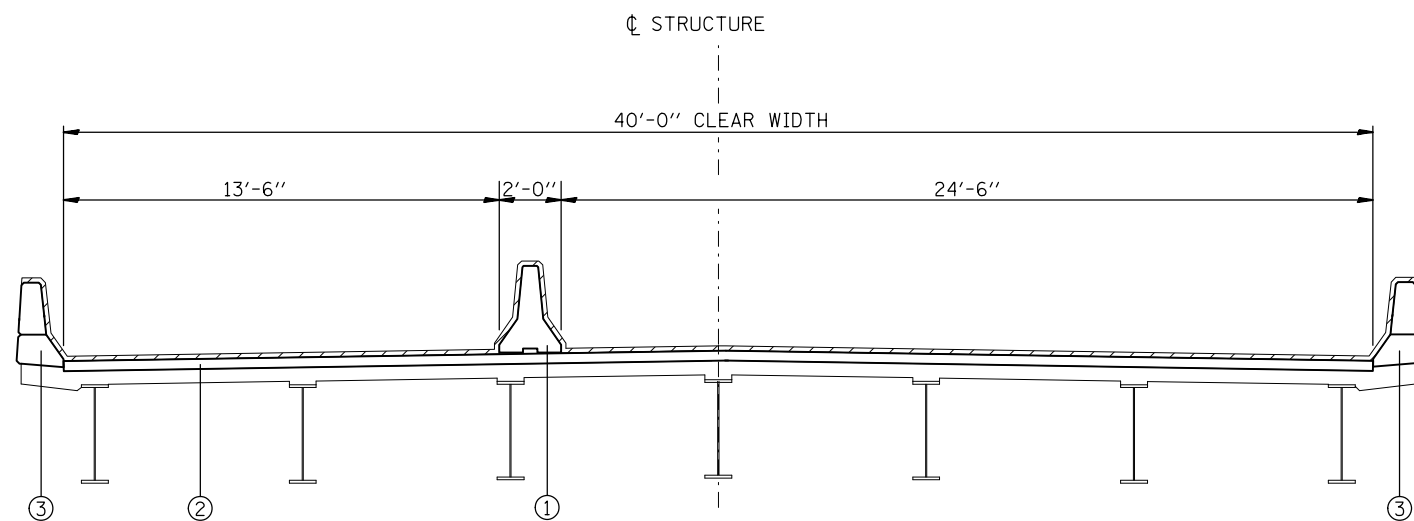

TYPICAL SECTION  
(LOOKING EAST)

- AREA TO BE SEALED

BILL OF MATERIALS

ITEM	UNIT	TOTAL
CONCRETE SEALER	SQ FT.	5,594

LEGEND

- ① EXISTING CONCRETE SAFETY BARRIER, SPECIAL
- ② EXISTING PCC BRIDGE DECK
- ③ EXISTING CONCRETE PARAPET
- \* EXISTING ALUMINUM PARAPET SPAN 8-10

MODEL: Default  
 FILE NAME: P:\11111111\BID\NTEC\Illinois\gov\p\WIDOT\Documents\DOT - Offices\Director\B\Projects\087669\CADD\Draws\CAD\Sheet\087669-ah-ty-2\plc.dgn

USER NAME = challandeske	DESIGNED -	REVISED -
PLOT SCALE = 100.0000' / in.	DRAWN -	REVISED -
PLOT DATE = 3/26/2018	CHECKED -	REVISED -
	DATE -	REVISED -

STATE OF ILLINOIS  
DEPARTMENT OF TRANSPORTATION

TYPICAL SECTION AND PLAN VIEW

SCALE: SHEET 9 OF 9 SHEETS STA. TO STA.

F.A.P. RTE.	SECTION	COUNTY	TOTAL SHEETS	SHEET NO.
799	1-BR, DS-2	ST CLAIR	16	12
			CONTRACT NO. 76J69	
		ILLINOIS	FED. AID PROJECT	

MODEL: Default  
 FILE NAME: P:\1108\BID\NTEC\Illinois\gov\PIW\DOT\Documents\DOT Office\Director\Projects\087669\CADD\Bent\087669-bent-tyrlic.dgn

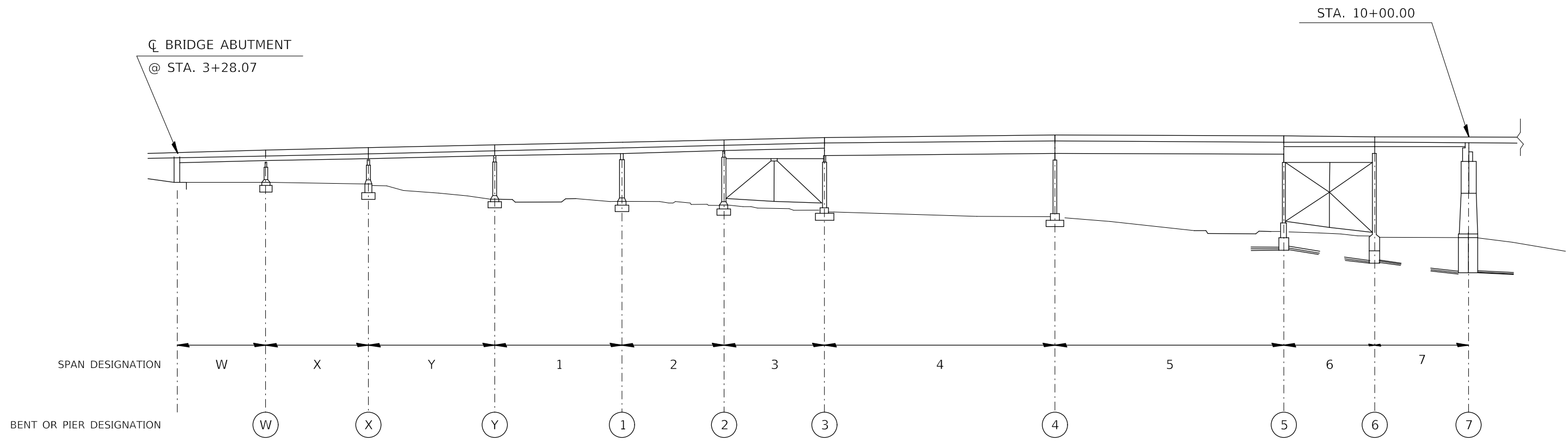

ELEVATION  
 SPANS W TO 7

USER NAME = challeske	DESIGNED -	REVISED -
	DRAWN -	REVISED -
PLOT SCALE = 100,0000' / in.	CHECKED -	REVISED -
PLOT DATE = 3/22/2018	DATE -	REVISED -

**STATE OF ILLINOIS**  
**DEPARTMENT OF TRANSPORTATION**

<b>ELEVATION</b>			
SCALE:	SHEET 1	OF 4 SHEETS	STA. TO STA.

F.A.P. RTE.	SECTION	COUNTY	TOTAL SHEETS	SHEET NO.
799	1-BR, DS-2	ST CLAIR	16	13
CONTRACT NO. 76J69				
ILLINOIS		FED. AID PROJECT		

MODEL: Default  
 FILE NAME: p:\u0008\BID\NTEC\Illinois\gov\PIV\DOT\Documents\1\DOT\_Offices\Director\B\Projects\0876\69\CADD\Drawn\CAD\sheet\0876\69-ah-ty\pic\1.dgn

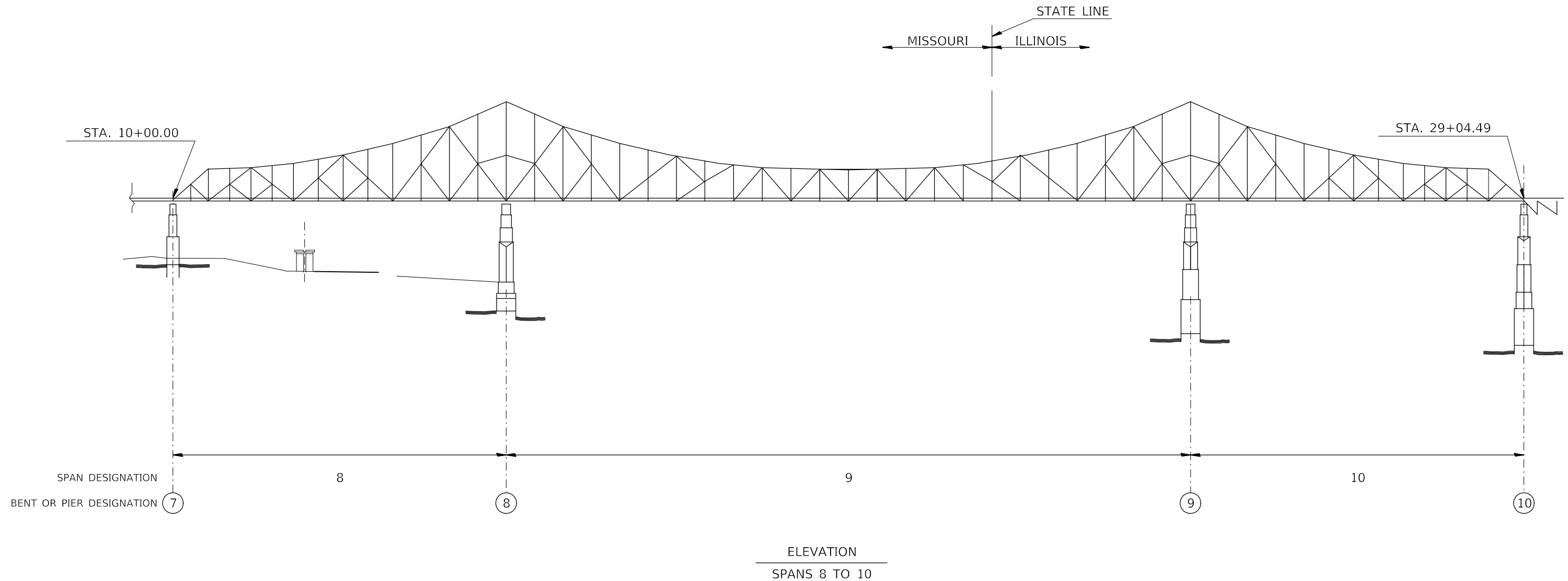

**STATE OF ILLINOIS  
 DEPARTMENT OF TRANSPORTATION**

**ELEVATION**

SCALE: SHEET 2 OF 4 SHEETS STA. TO STA.

USER NAME = challandeske	DESIGNED -	REVISED -
	DRAWN -	REVISED -
PLOT SCALE = 100.0000' / in.	CHECKED -	REVISED -
PLOT DATE = 3/22/2018	DATE -	REVISED -

F.A.P. RTE.	SECTION	COUNTY	TOTAL SHEETS	SHEET NO.
799	1-BR, DS-2	ST CLAIR	16	14
CONTRACT NO. 76J69			ILLINOIS FED. AID PROJECT	

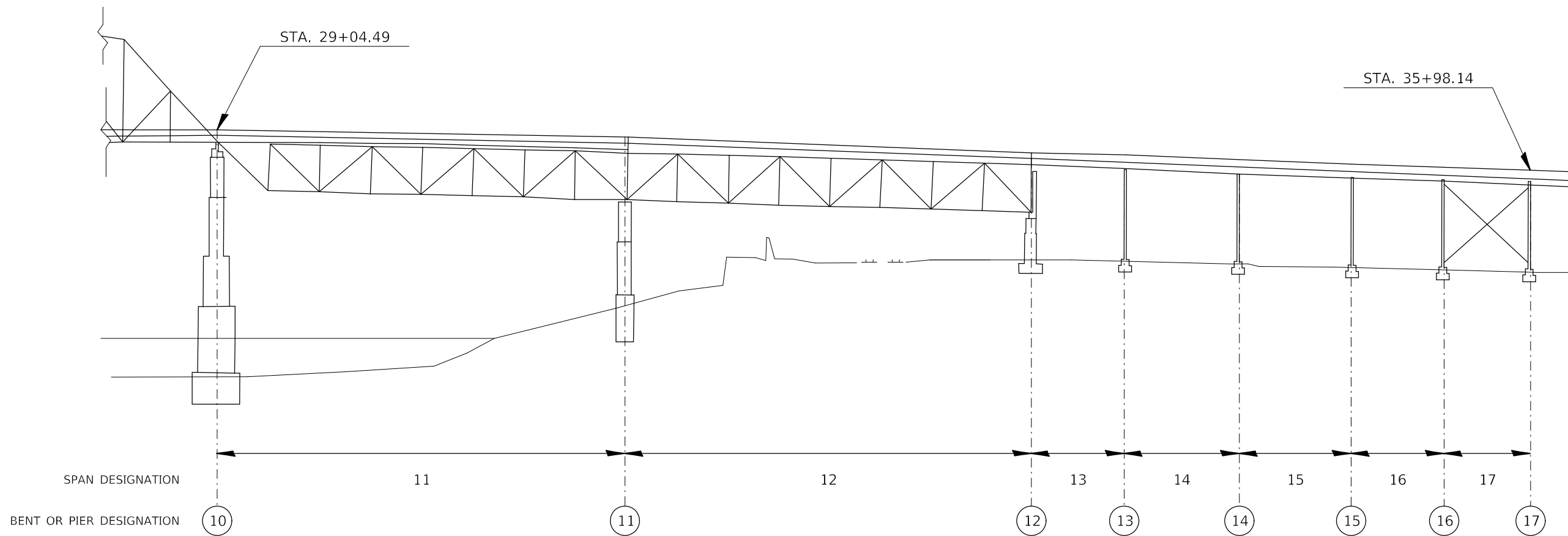

ELEVATION  
SPANS 11 TO 17

MODEL: Default  
 FILE NAME: p:\u0008\EBID\NTEC\Illinois.gov\PIV\DOT\Documents\1\DOT\_Offices\Director\Projects\0876\69\CADD\Drawn\CAD\sheet\0876\69-sh17-17.dwg

USER NAME = challandeske	DESIGNED -	REVISED -
	DRAWN -	REVISED -
PLOT SCALE = 100,0000 ' / in.	CHECKED -	REVISED -
PLOT DATE = 3/22/2018	DATE -	REVISED -

**STATE OF ILLINOIS  
DEPARTMENT OF TRANSPORTATION**

ELEVATION			
SCALE:	SHEET 3	OF 4 SHEETS	STA. TO STA.

F.A.P. RTE.	SECTION	COUNTY	TOTAL SHEETS	SHEET NO.
799	1-BR, DS-2	ST CLAIR	16	15
CONTRACT NO. 76J69			ILLINOIS FED. AID PROJECT	

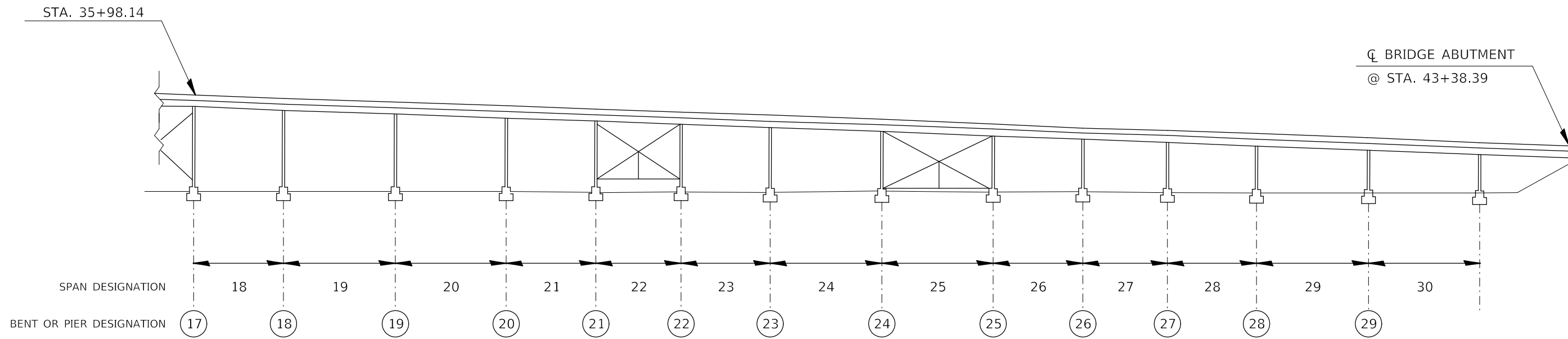

MODEL: Default  
 FILE NAME: p:\u0008\EBID\NTEC\Illinois.gov\PIV\DOT\Documents\DOT\_Offices\Director\Projects\087669\CADD\Drawn\CAD\sheet1087669-eh-by-pkcal.dgn

USER NAME = challandeske	DESIGNED -	REVISED -
	DRAWN -	REVISED -
PLOT SCALE = 100.0000 ' / in.	CHECKED -	REVISED -
PLOT DATE = 3/22/2018	DATE -	REVISED -

**STATE OF ILLINOIS  
DEPARTMENT OF TRANSPORTATION**

<b>ELEVATION</b>			
SCALE:	SHEET 4	OF 4	SHEETS
	STA.		TO STA.

F.A.P. RTE.	SECTION	COUNTY	TOTAL SHEETS	SHEET NO.
799	1-BR, DS-2	ST CLAIR	16	16
			CONTRACT NO. 76J69	
		ILLINOIS	FED. AID PROJECT	