

Summary of Quantities

#	Item	Section	Quantity	Unit	Rates/Remarks
1	Earth Excavation	202	343	C.Y.	
2	Riprap Excavation	202	322	C.Y.	
3	Seeding	250	4.5	ACRE	
4	Nitrogen Fertilizer Nutrient	250	450	POUND	100 LB / ACRE
5	Phosphorus Fertilizer Nutrient	250	675	POUND	150 LB / ACRE
6	Potassium Fertilizer Nutrient	250	1,575	POUND	350 LB / ACRE
7	Agricultural Ground Limestone	250	22.5	TON	5 TON / ACRE
8	Mulch, Method 2, Procedure 2	IDOT 251	4.5	ACRE	2 TON / ACRE
9	Riprap Ditch Checks, A-4	280	2	EACH	
10	Pipe Culvert, Polyethylene, 12" Diameter	280	140	FOOT	
11	Stone Dumped Riprap, A-4	IDOT 281	149.0	TON	
12	Grout for use with Riprap	425	190.2	C.Y.	
13	Concrete Structures	503	20.1	C.Y.	
14	Reinforcement Bars, Epoxy Coated	508	1,521	POUND	
15	Precast Concrete Box Culverts	IDOT 540	6	FOOT	REPLACE EXISTING SECTION
16	Adjusting Water Service Lines	IDOT 563	100	FOOT	
17	Cofferdams	616	1	EACH	
18	Mobilization (Max. 6% of Bid)	671	1	L.S.	

GENERAL NOTES

Unless otherwise noted on the plans, all disturbed areas within the construction limits will be amended with agricultural ground limestone, fertilizer nutrients, seeded and mulched at the required rates specified in the plans.

The contractor is responsible for visiting the site and familiarizing himself with the existing conditions and the proposed reclamation work prior to submitting a bid.

The contractor shall provide and pay for all field engineering services to execute the project as specified in the Field Engineering section of the Special Provisions.

The contractor is responsible for locating and protecting all existing utility lines pertaining to the work.

Unless noted on the plans, all onsite access roads may be used for construction and must be maintained during construction. Access roads to the site as designated on the plans are to be maintained to the satisfaction of the engineer.

The construction limits will be staked by the contractor prior to construction. The contractor is responsible for the repair and or restitution at his own expense for all damages done to any area outside the construction limits.

Application rates specified in the plans are shown in the Summary of Quantities-Rates/Remarks column.

CONSTRUCTION NOTES

BURIAL/REMOVAL OF MATERIAL-Concrete and masonry debris designated for burial by the engineer shall be buried at least three foot below proposed final grade. Onsite organic debris and trash shall be disposed of in an engineer approved offsite landfill in accordance with Sections 201 and 501 of the Special Provisions.

TREE REMOVAL-Trees removed shall be disposed of onsite per Section 201 of the Special Provisions.

ACID WATER TREATMENT-Acid mine drainage treatment shall be in accordance with Section 614 of the Special Provisions.

EROSION CONTROL-The contractor shall schedule his operations and take such precautions that may be necessary to prevent or minimize erosion. Failure to comply with this requirement shall cause the contractor to be fully responsible for repairing any eroded areas and cleaning up areas or drainage structures that have become silted in or damaged.

AGRICULTURAL GROUND LIMESTONE-Immediately prior to seed bed preparation, fertilizer nutrients and agricultural ground limestone shall be uniformly spread at the rates specified in the plans.

MULCHING-Within 24 hours from the time seeding has been performed, the seeded area shall be given a covering of mulch at the rates specified in the plans. The mulch is to be anchored into the soil in accordance with the requirements for method 2, procedure 2 of Article 251.03 of the Standard Specifications. If Excelsior or Special Excelsior Blanket is to be used, the blanket shall be placed the same day that the areas are seeded.

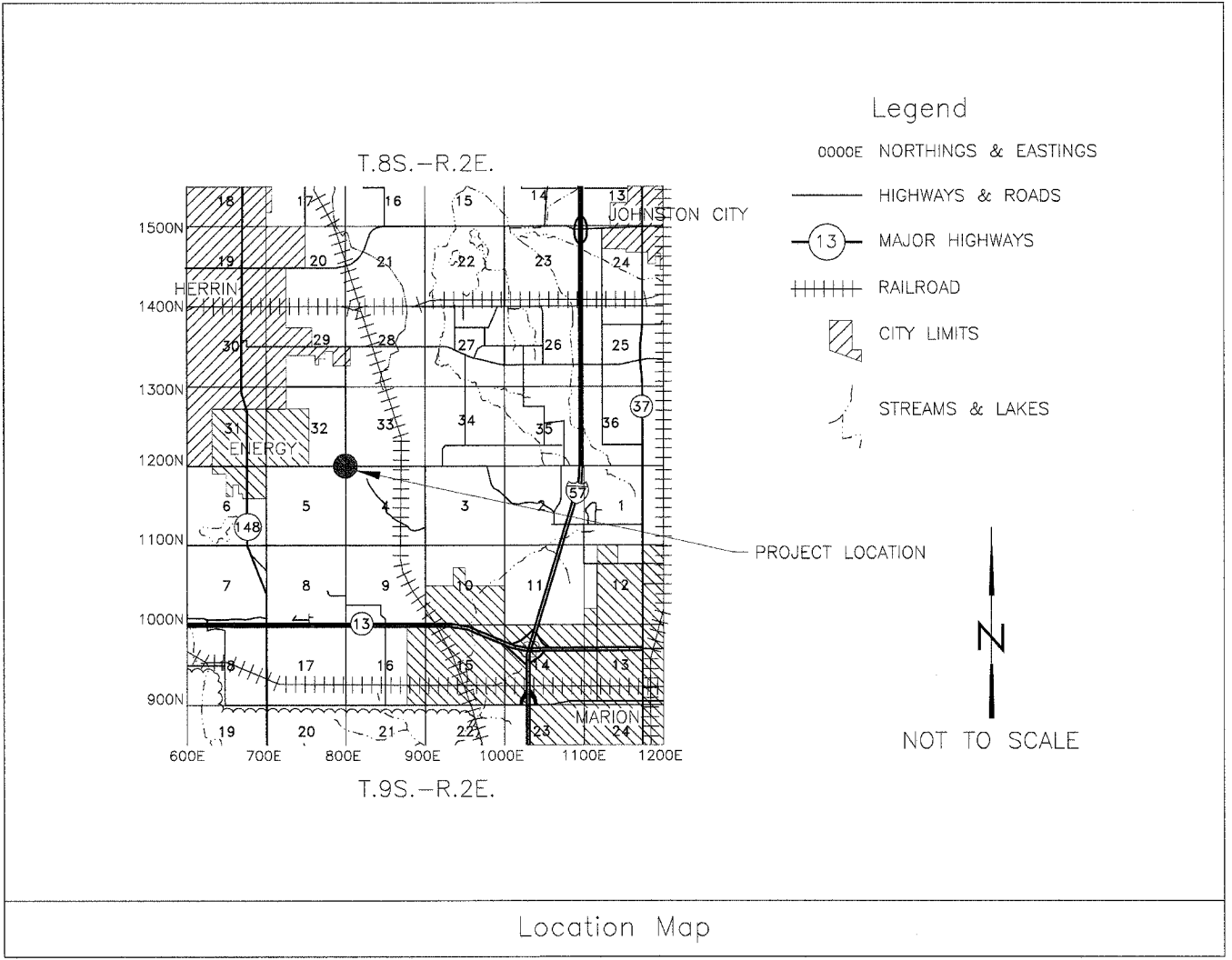

Schedule of Seeding, Fertilizer Nutrients and Mulch	
ITEM (unit)	FALL 2006 APPLICATION AUG 20 - OCT 15
SEEDING (acres)	4.5
NITROGEN FERTILIZER NUTRIENT (pounds)	450
PHOSPHORUS FERTILIZER NUTRIENT (pounds)	675
POTASSIUM FERTILIZER NUTRIENT (pounds)	1575
AGRICULTURAL GROUND LIMESTONE (tons)	22.5
MULCH, METHOD 2, PROCEDURE 2 (acres)	4.5