

**State of Illinois**  
**Department of Natural Resources**  
**Office of Mines and Minerals**  
**Division of Abandoned Mined Lands**

Funded by the  
United States Department of Interior  
Federal Office of Surface Mining

**Galatia C.C. #5 Main Shaft**  
**Reclamation Project**  
**AML-GSIE-0513**  
**Saline County**  
**2LR**

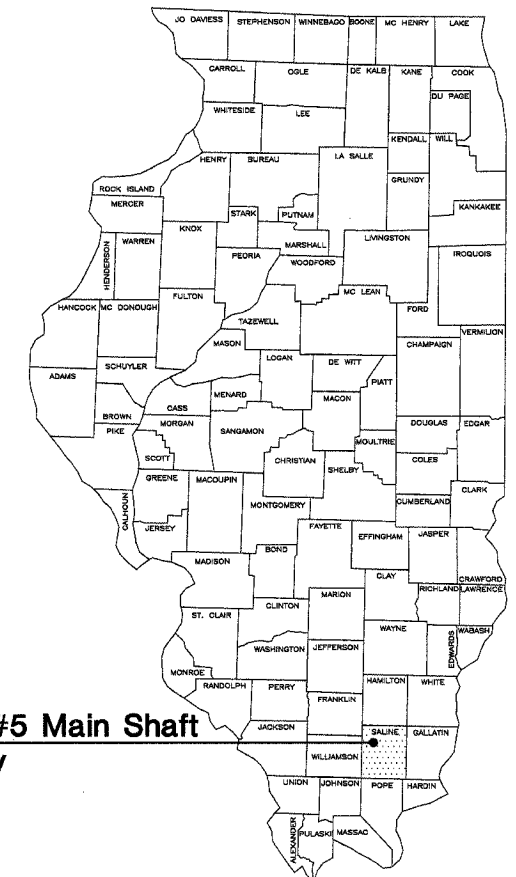

**Galatia C.C. #5 Main Shaft**  
**Saline County**

PRE-BID MEETING

A PRE-BID MEETING IS SCHEDULED FOR THIS PROJECT AT 10:30 A.M. WEDNESDAY, JULY 19, 2006. ALL INTERESTED POTENTIAL BIDDERS ARE TO MEET NEAR THE SITE ACCESS, ALONG NETTY GREEN RD., APPROXIMATELY 1.5 MI. EAST OF HARCO RD. AND 0.5 MI. WEST OF HICKORY ST., NEAR GALATIA, IL.

SCHEDULE OF DRAWINGS:

1. Cover Sheet
2. Summary of Quantities/General Notes/Location Map
3. Existing Conditions
4. Proposed Conditions
- 5.-6. Cross Sections
7. Details

Prepared By IDNR Staff

Approved for Bidding:

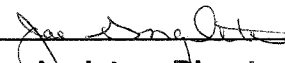
  
Joe Angleton, Director  
Office of Mines and Minerals

Approved By:

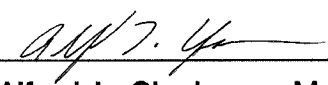
  
Alfred L. Clayborne, Manager  
AML Division

Approved By:

  
Bruce C. Schottel, P.E.  
IL Licensed Professional Engineer  
No. 0062-047240



Summary of Quantities					
#	Item	Section	Quantity	Unit	Rates/Remarks
1	Special Clearing	201	1	L.S.	
2	Earth Excavation	202	3,185	C.Y.	Compaction per Section 216
3	Class SI Concrete Plug	216	200	C.Y.	
4	CA Fill	216	1,694.0	Ton	CA-1
5	Seeding	250	3.5	Acre	
6	Nitrogen Fertilizer Nutrient	250	420	Pound	See Schedule Below
7	Phosphorus Fertilizer Nutrient	250	490	Pound	
8	Potassium Fertilizer Nutrient	250	945	Pound	
9	Agricultural Ground Limestone	250	70.0	Ton	20.0 Tons/Acre
10	Mulch Method 2, Procedure 2	IDOT 251	3.0	Acre	2.0 Tons/Acre
11	Erosion Control Blanket	IDOT 251	1,989	S.Y.	8 Feet Wide Strips
12	Mobilization (Max. of 6 % of Bid)	671	1	L.S.	

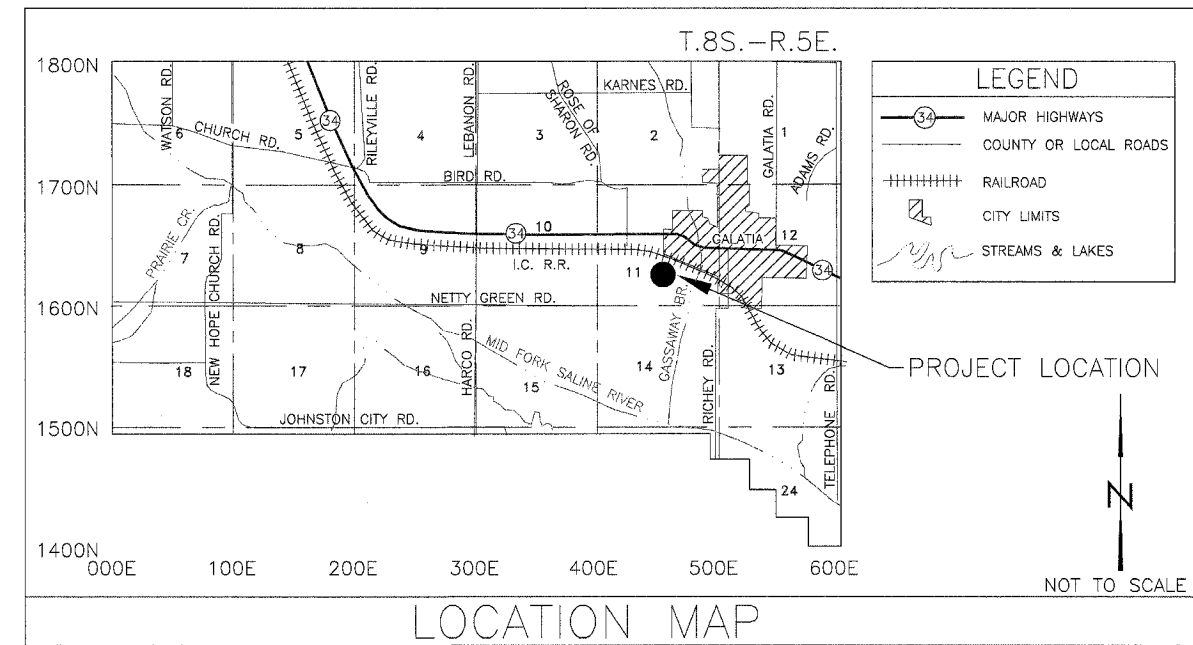

**GENERAL NOTES**

Unless otherwise noted on the plans, all disturbed areas within the construction limits will be amended with agricultural ground limestone, fertilizer nutrients, seeded and mulched at the required rates specified in the plans.

The contractor is responsible for visiting the site and familiarizing himself with the existing conditions and the proposed reclamation work prior to submitting a bid.

The contractor shall provide and pay for all field engineering services to execute the project as specified in the Field Engineering section of the Special Provisions.

The contractor is responsible for locating and protecting all existing utility lines pertaining to the work.

Unless noted on the plans, all onsite access roads may be used for construction and must be maintained during construction and restored to original or better condition at the completion of work by the contractor. Access roads to the site as designated in the plans are to be maintained to the satisfaction of the engineer.

The construction limits will be staked by the contractor prior to construction. The contractor is responsible for the repair and or restitution at his own expense for all damages done to any area outside the construction limits.

Application rates specified in the plans are shown in the Summary of Quantities—Rates/Remarks column.

**CONSTRUCTION NOTES**

**BURIAL/REMOVAL OF MATERIAL**—Concrete and masonry debris designated for burial by the engineer shall be buried at least three feet below proposed final grade. Onsite organic debris and trash shall be disposed of in an engineer approved offsite landfill in accordance with Sections 201 and 501 of the Special Provisions.

**TREE REMOVAL**—Trees removed shall be disposed of onsite per Section 201 of the Special Provisions.

**ACID WATER TREATMENT**—If acid mine drainage treatment is determined necessary by the engineer, and not otherwise specified in the plans, any water treatment will be paid for in accordance with Article 109.04 of the Standard Specifications.

**EROSION CONTROL**—The contractor shall schedule his operations and take such precautions that may be necessary to prevent or minimize erosion. Failure to comply with this requirement shall cause the contractor to be fully responsible for repairing any eroded areas and cleaning up areas or drainage structures that have become silted in or damaged.

**AGRICULTURAL GROUND LIMESTONE**—Immediately prior to seed bed preparation, fertilizer nutrients and agricultural ground limestone shall be uniformly spread at the rates specified in the plans.

**MULCHING**—Within 24 hours from the time seeding has been performed, the seeded area shall be given a covering of mulch at the rates specified in the plans. The mulch is to be anchored into the soil in accordance with the requirements for method 2, procedure 2 of Article 251.03 of the Standard Specifications. If Excelsior or Special Excelsior Blanket is to be used, the blanket shall be placed the same day that the areas are seeded.

**Schedule of Seeding, Fertilizer Nutrients and Mulch**

ITEM (unit)	FALL 2006 AUG. 20 – OCT. 15	TOTAL QUANTITY
SEEDING (acres)	3.5	3.5
AGRICULTURAL GROUND LIMESTONE (tons)	70.0 20.0 T/A	70.0
NITROGEN FERTILIZER NUTRIENT (pounds)	420 120 Lb./A	420
PHOSPHOROUS FERTILIZER NUTRIENT (pounds)	490 140 Lb./A	490
POTASSIUM FERTILIZER NUTRIENT (pounds)	945 270 Lb./A	945
MULCH, METHOD 2 PROCEDURE 2 (acres)	3.0 2.0 T/A	3.0

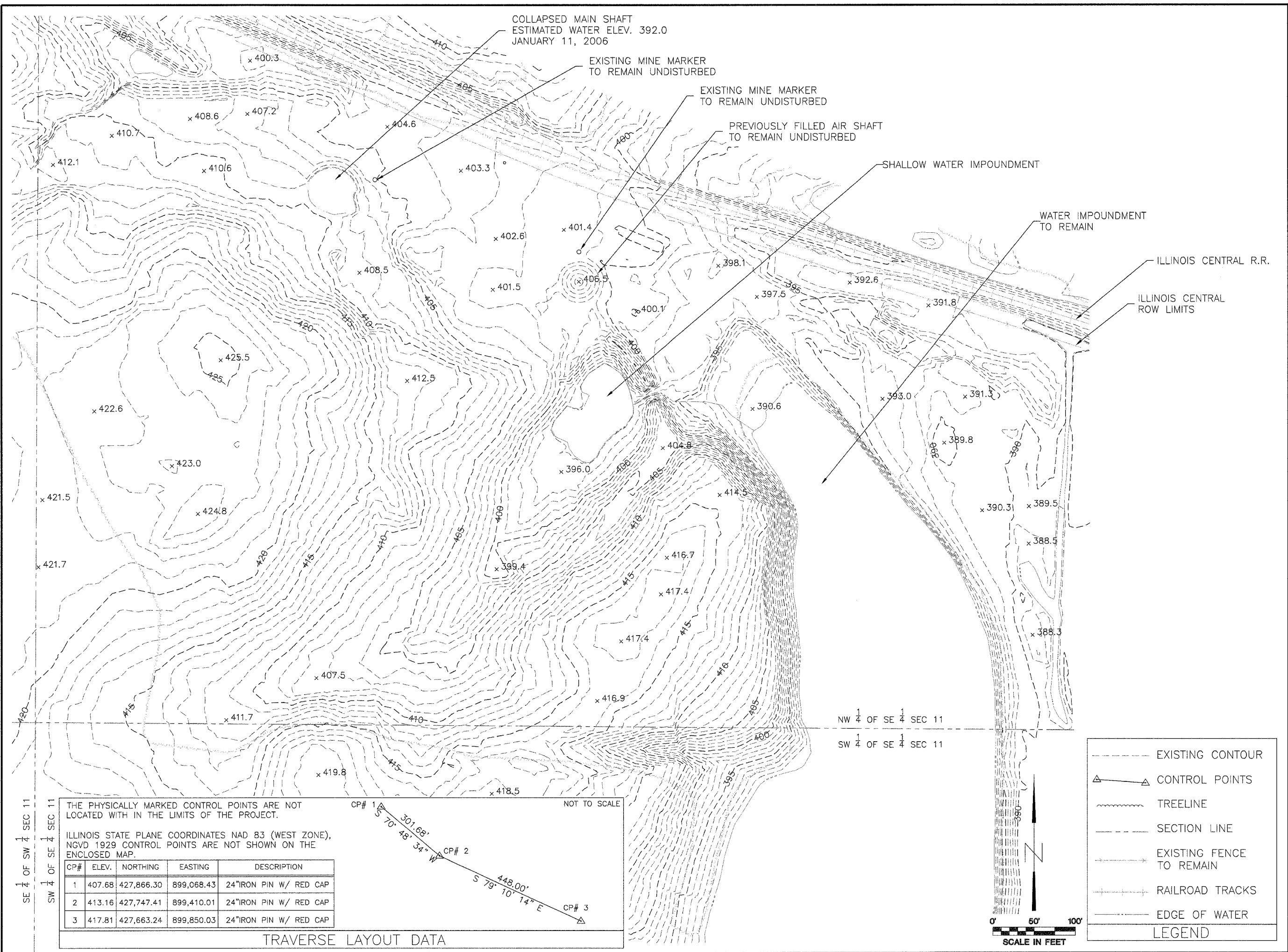

Drawn By: OMA Date: 04-28-06  
Checked By: \_\_\_\_\_

THE PHYSICALLY MARKED CONTROL POINTS ARE NOT LOCATED WITH IN THE LIMITS OF THE PROJECT.

ILLINOIS STATE PLANE COORDINATES NAD 83 (WEST ZONE),  
NGVD 1929 CONTROL POINTS ARE NOT SHOWN ON THE  
ENCLOSED MAP.

CP#	ELEV.	NORTHING	EASTING	DESCRIPTION
1	407.68	427,866.30	899,068.43	24" IRON PIN W/ RED CAP
2	413.16	427,747.41	899,410.01	24" IRON PIN W/ RED CAP
3	417.81	427,663.24	899,850.03	24" IRON PIN W/ RED CAP

TRAVERSE LAYOUT DATA

NOT TO SCALE

CP# 1 301.68' S 70° 48' 34" W  
CP# 2 448.00' S 79° 10' 14" E  
CP# 3

LEGEND

- EXISTING CONTOUR
- △ CONTROL POINTS
- ~~~~ TREELINE
- - - SECTION LINE
- - - EXISTING FENCE TO REMAIN
- RAILROAD TRACKS
- EDGE OF WATER

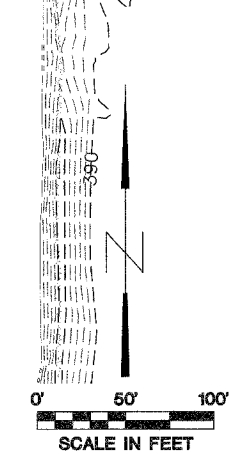

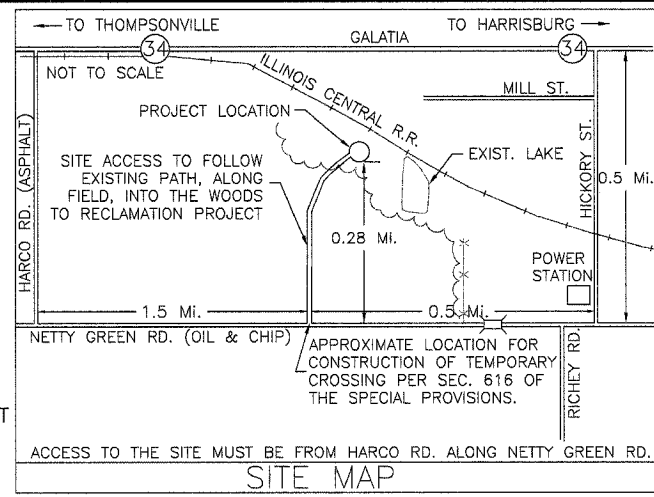
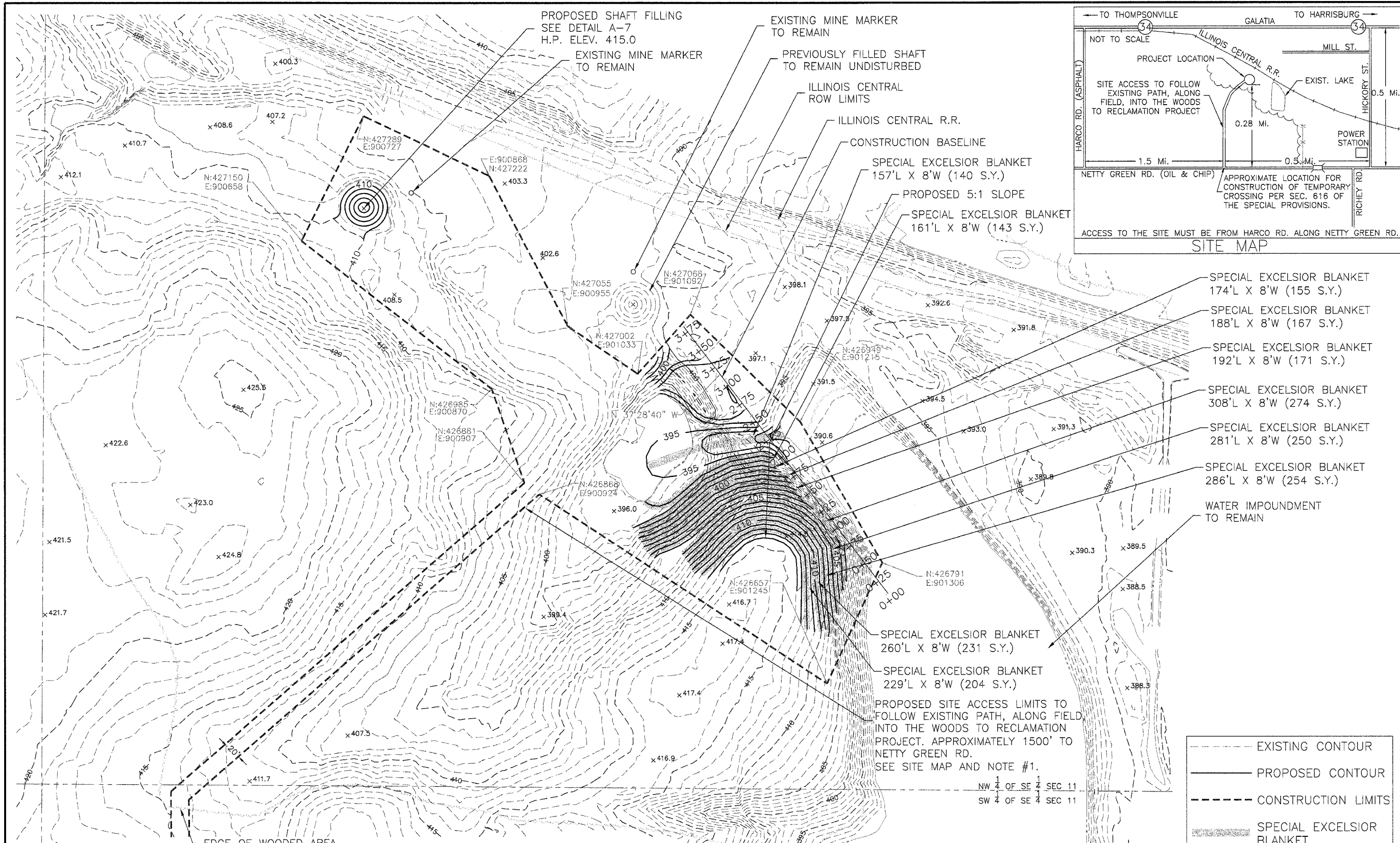

- SPECIAL EXCELSIOR BLANKET 174'L X 8'W (155 S.Y.)
- SPECIAL EXCELSIOR BLANKET 188'L X 8'W (167 S.Y.)
- SPECIAL EXCELSIOR BLANKET 192'L X 8'W (171 S.Y.)
- SPECIAL EXCELSIOR BLANKET 308'L X 8'W (274 S.Y.)
- SPECIAL EXCELSIOR BLANKET 281'L X 8'W (250 S.Y.)
- SPECIAL EXCELSIOR BLANKET 286'L X 8'W (254 S.Y.)
- WATER IMPOUNDMENT TO REMAIN

- SPECIAL EXCELSIOR BLANKET 260'L X 8'W (231 S.Y.)
- SPECIAL EXCELSIOR BLANKET 229'L X 8'W (204 S.Y.)
- PROPOSED SITE ACCESS LIMITS TO FOLLOW EXISTING PATH, ALONG FIELD, INTO THE WOODS TO RECLAMATION PROJECT. APPROXIMATELY 1500' TO NETTY GREEN RD. SEE SITE MAP AND NOTE #1.

NW 1/4 OF SE 1/4 SEC 11  
SW 1/4 OF SE 1/4 SEC 11

**NOTES:**

1. ACCESS/EGRESS: THE CONTRACTOR SHALL MAKE ANY IMPROVEMENTS TO THE DESIGNATED ACCESS ROUTE AS NECESSARY TO DELIVER MATERIALS, EQUIPMENT AND TO COMPLETE ALL PROJECT WORK. IMPROVEMENTS SHALL BE REMOVED SOUTH OF WOODED AREA UPON PROJECT COMPLETION AND THE ACCESS ROUTE SHALL BE RESTORED TO ORIGINAL OR BETTER CONDITION. IMPROVEMENTS MADE NORTH OF WOODED AREA SHALL REMAIN IN PLACE UPON PROJECT COMPLETION. MATERIALS SUCH AS AGGREGATES USED IN MAKING IMPROVEMENTS, THAT ARE DEEMED SUITABLE, MAY BE UTILIZED AT THE CONTRACTORS DISCRETION AS FILL ABOVE THE CONCRETE CAP, PROVIDED THEY ARE NOT PLACED WITH IN THE TOP 5 FEET. THIS ITEM SHALL BE INCIDENTAL TO THE CONTRACT PRICE FOR MOBILIZATION.
2. THE CONTRACTOR SHALL USE EXTREME CAUTION WHEN WORKING IN THE AREA OF THE SHAFT DUE TO THE UNKNOWN CONDITION OF THE SHAFT AND THE UNKNOWN STABILITY OF THE AREA AROUND THE SHAFT. THE ENGINEER RESERVES THE RIGHT TO INCREASE OR DECREASE THE VOLUME OF BACKFILLING MATERIALS REQUIRED. THE ENGINEER WILL MAKE THE DETERMINATION DURING CONSTRUCTION.
3. THE CONTRACTOR SHALL NOT ENCROACH UPON THE RAILROAD RIGHT-OF-WAY.
4. SHALLOW WATER IMPOUNDMENTS PRESENT AND/OR THOSE THAT MAY APPEAR PRIOR OR DURING CONSTRUCTION SHALL BE DEWATERED. THIS WORK SHALL BE INCIDENTAL TO EARTH EXCAVATION.

	EXISTING CONTOUR
	PROPOSED CONTOUR
	CONSTRUCTION LIMITS
	SPECIAL EXCELSIOR BLANKET
	TREELINE
	SECTION LINE
	EXISTING FENCE TO REMAIN
	RAILROAD TRACKS
	EDGE OF WATER

LEGEND

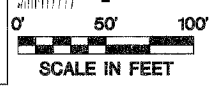



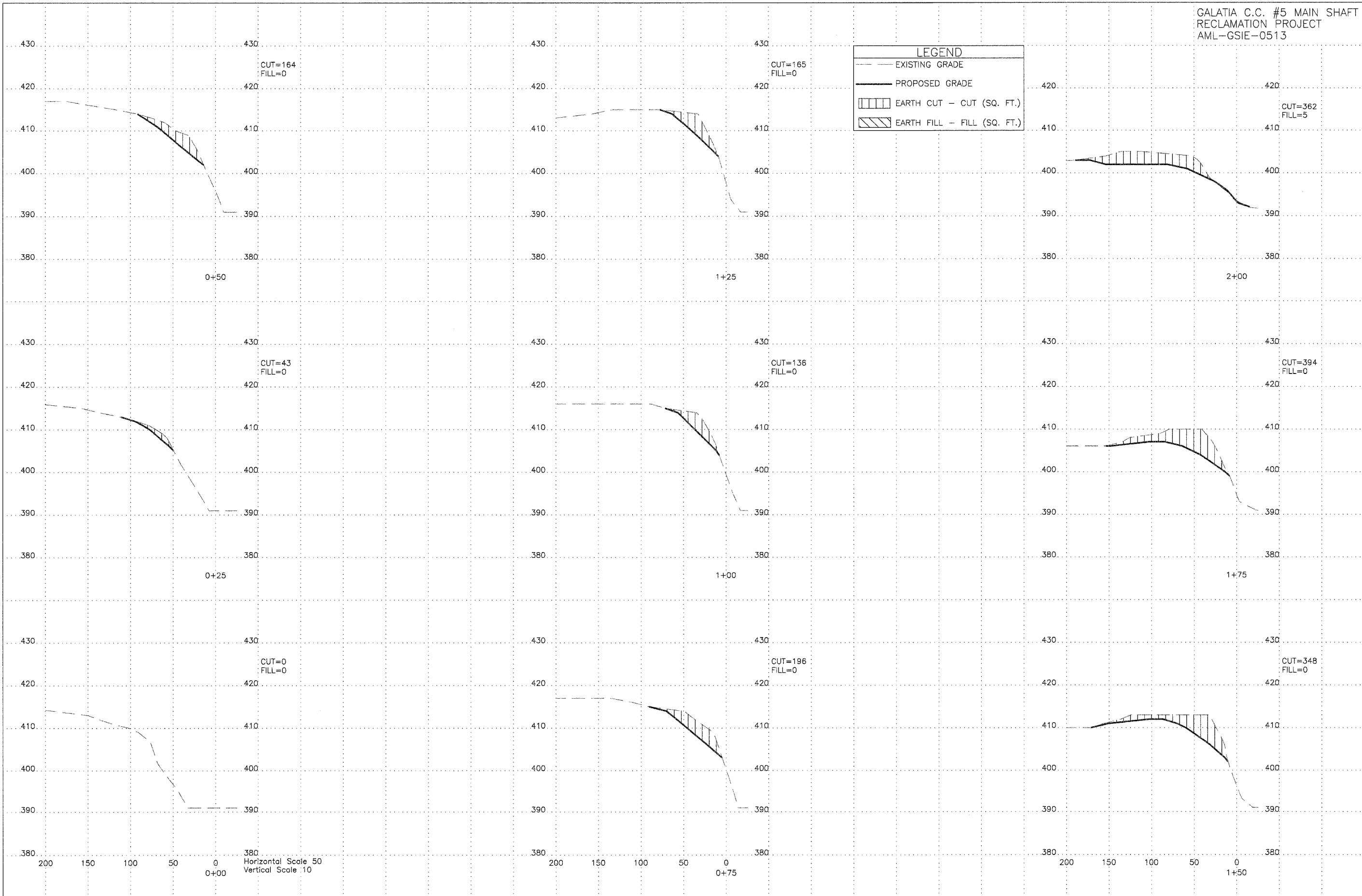

Drawn By: OMA  
Checked By:  
Date: 05-04-06

**LEGEND**

- EXISTING GRADE
- PROPOSED GRADE
- ▨ EARTH CUT - CUT (SQ. FT.)
- ▩ EARTH FILL - FILL (SQ. FT.)



Horizontal Scale 50  
 Vertical Scale 10

LEGEND	
	EXISTING GRADE
	PROPOSED GRADE
	EARTH CUT - CUT (SQ. FT.)
	EARTH FILL - FILL (SQ. FT.)

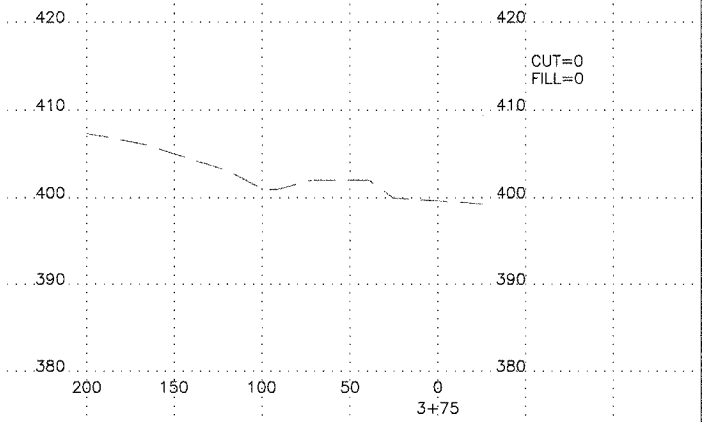
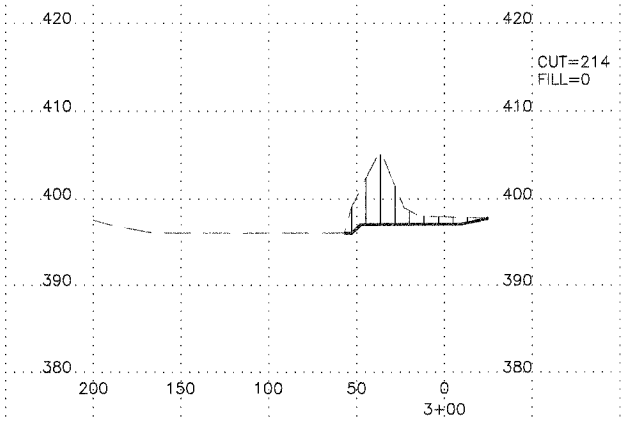
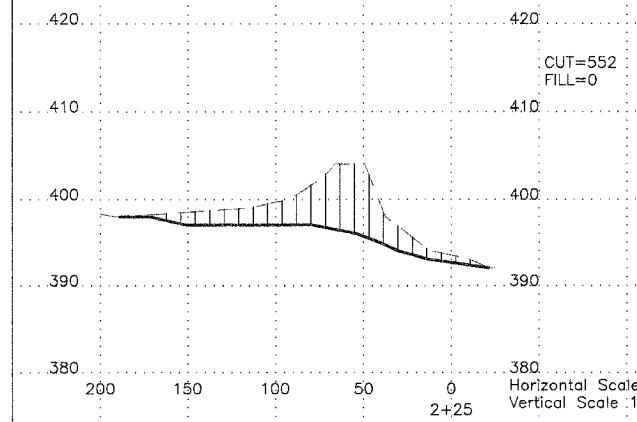
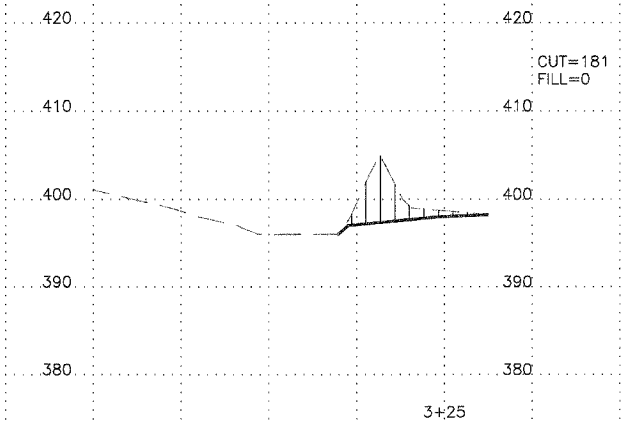
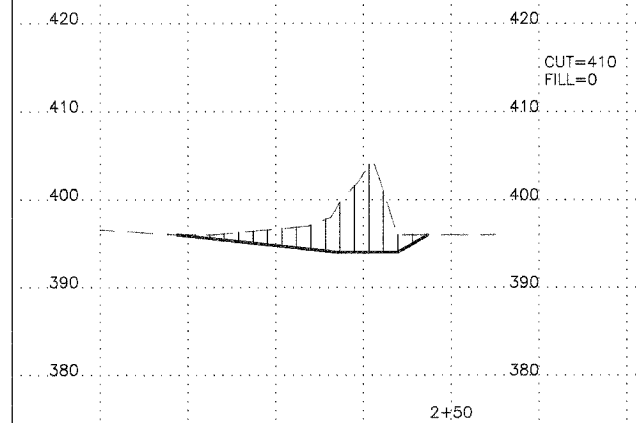
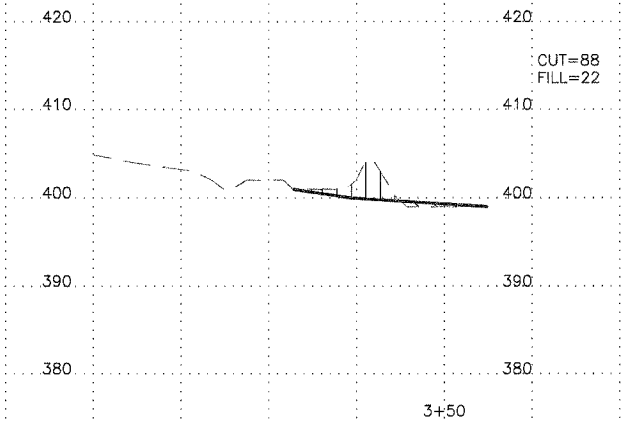
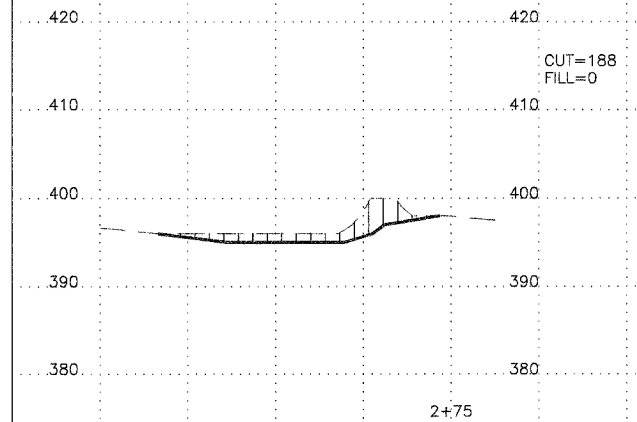

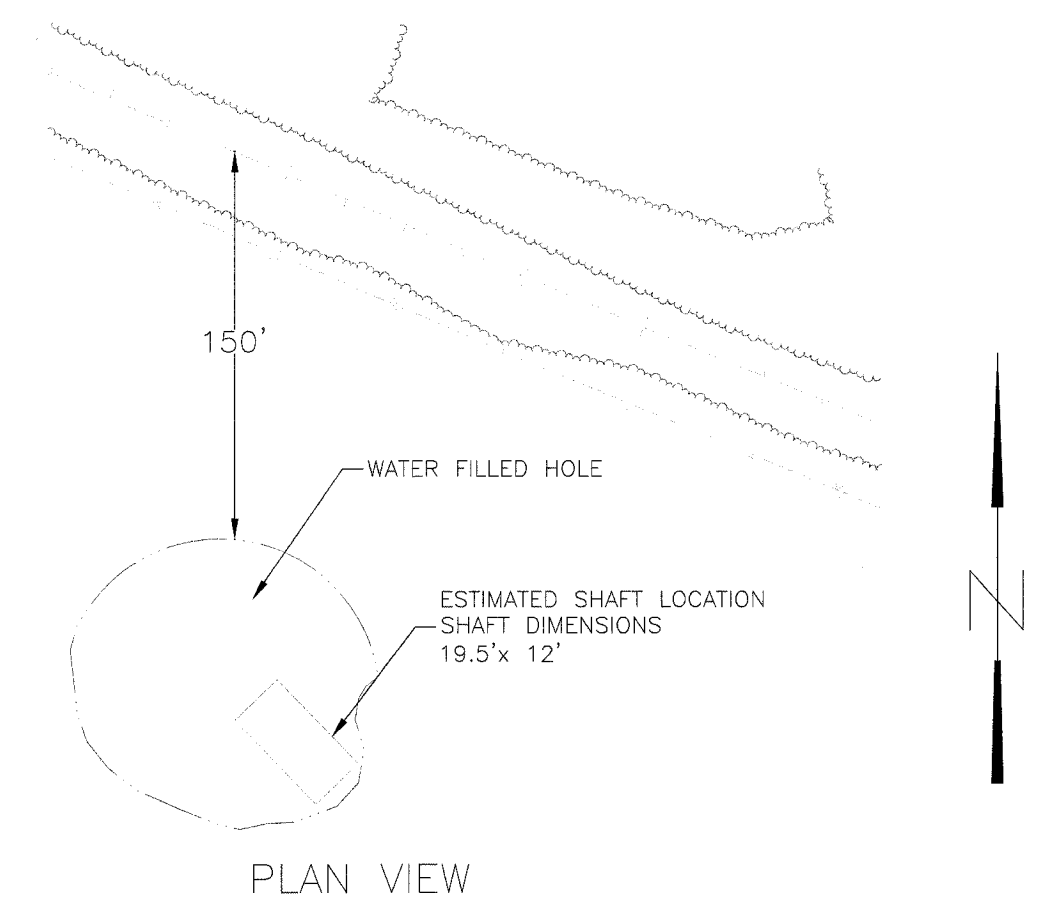
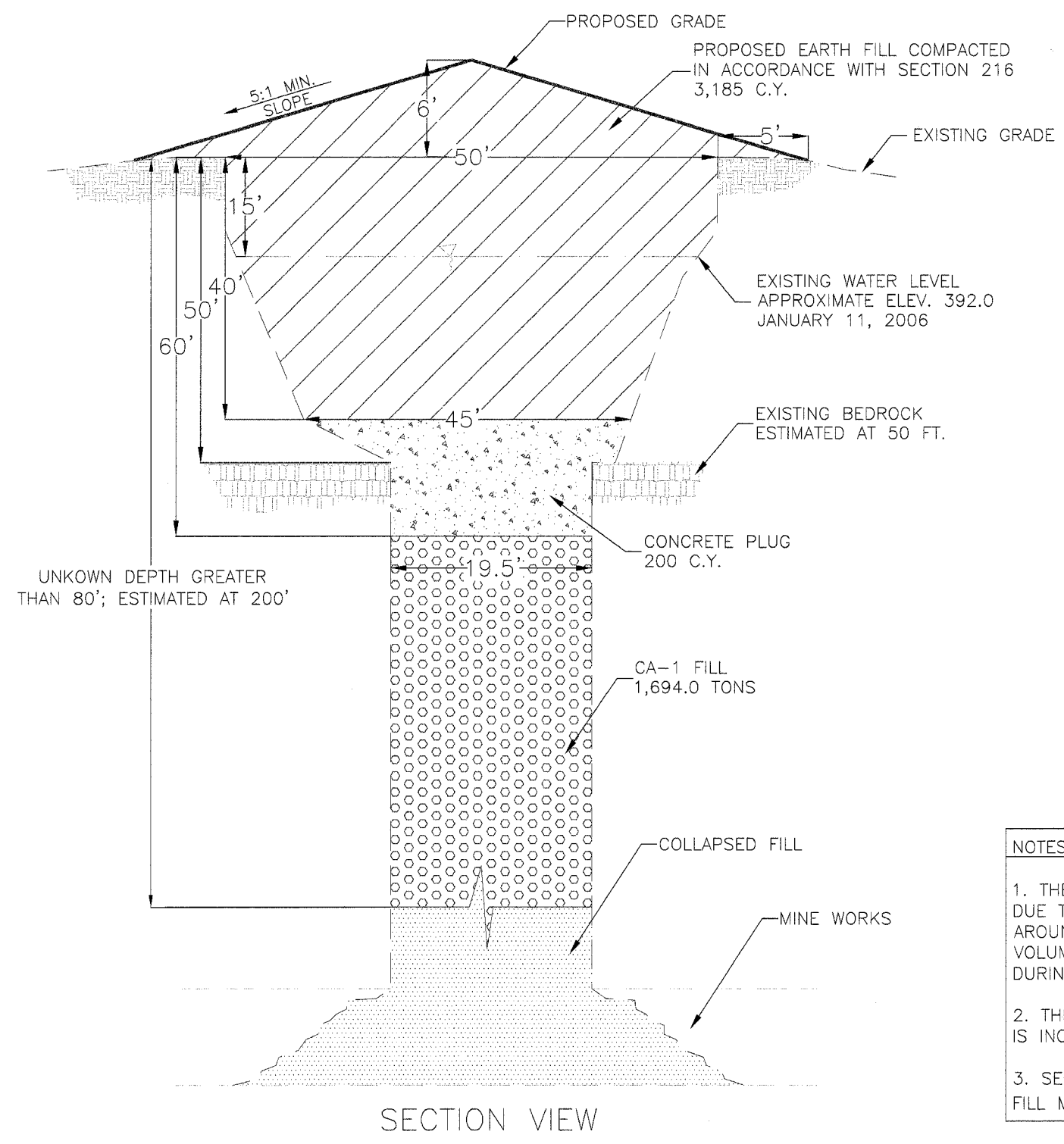

NOTES:

1. THE CONTRACTOR SHALL USE EXTREME CAUTION WHEN WORKING IN THE AREA OF THE SHAFT DUE TO THE UNKNOWN CONDITION OF THE SHAFT AND THE UNKNOWN STABILITY OF THE AREA AROUND THE SHAFT. THE ENGINEER RESERVES THE RIGHT TO INCREASE OR DECREASE THE VOLUME OF BACKFILLING MATERIALS REQUIRED. THE ENGINEER WILL MAKE THE DETERMINATION DURING CONSTRUCTION.
2. THE CONTRACTOR SHALL LOCATE AND MEASURE THE DEEPEST PART OF THE VOID. THIS WORK IS INCIDENTAL TO PLACEMENT OF CA-1 FILL.
3. SEE SPECIAL PROVISION 216 FOR DETAILED SPECIFICATIONS REGARDING PLACEMENT OF SHAFT FILL MATERIALS.

SHAFT FILLING DETAIL  
DETAIL A-7 - NOT TO SCALE