

F.A.I. RTE.	SECTION	COUNTY	TOTAL SHEETS	SHEET NO.
90/94		COOK	312	100
STA. 4460+50		TO STA. 4465+25		
FED. ROAD DIST. NO. 1 ILLINOIS FED. AID PROJECT				
60A62 • (1919.15, 2021-922 PT1 & PT2) R-1				

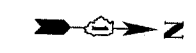

- LEGEND: EXISTING**
- INLET
 - CATCH BASIN
 - MANHOLE
 - STORM SEWER
 - COMBINED SEWER
 - PIPE UNDERDRAIN
 - [R] STRUCTURE TO BE REMOVED
 - [AD.] STRUCTURE TO BE ADJUSTED
 - //// STORM SEWER REMOVAL
 - //// COMBINED SEWER REMOVAL
 - //// WATER MAIN REMOVAL
 - ***** ABANDON EXISTING PIPE

EXISTING CONDITIONS AND REMOVAL
PROPOSED IMPROVEMENTS

- LEGEND: PROPOSED**
- INLET
 - CATCH BASIN
 - MANHOLE
 - STORM SEWER
 - PIPE UNDERDRAIN
 - PROPOSED SWALE
 - ↔ HIGH POINT
 - ↔ LOW POINT
 - (XX-01) PROPOSED STRUCTURE

- NOTES:**
- SEE DRAINAGE SCHEDULES FOR STRUCTURE, PIPE AND UNDERDRAIN INFORMATION.
 - THE LOCATION OF DRAINAGE STRUCTURES AND PIPES CONSTRUCTED IN PREVIOUS CONTRACTS IS BASED OFF OF CONTRACT PLAN DRAWINGS. THE CONTRACTOR MUST VERIFY LIMITS OF PREVIOUS CONSTRUCTION IN THE FIELD.



REVISIONS	
NAME	DATE

DU-14

ILLINOIS DEPARTMENT OF TRANSPORTATION
F.A.I. 90/94 (DAN RYAN EXPRESSWAY)
63RD STREET TO GARFIELD BLVD (NB LOCAL LANES)

DRAINAGE AND UTILITY PLANS

SCALE: 1"=20'
DATE: June 9, 2006

DRAWN BY: MDD
CHECKED BY: MS

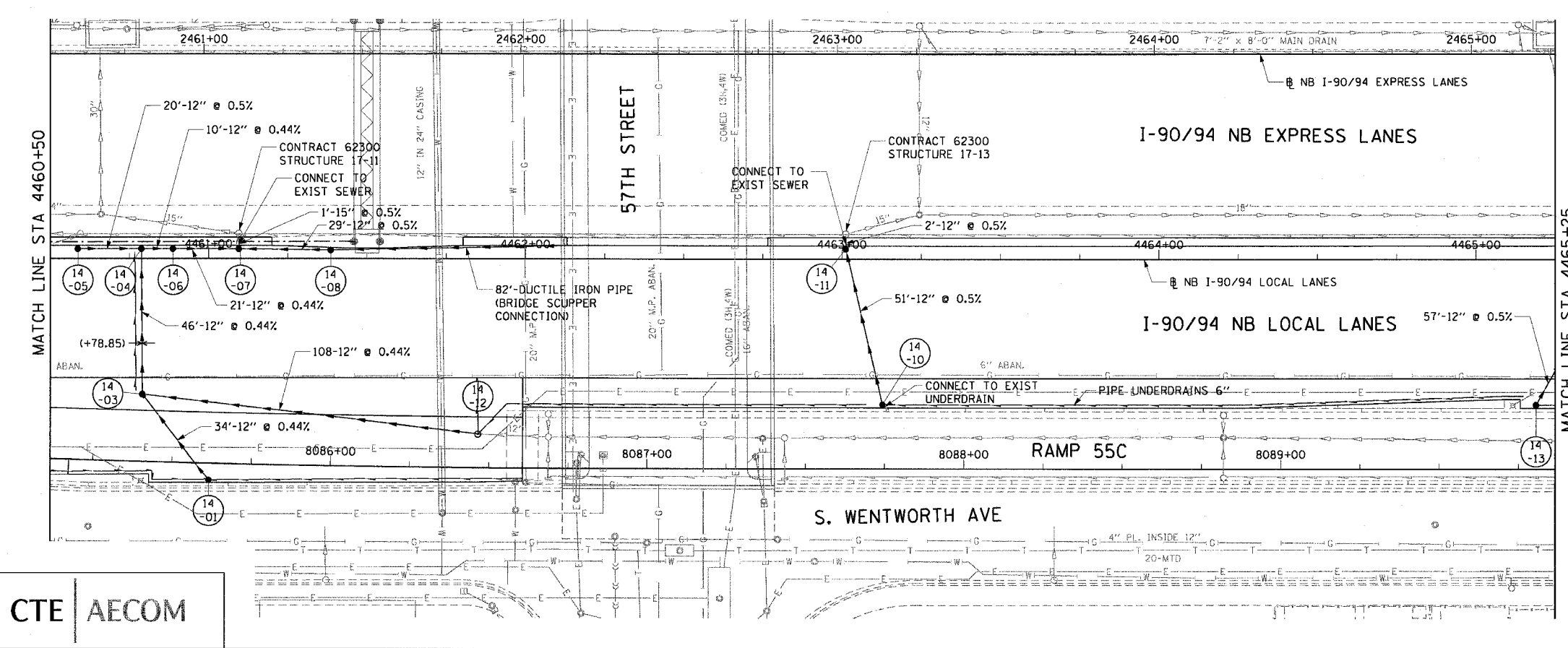
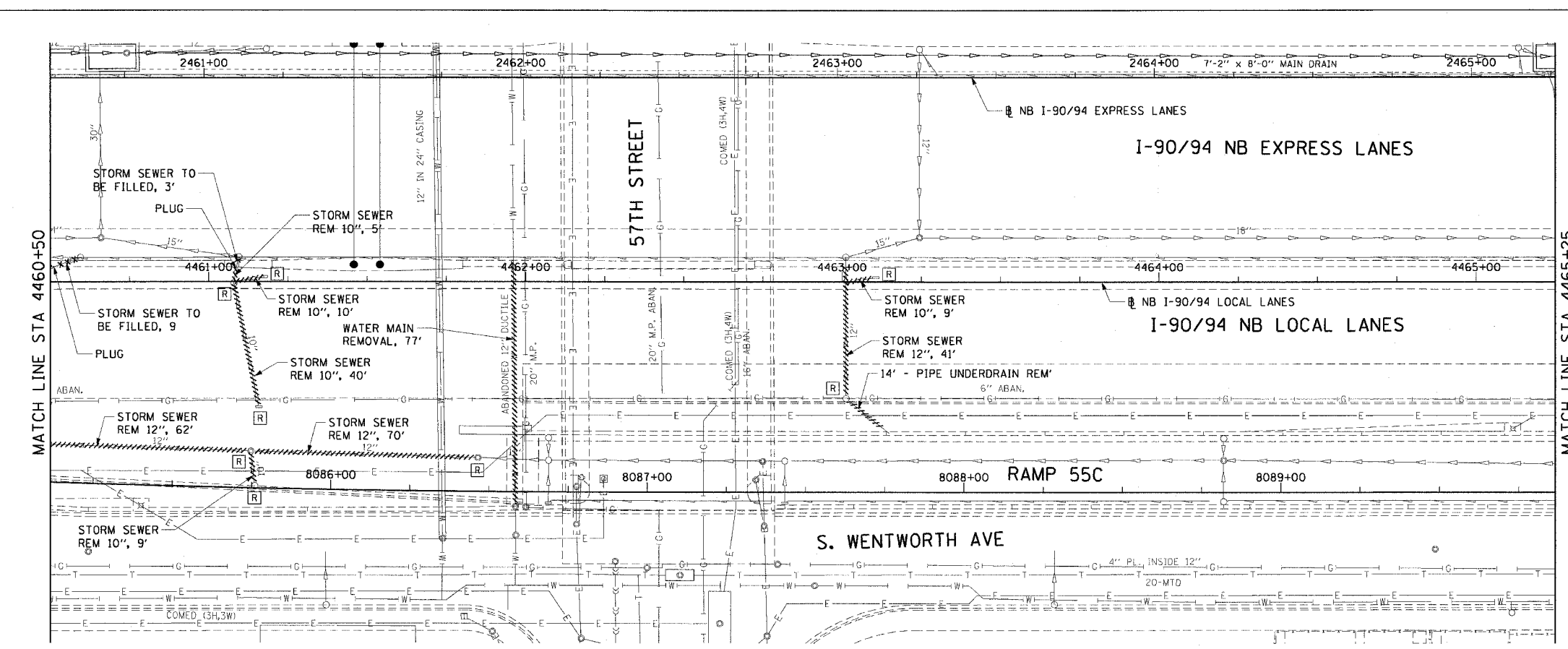

P:\V\0468\CH\NB-cnfrs 18 & 15\SP\cnfr. (Bodrainage and utility plan)\du14.dwg 9/8/06 AM 6/15/2006