

F.A.I. RTE.	SECTION	COUNTY	TOTAL SHEETS	SHEET NO.
90/94	*	COOK	312	179
STA. 1416+00.00		TO STA. 1426+00.00		
FED. ROAD DIST. NO. 1 ILLINOIS FED. AID PROJECT				
60A62 • (1919.15, 2021-922 PT1 & PT2) R-1				

NOTES:

- SEE DRAWINGS EI-100 AND EI-101 FOR ELECTRICAL SYMBOLS AND ABBREVIATIONS.
- SEE DRAWING EI-106 FOR ELECTRICAL DUCTBANK INSTALLATION DETAILS.
- SEE DRAWING EI-107 FOR TYPICAL INSTALLATION DETAIL OF DUCTBANK AT AN EXISTING BRIDGE ABUTMENT. DUCTBANK SHALL BE TERMINATED AT THE STATIONS AND OFFSETS SHOWN APPROXIMATELY 30" BELOW FINISHED GRADE.
- UNLESS NOTED OTHERWISE, ALL ITEMS AND WORK SHOWN IN HEAVY LINE WEIGHT ON THIS DRAWING ARE PROPOSED NEW ITEMS AND WORK.

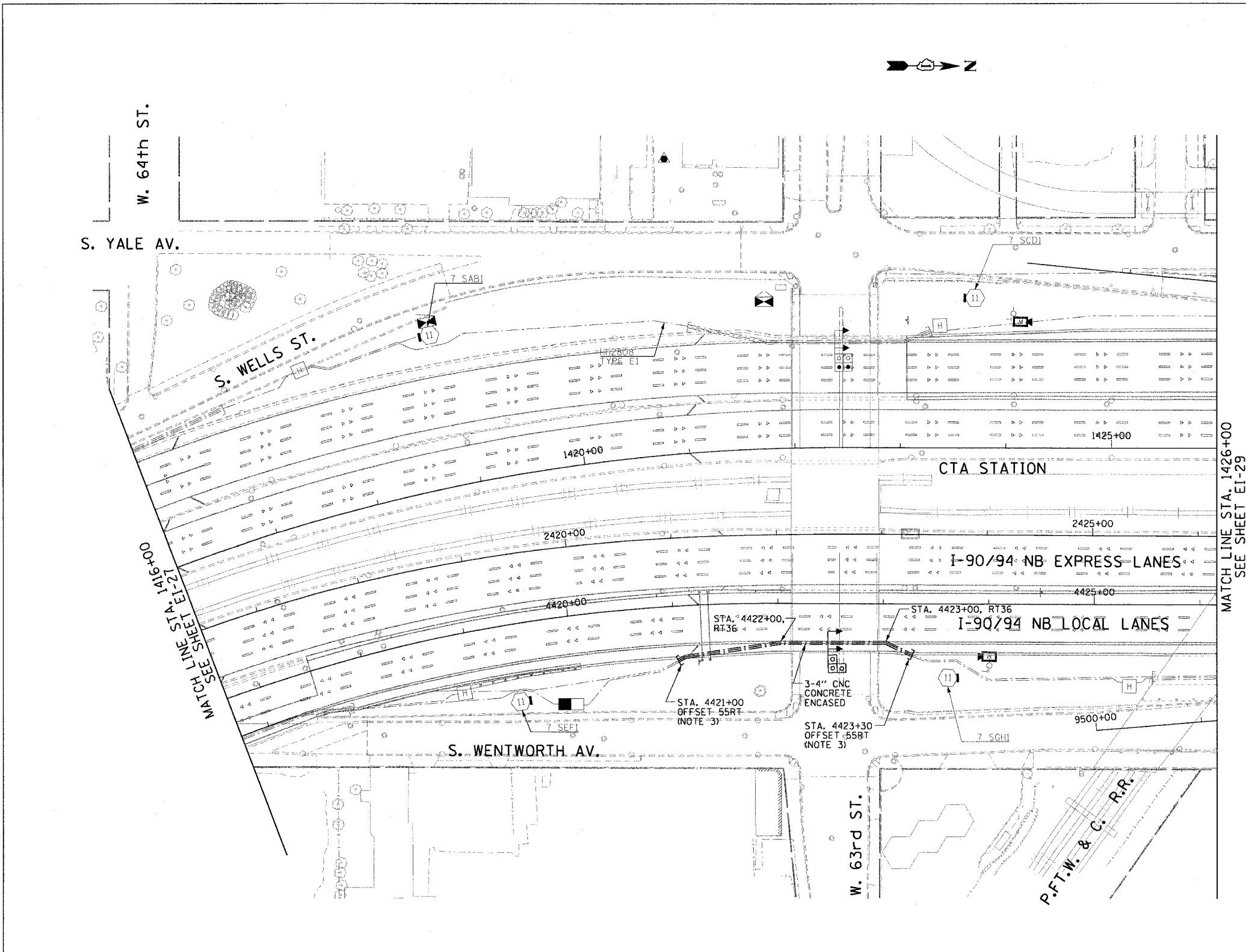

MATCH LINE STA. 1426+00
SEE SHEET EI-29

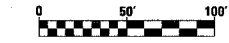

EI-28

REVISIONS	
NAME	DATE

ILLINOIS DEPARTMENT OF TRANSPORTATION
 F.A.I. 90/94 (DAN RYAN EXPRESSWAY)
 63RD STREET TO GARFIELD BLVD (NB LOCAL LANES)
ELECTRICAL INFRASTRUCTURE PLAN

SCALE: 1"=50'
 DATE: June 9, 2006
 DRAWN BY: HAR
 CHECKED BY: JPC

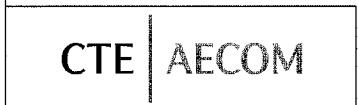

06/02/2006 03:51:09 PM