

F.A.I. RTE.	SECTION	COUNTY	TOTAL SHEETS	SHEET NO.
90/94		COOK	312	197
STA. 1376+00.00 TO STA. 1388+00.00				
FED. ROAD DIST. NO. 1 ILLINOIS FED. AID PROJECT				
60A62 • (1919.15, 2021-922 PT1 & PT2) R-1				

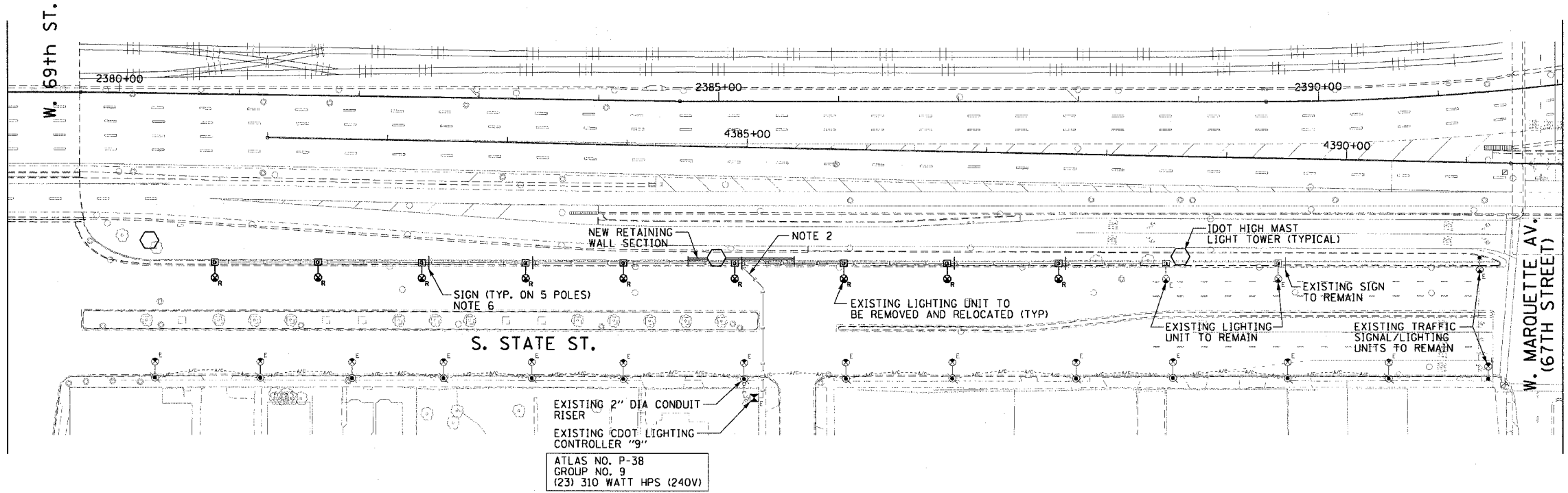

**EXISTING CONDITION/DEMOLITION PLAN**

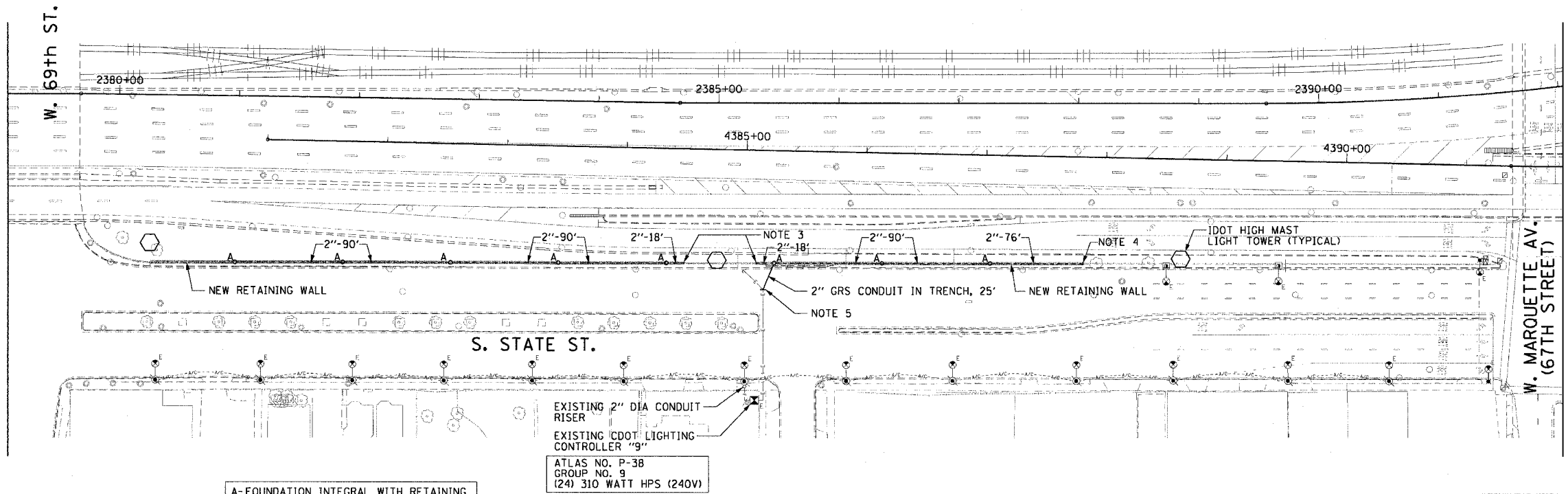

**PROPOSED CONDUIT AND FOUNDATION PLAN**

A- FOUNDATION INTEGRAL WITH RETAINING WALL SEE STRUCTURAL DRAWINGS, 10" B.C., 1/4" ANCHOR RODS  
 2" CONDUIT BETWEEN FOUNDATIONS SHALL BE SCHEDULE 80 PVC EMBEDDED IN RETAINING WALL

ATLAS NO. P-38  
 GROUP NO. 9  
 (24) 310 WATT HPS (240V)

**NOTES:**

- SEE DRAWINGS E-1 AND E-2 FOR GENERAL NOTES SYMBOLS AND ABBREVIATIONS.
- REMOVE EXISTING WIRING BACK TO LIGHTING CONTROLLER. CUT AND CAP CONDUIT FOR FUTURE USE.
- CONNECT TO EXISTING 2" CONDUIT EMBEDDED IN EXISTING RETAINING WALL.
- EXTEND CONDUIT 12" PAST END OF WALL AND CAP FOR FUTURE EXTENSION.
- INTERCEPT EXISTING RACEWAY AND EXTEND TO WALL MOUNTED LIGHTING UNIT. (2" RGS IN TRENCH). REPAIR STREET TO MATCH EXISTING. STREET REPAIR WILL NOT BE PAID FOR SEPARATELY BUT SHALL BE INCLUDED UNDER THE PAY ITEM TRENCH AND BACKFILL WITH SCREENINGS AND/OR SAND.
- REGULATORY SIGNS ATTACHED TO LIGHT POLES SHALL BE INVENTORIED, REMOVED AND STORED BY THE CONTRACTOR FOR REINSTALLATION ON RELOCATED LIGHT POLES.

CTE | AECOM

REVISIONS	
NAME	DATE

ILLINOIS DEPARTMENT OF TRANSPORTATION  
 F.A.I. 90/94 (DAN RYAN EXPRESSWAY)  
 63RD STREET TO GARFIELD BLVD (NB LOCAL LANES)

**EXISTING PLAN  
 PROPOSED CONDUIT AND  
 FOUNDATION PLAN**

SCALE: 1"=50'  
 DATE: June 9, 2006

DRAWN BY: HAR  
 CHECKED BY: JPC