

STATE OF ILLINOIS
DEPARTMENT OF TRANSPORTATION

F.A.I. RTE.	SECTION	COUNTY	TOTAL SHEETS	SHEET NO.
90/94		COOK	312	235
STA.		TO STA.		
FED. ROAD DIST. NO. 1		ILLINOIS FED. AID PROJECT		
60A62		• (1919.15, 2021-922 PT1 & PT2) R-1		

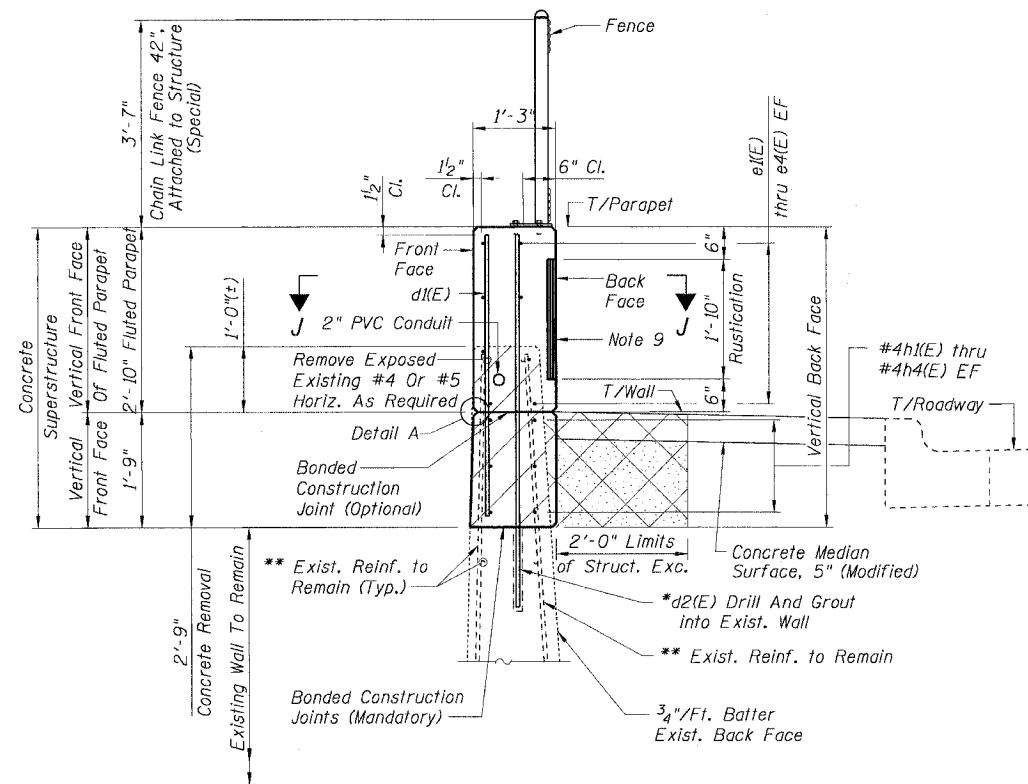

TYPICAL TOP OF WALL SECTION

* Drill & Grout d2(E) & d4(E) Bars in 1/8" Dia. drilled holes with a minimum depth of 1'-3", according to Article 5B4 of the Standard Specifications. (Cost included with Reinforcement Bars, Epoxy Coated)

** Existing reinforcing steel which is exposed by the concrete removal process, but which is to remain partially embedded in the existing structure, shall be cleaned to be free of existing concrete and rust, straightened if necessary, and recast into the new concrete. (Cost included with Concrete Removal).

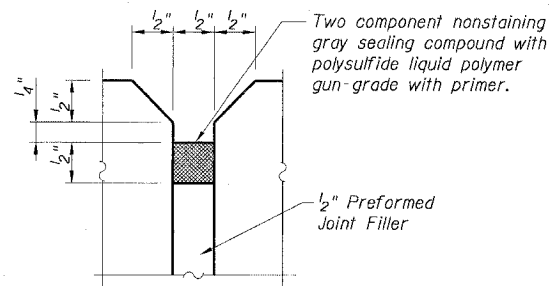

EXPANSION JOINT SEALING DETAIL

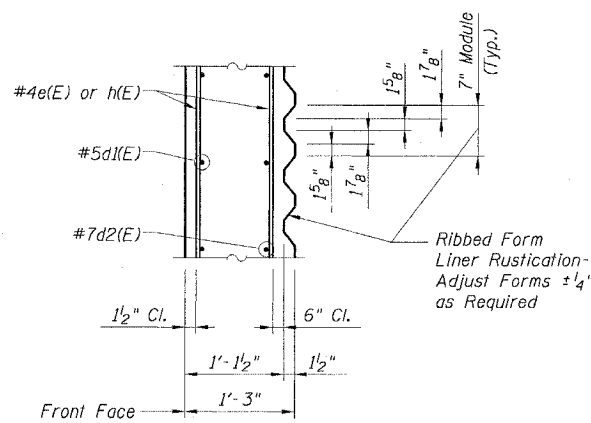

SECTION J-J

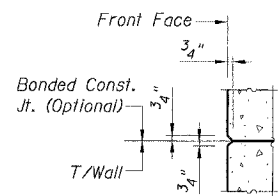

DETAIL A

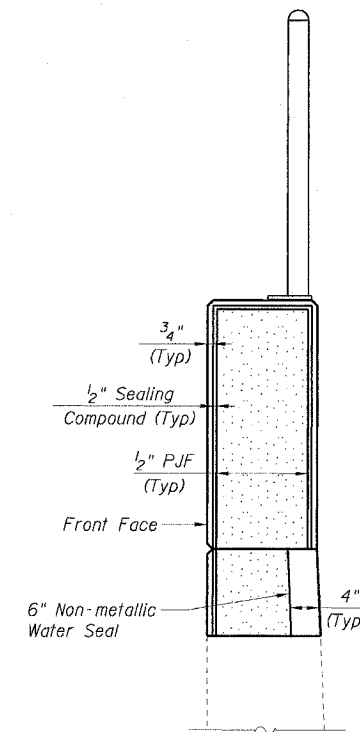

EXPANSION JOINT ELEVATION

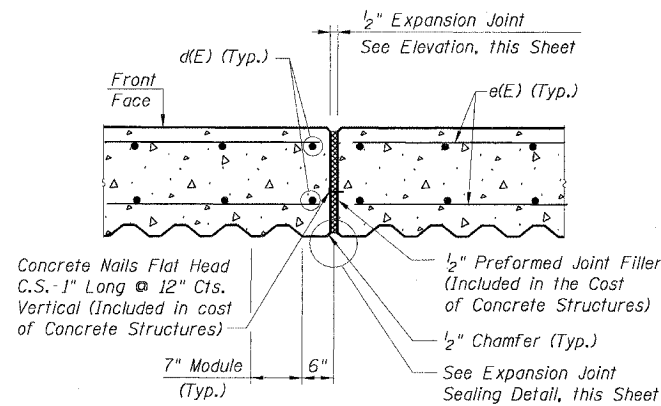

EXPANSION JOINT DETAIL

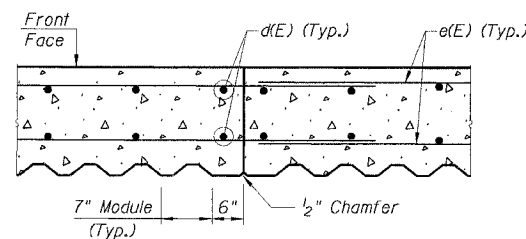

CONSTRUCTION JOINT DETAIL

LEGEND:

	Structure Excavation
	Porous Granular Embankment
	Concrete Removal

CTE | AECOM

REVISIONS	
NAME	DATE

Sheet A6 of 8
ILLINOIS DEPARTMENT OF TRANSPORTATION
F.A.I. 90/94 (DAN RYAN EXPRESSWAY)
63RD STREET TO GARFIELD BLVD (NB LOCAL LANES)
WALL SECTIONS AND DETAILS
SOUTH STATE STREET RETAINING WALL
SECTION (1818, ETC, 2324.6-1P) R-10
STATION 25+26.41 TO 33+04.33
COOK COUNTY S.N. 016-W923
SCALE: None DRAWN BY: CHD
DATE: June 9, 2006 CHECKED BY: MJP

P:\P\40468\STRUCTURE\CH17\8819\CH17\BANS\KRT\84062\A06-W923.SWT 1/16/09 AM 6/2/2006