

F.A.I. RTE.	SECTION	COUNTY	TOTAL SHEETS	SHEET NO.
55	2005-062 I	WILL	72	14
STA.		TO STA.		
FED. ROAD DIST. NO.		ILLINOIS FED. AID PROJECT		

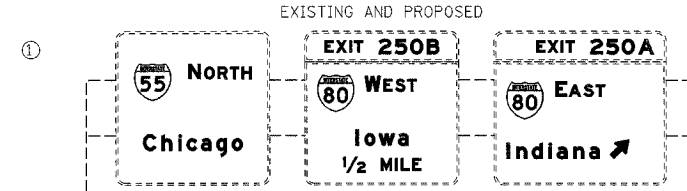
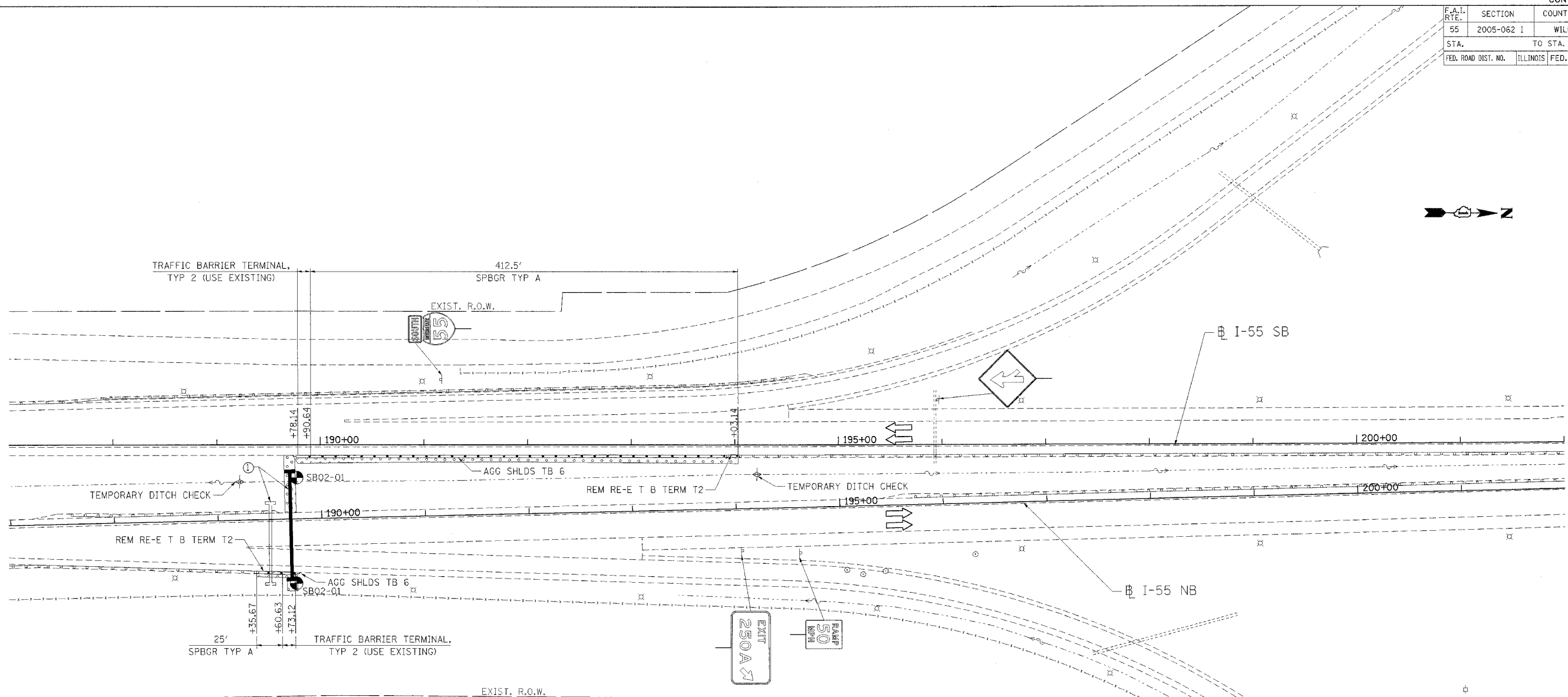

- 1S099I055R249.90  
EXISTING STA. 189+50  
PROPOSED STA. 189+70
- ERECT OVHD SIN STR-SPAN T2A 20 FT NORTH OF EXISTING
  - REL SIGN PANEL T3 FROM EXISTING TRUSS TO NEW TRUSS
  - REMOV OH SIN STR-SPN
  - REM CONC FDN-OVHD

**SIGNING LEGEND**

	EXISTING OVERHEAD TRUSS MOUNTED SIGN
	PROPOSED OVERHEAD TRUSS MOUNTED SIGN
	PROPOSED DYNAMIC MESSAGE SIGN
	EXISTING OVERHEAD CANTILEVER SIGN
	PROPOSED OVERHEAD CANTILEVER SIGN
	EXISTING GROUND MOUNTED SIGN (1 POSTS)
	EXISTING GROUND MOUNTED SIGN (2 POSTS)
	PROPOSED GROUND MOUNTED SIGN (2 POSTS)

**LEGEND**

	SEEDING CLASS 2A, TOPSOIL FURNISH AND PLACE, (VAR. DEPTH) AND EROSION CONTROL
	DIRECTION OF TRAFFIC
	SOIL BORING

REVISIONS	
NAME	DATE

ILLINOIS DEPARTMENT OF TRANSPORTATION  
FBI ROUTE 55 (I-80 TO U.S. 30)  
SIGNING

**SIGNING AND ROADWAY PLAN  
SIGN TRUSS AT STA. 189+70.00 (NB)**

SCALE: 1"=50'  
DATE 05/19/06

DRAWN BY MW  
CHECKED BY DDH

**TENG**  
TENG & ASSOCIATES, INC.  
ENGINEERS/ARCHITECTS/PLANNERS  
CHICAGO, ILLINOIS

PLOT DATE = 05/19/06  
 PLOT SCALE = 1"=50'  
 PLOT USER = MW  
 PLOT USER NAME = MW