

STATE OF ILLINOIS
DEPARTMENT OF TRANSPORTATION

ROUTE NO.	SECTION	COUNTY	JOB SHEETS	SHEET NO.	SHEET NO. 2 3 SHEETS
FAI 290	COOK		12	6	
FED. ROAD DIST. NO. 7	ALTITUDE	FED. ROAD PROJECT			

Contract No. 60B20

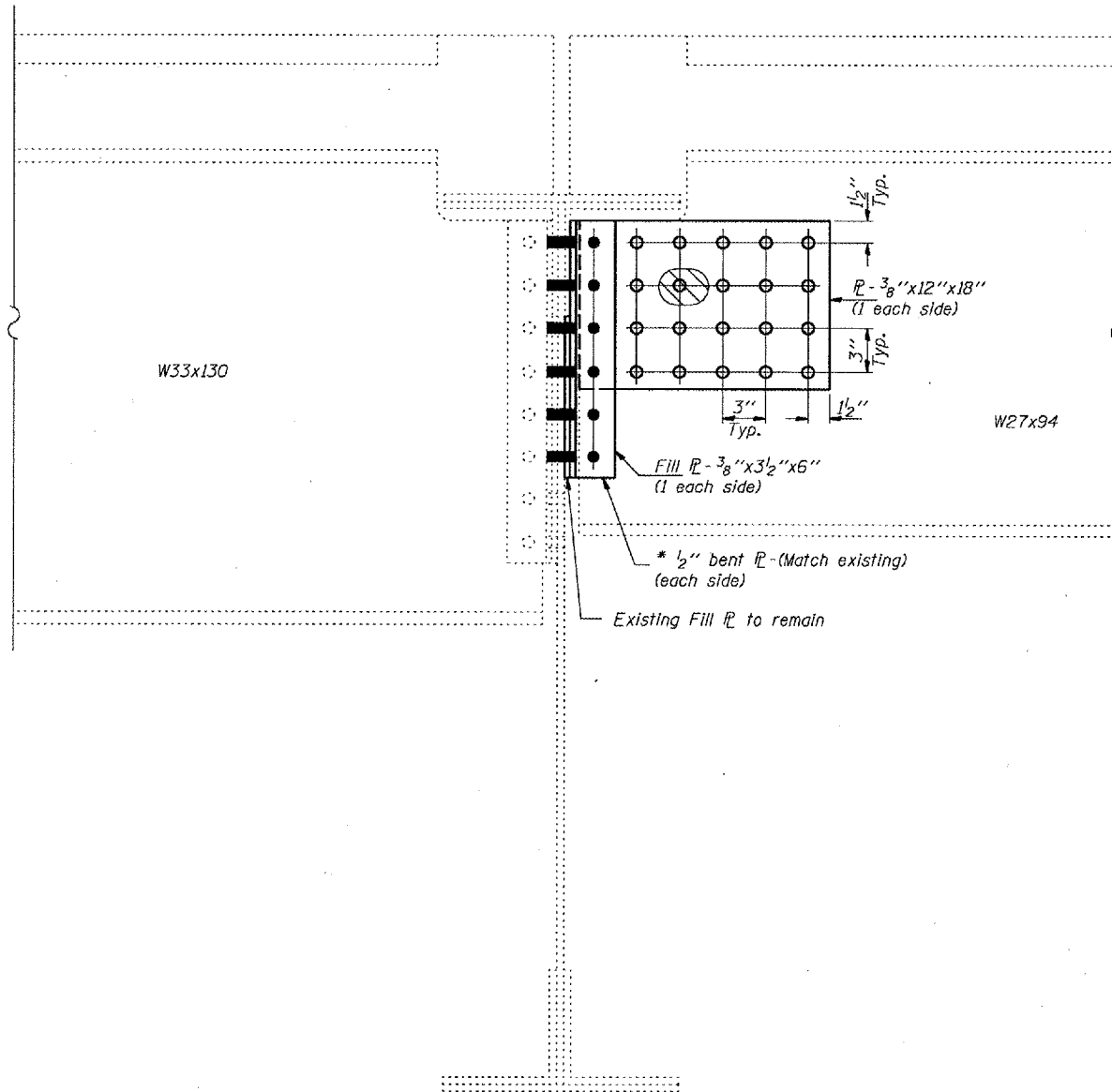

SECTION AT PIER J
Beam Line 7

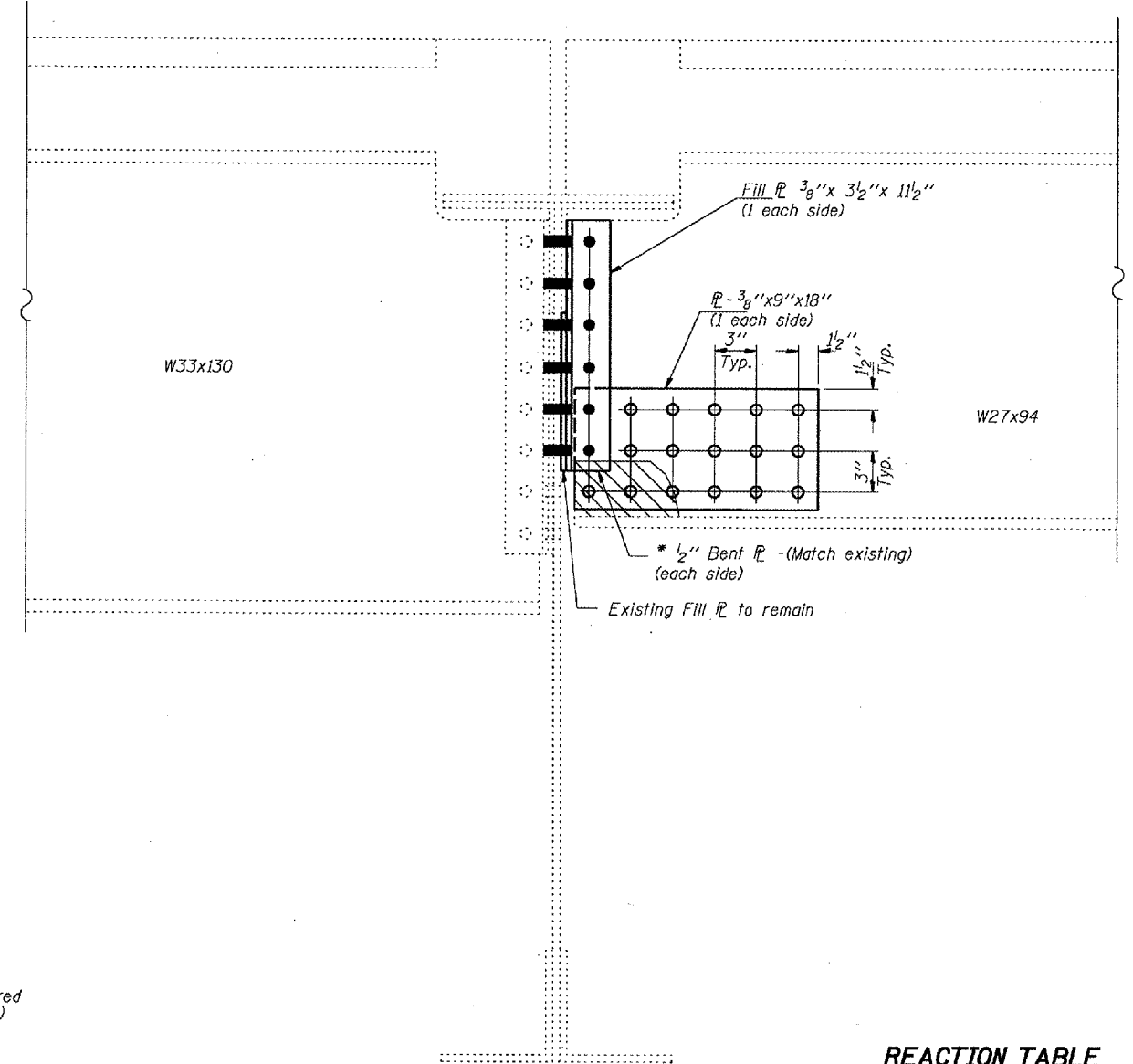

SECTION AT PIER J
Beam Line 11

- - See NOTE A
- - See NOTE B

All sections are looking North.
Hatched areas indicate beam damage.

* Temporary support system will be required
when removing and replacing bent R (Typ.)

REACTION TABLE

BEAM LINE	R@
7	14k
11	14k

DESIGNED	DAB
CHECKED	VHV
DRAWN	baliva
CHECKED	DAB VHV

JUNE 8, 2006
EXAMINED *John A. Morris*
ENGINEER OF STRUCTURAL SERVICES
PASSED *Ralph E. Anderson*
ENGINEER OF BRIDGES AND STRUCTURES

NOTE A:
Remove existing rivets. Field drill $\frac{15}{16}$ " ϕ holes in new angles using holes in existing beams as template. Existing rivets are to be replaced with $\frac{7}{8}$ " ϕ H.S. bolts. Cost of rivet replacement and field drilling is included with Structural Steel Repair.

NOTE B:
Drill $\frac{15}{16}$ " ϕ holes in plates. Field drill $\frac{15}{16}$ " ϕ holes in web using holes in plates as template. Use $\frac{7}{8}$ " ϕ H.S. bolts. Cost is included with Structural Steel Repair.

BRIDGE REPAIRS
FAI-290
CONGRESS STREET FROM OLD POST OFFICE
TO THE SOUTH BRANCH OF THE CHICAGO RIVER
COOK COUNTY
STRUCTURE NO. 016-0460