

CONTRACT NO. 60B32				
F.A.U. RTE.	SECTION	COUNTY	TOTAL SHEETS	SHEET NO.
2710	(1213&3219)RS-7	COOK	22	10
STA.	TO STA.			
FED. ROAD DIST. NO.	ILLINOIS FED. AID PROJECT			

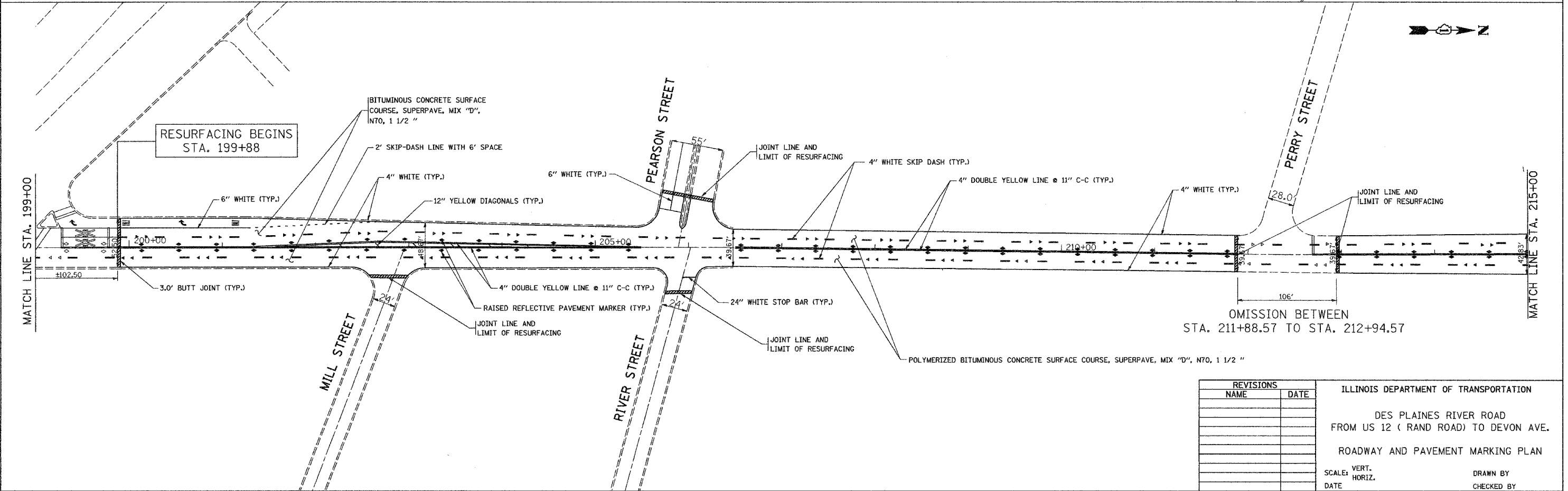
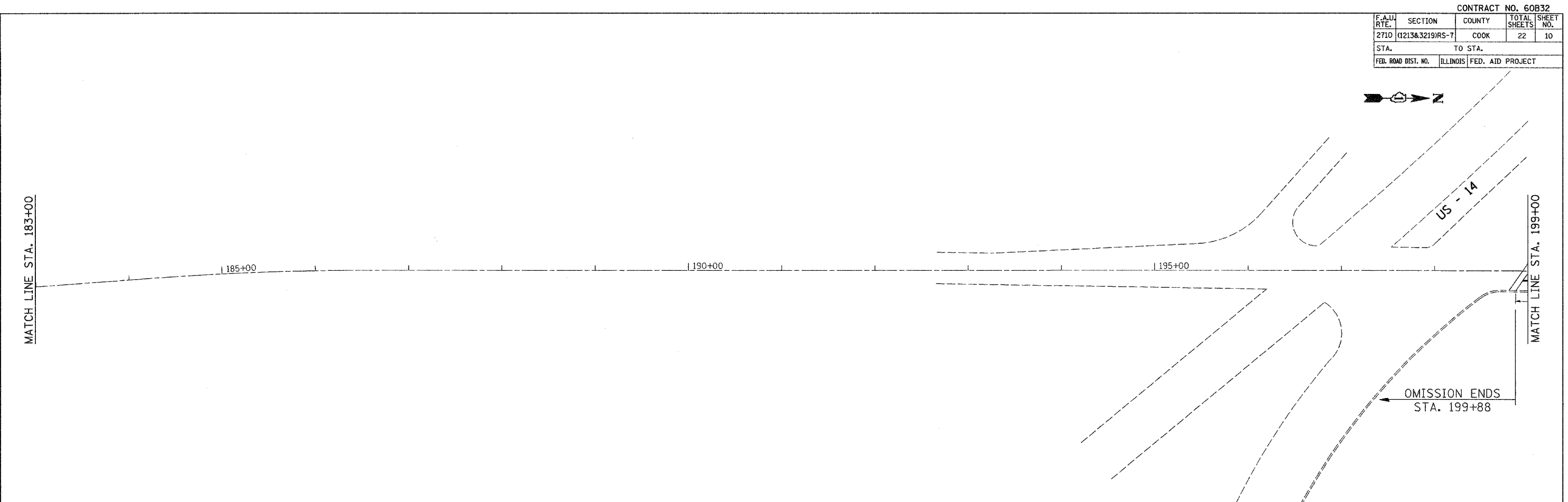

PLOT DATE = 6/23/2006
 FILE NAME = c:\projects\60b32\design\60b32.dgn
 PLOT SCALE = 5/8" = 1' IN.
 USER NAME = handeh

REVISIONS	
NAME	DATE

ILLINOIS DEPARTMENT OF TRANSPORTATION

DES PLAINES RIVER ROAD
 FROM US 12 (RAND ROAD) TO DEVON AVE.

ROADWAY AND PAVEMENT MARKING PLAN

SCALE: VERT. _____
 HORIZ. _____

DATE _____ DRAWN BY _____
 CHECKED BY _____