

F.A.I.	SECTION	COUNTY	TOTAL SHEETS	SHEET NO.
94/90	*	COOK	565	76
STA.		TO STA.		
FED. ROAD DIST. NO.	ILLINOIS	FED. AID PROJECT		

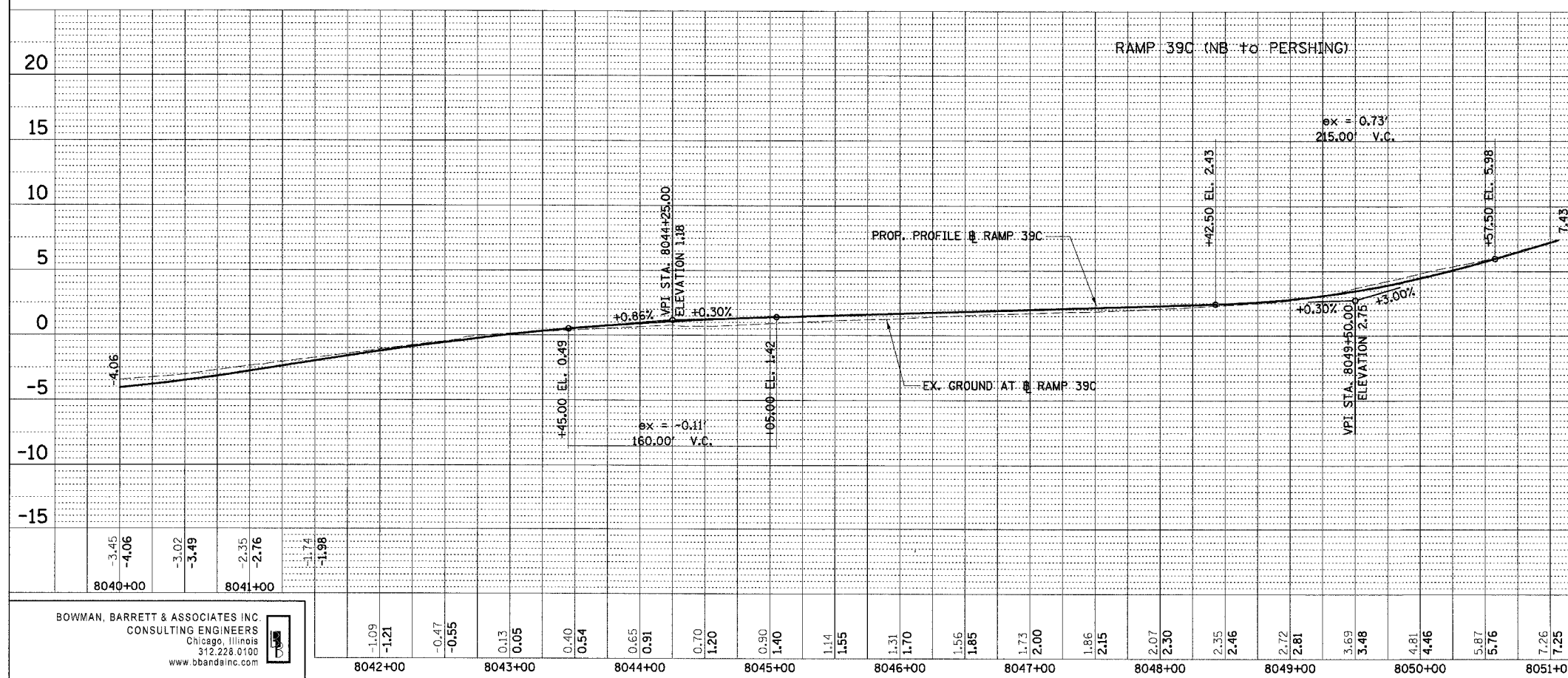
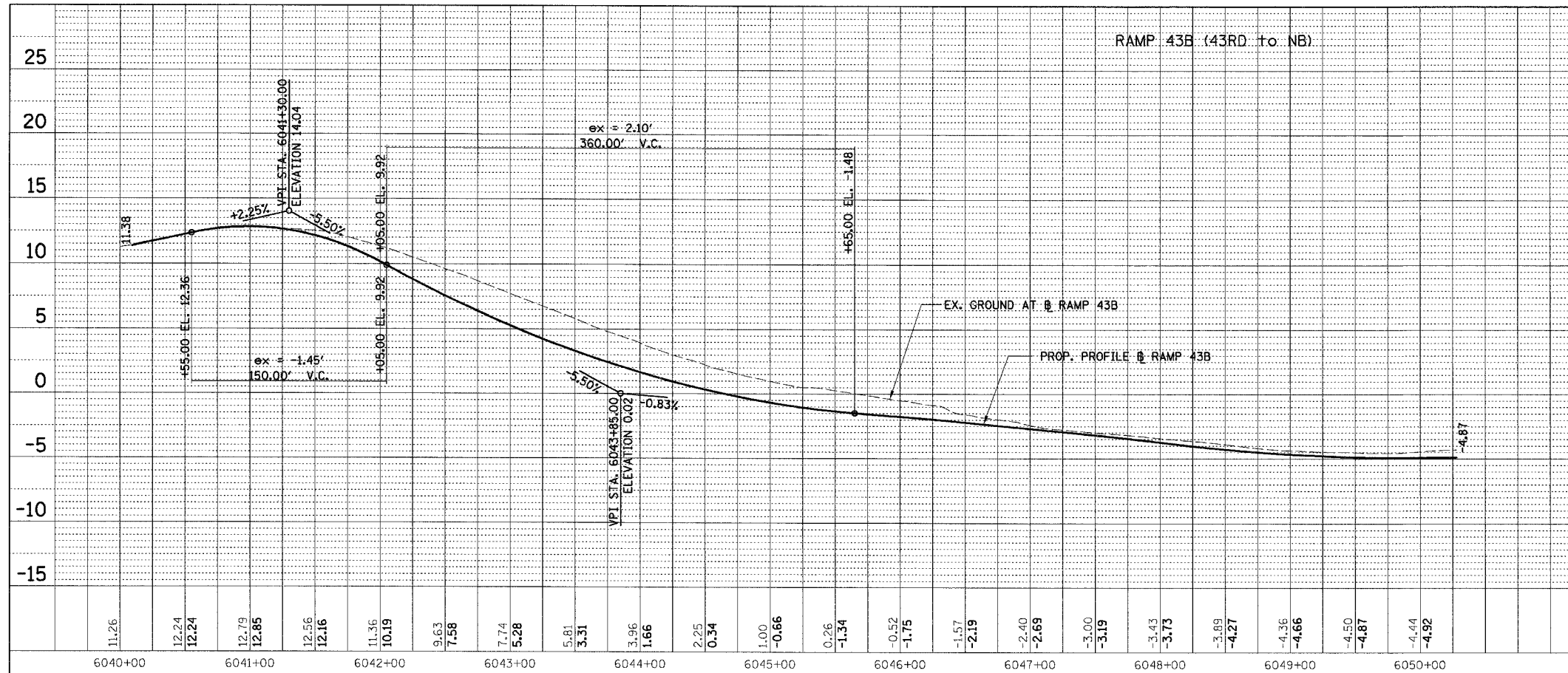

PLAN	SURVEYED	DATE
NOTE BOOK	ALIGNMENT CHECKED	BY
NO.	DATE	
	FILE NAME	

PLAN	SURVEYED	DATE
NOTE BOOK	ALIGNMENT CHECKED	BY
NO.	DATE	
	FILE NAME	

BOWMAN, BARRETT & ASSOCIATES INC.
CONSULTING ENGINEERS
Chicago, Illinois
312.228.0100
www.bbainc.com

REVISIONS	
NAME	DATE

ILLINOIS DEPARTMENT OF TRANSPORTATION
F.A.I. 94/90 (DAN RYAN EXPRESSWAY)
GARFIELD BLVD TO 31ST STREET (NB LOCAL LANES)
PROFILES - RAMPS 43B AND 39C
1" = 5' VERT
SCALE: 1" = 50' HORIZ
DATE: 06/09/06
DRAWN BY: JDC
CHECKED BY: RS

PRO-11

12/25/23 PM
6/7/2006