

|                     |                                   |        |              |           |
|---------------------|-----------------------------------|--------|--------------|-----------|
| F.A.I.              | SECTION                           | COUNTY | TOTAL SHEETS | SHEET NO. |
| 94/90               |                                   | COOK   | 565          | 91        |
| STA.                | TO STA.                           |        |              |           |
| FED. ROAD DIST. NO. | ILLINOIS FED. AID PROJECT         |        |              |           |
| 62301               | (2021-922 PT2 ETC 2324.6-1P) R-10 |        |              |           |

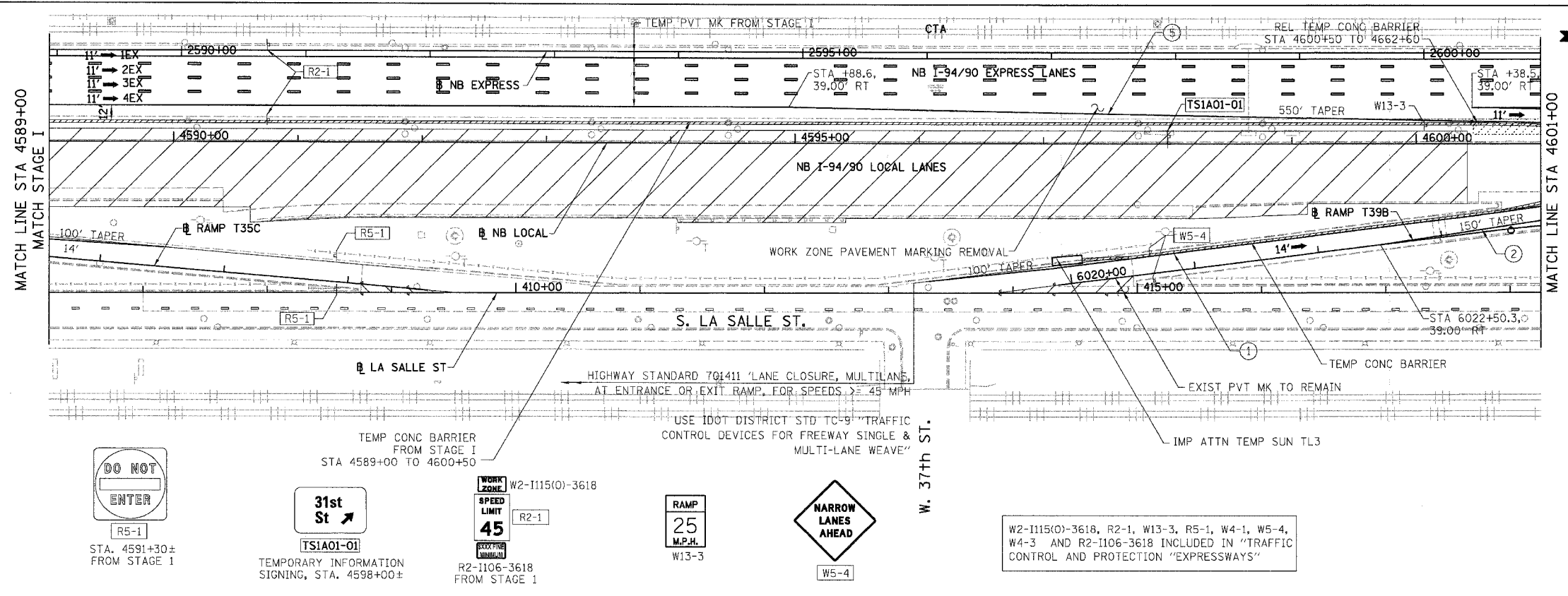

- LEGEND:**
- 1 → LANE NUMBER AND DIRECTION OF TRAFFIC
  - ▨ WORK AREA
  - ▨ TEMPORARY PAVEMENT
  - ∞ IMPACT ATTENUATORS, TEMPORARY (NON-REDIRECTIVE), TEST LEVEL 3
  - DRUM OR BARRICADE TYPE II WITH STEADY BURNING LIGHT
  - ⊥ BARRICADE TYPE III
  - ▨ TEMPORARY CONCRETE BARRIER
  - ① LINE 4" (YELLOW EDGE)
  - ② LINE 4" (WHITE EDGE)
  - ③ LINE 4" (SKIP DASH, 6' SKIP - 2' DASH, WHITE)
  - ④ LINE 5" (SKIP DASH, 30' SKIP - 10' DASH, WHITE)
  - ⑤ LINE 8" (WHITE GORE LINE)
  - ⑥ LINE 8" (SKIP DASH, 12' SKIP - 3' DASH, WHITE)
  - ⑦ LINE 12" (DIAGONAL, 30' C-C, WHITE)
  - ⑧ LETTERS AND SYMBOLS
- ES-XXX-XX EXISTING OVERHEAD OR CANTILEVER SIGNS  
 GS-XXX-XX EXISTING POST MOUNTED SIGNS  
 TS-XXX-XX TEMPORARY SIGNS
- +XX.XX STATION PROVIDED FROM THE ± SB I-90/94 EXPRESS LANES  
 (+XX.XX) STATION PROVIDED FROM THE ± SB I-90/94 LOCAL LANES

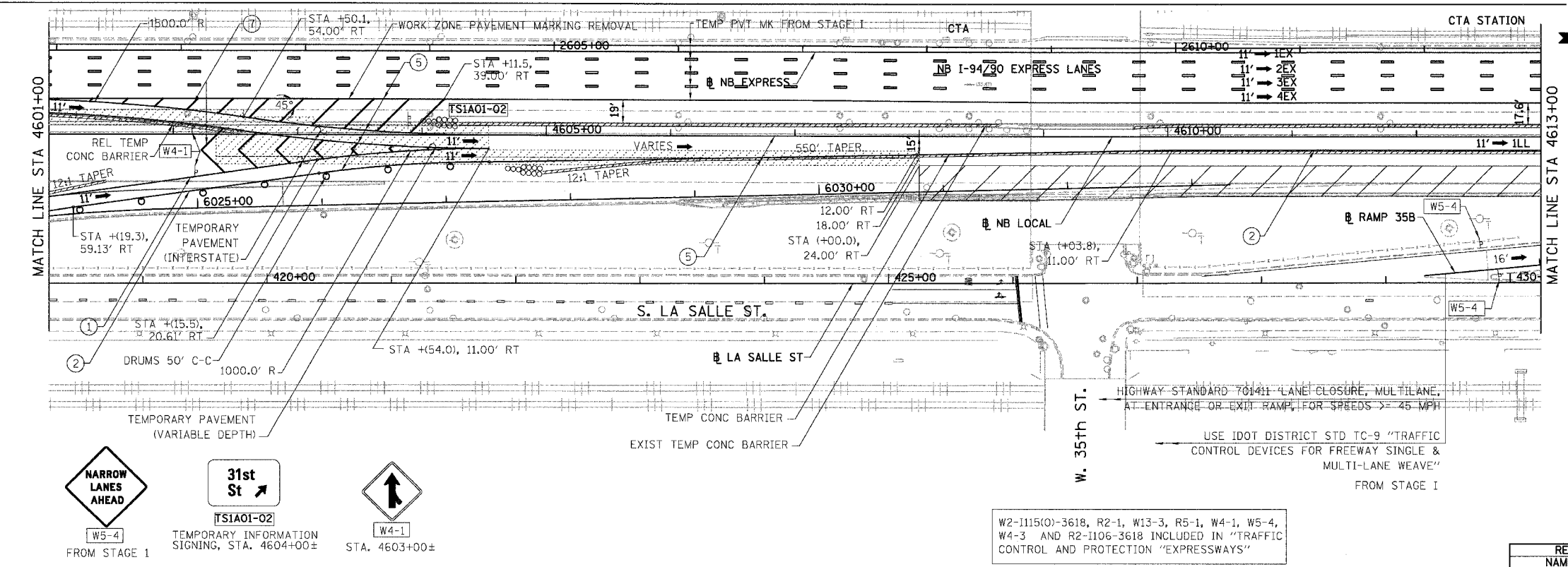

- NOTES:**
- SEE SHEET MOTTS-01 FOR TYPICAL SECTIONS.
  - SEE TEMPORARY SIGN PANEL SHEETS FOR DETAILS.
- 0 50' 100'
- MOT-1A01

| REVISIONS |             | NAME | DATE |
|-----------|-------------|------|------|
| NO.       | DESCRIPTION |      |      |
|           |             |      |      |
|           |             |      |      |
|           |             |      |      |
|           |             |      |      |
|           |             |      |      |

ILLINOIS DEPARTMENT OF TRANSPORTATION  
 F.A.I. 94/90 (DAN RYAN EXPRESSWAY)  
 GARFIELD BLVD TO 31ST STREET (NB LOCAL LANES)  
 SUGGESTED STAGES OF CONSTRUCTION  
 AND TRAFFIC CONTROL  
 SUBSTAGE 1A

SCALE: 1"=50'  
 DATE: 06/09/06  
 DRAWN BY: RA  
 CHECKED BY: RS

BOWMAN, BARRETT & ASSOCIATES INC.  
 CONSULTING ENGINEERS  
 Chicago, Illinois  
 312.228.0100  
 www.bbainc.com

NB I-94/90 EXPRESS LANES TEMPORARY PAVEMENT MARKINGS WERE INSTALLED IN STAGE 1, UNLESS OTHERWISE SPECIFIED IN SUBSTAGE 1A.  
 CROSS OVER RAMP TEMPORARY PAVEMENT MARKINGS INSTALLED IN SUBSTAGE 1A TO REMAIN TO NEXT STAGE, UNLESS OTHERWISE SPECIFIED IN STAGE 2.

14660/0400/04/11/15/16/17/18/19/20/21/22/23/24/25/26/27/28/29/30/31/32/33/34/35/36/37/38/39/40/41/42/43/44/45/46/47/48/49/50/51/52/53/54/55/56/57/58/59/60/61/62/63/64/65/66/67/68/69/70/71/72/73/74/75/76/77/78/79/80/81/82/83/84/85/86/87/88/89/90/91/92/93/94/95/96/97/98/99/100