

F.A.I.	SECTION	COUNTY	TOTAL SHEETS	SHEET NO.
94/90		COOK	565	106
STA.	TO STA.			
FED. ROAD DIST. NO.	ILLINOIS	FED. AID PROJECT		
62301		*12021-922 PT2 ETC 2324.6-1P) R-10		

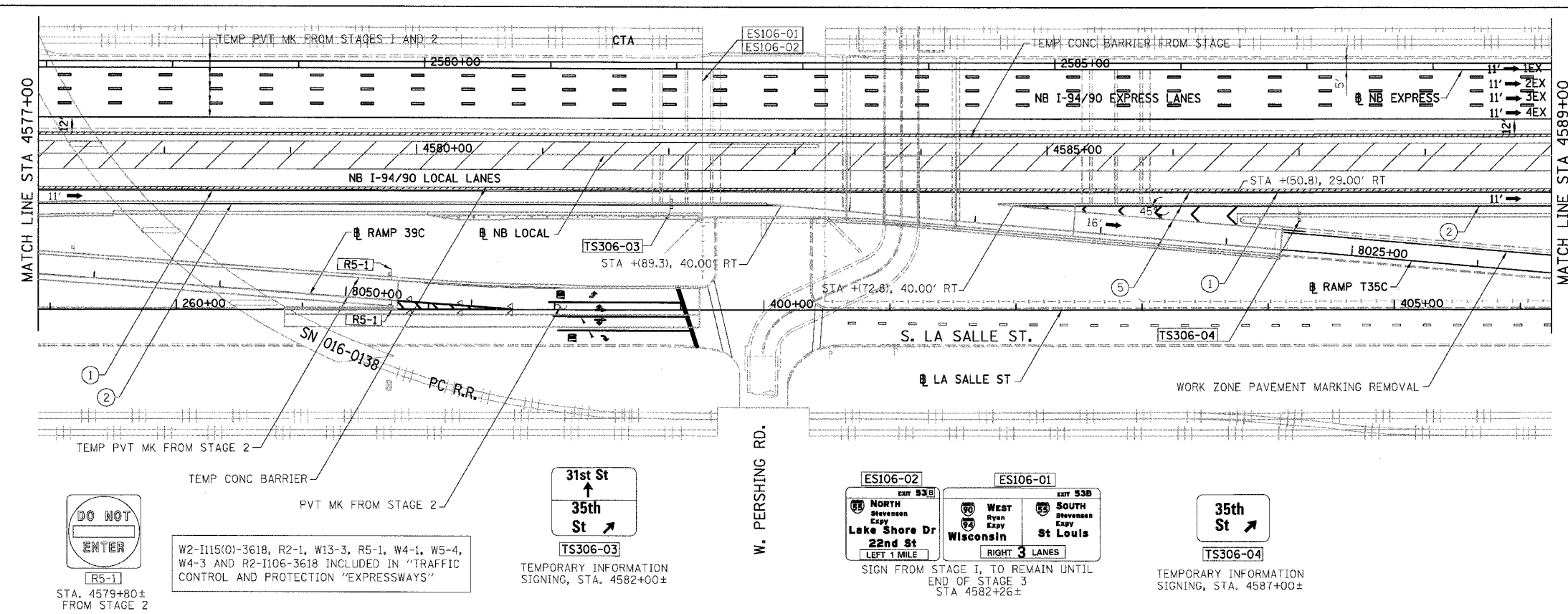

- LEGEND:**
- 1 → LANE NUMBER AND DIRECTION OF TRAFFIC
 - ▨ WORK AREA
 - ▨ TEMPORARY PAVEMENT
 - ⊖ IMPACT ATTENUATORS, TEMPORARY (NON-REDIRECTIVE), TEST LEVEL 3
 - ⊙ DRUM OR BARRICADE TYPE II WITH STEADY BURNING LIGHT
 - ⊓ BARRICADE TYPE III
 - ▬ TEMPORARY CONCRETE BARRIER
 - ① LINE 4" (YELLOW EDGE)
 - ② LINE 4" (WHITE EDGE)
 - ③ LINE 4" (SKIP DASH, 6' SKIP - 2' DASH, WHITE)
 - ④ LINE 5" (SKIP DASH, 30' SKIP - 10' DASH, WHITE)
 - ⑤ LINE 8" (WHITE GORE LINE)
 - ⑥ LINE 8" (SKIP DASH, 12' SKIP - 3' DASH, WHITE)
 - ⑦ LINE 12" (DIAGONAL, 30' C-C, WHITE)
 - ⑧ LETTERS AND SYMBOLS
 - ES-XXX-XX EXISTING OVERHEAD OR CANTILEVER SIGNS
 - GS-XXX-XX EXISTING POST MOUNTED SIGNS
 - TS-XXX-XX TEMPORARY SIGNS
 - +XX.XX STATION PROVIDED FROM THE ± SB I-90/94 EXPRESS LANES
 - (+XX.XX) STATION PROVIDED FROM THE ± SB I-90/94 LOCAL LANES

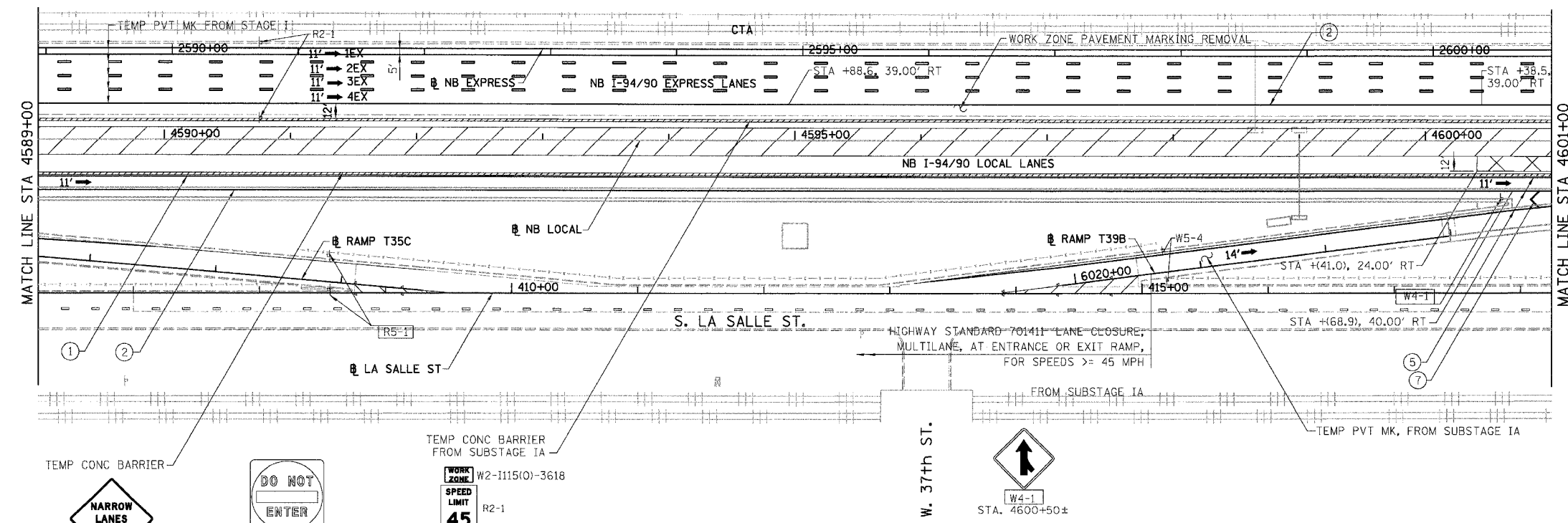

- NOTES:**
- SEE SHEET MOTTS-01 FOR TYPICAL SECTIONS.
 - SEE TEMPORARY SIGN PANEL SHEETS FOR DETAILS.



REVISIONS	
NAME	DATE

MOT-306

ILLINOIS DEPARTMENT OF TRANSPORTATION
 F.A.I. 94/90 (DAN RYAN EXPRESSWAY)
 GARFIELD BLVD TO 31ST STREET (NB LOCAL LANES)
 SUGGESTED STAGES OF CONSTRUCTION
 AND TRAFFIC CONTROL
 STAGE 3

SCALE: 1"=50'
 DATE: 06/09/06

DRAWN BY: RA
 CHECKED BY: RS

BOWMAN, BARRETT & ASSOCIATES INC.
 CONSULTING ENGINEERS
 Chicago, Illinois
 312.228.0100
 www.bbainc.com

NB I-94/90 EXPRESS LANES TEMPORARY PAVEMENT MARKINGS WERE INSTALLED IN STAGES I, 2 AND SUBSTAGE IA, UNLESS OTHERWISE SPECIFIED IN STAGE 3. CROSS OVER RAMP, TEMPORARY PAVEMENT MARKINGS INSTALLED IN STAGE 2 TO REMAIN TO END OF SUBSTAGE 3A, UNLESS OTHERWISE SPECIFIED IN STAGE 3.

W2-I115(O)-3618, R2-1, W13-3, R5-1, W4-1, W5-4, W4-3 AND R2-I106-3618 INCLUDED IN "TRAFFIC CONTROL AND PROTECTION "EXPRESSWAYS"

W2-I115(O)-3618 R2-1
 R2-I106-3618 FROM STAGE I

R5-1
 STA. 4591+30± FROM STAGE I

W5-4 FROM STAGE IA

W4-1
 STA. 4600+50±

HIGHWAY STANDARD 701411 LANE CLOSURE, MULTILANE, AT ENTRANCE OR EXIT RAMP, FOR SPEEDS ≥ 45 MPH

TEMP PVT MK, FROM SUBSTAGE IA

TEMP CONC BARRIER FROM SUBSTAGE IA

TEMP CONC BARRIER

FROM STAGE IA

W. 37th St.

S. LA SALLE ST.

LA SALLE ST.

NB LOCAL

W. PERSHING RD.

ES106-02
 NORTH Stevenson Expwy
 Lake Shore Dr
 22nd St
 LEFT 1 MILE

ES106-01
 WEST Ryan Expwy
 Wisconsin
 SOUTH Stevenson Expwy
 St Louis
 RIGHT 3 LANES

31st St
 35th St
 TS306-03
 TEMPORARY INFORMATION SIGNING, STA. 4582+00±

35th St
 TS306-04
 TEMPORARY INFORMATION SIGNING, STA. 4587+00±

R5-1
 STA. 4579+80± FROM STAGE 2

DO NOT ENTER
 R5-1

W2-I115(O)-3618, R2-1, W13-3, R5-1, W4-1, W5-4, W4-3 AND R2-I106-3618 INCLUDED IN "TRAFFIC CONTROL AND PROTECTION "EXPRESSWAYS"

MATCH LINE STA 4577+00

MATCH LINE STA 4589+00

MATCH LINE STA 4589+00

MATCH LINE STA 4601+00