

F.A.I.	SECTION	COUNTY	TOTAL SHEETS	SHEET NO.
94/90	*	COOK	565	241
STA.		TO STA.		
62301		*(2021-922 PT2 ETC 2324.6-1P) R-10		

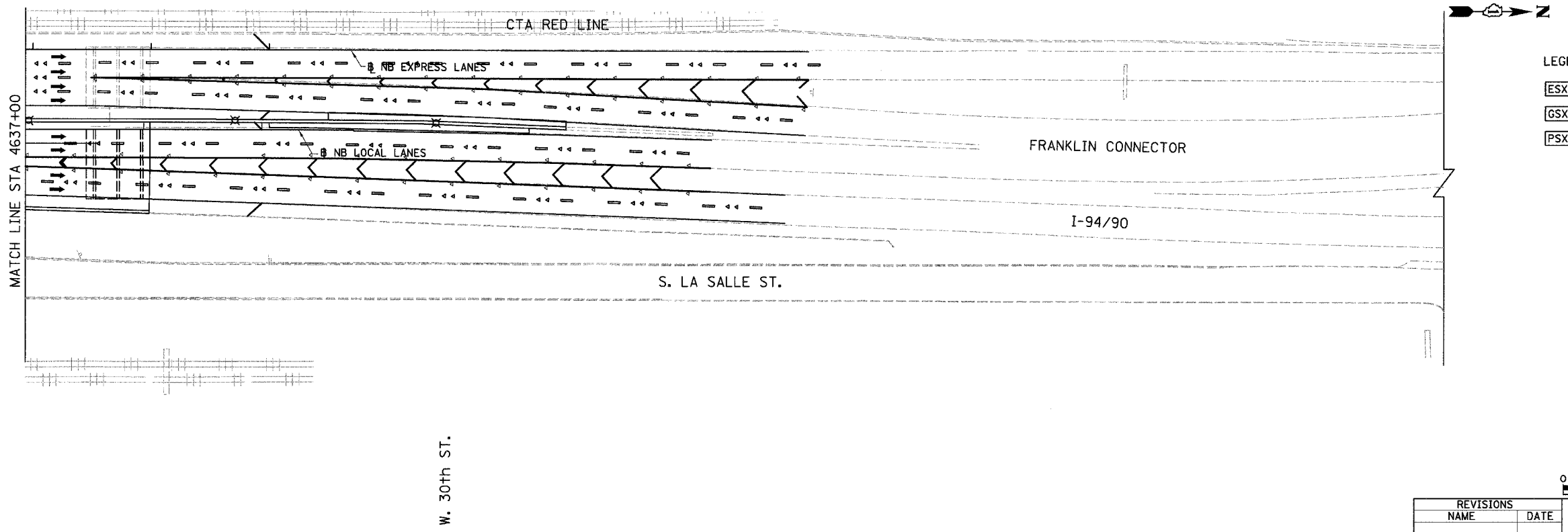
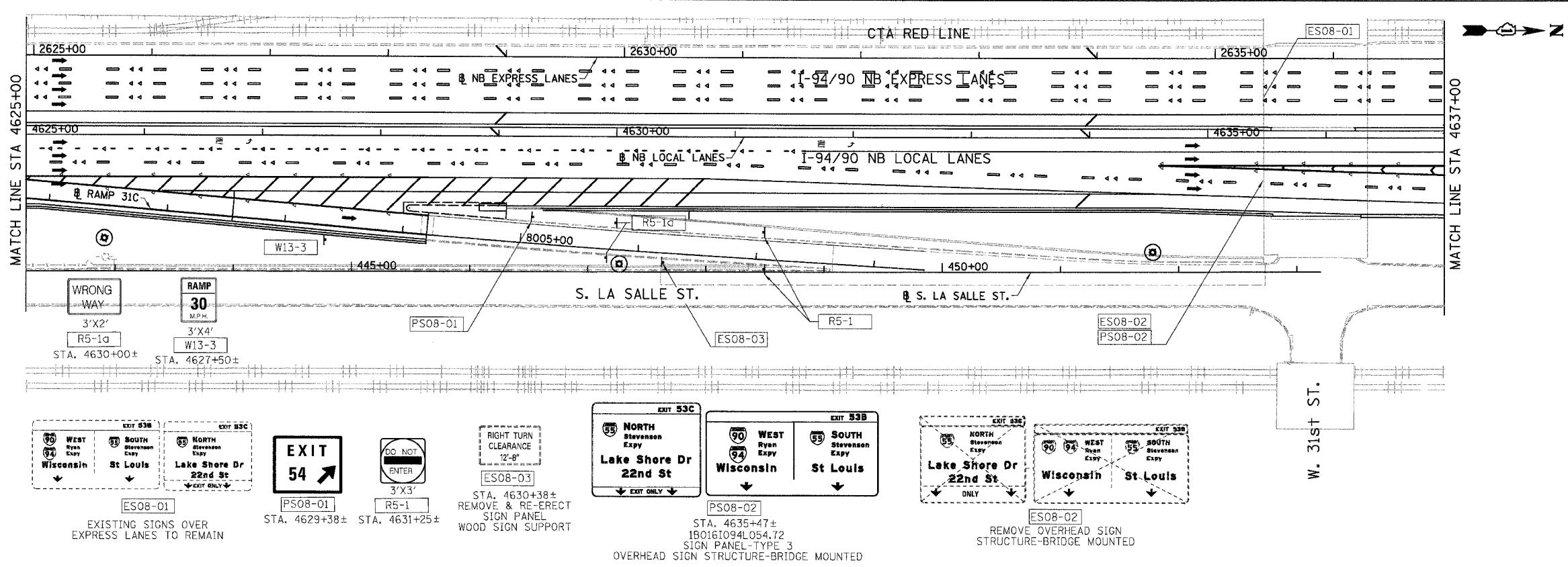

KAM ENGINEERING, INC.
CONSULTING ENGINEERS
707A Davis Road, Suite 205
Elgin, Illinois 60123-1369

REVISIONS	
NAME	DATE

0 50' 100'

ILLINOIS DEPARTMENT OF TRANSPORTATION
F.A.I. 94/90 (DAN RYAN EXPRESSWAY)
GARFIELD BLVD TO 31ST STREET (NB LOCAL LANES)

PROPOSED SIGNING PLANS

SCALE: 1"=50'
DATE: 06/09/06

DRAWN BY: RV
CHECKED BY: MSA

SG-08
1/5/06 PM
6/7/2006